

Reorder No. 10704

 Manufactured for:
Dynarex Corporation
10 Glenshaw Street
Orangeburg, NY 10962
USA • www.dynarex.com

Made in China



Hydraulic Patient Lift



GENERAL INFORMATION

SAFETY PRECAUTIONS

The Dynarex Hydraulic Patient Lift (Reorder number 10704) is NOT a transport device. It is intended to transfer an individual from one resting surface to another (such as a bed to a wheelchair).

Assembling the Hydraulic Patient Lift

DO NOT overtighten the mounting hardware as this can damage the mounting brackets.

All hardware must be tight to ensure safe use of the Hydraulic Patient Lift. All hardware and welds must be checked at least every six months in conjunction with periodic maintenance.

Operating the Hydraulic Patient Lift

DO NOT exceed maximum weight limitation of the Hydraulic Patient Lift.

The weight limitation is 450 lb.

ALWAYS keep hands and fingers away from moving parts to avoid injury.

Lifting the Patient

The rear casters of the Hydraulic Patient Lift MUST be kept unlocked when lifting an individual. Locking the casters during lifting procedures could cause the lift to tip and endanger the patient and assistants. The unlocked casters during lifting procedures will allow the Hydraulic Patient Lift to stabilize itself when the patient is initially lifted from a chair, bed or any stationary object.

Specific slings are made for the Hydraulic Patient Lift. For the safety of the patient, DO NOT intermix slings and patient lifts of different manufacturers. Warranty will be voided.

When the patient is elevated a few inches off a stationary surface and before moving the patient, check again to make sure that all hardware or straps are properly connected. If any attachment is NOT properly in place, lower the patient back onto the bed and rectify the issue.

Adjustments for safety and comfort should be made prior to moving the patient. Patient's arms should be kept inside of the straps.

During transfer, DO NOT roll caster base over uneven surfaces that could cause the Hydraulic Patient Lift to tip over. Use steering handle on the mast at all times to maneuver the Hydraulic Patient Lift.

Performing Maintenance

DO NOT attempt to open the pre-sealed hydraulic pump as it will VOID the warranty and might result in damage. Consult your dealer or manufacturer for further information.

EQUIPMENT ASSEMBLY

Main components provided in the package:

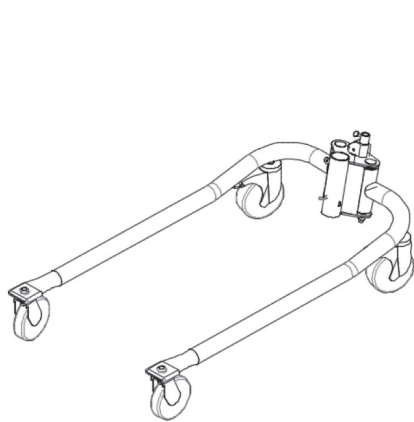

Lift Caster Base x 1

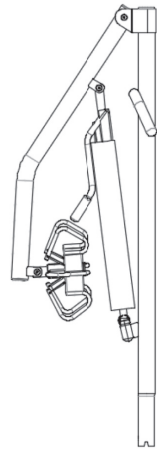

Boom Mast assembly x 1

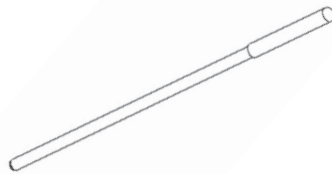

Shifter Handle x 1

Not all items provided in the carton are shown in the above. Threaded screws are fastened to their intended locations and therefore omitted from the illustration.

Unless the lift is to be used immediately, retain boxes, containers, and packing materials for use in storing until use of the Hydraulic Patient Lift is required.

IMPORTANT

Store the repackaged patient lift in a dry area. Do not place other objects on top of the repackaged patient lift.

EQUIPMENT ASSEMBLY

ASSEMBLING THE HYDRAULIC PATIENT LIFT

Assembling the boom/mast assembly to the base

WARNING: Use only parts supplied by the manufacturer for assembly. The base legs, the mast, boom, pump assembly and the swivel bar are manufactured to specifications that assure correct alignment of all parts for safe operation.

1. Step on the locking levers to lock the two rear casters at the base.

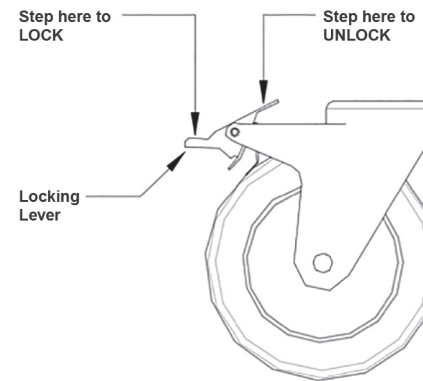

2. Remove the wing screw fastened to mounting barrel of the base.
3. Position the mast assembly in an upright position and insert the mast into the mounting barrel of the base. The notches at the bottom of the mast should lock in with the tabs in the mounting barrel, preventing the mast from rotating once it is inserted into the base.
4. Secure the mast assembly to the base with wing screw removed in Step 2.

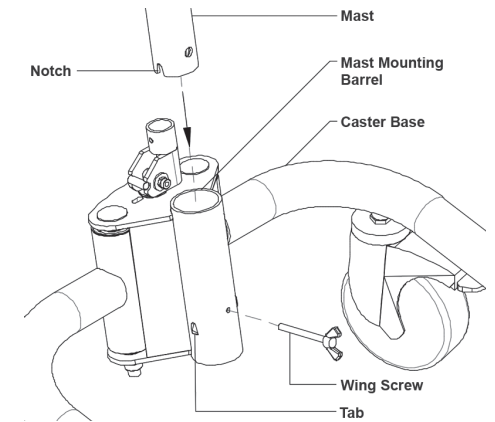

WARNING: For storage or transport, the mast may be disconnected from the base. Each time the mast is removed and returned to the base, the mast MUST be properly secured to the base assembly.

Assembling the hydraulic pump to the boom

1. Remove the clevis pin and split ring fastened to the boom mounting bracket.
2. Lift up on the boom and place it on your left shoulder.
3. Align the hydraulic pump shaft to the mounting bracket of the boom assembly.
4. Insert a clevis pin to keep the hydraulic pump assembly attached to the boom. Secure with split ring.

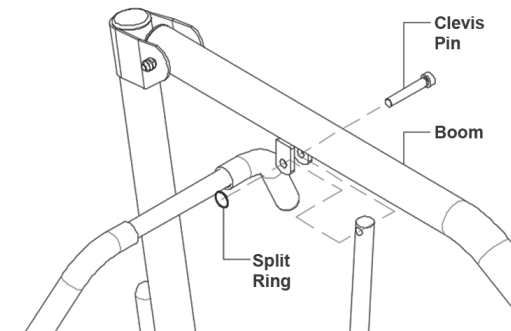

EQUIPMENT ASSEMBLY

Installing the shifter handle

Insert the threaded end of the shifter handle into the handle's mounting barrel. Rotate the shifter handle clockwise until the handle is tightly locked in place.

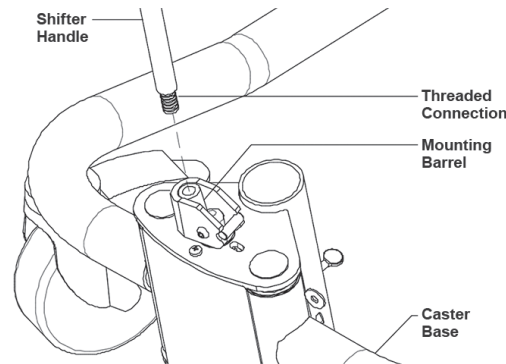

EQUIPMENT OPERATION

OPERATING THE HYDRAULIC PATIENT LIFT

Closing/Opening the legs of the lift base

1. Stand at the rear of the lift and grasp the shifter handle with one hand and hold the steering handle with the opposite hand for balance.
2. Pull/push the shifter handle sideways away from the lift to release the lock pin from the mounting hole.
3. Swivel the shifter handle in a round motion towards the opposite side until you are able to secure the lock pin into the mounting hole.

The shifter handle **MUST** lock into its mounting slot to lock the legs in the full close/open position.

WARNING: The shifter handle **MUST** be positioned completely into its mounting slot. **DO NOT** use the patient lift until

the shifter handle is properly seated and the legs of the patient lift are locked in place. Otherwise, injury and/or damage may occur.

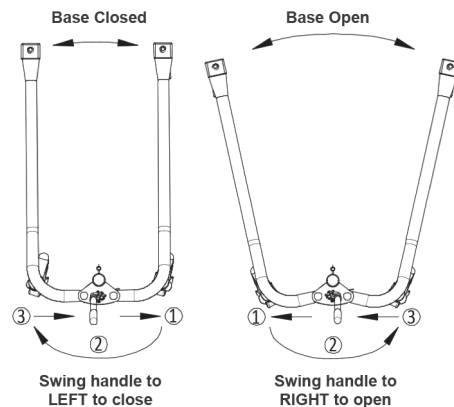

EQUIPMENT OPERATION

Raising/lowering the lift

WARNING: The rear casters of the patient lift should not be locked when lifting an individual. Locked casters could cause the lift to tip and endanger the patient and assistants. It is recommended that the rear casters be left unlocked during lifting procedures to allow the patient lift to stabilize itself when the patient is initially lifted from a chair, bed or any stationary object.

1. To raise the patient, first make sure the control valve is locked (Valve handle parallel to the pump handle).
2. Maneuver the pump handle in an up and down motion to lift up the patient.
3. To lower the patient, turn the control valve away from the pump handle in the open position. The weight of the patient will lower the lift. The degree of control valve opening will vary the speed of descent.

The safety mechanism built into the lift allows the patient to descend slowly even when the control valve is fully open.

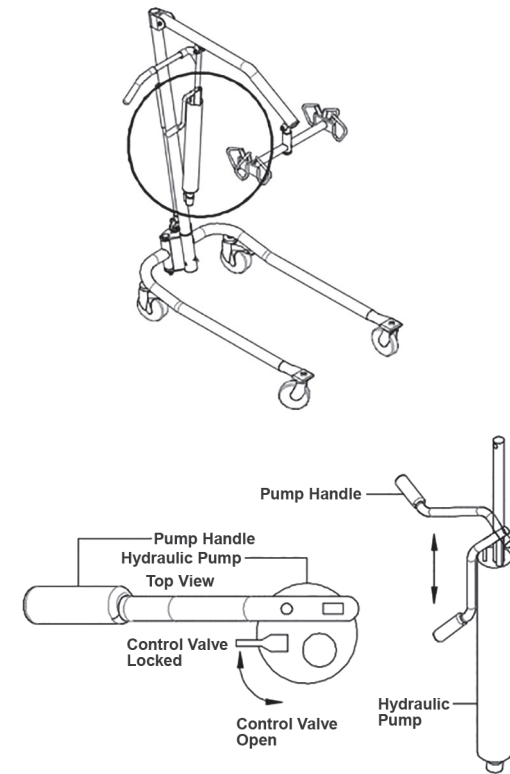

LIFTING THE PATIENT

PREPARING THE LIFT FOR USE

Positioning the lift for use

1. With the legs of the base open, use the steering handle to push the Hydraulic Patient Lift into position.
2. Lower the lift for easy attachment of the sling.

NOTE: The legs of the lift must be in the maximum open position and the shifter handle locked in place for optimum stability and safety. If it is necessary to close the legs of the lift to maneuver the lift under a bed, close the legs of the lift only as long as it takes to position the lift over the patient and lift the patient off the surface of the bed.

When the legs of the lift are no longer under the bed, return the legs of the lift to the maximum open position and lock the shifter handle immediately.

Prepare the sling for patient in lying position

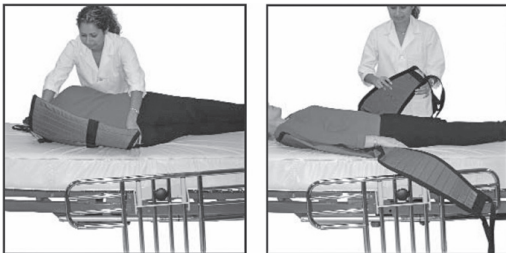

1. Carefully and gently roll the patient on their side. The sling seat should be folded lengthwise and placed under the patient so that the lower edge of the seat is slightly below the back.
2. Roll the patient back onto their other side and pull the sling seat so that it unfolds under the patient.
3. Attach chains if needed.

Prepare the sling at seated position



WARNING: When the patient is seated in a wheelchair, the wheels **MUST** be locked when putting on the sling.

1. Lean patient forward and set the “U” sling behind the patient’s back. Set the sling as far down as possible until it touches the back of the seat.
2. Pull the leg loops forward and under the patient’s thighs. The loops should come through the patient’s legs. Then cross the loops.

Lifting/Moving the patient

WARNING: Before lifting or transferring the patient, the base legs **MUST** be in the open position for optimum stability and safety. **DO NOT** engage the rear locking casters when patient is in the lift.

1. With the lift in position and boom lowered, place the straps of the sling or chains over hooks of the swivel bar. With the sling securely attached to the lift, raise the patient above the bed. The patient should be elevated high enough to clear the bed and their weight supported by the lift.
2. When the patient is clear of the bed surface, swing their feet off the bed.
3. Using the steering handle, move the lift away from the bed.

LIFTING THE PATIENT

4. When moving the Hydraulic Patient Lift away from the bed, turn the patient so that he/she faces assistant operating the lift.

TRANSFERRING THE PATIENT

Transferring the patient to a wheelchair

WARNING: The wheelchair wheels **MUST** be locked before lowering the patient into the wheelchair for transport.

1. The legs of the lift (with patient) should be in open position.
2. Move the wheelchair into position.
3. Ensure the rear wheels of the wheelchair are locked to prevent further movement of the chair.
4. Position the patient over the seat with their face away from the seat and their back against the back of the chair.

Use the straps or handles on the side and the back of the sling to guide the patient’s hips as far back as possible into the seat for proper positioning.

5. Lower the patient.
6. With one assistant behind the chair and the other operating the lift, the assistant behind the chair will pull back on the grab handle (on select models) or sides of the sling to seat the patient well into the back of the chair. This will maintain a good center of balance and prevent the chair from tipping forward.
7. Disconnect the sling from the lift.

To return to the bed, reverse procedures concerning lifting the patient, operation and sling attachments.

WARRANTY

Your Dynarex Hydraulic Patient Lift is warranted to be free of defects in materials and workmanship for five (5) years on structural steel, one (1) year on mechanical parts/components, from original date of purchase, for use by the original purchaser. This item was built to exacting standards and carefully inspected prior to shipment. This Limited Lifetime Warranty is an expression of our confidence in the materials and workmanship of our products and our assurance to the consumer of dependable service.

The Warranty shall not apply under the following conditions:

- Problems arising from normal wear
- Problems arising from failure to adhere to the product instructions
- Problems arising from misuse, negligence, accident or improper operation, maintenance or storage
- Problems arising from modifications or unauthorized repairs, parts or attachments

- Products where the serial number has been removed or defaced
- Problems with non-durable components, such as rubber accessories, casters, and grips, which are subject to normal wear and need periodic replacement

Dynarex shall not be liable for any consequential or incidental damages whatsoever. Dynarex shall repair or replace defective products at its option. The foregoing warranty is exclusive and in lieu of other express warranties, if any, including the implied warranties of merchantability and fitness of a particular purpose. The remedy for any violation of the implied warranty shall be limited to repair or replacement of the defective product pursuant to the terms contained herein.

If you have a question about your Dynarex device or this warranty, please contact an authorized Dynarex dealer.



SYMBOL GLOSSARY

For an explanation of symbols used in Dynarex packaging, visit dynarex.com/symbols.php

 **WARNING:**
Cancer and Reproductive Harm
www.P65Warnings.ca.gov