

CORAL

FROSTED WALL LIGHT

Designed and Handmade by Oliver Höglund & Ryan Roberts

Molten hot glass shaped and hand-blown at one thousand degrees cel-sius. A flat disc shape made with quality Swedish clear glass.

The free formation design ensures that no two pieces are the same, giving you a truly aesthetic piece for your space.

Hand Made in Currumbin, Australia.

GLASS FINISH



Frosted

TECHNICAL DATA

Application	Interior Use Only	Input Power	100 - 240VAC
Glass	Frosted	Output Voltage	4V DC Driver (350mA Constant Current) Remote Driver Included
Cover Cap Finish	Matte Black / White / Brass Finish / Clear Finish	LED Wattage	Standard 1W / 2W (additional cost) Lifespan - 60,000+ Hours
Wall Mount Finish	Matte Black / White / Brass Finish / Clear Finish	Colour Temperature	2700K / 3000K (Stansard) / 4000K
Dimensions	Glass Diameter Small: 120 - 140 Medium: 150 - 170 Large: 200 - 220 Glass Thickness: 10-20mm Wall Mount: 110 x 15mm	Dimming	Single-Use - 1W LED Non-Dimming / 2W LED Dimmable TRIAC Two or more - 1W LED Dimmable TRIAC Optional Single-use - 1W LED Dimmable with Bell press & DALI (additional cost)
		Warranty	24 Months

DIMENSIONS

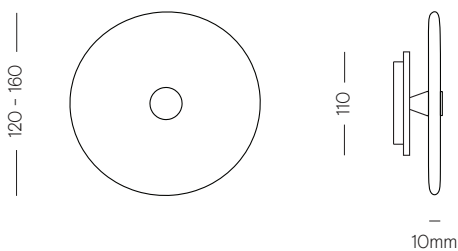

MOUNTING

Installation Instructions

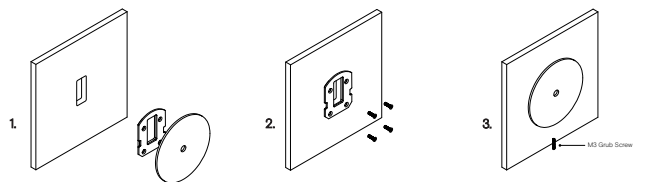

1. Prep the wall with an hole match the wall plate cutout. Secure the transformer into the wall cavity and feed the cable through the hole into the room. Connect the single electrified cable to the transformer.

2. Screw the mounting plate to the wall using appropriate fasteners for the wall substrate.

3. Fit the circular wall plate over the mounting plate and secure with the supplied M3 grub screw at the bottom of the plate.

*The transformer needs to be accessible for maintenance purposes.