



# CORAL

## SINGLE ROD (FROSTED) PENDANT

Designed and Handmade by Oliver Höglund & Ryan Roberts

Molten hot glass shaped and hand-blown at one thousand degrees cel-sius. A flat disc shape made with quality Swedish clear glass.

The free formation design ensures that no two pieces are the same, giving you a truly aesthetic piece for your space.

Hand Made in Currumbin, Australia.



### TECHNICAL DATA

Application	Interior Use Only	Input Power	100 - 240VAC
Glass Colour	Frosted	Output Voltage	4V DC Driver (350mA Constant Current) Supplied with Remote Driver
Suspension Rod	Natural Brass / Matte Black / Matte White / Steel Finish / Medium Bronze Powdercoated	Dedicated LED	1W - 350mA (Standard) / 2W (additional cost) Lifespan - 60,000+ Hours
Glass Diameter	Small: 120 - 140mm Medium: 150 - 170mm Large: 200 - 220mm  Glass thickness: 10-20mm	Colour Temperature	2700K / 3000K (Standard) / 4000K
Rod Length	1200mm (custom lengths available)	Dimming	Single-Use-1W LED Non-Dimmable (Standard) Optional Single-use - 1W LED Dimmable with DALI (additional cost) Please contact for alternative dimming options
		Warranty	24 Months / 2 Years
		Certification	CE / AS/NZS - 60598.2.1

### MOUNTING

#### Dimensions

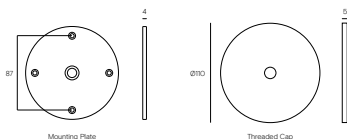

#### Installation Instructions

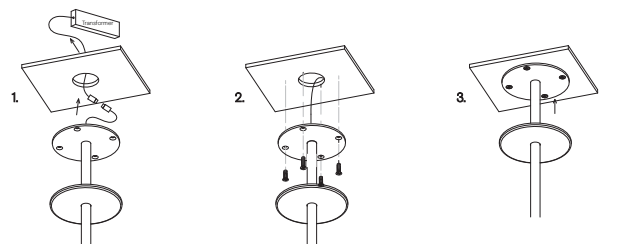

1. Prep the ceiling with an approx. 50mm hole to fit the transformer. Place the transformer in the ceiling and feed the cable through the hole into the room. Connect the single electrified cable to the transformer.

2. Screw the steel mounting plate to the ceiling using appropriate fasteners for the ceiling substrate.

3. Secure the magnetic cover plate onto the mounting plate.

\*The transformer needs to be accessible for maintenance purposes.