

PITAKA MagEZ Mount User Manual

Package Contains:

- PITAKA MagEZ Mount x 1
- Metallic Plate x 1

Compatibility Notice:

- With a PITAKA MagEZ Case/MagEZ Case Pro, there's no need to use the metallic plate. Simply attach the device to the mount and go.
- If you are not a PITAKA MagEZ Case/MagEZ Case Pro user, the metallic plate is necessary for the mounting.

Installation:

(If you are using PITAKA MagEZ Case/MagEZ Case Pro, you can skip step 2 directly)

STEP 1:

Stick the adhesive metallic plate on the back of the device or the phone case.

With case



Without case



STEP 2:

Using the PITAKA Car Vent MagEZ Mount

Find a safe location on the vehicle vent, slide the MagEZ Mount air vent clips into your car's air vent.

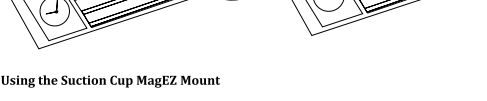

Using the Suction Cup MagEZ Mount

Find a proper location on the windshield or on the dashboard, and clean the surface.

Then firmly press the suction cup and press down the suction switcher to ensure the MagEZ Mount is adhered tightly to the windshield or dashboard.

* Notice: Remember to press the suction cup on the windshield FIRST, then press the suction switcher and lock to ensure the MagEZ Mount will be tightly adhered to the windshield.



1, Firmly press the suction cup against the windshield.

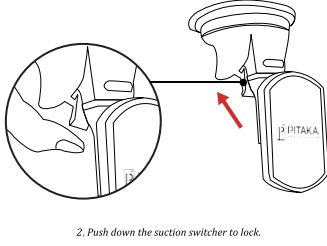

2, Push down the suction switcher to lock.



3, Then the MagEZ Mount is attached on the windshield tightly.

Using the CD Slot MagEZ Mount

Simply insert the slot mount in and tighten the screw to lock it in-place.

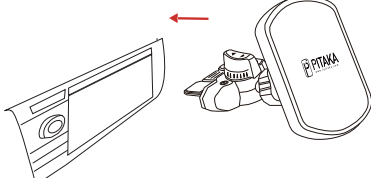

1, Insert the mount in the CD slot.

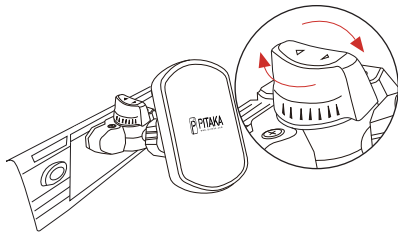

2, Tighten the mounting screw to lock the mount in-place.

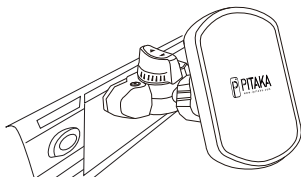

3, The MagEZ Mount (CD Slot) is installed well.

STEP 3:

Attach your device to the mount. The mount securely holds the device and automatically aligns it for a proper position.

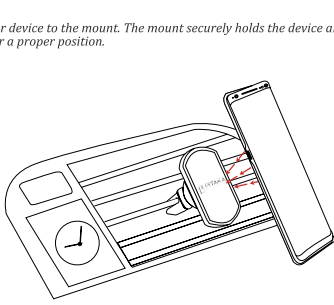

STEP 4:

Adjust the ball-joint rotation to align the mount for the suitable viewing angle. You can rotate the vent mount so your device is in either portrait or landscape orientation.

And then tighten the rotation to fix the position until it rests firmly.

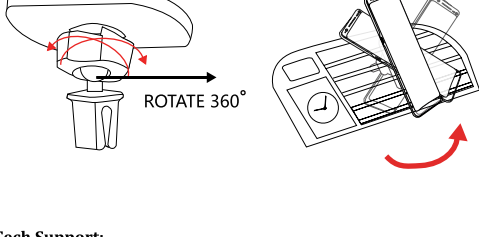

ROTATE 360°

Tech Support:

+852 9202 6223
support@ipitaka.com
Web: www.ipitaka.com

Warranty:

At PITAKA, we are always striving to provide our customers with the best quality products. The PITAKA MagEZ Mount is warranted for 2 months from date of purchase.

The warranty is warranted to be free defects in materials and function under normal use. A defect is defined as an imperfection or flaw that is produced by a manufacturing error.

This warranty is non-transferable and covers the original end-user purchaser. PITAKA will only authorize the warranty claim if the products were purchased from an official store or an authorized dealer.

Warning:

Read all instructions and warnings prior to using this product. Improper use may result in product damage, excess heat, toxic fumes, fire or explosion, for which damages PITAKA is not responsible.

1, Do not disassemble the MagEZ Mount or attempt to modify it in any way.

2, Do not attempt to replace any part of the MagEZ Mount.

3, If this MagEZ Mount is intended by Purchaser to be used by a minor, purchasing adult agrees to provide detailed instructions and warnings to any minor prior to use. Failure to do so is sole responsibility of purchaser, who agrees to indemnify Manufacturer for any unintended use/misuse by a minor.