



## **MagEZ Mount Qi User Manual**

## Contents

Compatibility Notice .....	1
Package Contains .....	1
Quick Guide .....	2
Spec .....	10
Warranty .....	11
Important .....	12
Customer Service .....	13
FCC WARNING .....	16

## **Compatibility Notice:**

- The PITAKA MagEZ Mount Qi will only wirelessly charge any Qi supported phones with a proper PITAKA MagCase (Pro).
- Wireless charging may not work when you put other cases or stick metal plates on your phone.
- Do not use the MagEZ Mount Qi to charge your wireless charging devices that are not Qi-compatible wirelessly.

## **Package Contains:**

- MagEZ Mount Qi \*1
- Charging Cable \*1
- User Manual \*1

## Quick Guide:

Step 1: Connect the cable to the MagEZ Mount Qi's USB port and your car charger's USB port. Plug the car charger into your car's power outlet.

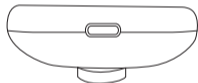

Step 2: Install the MagEZ Mount Qi on your car

1, Installing the PITAKA Car Vent MagEZ Mount Qi

Find a safe location on the vehicle vent, slide the MagEZ Mount Qi air vent clips into your car's air vent.

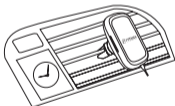
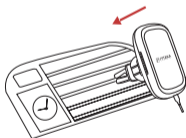

## 2, Installing the Suction Cup MagEZ Mount Qi.

Find a proper location and clean the surface. Then firmly press the suction cup and press down the suction switcher to ensure the MagEZ Mount Qi is adhered tightly.

\*Notice: Remember to press the suction cup FIRST, then press the suction switcher and lock to ensure that you have tightly adhered the MagEZ Mount Qi.

### 2.1 Firmly press the suction cup.

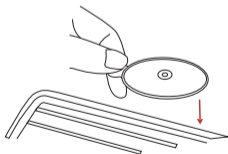

a) Push down the suction switcher to lock the mount in place.



2.3 Then the MagEZ Mount Qi is attached tightly.

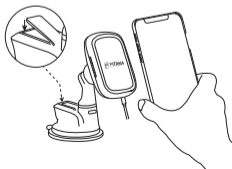

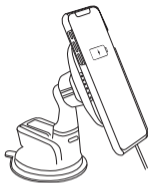

Notice: A dashboard pad is needed when you attach it on the car's dashboard. Then follow the other steps as above to install the suction cup MagEZ Mount Qi.

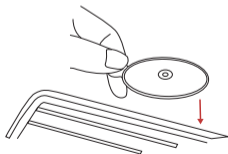

### 3. Installing the CD Slot MagEZ Mount Qi

Simply insert the slot mount and tighten the screw to lock it in place

#### 3.1 Insert the mount in the CD slot

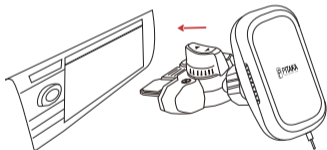

3.2 Tighten the mounting screw to lock the mount in place.

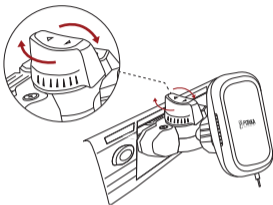

3.3 Then MagEZ Mount Qi (CD Slot) is installed well

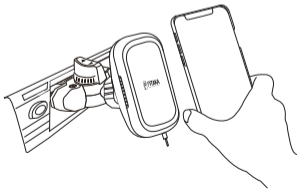

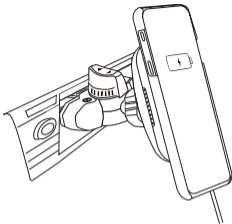

Step 4: You can adjust the ball-joint rotation of the vent mount, so your device is in either portrait or landscape orientation. And then tighten the rotation to fix the position until it rests firmly.

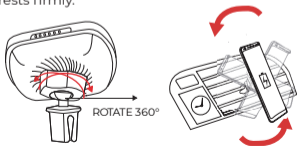

## Spec:

Items	Specification
Input Voltage	5V ~9V
Input Current	≤2A
Rated Output Voltage/ Current (Normal charging)	DC 5V/1A
Rated Output Voltage/ Current (Fast charging)	DC 9V/1.1A
Max Output Power	10W
Transmission Distance	≤8mm
Transfer Efficiency	75% Max
Operating Temperature	-10°C~30°C
Storage Temperature	-20°C~60°C
Working Frequency	110KHz-205KHz

Note: Fast charging will only be supported when using a QC 3.0 adapter with an output over 18W and a USB cable supporting 3A power output.

## **Warranty:**

The PITAKA MagEZ Mount Qi is warranted for 12 months from the date of purchase. The MagEZ Mount Qi is warranted to be free defects in materials and function under normal use for the lifetime of the product. A defect is defined as an imperfection or flaw that is produced by a manufacturing error, including malfunction of wireless charging or surface defect, etc. This warranty is non-transferable and covers only the original end-user purchaser. PITAKA will only authorize the warranty claim if the product was purchased from the official store or authorized dealer.

**MODIFICATION:** Any change or modification of this device will void the warranty.

### **Exclusion**

Damages don't cover those resulting from abuse, not correctly maintained, alteration or misuse (including disassemble, drops), abnormal wear and tear, cosmetic damages that do not affect the functionality.

## **Important:**

Read all instructions and warnings before using this product. Improper use may result in product damage, excess heat, toxic fumes, fire or explosion, for which damages PITAKA is not responsible.

- 1) DO NOT DIRECT HEATED AIR FROM THE VENT ONTO THE MOUNT WHILE IT IS ATTACHED TO THE VENT. When running the car's heater, make sure you close the vent that the mount is attached to or take the mount from the car vent directly, or direct the heated air out of the car's lower vents and away from the upper vents.
- 2) Do not keep the MagEZ Mount Qi in a high-temperature environment, including heat caused by intense sunlight or other forms of heat. Do not place it in the fire or other excessively hot environments.
- 3) Do not disassemble the MagEZ Mount Qi or attempt to modify it in any way.
- 4) Do not attempt to power the MagEZ Mount Qi with any connection other than the Type-C connector.

- 5) Do not attempt to replace any part of the MagEZ Mount Qi
- 6) All products have gone through a thorough quality assurance inspection. If you find that your MagEZ Mount Qi is excessively hot, is emitting odor, is deformed, abraded, cut or is experiencing or demonstrating an abnormal phenomenon, immediately stop all product use and contact Manufacturer.
- 7) If this MagEZ Mount Qi is intended by the purchaser to be used by a minor, purchasing adult agrees to provide detailed instructions and warnings to any minor before use. Failure to do so is the sole responsibility of the purchaser, who agrees to indemnify Manufacturer for any unintended use/misuse by a minor.

## **Customer Service**

Phone: +852 9202 6223

E-mail: [support@ipitaka.com](mailto:support@ipitaka.com)

Website: [www.ipitaka.com](http://www.ipitaka.com)

### **- English:"**

This device complies with Industry Canada licence-exempt RSS standard(s). Operation is subject to the following two conditions:

- (1) this device may not cause interference, and
- (2) this device must accept any interference, including interference that may cause undesired operation of the device."

### **- French:"**

Le présent appareil est conforme aux CNR d'Industrie Canada applicables aux appareils radio exempts de licence. L'exploitation est autorisée aux deux conditions suivantes :

- (1) l'appareil n' doit pas produire de brouillage, et
- (2) l'utilisateur de l'appareil doit accepter tout brouillage radioélectrique subi, même si le brouillage est susceptible d'en compromettre le fonctionnement."

## **FCC WARNING:**

This device complies with part 15 of the FCC Rules.

Operation is subject to the following two conditions:

(1) this device may not cause harmful interference, and (2) this device must accept any interference received, including interference that may cause undesired operation. Any changes or modifications not expressly approved by the party responsible for compliance could void the user's authority to operate the equipment.

NOTE: This equipment has been tested and found to comply with the limits for a Class B digital device, pursuant to Part 15 of the FCC Rules. These limits are designed to provide reasonable protection against harmful interference in a residential installation.

This equipment generates, uses and can radiate radio frequency energy and, if not installed and used in accordance with the instructions, may cause harmful interference to radio communications. However, there is no guarantee that interference will not occur in a particular installation.

If this equipment does cause harmful interference to radio or television reception, which can be determined by turning the equipment off and on, the user is encouraged to try to correct the interference by one or more of the following measures:

- Reorient or relocate the receiving antenna.
- Increase the separation between the equipment and receiver.
- Connect the equipment into an outlet on a circuit different from that to which the receiver is connected.
- Consult the dealer or an experienced radio/TV technician for help.

The device has been evaluated to meet the general RF exposure requirement.

FCC ID: 2AR15-CM3001Q

