

## **Air Pal User Manual**

## Contents

Package Contains .....	1
Compatibility Notice .....	1
Quick Guide .....	2
LED Lightning Indicator & Buttons .....	2
Specs .....	12
Warranty .....	12
Exclusion & Limitations .....	13
Important .....	13
Customer Service .....	14
FCC WARNING.....	14

## Package Contains:



PITAKA Air Pal \*1

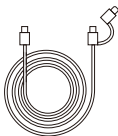

Type C to Type C +  
Lightning Cable\*1



User Manual\*1

## Compatibility Notice:

The PITAKA Air Pal is compatible with the AirPods I and the AirPods II for both wireless charging or charging via the embedded power bank.

## Quick Guide

### I. Install your AirPods in the Air Pal

Simply slide your AirPods into the Air Pal until in snap securely in.

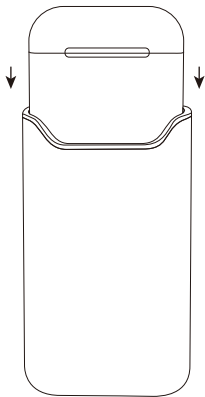

## II. Charge your AirPods with the Air Pal

### 1, Wirelessly Charge your AirPods with the Air Pal

Place the Air Pal on any wireless charger that supports Qi charging, and it will start charging your AirPods on contact.

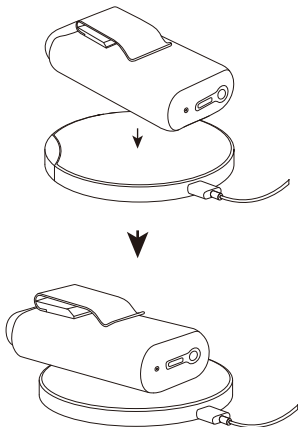

## 2, Charge your AirPods with the Air Pal Internal Power Bank

- Quick press the button once on the base of the Air Pal, and your AirPods will start to charge using the internal power bank.

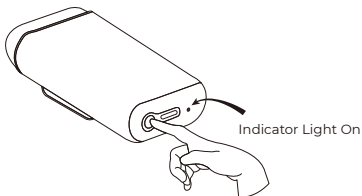

- Double click the button on the base of the Air Pal to stop charging.

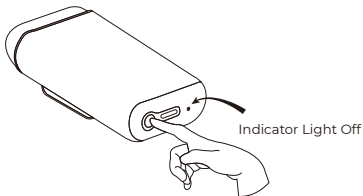

### III. Use the Air Pal to Charge Your iPhone

#### 1, Use Air Pal to Charge Your iPhone

Connect your iPhone to the Air Pal using a Type C to Lightning cable, press the button on the base of the Air Pal. The Air Pal will start to charge your iPhone immediately.

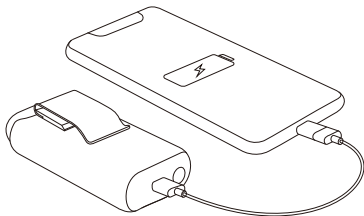

## 2, Use the Air Pal to Charge Your Samsung Phone (Or Other Phone with a Type C Port)

Connect your Samsung phone with a Type C to Type C cable to the Air Pal, and press the button on the base of the Air Pal. The Air Pal will immediately start to charge your Samsung phone (or other phone with the Type C port).

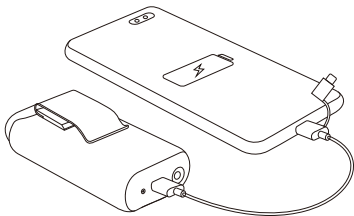

Please kindly note: For Kickstarter pledge, the Type C – C lighting cable is available as an add-on. For Air Pal that's purchased from the official store, the standard package includes the Type C – C+ lighting cable.



## IV. Charging Your Air Pal

### 1, Wirelessly Charge Your Air Pal

Place the Air Pal on any wireless charger that supports Qi charging, the Air Pal will start to be charged on contact.

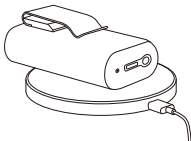

### 2, Charge Your Air Pal using a cable

Connect a Type C charging cable to an AC wall adapter, and then connect the Type C cable to the Air Pal. The Air Pal will start to be charged immediately.

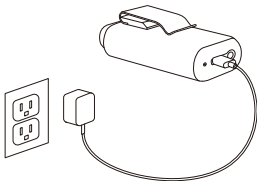

## V. Remove and Install the Metal Belt Clip

### 1, Remove the Metal Clip

Press the metal clip to the right and you will be able to safely remove the metal clip.

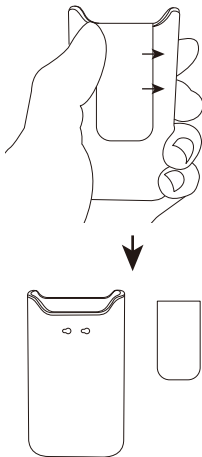

## 2, Install the Metal Belt Clip

Insert the metal belt clip into the Air Pal and slide it to the left. This will install the metal clip into the Air Pal correctly.

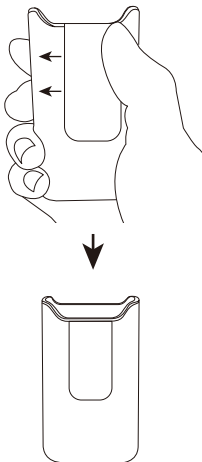

## LED Lightning Indicator & Buttons

### 1, LED Indicator

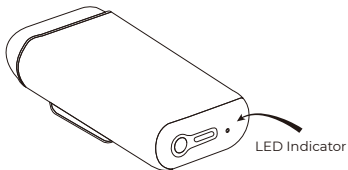

- When the Air Pal is being charged, the LED indicator will blink;
- When the Air Pal is fully charged, the LED indicator will remain on;
- When the Air Pal is charging your AirPods, the LED indicator will remain on;
- When the battery is below 5%, the LED indicator will start to blink until the battery runs out.

## 2, Button

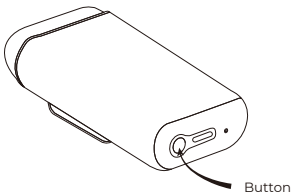

- Single click the button to wake up the Air Pal;
- Double click the button to shut down the Air Pal and stop charging;
- Air Pal will automatically sleep after 10 seconds if there is no AirPods being charged.

## Specs

Items	Specifications
Type-C Input	DC-5V/0.8A
Wireless Input	5V/0.8A
Type-C Output	DC-5V/1A
Lightning Output	DC-5V/0.5A
Total Output	DC-5V/1.5A
Battery	3.7V/600mAH * 2=1200mAH/4.44Wh
Operating Temperature	-10~30°C
Storage Temperature	-20~60°C
Operating Humidity	45~85%RH
Storage Humidity	30~90%RH

## Warranty

The PITAKA Air Pal is warranted for one year from date of purchase.

The Air Pal is warranted to be free defects in materials and function under normal use. A defect is defined as an imperfection or flaw that is produced by a manufacturing error, including malfunction of the wireless charging.

The warranty is non-transferable and covers the original end-user/purchaser. PITAKA will only authorize the warranty claim if the products were purchased from an official store or an authorized dealer.

MODIFICATION: Any change or modification of this device will void the warranty.

## **Exclusion & Limitations**

Except for the limited warranty expressly set forth or to the extent restricted or prohibited applicable law, PITAKA expressly disclaims any and all other warranties express or implied, including any warranty of quality, merchantability, or fitness for a particular purpose, and you specially agree that PITAKA shall not be liable for any special incidental, indirect, punitive, or consequential damages of any type on any PITAKA product. In addition to and without limiting the generality of the foregoing disclaimers, the limited warranty does not, under any circumstances, cover the replacement or cost of any electronic device of personal property inside or outside of the PITAKA product.

## **Important**

1, Do not subject the Air Pal to any high-temperature environment, including heat caused by intense sunlight or other forms of heat. Do not place it in fire or other excessively hot environments.

2, Do not store or use the Air Pal in humid environment.

3, If this Air Pal is intended by the purchaser to be used by a minor, purchasing adult agrees to provide detailed instructions and warnings to any minor prior to use. Failure to do so is the sole responsibility of the purchaser, who agrees to indemnify manufacturer for any unintended use/misuse by a minor.

## **Customer Service**

+852 9202 6223

support@ipitaka.com

www.ipitaka.com

## **FCC WARNING**

This device complies with part 15 of the FCC Rules. Operation is subject to the following two conditions: (1) this device may not cause harmful interference, and (2) this device must accept any interference received, including interference that may cause undesired operation.

Any changes or modifications not expressly approved by the party responsible for compliance could void the user's authority to operate the equipment.

NOTE: This equipment has been tested and found to comply with the limits for a Class B digital device,



pursuant to Part 15 of the FCC Rules. These limits are designed to provide reasonable protection against harmful interference in a residential installation. This equipment generates, uses and can radiate radio frequency energy and, if not installed and used in accordance with the instructions, may cause harmful interference to radio communications. However, there is no guarantee that interference will not occur in a particular installation.

If this equipment does cause harmful interference to radio or television reception, which can be determined by turning the equipment off and on, the user is encouraged to try to correct the interference by one or more of the following measures:

- Reorient or relocate the receiving antenna.
- Increase the separation between the equipment and receiver.
- Connect the equipment into an outlet on a circuit different from that to which the receiver is connected.
- Consult the dealer or an experienced radio/TV technician for help.

To maintain compliance with FCC's RF Exposure guidelines, This equipment should be installed and operated with minimum distance between 20cm the radiator your body: Use only the supplied antenna.

FCC ID: 2ARI5- AP1001

