

Air Omni User Manual

Contents

Welcome & Intro	1
Package Contents	2
Features	3
Compatibility	4
Specs	5
LED Light Indicator	6
Quick Guide	7
Warranty	17
Exclusions	18
Important	18
Customer Service	20
Legal	20
FCC WARNING	22

Welcome & Intro

Thank you for purchasing the PITAKA Air Omni.

Air Omni is a 6-in-1 multi-device charging station for both Apple and Android devices.

Package Contents

1. Air Omni *1
2. Magnetic Holder *1
3. Adapter *1
4. Document Kit *1



①



②

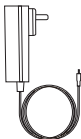

③



④

Features

- Charge 6 devices at the same time.
- 5W Apple Watch charging module.
- 10W wireless charging pad for Qi-enabled smartphones.
- 18W convertible Lightning & Type-C connector.
- 5W wireless charging pad for Qi-enabled earbuds.
- 18W Type-C and Type-A charging ports.
- Storage drawer for small accessories and jewelry.
- Built-in safety features.

Compatibility

Wireless Charging Pad

All Qi-enable Devices

Apple AirPods with wireless charging case and Samsung Galaxy Buds

Earbuds Charging Pad

Apple AirPods with wireless charging case

Samsung Galaxy Buds

Powerbeats Pro Charging Case

Apple Watch Charging Mount

Series SE/6/5/4/3/2&1 (Ceramic, Titanium, Steel, Aluminum, Sport, and Nike versions)

Compatible with original Apple watch charger (USB A)

Lightning & Type-C Toggle

All devices using Lightning or Type-C charging

Type-C Charging Port

All Type-C Charging Devices

Type-A Charging Port

All Type-A Charging Devices

The Lightning & Type-C Toggle should not be used if the device is upside down.

Specs

Items	Specifications
Input	15V / 4.3A
Apple Watch Wireless Output	5W
EarPods Wireless Output	5W
Wireless Output for Phone	5W / 7.5W / 10W
Wireless Charging Distance	≤8mm
Wireless Charging Efficiency	≤75%
Operating Temperature	-10℃~30℃
Storage Temperature	-20℃~60℃
Wireless Charging Frequency	110KHZ-205KHZ
Convertible Lightning Connector	5V/3A, 9V/2A, 12V/1.5A
Convertible Type-C Connector	5V/3A, 9V/2A, 12V/1.5A
USB-A Port Output	5V/3A, 9V/2A, 12V/1.5A
USB-C Port Output	5V/3A, 9V/2A, 12V/1.5A

LED Light Indicators

(Qi-enabled Smartphone Wireless Charging)

Charging Base State	LED Indicator
Power On	Red and white lights flash alternatively for two seconds. Then the red light turns off, and white stays on.
Charging	White light flashes every second.
Overheating	Red light flashes every half second.
Foreign Object Detected	Red light stays on.
Short-Circuiting	Red light flashes every 2 seconds.
Over/Under Voltage	Red light flashes every second.

Quick Guide

①

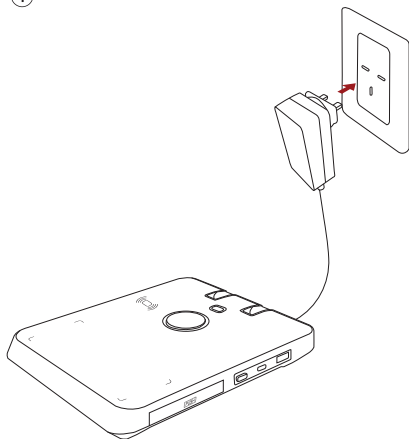

- ② Click the button to switch the Type-C & Lightning connectors.

Notice: Connectors can only be switchable when the supporting stand is folded.

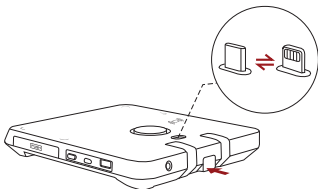

- ③

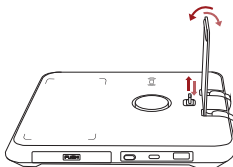

4

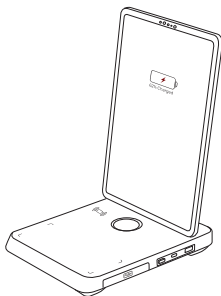

5

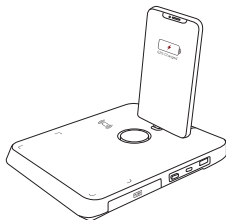

Please insert and remove your device from the connector properly to avoid human damage.

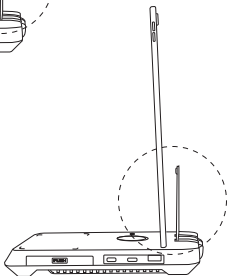
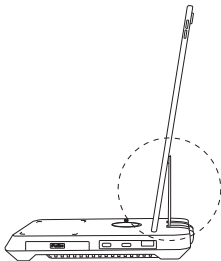

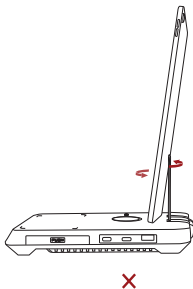
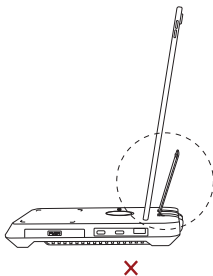

⑥

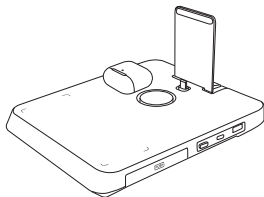

⑦

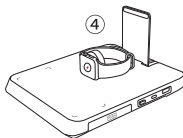
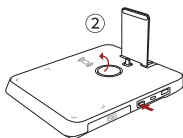
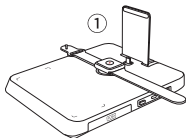

8

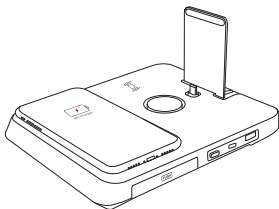

9

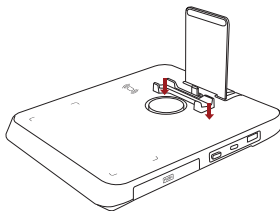

10

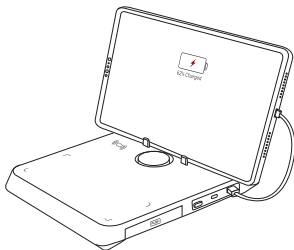

11

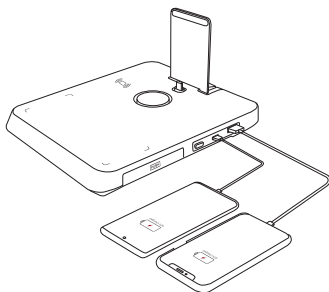

12

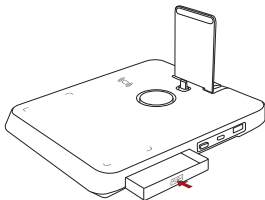

13

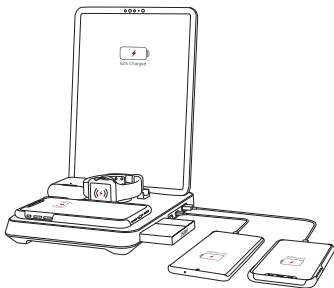



Scan QR code for video instruction.

Warranty

At PITAKA, we are always striving to provide our customers with the best quality products. The PITAKA Air Omni is guaranteed for 12 months from the date of purchase. The Air Omni is warranted to be free of material and functional defects, including wireless charging, under normal use. A defect is defined as an imperfection or flaw during the manufacturing process. Any change or modification of this device will void the warranty. The warranty is non-transferable and covers the original end-user purchaser. PITAKA will only authorize the warranty claim if the products were purchased from an official store or an authorized dealer. For full details regarding warranty terms and exclusions, please visit ipitaka.com/pages/shipping-warranty.

Exclusions

Damages do not include those resulting in abuse of the device, incorrect maintenance, alteration, misuse (including disassembly and drops), abnormal wear and tear, and cosmetic damages that do not affect functionality.

Important!

1. Please use the AC adapter included in this package to charge. If you are using a third-party adapter, please check and confirm whether the voltage is within the applicable range.
2. Do not keep the Air Omni in a high-temperature environment, including direct sunlight.
3. Do not disassemble the Air Omni or attempt to modify it in any way.
4. Do not attempt to power the Air Omni with any connection other than the Type-C connector.

5. All parts have gone through a thorough quality assurance inspection. If you find that your Air Omni is excessively hot, is emitting odor, is deformed, abraded, or is experiencing or demonstrating an abnormal phenomenon, immediately stop all product use and contact the manufacturer.

6. If this Air Omni is intended by the purchaser to be used by a minor, the purchasing adult agrees to provide detailed instructions and warnings to any minor before use. Failure to do so is the sole responsibility of the purchaser, who agrees to indemnify the manufacturer for any unintended use/misuse by a minor.

Customer Service

Tel: +852 9202 6223

Email: support@ipitaka.com

Web: www.ipitaka.com

Legal

iPhone, Apple Watch are trademarks of Apple Inc. in the US and other countries.

The 'Qi' symbol is a trademark of the Wireless Power Consortium. All associated logos and distinctive designs are the property of PITAKA and should be protected under design, trademark and other trade dress regulations.

This product is meant for use only in conjunction with the appropriate device and the steps laid out in this manual. Please consult your device packaging to determine whether this product is compatible with your particular device.

The manufacturer is not responsible for any damages to any device incurred through the use of this product. The manufacturer shall not, in any way, be liable to you or to any third party for any damages you or any third party may suffer as a result of use, intended or unintended, or misuse of this product in conjunction with any device or accessory other than the appropriate device for which this product is designed. The manufacturer will not be responsible for any damages you or any third party may suffer as a result of the misuse of this product as outlined above.

The purchaser agrees to defend, indemnify, and hold the manufacturer harmless for any claims or damages arising from unintended use or misuse, including use with an un-intended device.

The purchaser agrees to defend, indemnify, and hold the manufacturer harmless for any claims or damages arising from unintended use or misuse, including use with an un-intended device.

FCC WARNING

This device complies with part 15 of the FCC Rules. Operation is subject to the following two conditions: (1) this device may not cause harmful interference, and (2) this device must accept any interference received, including interference that may cause undesired operation.

Any changes or modifications not expressly approved by the party responsible for compliance could void the user's authority to operate the equipment.

NOTE: This equipment has been tested and found to comply with the limits for a Class B digital device, according to Part 15 of the FCC Rules. These limits are designed to provide reasonable protection against harmful interference in a residential installation. This equipment generates, uses and can radiate radio frequency energy and, if not installed and used following the instructions, may cause harmful interference to radio communications. However, there is no guarantee that interference will not occur in a particular installation.

If this equipment does cause harmful interference to radio or television reception, which can be determined by turning the equipment off and on, the user is encouraged to try to correct the interference by one or more of the following measures:

- Reorient or relocate the receiving antenna.
- Increase the separation between the equipment and receiver.
- Connect the equipment into an outlet on a circuit different from that to which the receiver is connected.
- Consult the dealer or an experienced radio/TV technician for help.

To maintain compliance with FCC' s RF Exposure guidelines, this equipment should be installed and operated with minimum distance between 20cm the radiator your body: Use only the supplied antenna.

FCC ID: 2ARI5-AO2001

