

# INSTRUCTIONS FOR INSTALLATION AND USE OF THE 9x12 TELESCOPING EASEL (Item #134.12T)

## MATERIAL CONTENTS

- A. 1 Telescoping Assembly with Support
- B. 1 Vinyl-Coated Clamp
- C. 2 Screws
- D. 1 Wing Knob
- E. 1 Upper Panel Shelf
- F. 1 Removable Lower Panel/Canvas Shelf  
(with two holes)

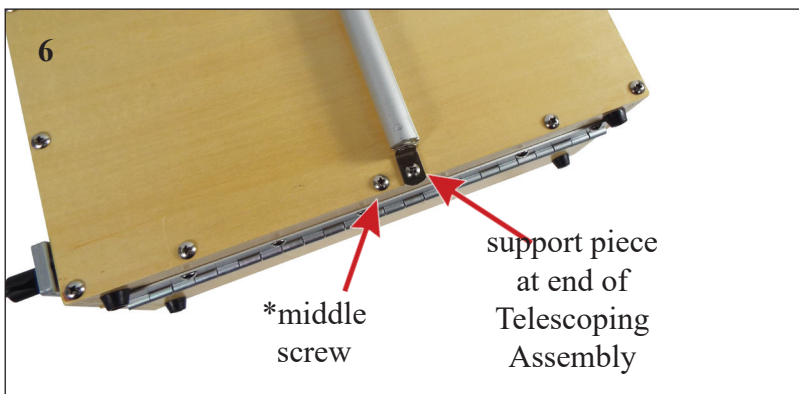
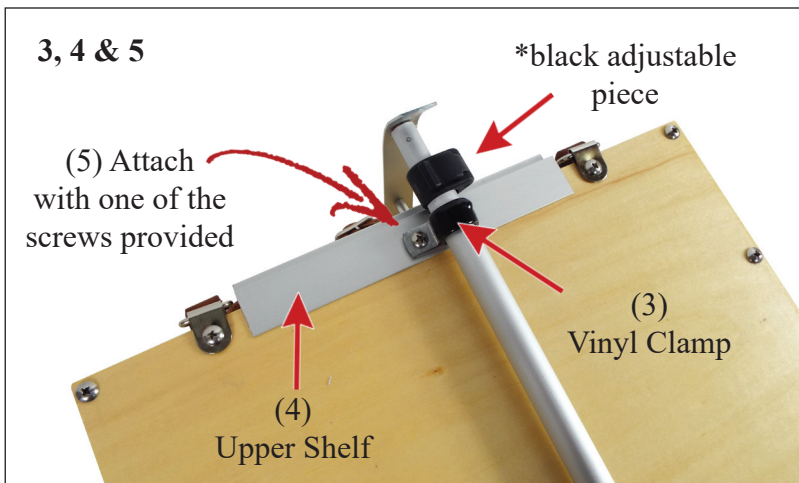
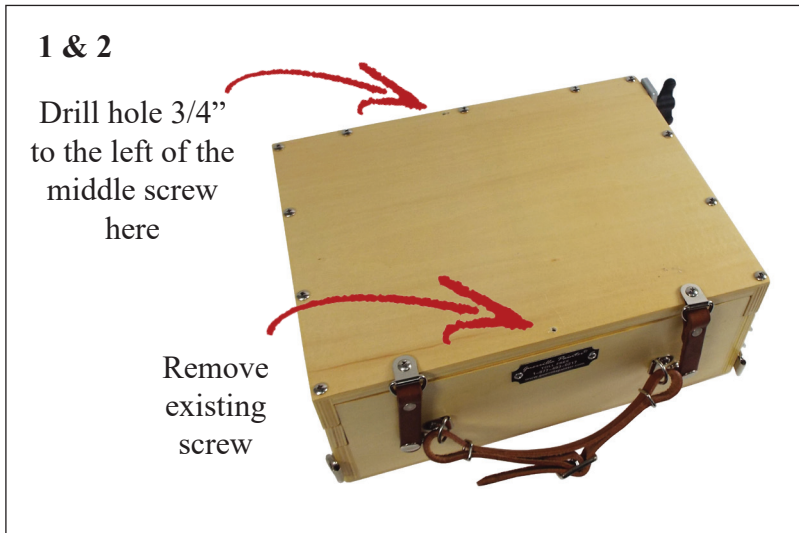
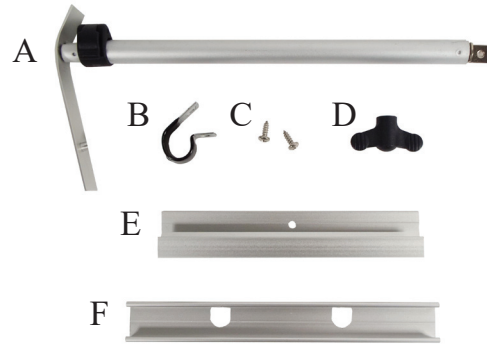

## INSTALLATION

1. Remove the center screw from the long edge of the Guerrilla Box™ lid as shown using a Phillips head screwdriver.
2. Drill a hole 3/4" to the left of the center screw at the bottom lid.
3. Place the **Vinyl-Coated Clamp** on the **Telescoping Assembly** and slide up until it's just below the base of the \*black adjustable piece.
4. Place the Upper Panel Shelf as shown with the hole over the screw hole in the lid.
5. Attach to the box with the screw provided. **Do not over tighten.**
6. Use the second screw to attach the support piece that goes inside the end of the Telescoping Assembly (next to the \*middle screw) using the newly drilled hole. **Do not over tighten.**
7. Replace the **Adjusting Knob** (and bolt if necessary) located on the \*L-bracket on the side of your Guerrilla Box™ with the wing knob as shown this will allow you to make sure the lid is firmly tightened when using large panels or canvases.

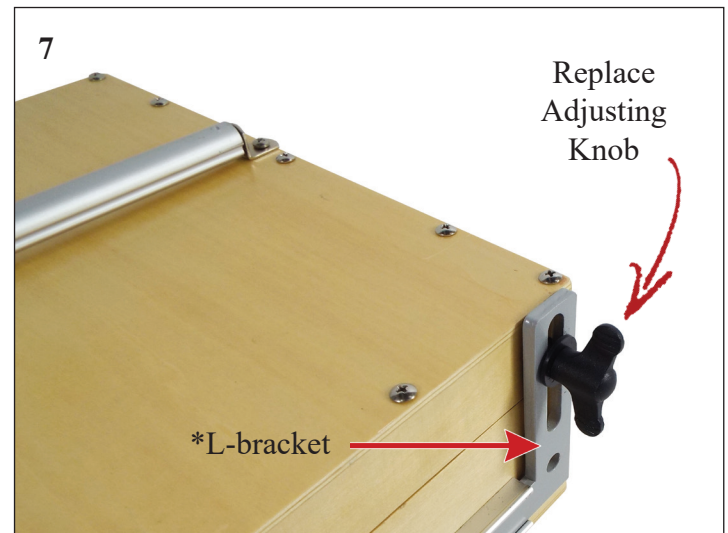

## USE

The Telescoping Easel adjusts easily up and shown using the adjusting knob on the **Telescoping Assembly**. The **Top Panel Holder** can be rotated to use either the short or long end as needed (as shown below).

1. For panels up to 10" tall: You may use the Telescoping Easel to paint on smaller panels up to 10" tall using the **Upper Panel Shelf (1a)** as shown. Use the short end of the **Top Panel Holder (1b)** when painting on smaller panels held in this position.



2. For panels or canvases up to 20" tall: Use the **Removable Lower Panel/Canvas Shelf (2a)** when painting on larger panels or canvases up to 20" tall. Place the panel brackets through the holes in the metal shelf. The shelf will hang at a 45° angle and your panel/canvas will rest on the lower lip of this shelf outside of the frame of the box lid. Use the long end of the **Top Panel Holder (2b)** when painting on larger panels or canvases held in this position.



3. For panels up to 16" tall: Or you may use the Telescoping Easel and the Slip-In Easel (3a) (item #133.12 sold separately) in combination for panels up to 16" tall as shown. Use the long end of the Top Panel Holder (3b) when painting on larger panels or canvases held in this position.

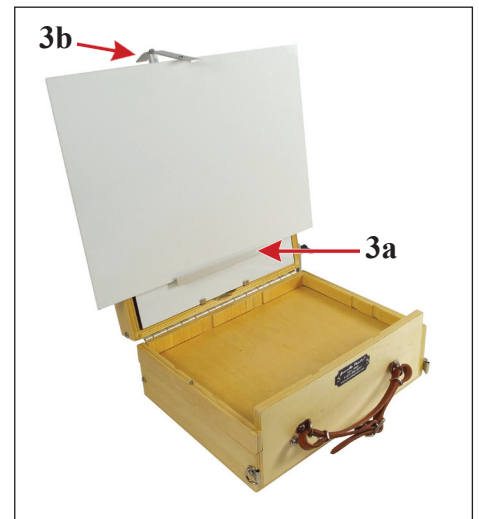
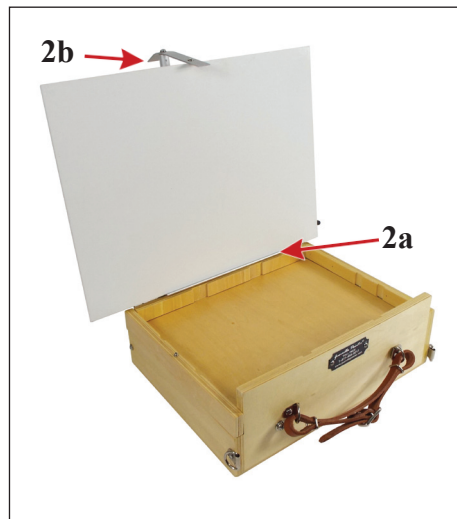

4. When not in use, store the **Telescoping Easel** as show.

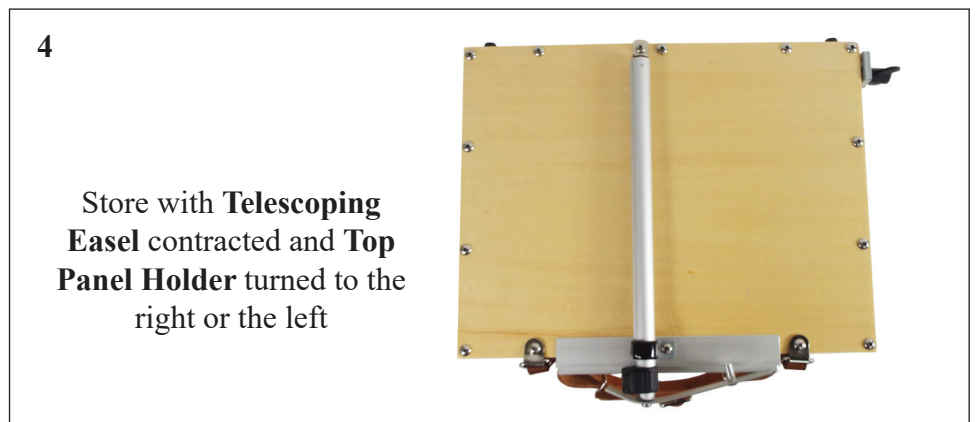

**CAUTION** -- when using the Telescoping Easel and large canvases, make sure that you box and tripod are well secured. We recommend use of a tripod with the capability of carrying 13 or more pounds, with legs adjusted to their broadest stance and used with our Tripod Stone Bag (item #306 sold separately). A wind induced crash, with the added leverage of a large painting, could damage the Telescoping Easel, your Guerrilla Box, your painting--or all three.

© 2019  
Guerrilla Painter, LLC  
1-970-493-0217  
www.GuerrillaPainter.com