

To set up the French Resistance for painting:

- 1) Open the box and tighten the black knobs (A) on the right and left sides of the box.
- 2) Place the metal shelf (B) into the eyelets (C) at the height where you want the base of your panel (depending on your preference and the size of your panel).
- 3) Extend the telescoping easel by pushing the black latch (D) open; close the latch to keep the telescoping easel extended.

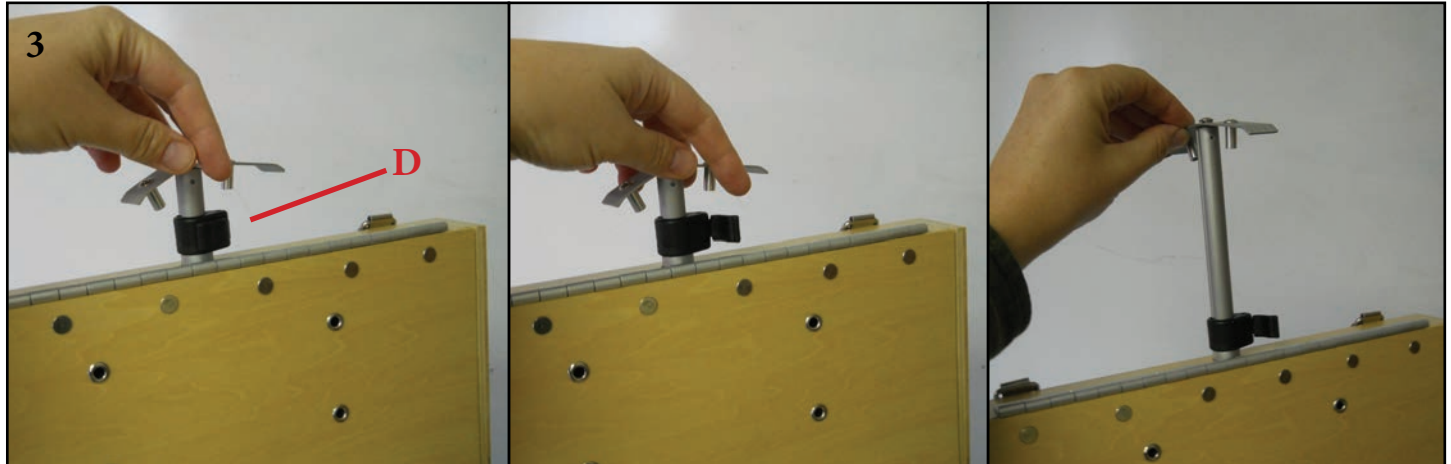

- 4) Place your panel on the metal shelf and bring the telescoping easel down to secure the top of your panel.

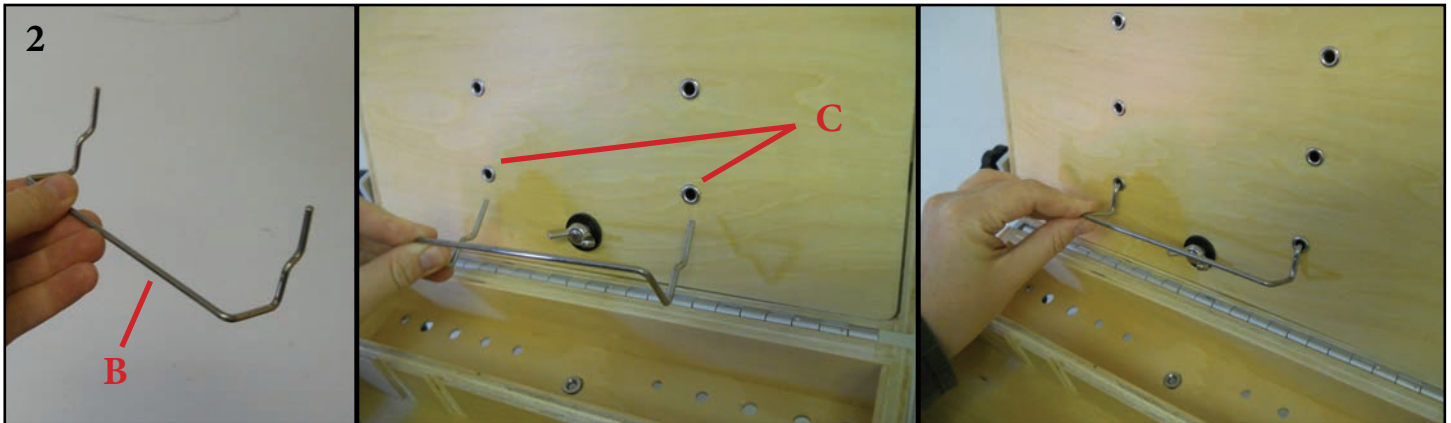
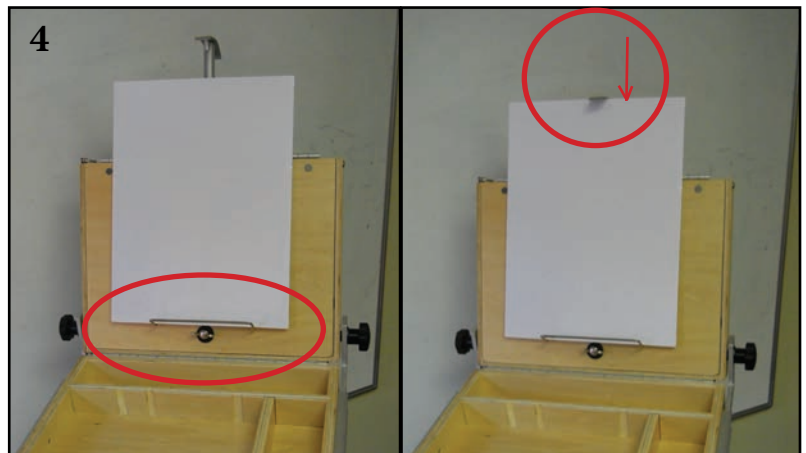

(continued...)

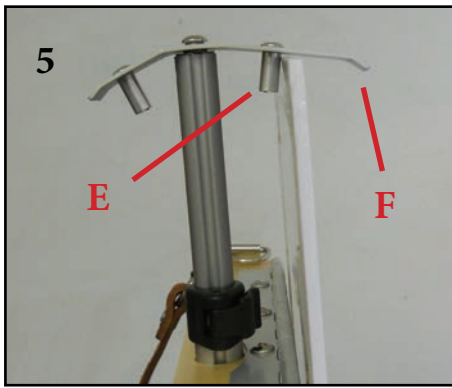

5) Secure your panel between the stand-off (E) and the curve (F) on the long portion of the top of the telescoping easel. Then close the black latch.

6) To close the French Resistance and safely carry your wet panel on the box, you need only close your box, insert the metal shelf into the eyelets on the outside of the lid. Place your panel on the metal shelf and adjust the telescoping easel to secure the top of your panel, now using the shorter portion of the top of the telescoping easel, with the panel secured between the stand-off (G) and the curve (H). *Note: The stand-off gives enough space to protect the wet panel from the side of the box and the curve of the top of the easel prevents the panel from coming loose from it's secured place.*

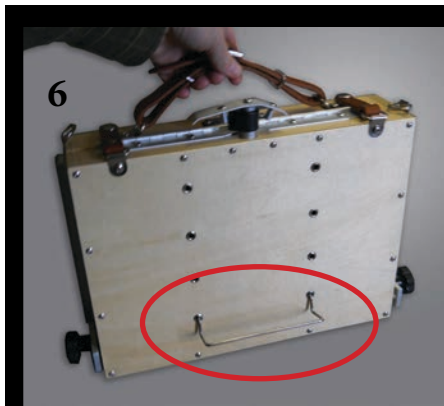

7) Note: You can also paint with your French Resistance set up on a table. Place the metal shelf into the eyelets on the outside of the box, secure the panel with the telescoping easel and adjust the lid to the angle you prefer.

