

 **h2o audio**®



SNOW PRO MULTI-SPORT



WITH **PLAYLIST+**

SNOW & WATERPROOF OPEN EAR HEADPHONES



SNOWBOARD



SKI



CROSS COUNTRY



TABLE OF CONTENTS:

BATTERY

TURN ON/OFF

BUTTON FUNCTIONS

M (MIDDLE / MODE BUTTON)

+/- BUTTONS

DOWNLOAD VIA USB

MEMORY MODE - FOLDERS & SHUFFLE

BLUETOOTH CONNECTION & PAIRING

PLAYLIST+

HOW TO WEAR

SNOW SPORTS WITH SNOW PRO

SWIMMING WITH SNOW PRO

SUPPORT & TROUBLESHOOT





BATTERY

HOW TO CHARGE

Connect the 4 pin USB cable to the SNOW PRO (It will attach only 1 way with the magnets).

- **BATTERY CHARGING:** Red LED
- **BATTERY FULL:** Blue LED
- **FULL BATTERY PLAY TIME:** ~5 hrs

When you turn **ON** the SNOW PRO you will hear the current battery level status.



POWER ON/OFF

TURN ON/OFF:

Press and hold the middle button for 3 seconds.

To **RESET** - hold for 12 sec

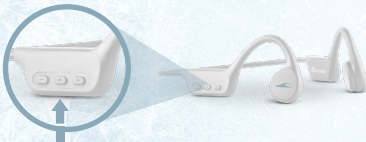



BUTTON FUNCTIONS

+/- BUTTONS

VOLUME UP/DOWN: 1-Click

SKIP SONG: Hold + or - to skip to next or previous track.

SKIP FOLDER: Quick double click to advance to next/previous folder (only in memory play mode)

PLAYLIST+

Quick double-press + button to start/stop Loading (Only in Bluetooth Mode)

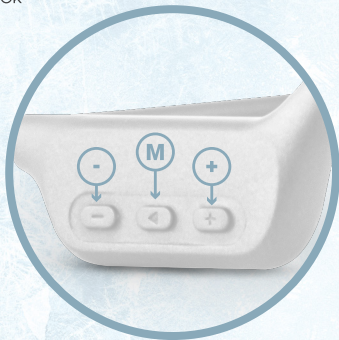



BUTTON FUNCTIONS continued

M (MIDDLE/MODE BUTTON)

POWER ON/OFF: Hold (3 sec) to Power ON/OFF

PLAY/PAUSE: 1-Click to Play/Pause audio

MODE CHANGE (Memory <-> Bluetooth):

2-Click (Double Click)

RESET: Hold for 12 seconds to Reset. Make sure headphones are off. After 12 seconds you will see the LED light blink 3 times.

SHUFFLE MODE:

3-click (triple click) to turn on/off

(Only in memory mode)

SIRI/VOICE ASSISTANT

Long Press **(Only in Bluetooth Mode)**

ANSWER INCOMING CALL

1-click **(Only in Bluetooth Mode)**



DOWNLOADING MUSIC VIA USB

- Make sure the battery is charged. If battery is too low the USB connection may fail.
- Turn OFF the headphones.
- Then, connect the USB cable to the SNOW PRO 4-pin connector and then to the computer USB port. DO NOT BUMP the headphones while it is connected.
- After connecting, wait a few moments until the computer recognizes the device.
- SNOW PRO will appear as a memory drive or USB Memory device in the File Explorer (Windows) or Finder App (MAC).

IMPORTANT NOTE: Subscription based music like Spotify, Apple Music, Pandora, etc. are copyright protected and can NOT be copied to the memory via USB. See PLAYLIST+ feature.

- Find the music files on your computer. The SNOW PRO can play .MP3, .WMA and .M4A (Apple iTunes) music.



DOWNLOADING MUSIC VIA USB

- Select or Copy the music files and then copy/paste or 'drag & drop' the files to the SNOW PRO
- The file transfer will start. Do not disconnect until all files have been copied.
- To remove or delete files on the SNOW PRO - simply select the files in the SNOW PRO memory and Delete them or drag to Trash.
- To disconnect it from the Computer, click Eject the SNOW PRO or simply disconnect it.

TROUBLESHOOT USB CONNECTION

Inspect the USB cable – Make sure the pins are not stuck and moving, the 2 magnets are push down all the way inside the cable.

If you are having trouble with the USB connection, disconnect the SNOW PRO from the computer, power off SNOW PRO and restart the computer. After your computer has done a full restart – try to connect again. You can also try a different USB port. Make sure your SNOW PRO battery is charged. You can also reset the SNOW PRO headphones. Turn Off the headphones and the hold the Mode button for 10 sec. You will see a 3 blinking of the LED light.



MEMORY / BLUETOOTH PAIRING

MEMORY MODE (FOLDERS & SHUFFLE)

- The music can be organized into different folders.
- You will have 2 added folders, LOAD and FAVORITE. The LOAD folder will keep any audio you have loaded via PLAYLIST+.
- Skip to next or previous folder = Quick DOUBLE-CLICK **+/-** button.
Turn on Shuffle Mode: Quick 3-click **M** button to turn on / off shuffle mode.

BLUETOOTH CONNECTION & PAIRING

- Start with the SNOW PRO headphones OFF.
- Power ON the headphones (press middle button for 2 sec). You will hear the start up prompts and battery level.
- Change the MODE to BLUETOOTH MODE by a double clicking of the middle M button. The double click needs to be fast.
You should then hear the audio prompt, "Bluetooth Mode".



MEMORY / BLUETOOTH PAIRING

- Go to the Bluetooth Settings in your phone or smart watch. Look for the SNOW PRO name and select it. This will complete the pairing and you will hear “Connected” prompt. A blue blinking LED light will also indicate that the Bluetooth is connected.

****PLEASE NOTE****

Bluetooth connection has a range of approx. 10m/30ft. in air and 10cm/2 inches under water. Bluetooth does not penetrate water (due to laws of physics)

PLEASE SEE PLAYLIST+ and SWIMMING WITH SNOW PRO for more .



PLAYLIST+

PLAYLIST+ is a new feature, that allows you to load any streaming music into your headphones, and listen to it offline, uninterrupted, underwater, anywhere, with no phone needed. With PLAYLIST+, you can truly take your streaming music anywhere and leave your phone home. ANY audio you play over Bluetooth can be loaded into PLAYLIST+. PLAYLIST+ audio is stored in the LOAD folder of your SNOW PRO headphones.

TO START ADDING AUDIO TO YOUR PLAYLIST+

1. Enter Bluetooth mode and pair the headphones with your smartphone.
2. Start your favorite music (you should hear it from the headphones.)
3. Start/Stop LOADING: Quick Double-Click the + button. A BLUE LED will blink rapidly indicating the LOAD is active.

While loading, the SNOW PRO will listen to the audio and store it. Make sure your play volume is set high enough. Any changes in volume will also be in the loaded audio.

You can also charge the SNOW PRO battery while it is LOADING. Make sure it is connected to a wall charger (not a computer).

4. To Play the PLAYLIST+: Enter the Memory Mode and skip (2-click + button) to the LOAD Folder.



HOW TO WEAR

The **SNOW PRO headphones** are **OPEN EAR** and use Bone Conduction. The Speakers are sitting **IN FRONT** of the ear vs in the ear, leaving your ear open for other surrounding sounds.

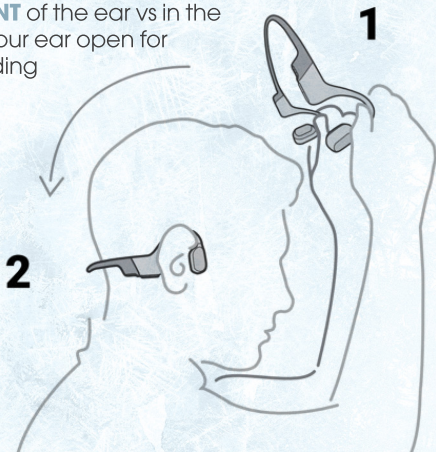



HOW TO WEAR

SNOWBOARDING & SKIING WITH SNOW PRO

When biking or running, you can use either the Bluetooth or the Memory Mode.

- The memory mode will play music from the internal memory without the need of any other devices. i.e. you can leave your phone home.
- You can also listen to PLAYLIST+ audio without your phone.
- The Bluetooth mode will receive audio from a device you are carrying. Make sure you have paired the headphones with the device.

SAFETY TIP

It is important to adjust the audio level so that you are able to hear ambient sounds from around you – cars, traffic, etc. The SNOW PRO has an open ear design that will allow you to hear what's around you easier.



HOW TO WEAR

SWIMMING WITH SNOW PRO

WHICH MODE SHOULD I USE?

When swimming, we recommend using the Memory Mode – as this will provide you the uninterrupted sound without the need of additional devices.

USE PLAYLIST+ LOAD MUSIC FROM BLUETOOTH AND LISTEN TO IT UNDERWATER!

If you have a music enabled smart watch like the Apple Watch – you can use this as the source for your audio while swimming. However, you need to place the smart watch within 2-3 inches from the headphones. Put the watch under your swim cap or use the H2O Audio Apple Watch Clip (sold separately).

NOTE: The Bluetooth range under water is only a few inches (due to laws of physics)

HOW TO WEAR DURING SWIMMING:

Use your swim goggle strap or swim cap over the headphones to better keep the headphones in place.



SUPPORT & TROUBLESHOOT

TO RESET THE SNOW PRO HEADPHONES:

Make sure the power is **OFF**, then press and **HOLD** the Power button for 12 seconds. This will reset the headphones.

ANY ISSUES?

Please do not hesitate to contact us at
SUPPORT@H2OAUDIO.COM

Please note that your product has a
1 YEAR WARRANTY.

H2OAUDIO.COM



WE ARE HAPPY TO HELP :)

FOR MORE TIPS & VIDEOS

Please visit the H2O
Audio page.



SCAN ME

h2oaudio.com/pages/h2o-tri-headphones

SUPPORT:

For any issues or questions, please contact us directly.

Email: support@h2oaudio.com

Web: h2oaudio.com

DOWNLOAD THE FREE H2O AUDIO APP.

Below are the QR codes for your
iOS or Android devices.

