

Do it yourself!  
**DIY**



## WIFI IP CAMERA WITH NIGHT VISION

Monitor your home and loved ones from anywhere in the world.

## 13 SIMPLE STEPS TO CONFIGURE YOUR NEW TRUST SMART HOME STAND ALONE IP CAMERA for Android users



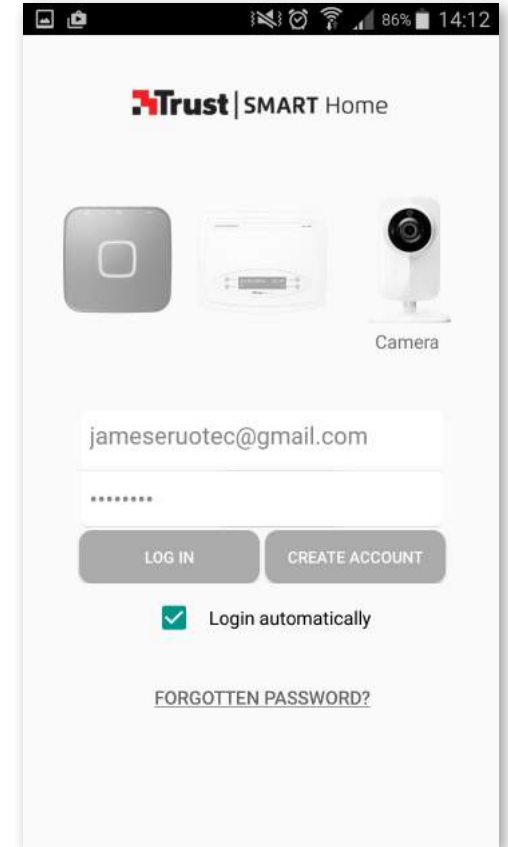
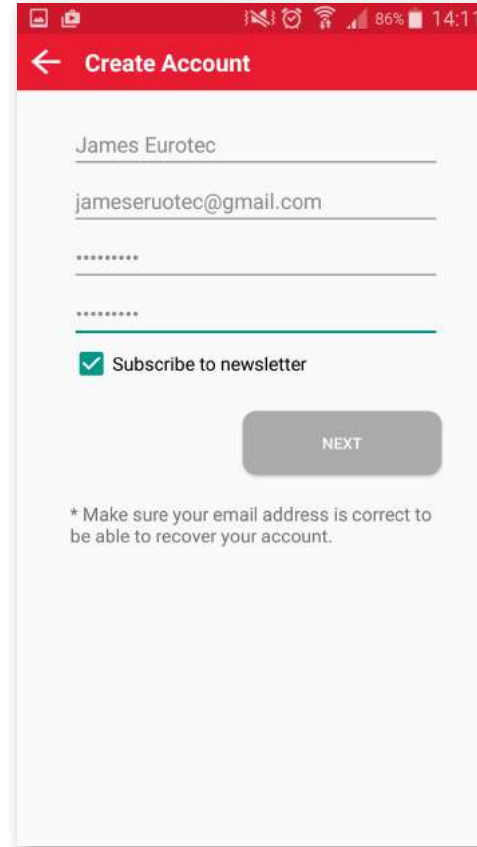
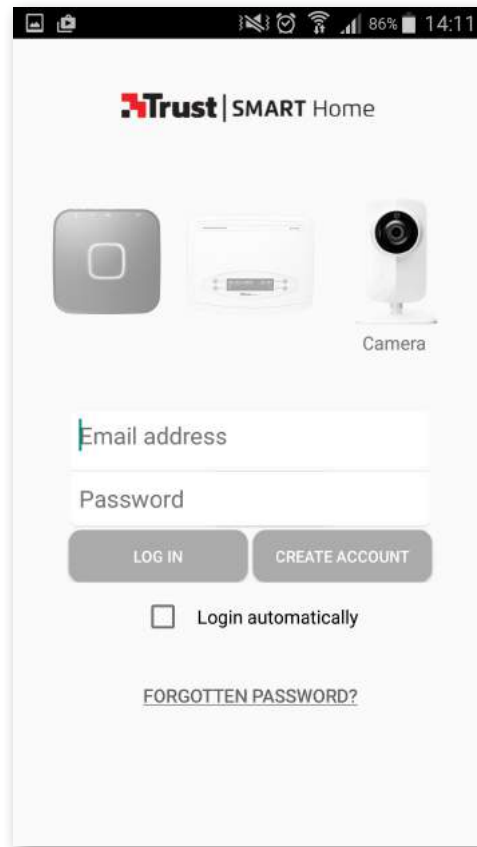
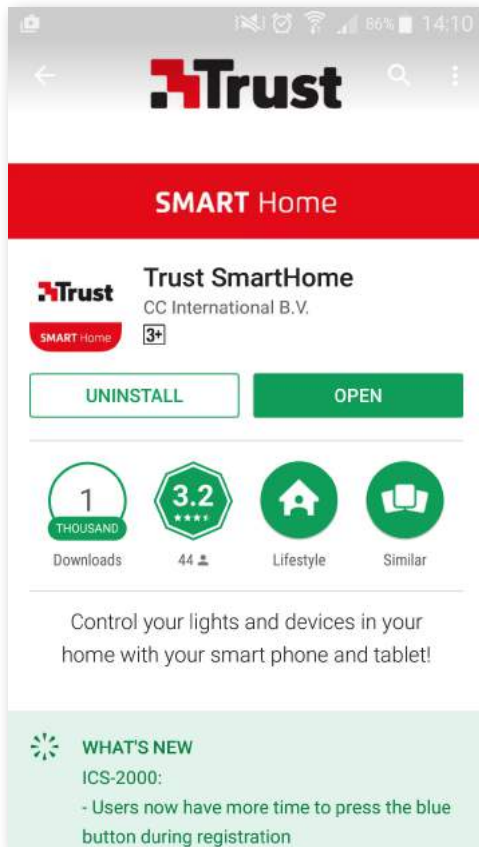

**STEP 1:**

Download the free Trust SmartHome app from the App Store and then open (whilst the app is downloading set the ipcam hardware up.)

**STEP 2:**

Create a new account (this can be used for ICS-2000 at a later date)

**STEP 3:**

Enter your account details before clicking 'next'.

**STEP 4:**

Select the camera icon and enter your new details before proceeding with login.

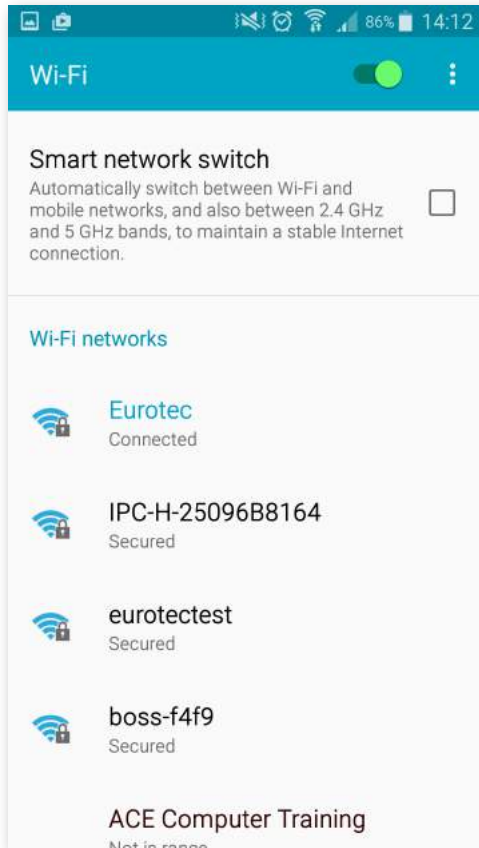

**STEP 5:**

After login you will need to open wifi settings on phone and select the temp Ipcam local wifi (each cam has a unique IPC-H-##### number)

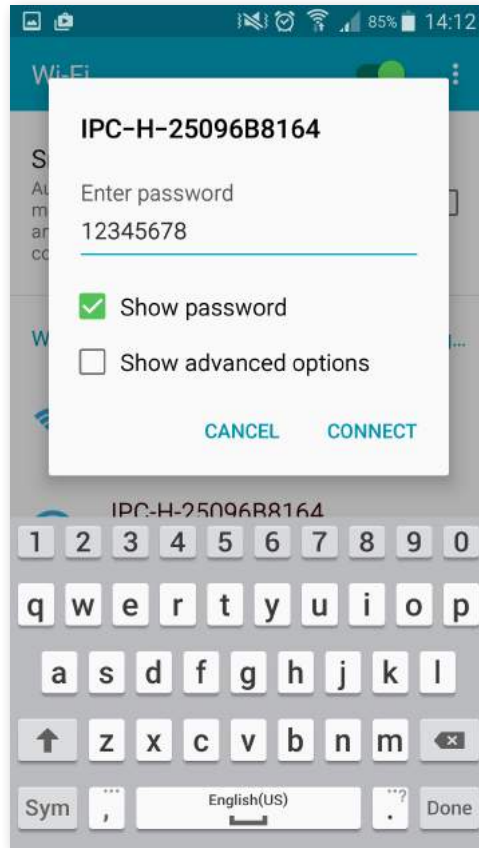

**STEP 6:**

The password for the temp local cam wifi is 12345678

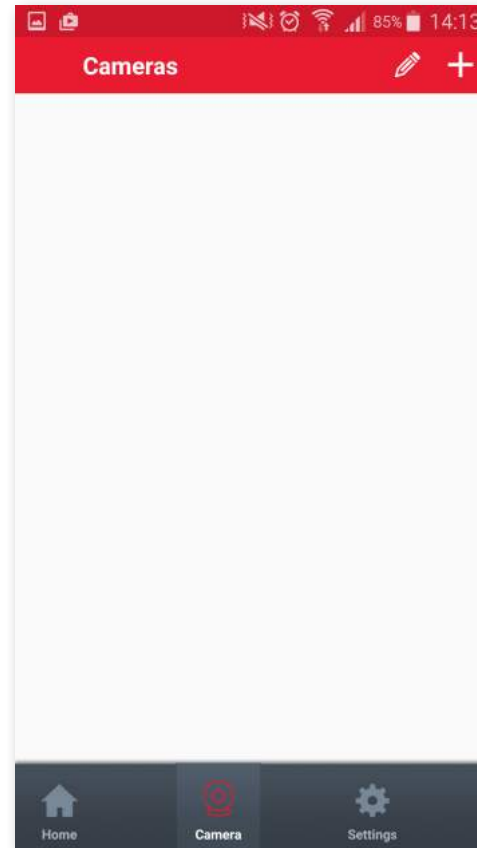

**STEP 7:**

After connecting to the temp cam wifi go back to the app and click the plus

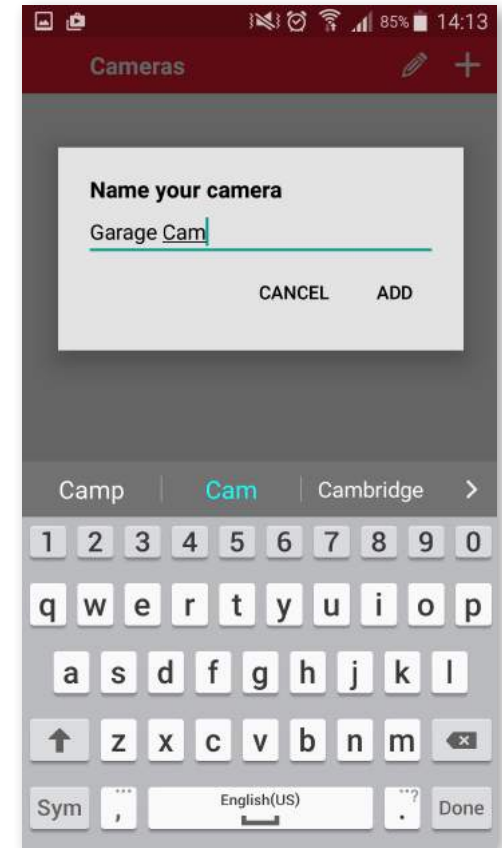

**STEP 8:**

Enter the camera name and proceed with 'ADD'.

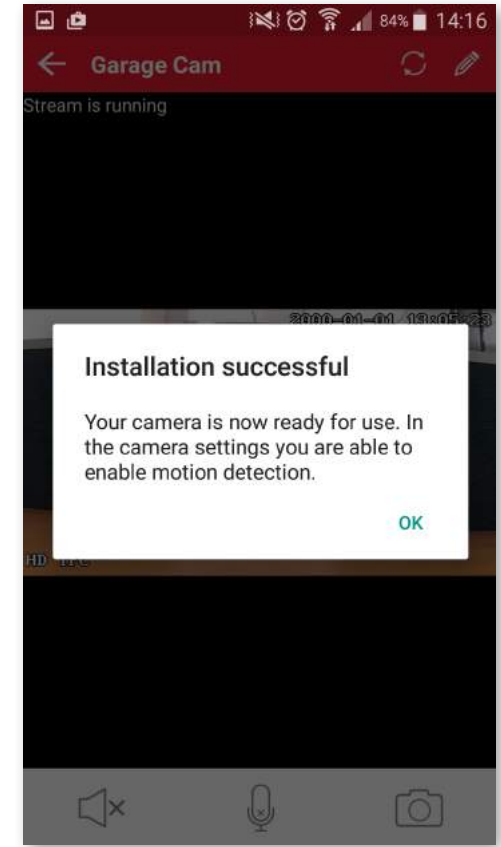
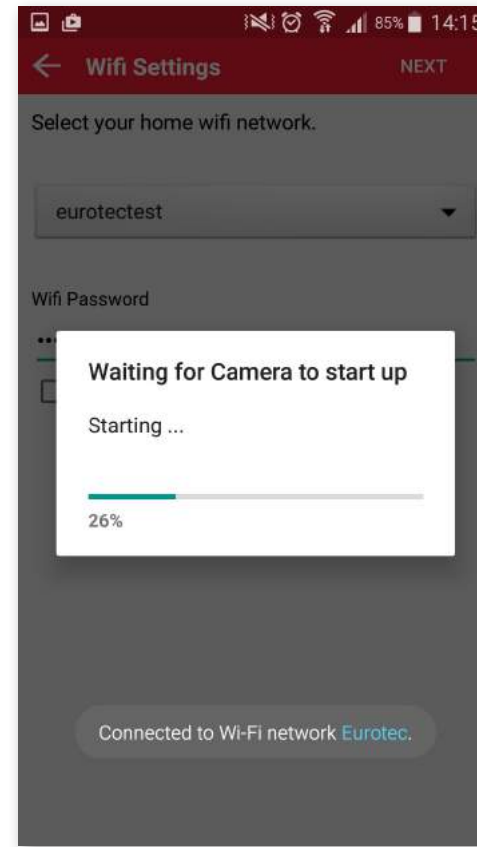
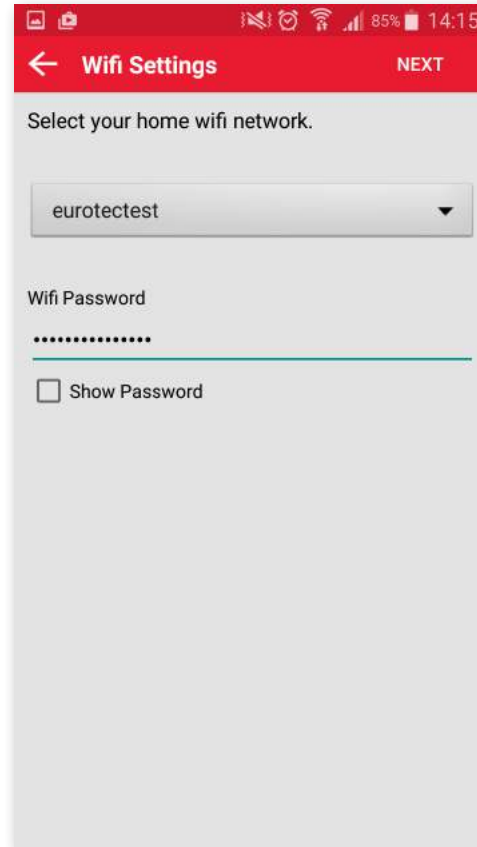

### STEP 9:

You will now have a live stream of the camera confirming connection via the temp local wifi network. Select 'Next'.

### STEP 10:

Now we will select your home wifi network from the drop down tab and enter wifi password (double check details before selecting next)

### STEP 11:

The camera will now restart and connect to the home network (the temporary wifi will be disabled and phone/tablet will reconnect to home wifi).

### STEP 12:

Success!! You will see the following message if you have done the set up correctly (if not you will need to start at step 5 and retry (occurs if the wifi password is incorrect).

**STEP 13:** The IPCAM is now connected to home wifi network and accessible via the app when you are away (keep an eye on that sneaky pet from the office).