



Version 1.0

Visit [www.trustsmarthome.com](http://www.trustsmarthome.com)  
for the most recent user manuals

# STARTER SET WIRELESS SWITCHING

## APA3-1500R STARTER SET WIRELESS SWITCHING

### COMPATIBILITY

This set can be combined with all TRUST SMART Home transmitters and receivers.

### FUNCTIONALITY

3 Mains socket switches to switch lights or electronic devices on/off up to 1500 Watt with the included remote control

### TECHNICAL SPECIFICATIONS RECEIVER

Power supply input	220-240 VAC 50 Hz
Maximum load	1500 Watt
RF frequency	433,92 MHz
RF range	Up to 30m indoor/ 70m outdoor (optimal conditions)
Memory addresses	3

### TECHNICAL SPECIFICATIONS TRANSMITTER

Battery	1x 3 V CR2032 lithium
RF frequency	433.92 MHz
RF range	Up to 30m indoor/ 70m outdoor (optimal conditions)
Channels	3 + Group off

### WIRELESS RADIO SIGNAL

- The 433.92 MHz radio signal passes through walls, windows and doors.
- Indoor range: up to 30 m. Outdoor range: up to 70 m. (optimal conditions)
- The range is strongly dependent on local conditions, such as the presence of metals. For example, the thin metal coating in Low-emissivity (Low-E) glass has a negative impact on the range of radio signals.

Read this manual carefully. Not following them may be dangerous and faulty installation will invalidate any warranty that may apply to this product.

### **MAXIMUM LOAD**

Never connect lights or equipment that exceed the maximum load of the receiver, as it can result in defects.

### **SHOCK HAZARD**

Exercise caution when installing a receiver. Voltage may be present, even when a receiver is switched off.

### **BATTERY**

Remove the battery if the product will not be used for an extended period. Extreme temperatures reduce the capacity and lifetime of the battery. Dispose of batteries according to local regulations. Please recycle when possible.

### **LIFE-SUPPORT**

Never use TRUST SMART Home products for life-support systems or other applications in which equipment malfunctions can have life-threatening consequences.

### **INTERFERENCE**

All wireless devices may be subject to interference, which could affect performance. The minimum distance between 2 receivers should be at least 50 cm.

### **REPAIRING**

Do not attempt to repair this product. There are no user-serviceable parts inside.

### **WATER-RESISTANCE**

This product is not water-resistant. Keep it dry. Moisture will corrode the inner electronics and can result in a short circuit, defects and shock hazard.

### **CLEANING**

Use a dry cloth to clean this product. Do not use harsh chemicals, cleaning solvents, or strong detergents.

### **HANDLING**

Do not drop, knock, or shake the device. Rough handling can break internal circuit boards and fine mechanics.

### **ENVIRONMENT**

Do not expose the product to excessive heat or cold, as it can damage or shorten the life of electronic circuit boards.

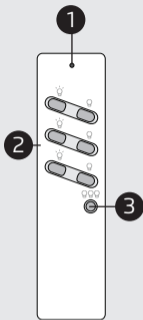

### Remote control

- (1) LED-indicator
- (2) ON/OFF buttons\*
- (3) Group OFF button\*

\*When using an OFF button or the group OFF button the connected light(s)/ device(s) is/are switched off and the receiver is put in stand-by.

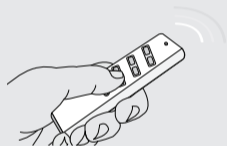

### Assigning different channels to different receivers

When you would like to control multiple receivers independently, you can assign a desired channel to a specific receiver like depicted above.

### Switching multiple receivers to stand-by with the group OFF function

By using the group OFF function (🔴🔴🔴) you can switch the connected receivers to stand-by. The connected lights and devices will be switched OFF.

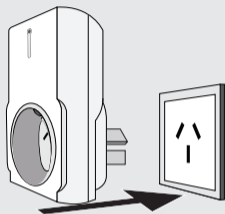
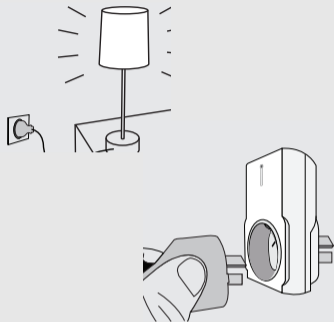

### 1. Connect lamp/device

First check if the lamp or device is turned on. Then plug the lamp or device into the receiver. Do not exceed the maximum load: 1500 W

### 2a. Assign transmitter code

Placing the receiver into a socket will automatically activate the learn-mode for 5 seconds. The LED-indicator on the receiver will blink slowly. To reactivate the learn-mode, remove the receiver from the socket, wait 10 seconds, then insert the receiver into the socket again.

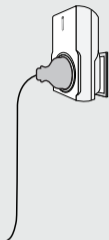
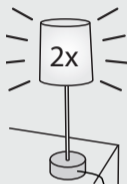
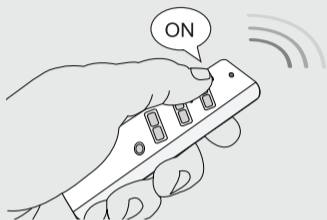

**2b.**

Send an ON-signal with any TRUST SMART Home transmitter while the learn-mode is active, to assign the code to the receiver's memory.

**2c.**

The receiver will switch on/off 2 times to confirm the code has been received. The receiver can store up to 3 different transmitter codes in its memory. The memory will be preserved when the receiver is moved to another socket or in case of power failure.

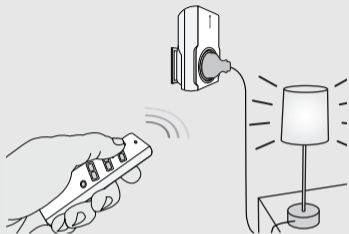

### **3. Manual operation with a transmitter**

1. Send an ON-signal to switch the receiver on.
2. Send an OFF-signal to put the receiver in stand-by.



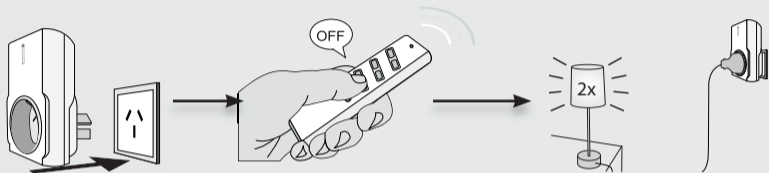



### Single code delete

1. Insert the receiver into the socket to activate the learn-mode for 5 seconds.
2. While the learn-mode is active, press the [OFF] button of a specific transmitter.
3. The receiver will switch on/off 2 times to confirm code deletion.

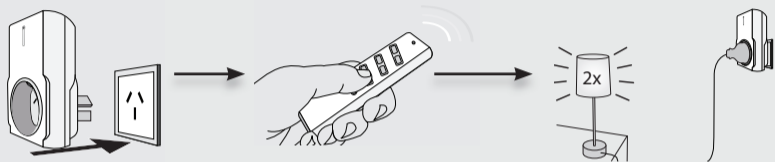
## APA3-1500R STARTER SET WIRELESS SWITCHING



### Full memory delete

1. Insert the receiver into the socket to activate the learn-mode for 5 seconds.
2. Press the  button on the APA3-1500R remote while the learn-mode is active.
3. The receiver will switch on/off 2 times to confirm code deletion.

 Trust International B.V. declares that this product is in compliance with the essential requirements and other relevant provisions

 WEEE: If possible, dispose of this product at a recycling center. Do not dispose of this product with the household waste.

### **Warranty**

This product is covered by the legal warranty that applies to your country and it begins on the day of purchase. For additional information, visit: [www.trustsmarthome.com/warranty/](http://www.trustsmarthome.com/warranty/)

### **Copyright**

The contents of this user manual are subject to copyright protection. Without prior written permission, reproducing or copying is prohibited. Information in these documents is subject to change without prior notice. Check [www.trustsmarthome.com](http://www.trustsmarthome.com) for updates.

### Declaration of conformity

Trust International B.V. declares that the TRUST SMART Home product:

model:	APA3-1500R STARTER SET WIRELESS SWITCHING
item number:	75066
intended use:	indoor

is in compliance with the essential requirements and other relevant provisions of the following directives: EMC Directive, Low Voltage Directive and R&TTE Directive.

The product is compatible with the following norms/standards:

AS/NZS 4268:2012 + A1:2013  
CISPR 15:2013  
AS/NZS CISPR 15:2011  
ERHE Standard: 2003  
ARPANSA: MELRF - 3kHz to 300GHz  
AS/NZS 3122: 2005 (Fifth Edition)  
AS/NZS 3197: 2005 (Second Edition) + Amendment  
No. 1: 2007 + Amendment No. 2: 2012

Manufacturer/Authorised representative,



H. Donker, Procurement Director  
Dordrecht, 28 October 2014

**EUROTEC** People • Technology • Solutions  
HVAC • Refrigeration • Electrical • Measurement

**Trust International B.V.**  
Laan van Barcelona 600  
3317 DD DORDRECHT  
THE NETHERLANDS  
FAX: +31 (0)78-6543229  
www.trust.com