

Trust | SMART Home

SECURITY PLUS-LINE
ALSIR-2000

USER MANUAL
MULTI LANGUAGE



Item 71112 Version 1.0
Visit www.trust.com
for the latest instructions

ALSIR-2000 SIREN

1

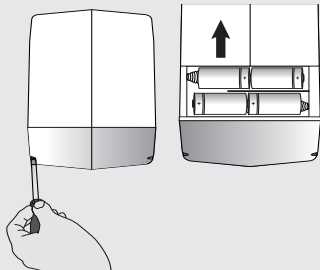

2

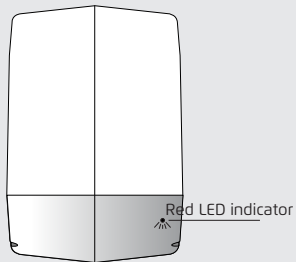

3

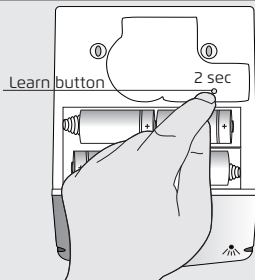

4

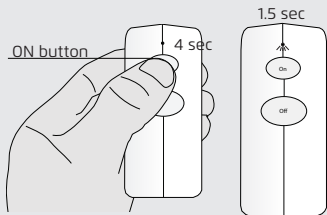

5

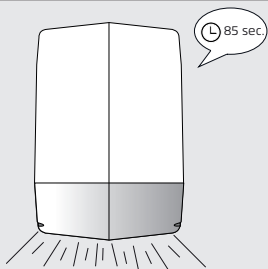

6

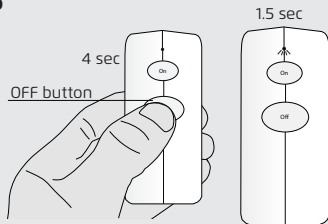

7

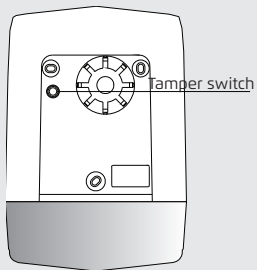

8

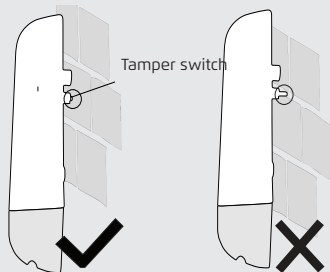

9

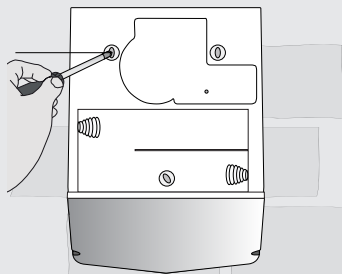

10

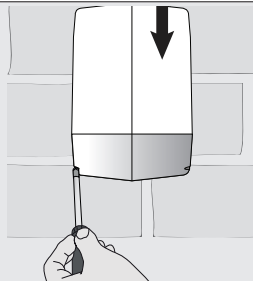

11

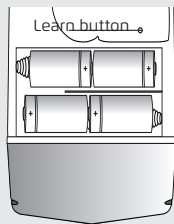

12

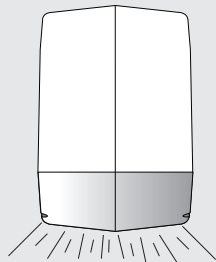

1. Place batteries

Open the Siren by unscrewing the two screws beneath the light cap. When the screws are removed the cap of the Siren can be slid open. When the cap of the Siren is slid open place 4x Alkaline D type 1.5V battery in the Siren. Observe the correct polarity of the batteries. When the battery is low the Siren will give 1 beep every 5 seconds while entering arm/disarm mode for the duration of 3 minutes.

2. LED indicator

The Siren has a LED indicator in the light cap. The LED behaviour is as followed.

Confirm pair: LED will blink 5 times

Confirm unpair: LED will blink 5 times

Learn mode: LED will blink for 15 sec.

3. Learn mode

When the Siren is disarmed slide open the cap and press and hold the Siren learn button for about 2 seconds to enter learn mode. The LED of the Siren will be blinking (in the light cap). The learn mode lasts 15 seconds. While in learn mode press the SET button on a sensor to pair it with the Siren (check manual of the sensor how to pair it). The LED of the Siren will flash quickly 5 times to confirm the pairing was successfully. Close the cap of the Siren.

4. Arm the ALSIR

To arm the Siren press and hold the ON button for 4 sec on the ALKCT-2000.

If the Siren is armed successfully the LED on the ALKCT will light up for 1.5 seconds.

5. Walk-out time

When the Siren is armed there is a 85 sec walk-out time. Within these 85 sec the system checks all the sensors if they are responding and it is possible to leave the building without triggering the alarm. When at the beginning of the walk-out time a window or door is open the alarm will go off for 20 sec reminding that one of the doors or windows isn't closed. After the window or door sensor is closed the alarm will stop and continue in armed mode.

6. Disarm ALSIR

To disarm the Siren press hold the OFF button for 4 sec on the ALKCT-2000.
If the Siren is disarmed successfully the LED on the ALKCT will light up for 1.5 seconds.

7. Tamper switch

The Siren contains a tamper switch. This is a switch that prevents the Siren from being moved when it is armed. The tamper switch is pressed when the Siren is mounted on a wall or placed on another flat surface. When the Siren is moved and it is armed the tamper switch will activate the alarm immediately.

8. ALSIR placement

When placing the Siren on a wall keep attention that the tamper switch isn't placed on a groove or crack in the wall. Make sure that the tamper switch is placed on a location of the wall where it is firmly pressed

9. Mount the ALSIR

To mount the Siren slide the cap off (see step 1) and screw the casing with screws on a flat surface according to the screwholes. (Screws are included). Keep attention that the tamper switch is pressed to the surface after mounting the Siren.

10. Close the ALSIR

Place the batteries in the Siren (see step 1) and slide the cap back on. Screw the screws back in to secure the cap. When the Siren is triggered by a sensor it will flash and sound the alarm for approximately 4 minutes.

11. Delete all paired devices

To delete all the devices that are paired with the Siren press the Siren learn button for 2 seconds until the LED is blinking. Release the button and press the button for another 6 seconds. The LED will begin to flash quickly. Release the learn button and press it again for 1 sec to delete all paired devices.

12. ALSIR flash behaviour + sound

Siren alarm: Siren will flash + sound for 4 min

Low battery: Siren will flash + sound if alarm active

Door/window open in walk-out time: Siren will flash + sound for 20 sec when the Siren is armed

Trust | SMART Home

SECURITY PLUS-LINE
ALSIR-2000

IMPORTANT INFORMATION
MULTI LANGUAGE



Item 71112 Version 1.0
Visit www.trust.com
for the latest instructions

ALSIR-2000 SIREN

Read these simple instructions. Failure to follow these instructions can be dangerous. Incorrect installation will void any warranty on this product.

COMPATIBILITY

The Siren works with the ALKCT-2000, ALMST-2000, ALMDT-2000 and ICS-2000

FUNCTIONALITY

Siren for alarming purposes when a sensor is triggered.

SMARTPHONE/TABLET FUNCTIONS

By combining this product with a sensor and the OCTOPUS Control station, you can also set your alarm on / off via your tablet and / or smartphone and receive push notifications when you are not at home. For more information visit trust.com/71110

TECHNICAL SPECIFICATIONS

- | | |
|--------------------------|--|
| • Battery | 4x Alkaline D type 1.5V batteries (not included) |
| • Battery life | 18 months stand-by |
| • Battery low indication | Siren will flash and beep every 5 sec while entering arm/disarm mode |
| • Frequency | 868 MHz 2-way communication |
| • RF Range | Up to 120 m (under optimal conditions) |
| • Waterresistant | IP44 |

WIRELESS SIGNAL

- The 868 MHz signal passes through walls, windows and doors.
- Range up to 120 m (under optimal conditions).
- The range depends on local conditions, such as the presence of metals. The metal particles in for example, double glazing (HR glass), can provide a reduction in the range of wireless signals.
- There may be restrictions on the use of this device outside the EU. Check, if applicable, whether this device meets local regulations.

Legal information

CE: Trust declares this device complies with the Directives as listed in Section 2 of this document.
WEEE: Dispose of the device at a recycling centre. More information: www.trust.com
Warranty information: www.trust.com/warranty

BATTERY

Remove the battery from the device if it is not used for a long time. Extreme temperatures reduce the capacity and lifetime of the battery.

Siren will flash and beep every 5 sec while entering arm/disarm mode. Batteries should not be chopped into pieces or burned. Dispose of batteries according to local regulations. Deliver them for the possibility to reuse. Do not throw batteries away with the normal household waste.

LIFE SUPPORT

Never use Trust SmartHome products for life support systems or other applications where failures can have life-threatening consequences.

INTERFERENCE

Interference can affect the operation of all broadcast transmitters and receivers negatively. The distance between 2 receivers or transmitters should be at least 50 cm.

REPAIRS

Do not try to repair this product yourself. The device contains no serviceable parts for the user.

WATER-RESISTANT

This product is IP44 water-resistant. Make sure the screws in the light cap are fasten tight.

CLEANING

Clean this product with a dry cloth. Do not use harsh chemicals, cleaning solvents or strong detergents.

HANDLING

Do not drop the device, bump the device against something or shake it. Rough handling can damage internal circuit boards and fine mechanics.

MEMORY

The Siren can save up to 16 devices in its memory

ENVIRONMENT

The product should not be exposed to extreme heat or cold. This can damage the circuit boards and batteries or shorten its life.

DISCLAIMER

This product is a basic deterrent against intruders. However, it remains the responsibility of the end-user to adequately protect their home against break-ins. Therefore Trust cannot be held responsible or liable for any damages resulting from break-ins, trespassing, unauthorized access or vandalism.

CE Declaration of conformity

Trust International B.V. declares that the TRUST SMARTHOME-product:

model:	ALSIR-2000 Siren
item number:	71112
intended use:	Indoor/Outdoor

is in compliance with the essential requirements and other relevant provisions of the following directives: EMC Directive (2014/30/EU), Low Voltage Directive (2014/35/EU), ROHS Directive (2011/65/EC), R&TTE Directive (1999/5/EC). The product is compatible with the following norms/standards:

EN 300-220-1 V2.4.1 (2012)	EN 55014-1 : 2006+A1 : 2009+A2: 2011
EN 300-220-2 V2.4.2 (2012)	EN 55014-2: 1997+A1: 2001 +A2: 2008
EN 301489-1 V1.9.2 (2011)	EN 50581: 2012
EN 301489-3 V1.6.1 (2013)	
EN 60950-1: 2006+A11: 2009+A1 2010+A12: 2011+A2 2013	

Manufacturer/Authorised representative,



H. Donker, Procurement Director

Dordrecht, April 28 2016

EUROTEC People • Technology • Solutions
HVAC • Refrigeration • Electrical • Measurement

Trust International B.V.
LAAN VAN BARCELONA 600
3317DD DORDRECHT
NETHERLANDS
www.trust.com