

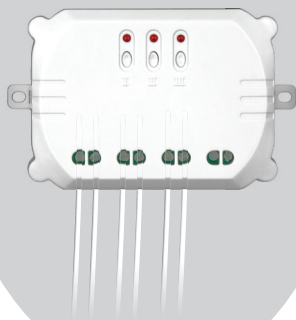

ACM-3500-3 3-IN-1 BUILD-IN SWITCH
START-LINE
RECEIVER ACM-3500-3

**USER MANUAL
MULTI LANGUAGE**



Item 71053 Version 1.0
Visit www.trustsmarthome.com
for the latest instructions

3-IN-1 BUILD-IN SWITCH

ACM-3500-3 3-IN-1 BUILD-IN SWITCH

1

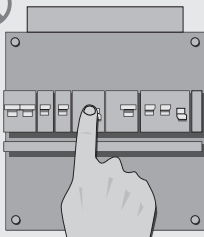

2

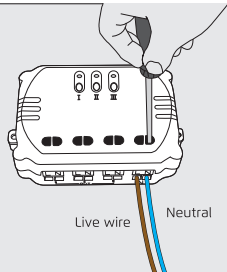

3

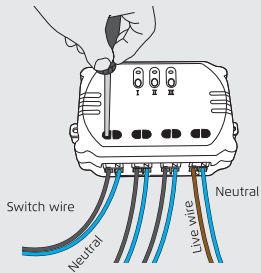

4

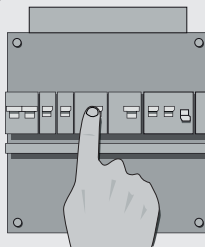

5

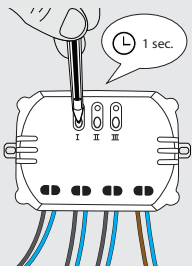

6

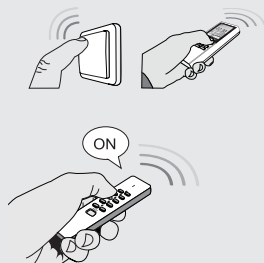

7

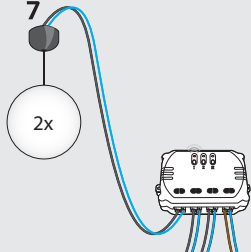

8

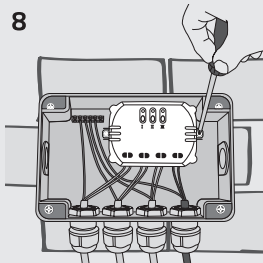

9

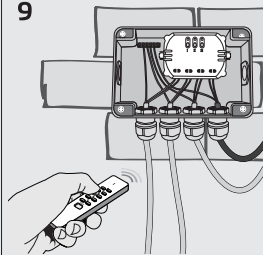

ACM-3500-3 3-IN-1 BUILD-IN SWITCH

10

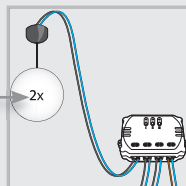
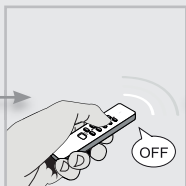
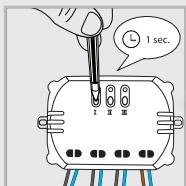

11

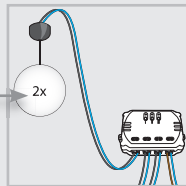
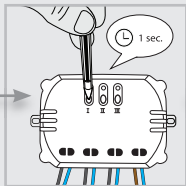
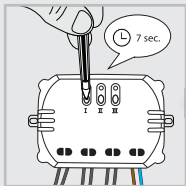

1. Switch off the mains power (electric meter box)

2. Connect the live wire and neutral wire to [IN]

Connect the (brown) live wire to [L]. Connect the (blue) neutral wire to [N]. Contact an electrician when in doubt about wiring. Tighten the clamping screws.

3. Connect lamp/device wiring to [OUT]

For each lamp/device, connect 2 wires to the [L] and [N] contact of output I, II or III. Contact an electrician when in doubt about wiring. Tighten the clamping screws. Do not exceed the total maximum load: 3500W.

4. Switch on the mains power (electric meter box) to continue the installation

Shock hazard! Do not contact any exposed wiring. Only touch the plastic housing of this product.

5. Activate learn-mode

Press the learn-button of port I, II or III on the receiver for 1 second. The learn-mode for this port will be active for 15 seconds and the LED-indicator will blink slowly.

6. Assign Trust SmartHome transmitter code

While the learn-mode is active, send an ON-signal with any Trust SmartHome transmitter to assign the code to the receiver's memory.

7. Code confirmation

The receiver will switch on/off 2 times to confirm the code has been received. Per port, the receiver can store up to 6 different transmitter codes in its memory. The memory will be preserved when the receiver is moved to another location or in case of power failure.

8. Affix the receiver

Secure the receiver to a surface for extra stability. For outdoor use, mount the receiver in a waterproof junction box and cover up any exposed wiring.

9. Manual operation with a Trust SmartHome transmitter

1. Send an ON-signal to switch port I, II or III of the receiver on.
2. Send an OFF-signal to switch port I, II or III of the receiver off.

10. Single code delete

1. Press the learn-button of port I, II or III for 1 second. The learn-mode will be active for 15 seconds and the LED-indicator will blink slowly.
2. While the delete-mode is active, send an OFF-signal with a specific Trust SmartHome transmitter to delete the code.
3. The receiver will switch on/off 2 times to confirm code deletion.

11. Full memory delete

1. Press and hold the learn-button of port I, II or III (approx. 7 sec.) until the LED-indicator starts blinking fast. The delete mode will be active for 15 seconds.
2. While the delete mode is active, press the learn button of the same port again for 1 second.
3. The receiver will switch on/off 2 times to confirm memory deletion.

Trust | SMART Home

START-LINE
RECEIVER ACM-3500-3

IMPORTANT INFORMATION
MULTI LANGUAGE

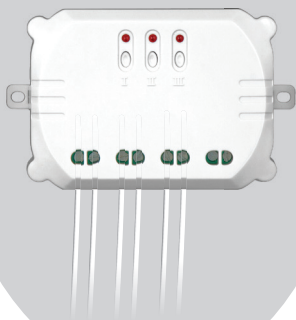

Item 71053 Version 1.0
Visit www.trustsmarthome.com
for the latest instructions

3-IN-1 BUILD-IN SWITCH

EN ACM-3500-3 3-IN-1 BUILD-IN SWITCH

Read these simple guidelines. Not following them may be dangerous and faulty installation will invalidate any warranty that may apply to this product.

COMPATIBILITY

This receiver works with all Trust SmartHome transmitters.

FUNCTIONALITY

3-in-1 receiver (I, II, III) for switching lights and electronic devices on/off.

TECHNICAL SPECIFICATIONS

- | | |
|-----------------------------|--|
| • Power supply input | 220-240 VAC 50 Hz |
| • Maximum load | 3500 Watt in total (all on 1 output channel, or divided over 2 or 3 output channels) |
| • Memory addresses | 6 per output channel (I, II and III) |
| • RF frequency | 433.92 MHz |
| • RF range | Up to 30 m indoor/70 m outdoor (optimal conditions) |
| • Standby power consumption | 0.5 Watt |

LIGHTING OVERVIEW (visit www.trustsmarthome.com for more information)

- | | |
|--|--|
| <input checked="" type="checkbox"/> Incandescent lamps | <input checked="" type="checkbox"/> LED lamps |
| <input checked="" type="checkbox"/> Eco halogen lamps | <input checked="" type="checkbox"/> Fluorescent tubes with electronic starter |
| <input checked="" type="checkbox"/> 230 V halogen lamps | <input checked="" type="checkbox"/> Switchstart fluorescent tubes (automatic glow starter) |
| <input checked="" type="checkbox"/> 12 V halogen lamps with electronic transformer | |
| <input checked="" type="checkbox"/> 12 V halogen lamps with iron-core transformer | |
| <input checked="" type="checkbox"/> Compact fluorescent lamps | |

WIRELESS RADIO SIGNAL

- The 433.92 MHz radio signal passes through walls, windows and doors.
- Indoor range: up to 30 m. Outdoor range: up to 70 m. (optimal conditions)
- The range is strongly dependent on local conditions, such as the presence of metals. For example, the thin metal coating in Low-emissivity (Low-E) glass has a negative impact on the range of radio signals.
- There may be restrictions on the use of this device outside the EU. If applicable, check whether this device complies with local directives.

INSTALLATION

Wire colors may vary per country. Contact an electrician when in doubt about wiring.

MAXIMUM LOAD

Never connect lights or equipment that exceed the maximum load of the receiver, as it can result in defects, a short circuit or fire.

SHOCK HAZARD

Exercise caution when installing a receiver. Voltage may be present, even when a receiver is switched off.

LIFE-SUPPORT

Never use Trust SmartHome products for life-support systems or other applications in which equipment malfunctions can have life-threatening consequences.

INTERFERENCE

All wireless devices may be subject to interference, which could affect performance. The minimum distance between 2 receivers should be at least 50 cm.

REPAIRING

Do not attempt to repair this product. There are no user-serviceable parts inside.

WATER-RESISTANCE

This product is not water-resistant. Keep it dry. Moisture will corrode the inner electronics and can result in a short circuit, defects and shock hazard.

CLEANING

Use a dry cloth to clean this product. Do not use harsh chemicals, cleaning solvents, or strong detergents.

HANDLING

Do not drop, knock, or shake the device. Rough handling can break internal circuit boards and fine mechanics.

ENVIRONMENT

Do not expose the product to excessive heat or cold, as it can damage or shorten the life of electronic circuit boards.

LEGAL INFORMATION

CE: Trust declares this device complies with the Directives as listed in Section 2 of this document.

WEEE: Dispose of the device at a recycling centre. More information: www.trustsmarthome.com

Warranty information: www.trustsmarthome.com/warranty

CE Declaration of Conformity

Trust International B.V. declares that this TRUST SMART Home-product:

Model: ACM-3500-3 3-IN-1 BUILD-IN SWITCH
Item number: 71053
Intended use: Indoor

is in compliance with the essential requirements and other relevant provisions of the following directives: EMC Directive, Low Voltage Directive and R&TTE Directive.

The product is compatible with the following norms/standards:

EN 55015:2013
EN 300 220-1 V2.4.1 (2012-05)
EN 300 220-2 V2.4.1 (2012-05)
EN 301 489-1 V1.9.2 (2011-09)
EN 301 489-3 V1.6.1 (2013-08)
EN 55022:2010 +AC:2011, Class B
EN 61000-3-2:2006 +A1:2009 +A2:2009, Class A
EN 61000-3-3:2013
EN 61000-4-2:2009
EN 61000-4-3:2006 +A1:2008 +A2:2010
EN 61000-4-4:2012

EN 61000-4-5:2006
EN 61000-4-6:2014
EN 61000-4-11:2004
EN 60669-2-1:2004 + A1:2009 + A12:2010
EN 60669-2-2:2006
EN 60669-1:1999 + A1:2002 + A2:2008

Authorized representative



H. Donker, Procurement Director
Dordrecht, 1-1-2015

EUROTEC People • Technology • Solutions
HVAC • Refrigeration • Electrical • Measurement

TRUST SMART Home
LAAN VAN BARCELONA 600
3317DD DORDRECHT
NEDERLAND
www.trustsmarthome.com