

HARVESTING SHELF ASSEMBLY (OPTIONAL EXTRA)

PARTS

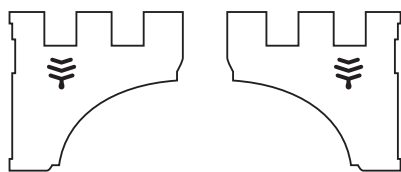

2 x harvesting shelf brackets

HARVESTING SHELF HARDWARE PACK - ACTUAL SIZE

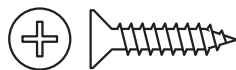

4 x Phillips head screws

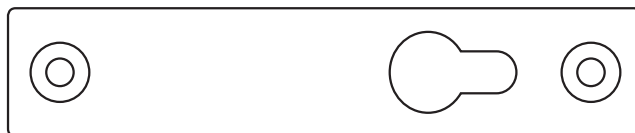

2 x harvesting shelf bracket keyhole mounts

ASSEMBLY

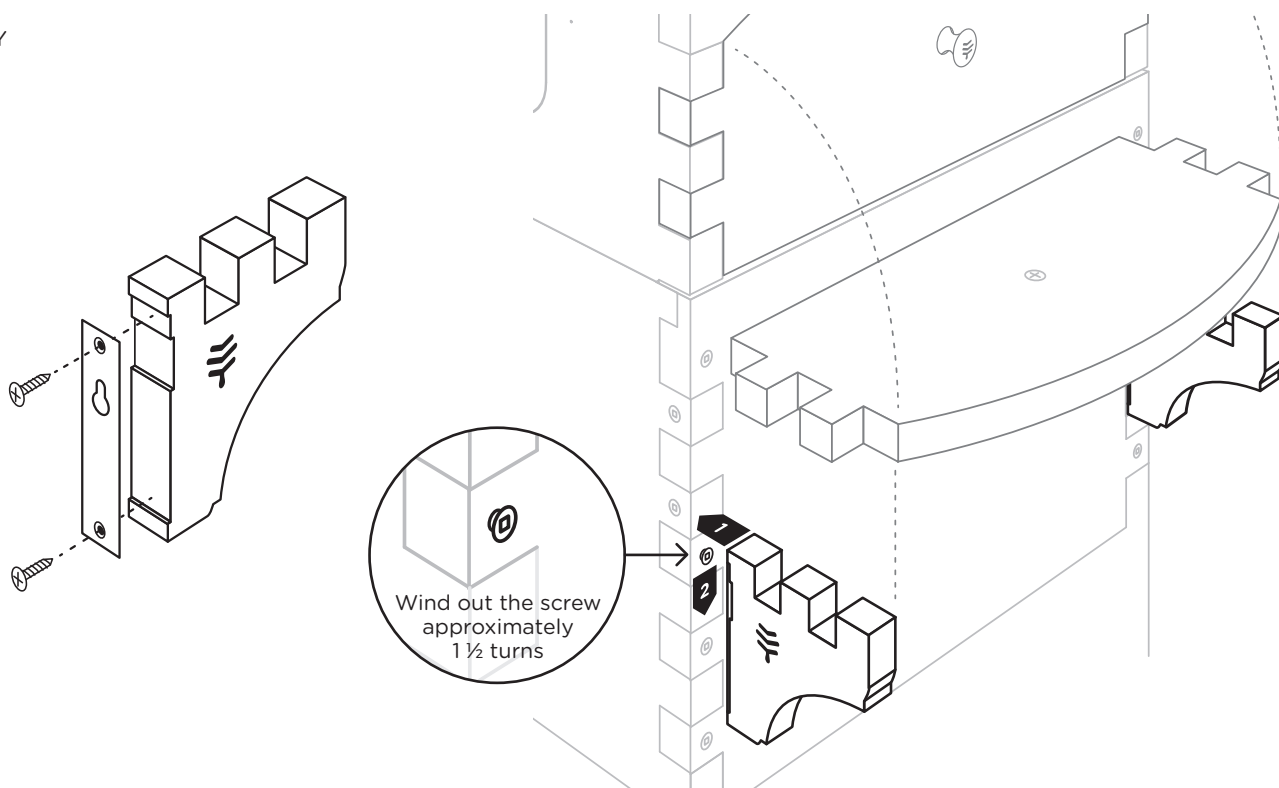

1. To fix keyhole mount to bracket: place the keyhole mount with countersink facing outward, against the shelf bracket and attach to the vertical edge as shown (Phillips head screws and Phillips head driver bit).
2. Make sure the large hole on the bracket mount goes at the bottom.

Using your harvesting shelf

1. You can attach your shelf in multiple locations at your preferred height. Choose any two corresponding square head screws on the brood box front (using the assembly tool and square drive bit) and wind out the screw approximately 1 1/2 turns (you may need to adjust slightly to get the perfect fit) see diagram.
2. Fit the harvesting shelf bracket over the exposed screwhead and push down until it clicks into place.
3. When you are ready to harvest you can fit the Flow Super rear window cover to these two brackets to create a handy shelf which will make harvesting honey even easier.
 - For large jars you can even use the screws on the rear of the base for a lower shelf, but be careful not to overload.
 - Adjust the screws so that they make a nice tight fit. If the screws are wound out too far, the brackets will not be as structurally secure.
 - These brackets are designed for easy removal. Store inside for longevity.