



Type A RCBO

Description

The WER Range RCBO from WCED with type A & AC Type RCD protection in one. RCBO's (Residual Current Circuit Breaker with Overload Protection) provide residual and overload protection in one neat device. They can detect & respond as for type AC, PLUS pulsating DC components. Ideal for Electric Vehicles, Domestic and Commercial applications.

Key Features

The WER Range RCBOs with switched neutral built in as standard will fully isolate a faulty or damaged circuit by disconnecting live and neutral conductors. They offer the most comprehensive circuit protection available.

Using the WER range rcbo's will guarantee that healthy circuits remain in service and that only a faulty circuit is switched off. This avoids danger and prevents inconvenience in the event of a fault. They have switched neutral built in as standard, live and neutral conductors do not have to be disconnected for insulation resistance testing. This saves time and money.

Twin handle system, black handle controls MCB function, white handle controls RCD function. If only black handle trips off, it indicates overload or short circuit. If both white and black handle trip, it will indicate residual current fault. This will assist an electrician to solve the electrical fault quickly, saving time and money.

Part No	Description	Qty
WER06B-30	Type A 6Amps B Curve 30mA High Immunity RCBO	60
WER10B-30	Type A 10Amps B Curve 30mA High Immunity RCBO	60
WER16B-30	Type A 16Amps B Curve 30mA High Immunity RCBO	60
WER20B-30	Type A 20Amps B Curve 30mA High Immunity RCBO	60
WER32B-30	Type A 32Amps B Curve 30mA High Immunity RCBO	60
WER40B-30	Type A 40Amps B Curve 30mA High Immunity RCBO	60
WER06C-30	Type A 6Amps C Curve 30mA High Immunity RCBO	60
WER10C-30	Type A 10Amps C Curve 30mA High Immunity RCBO	60
WER16C-30	Type A 16Amps C Curve 30mA High Immunity RCBO	60
WER20C-30	Type A 20Amps C Curve 30mA High Immunity RCBO	60
WER32C-30	Type A 32Amps C Curve 30mA High Immunity RCBO	60
WER40C-30	Type A 40Amps C Curve 30mA High Immunity RCBO	60

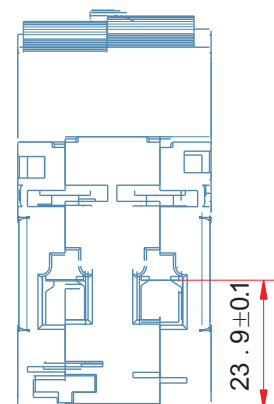
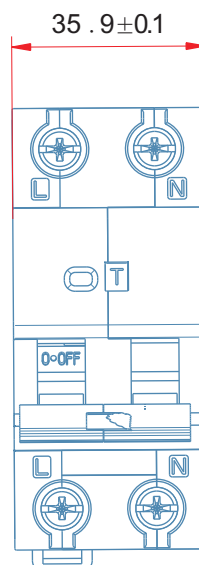
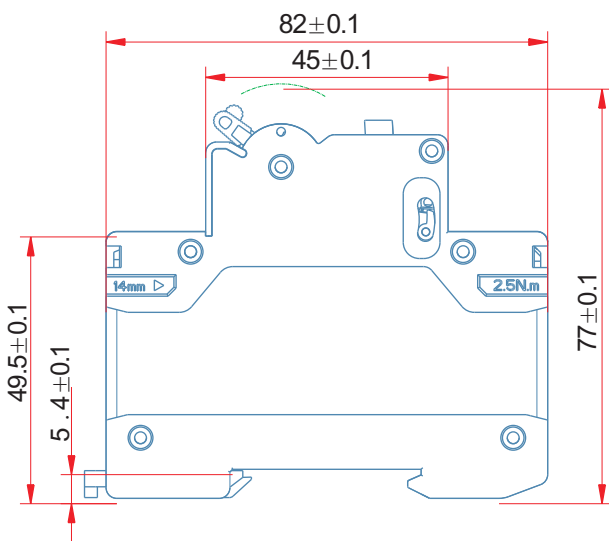



	Standard		IEC/EN 61009-1
Electrical features	Type		A
	Thermo-magnetic release characteristic		B, C
	Rated current I _n	A	6, 10, 16, 20, 25, 32, 40
	Poles		2P
	Rated voltage U _e	V	230/240
	Rated sensitivity I _{Δn}	A	0.03
	Rated residual making and breaking capacity I _{Δm}	A	3000
	Rated short-circuit capacity I _{cn}	A	6,000
	Break time under I _{Δn}	s	≤0.1
	Rated frequency	Hz	50/60
	Rated impulse withstand voltage (1.2/50) U _{imp}	V	6,000
	Dielectric TEST voltage at ind. Freq. for 1min	kV	2
	Insulation voltage U _i		500
	Pollution degree		2
Mechanical features	Electrical life		2,000
	Mechanical life		2,000
	Contact position indicator		Yes
	Protection degree		IP20
	Ambient temperature (with daily average ≤35°C)	°C	-5...+40
	Storage temperature	°C	-25...+70
Installation	Terminal connection type		Cable/U-type busbar/Pin-type busbar
	Terminal size top/bottom for cable	mm	25
		AWG	18-3
	Terminal size top/bottom for busbar	mm	10
		AWG	18-8
	Tightening torque	N*m	2.5
		In-lbs.	18
	Mounting		On DIN rail EN 60715 (35mm) by means of fastclip device
Connection		From top to bottom, or from bottom to top	

