

## Installation Instructions

**S-5!® Warning!** Please use these products responsibly! Visit our website or contact your S-5! distributor for available load test results. The user and/or installer of these parts is responsible for all necessary engineering and design to ensure the S-5-N and S-5-N 1.5 have been properly spaced and configured.

**Notice to S-5! users:** Due to the many variables involved with specific panel products, climates, snow melt phenomena, and job particulars, the manufacturer cannot and does not express any opinions as to the suitability of any S-5! assembly for any specific application and assumes no liability with respect thereto. S-5! products are tested for ultimate holding strength on various profile types and materials. This information is available from the S-5! website: [www.S-5.com](http://www.S-5.com). This document is an installation guide only and the photographs and drawings herein are for the purpose of illustrating installation tools and techniques, not system designs.

The S-5-N and S-5-N Mini clamps are designed to fit Taylor Metals' Easy Lock™, ASC Building Products' Skyline Roofing®, McElroy Metals' Meridian, New Tech Machinery's FF100, and similar 1" nail strip profiles.

The S-5-N 1.5 and S-5-N 1.5 Mini clamps are designed to fit 1.5" nail strip profiles.

## Tools Needed

- Screw Gun
  - 3/16" Allen Bit Tip (provided)
  - Dial-Calibrated Torque Wrench\*
- (\*For accurate tension values, do NOT use a clicking torque wrench)

## To Install S-5-N and S-5-N 1.5

1. Partially thread the setscrews into the clamp by hand.
2. Position clamp at desired location along the seam.
3. Make sure the nose of the clamp engages the female part of the seam.
4. Tighten the setscrews at the base of the clamp using a screw gun and the included screw gun bit tip. Setscrews should be tensioned and re-tensioned as the seam material compresses, i.e. tighten the first setscrew, then the second; then repeat until each setscrew achieves the recommended torque. For optimal holding strength, setscrews should be tensioned to 160 to 180 inch pounds on 22ga steel, and 130 to 150 inch pounds on all other metals and thinner gauges of steel. Once installed properly, these clamps require zero maintenance or inspection for the life of the roof.

**Note:** Seams that exceed 0.56" at the widest part will require hand crimping to allow the clamp to fit.

Specified Torque	Inch Pounds	Foot Pounds	Nm
<b>22ga steel</b>	160–180	13–15	18–20
<b>24ga steel</b>	130–150	11–12.5	15–17

All other metals - see our website at [www.S-5.com](http://www.S-5.com).

When relying upon published load values, setscrew tension should be verified periodically throughout the installation process to ensure you are consistently achieving the proper torque.

These instructions are for use by those experienced in the trade. Always follow appropriate safety precautions and use appropriate tools.

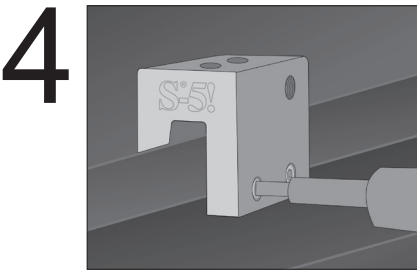
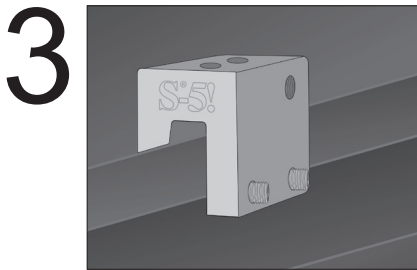
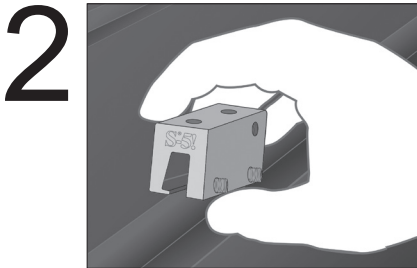
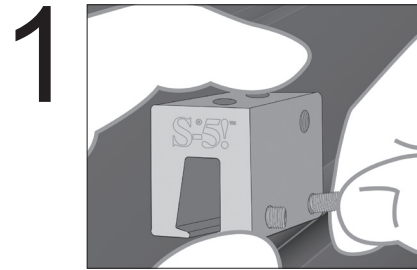

Above illustrations show S-5-N clamp.

### To Install S-5-N Mini and S-5-N 1.5 Mini

1. Partially thread the setscrew into the clamp by hand.
2. Position clamp at desired location along the seam.
3. Make sure the nose of the clamp engages the female part of the seam.
4. Tighten the setscrew at the base of the clamp using a screw gun and the included screw gun bit tip. For optimal holding strength, setscrew should be tensioned to 160 to 180 inch pounds on 22ga steel, and 130 to 150 inch pounds on all other metals and thinner gauges of steel. Once installed properly, these clamps require zero maintenance or inspection for the life of the roof.

**Note:** Seams that exceed 0.56" at the widest part will require hand crimping to allow the clamp to fit.

Specified Torque	Inch Pounds	Foot Pounds	Nm
22ga steel	160–180	13–15	18–20
24ga steel	130–150	11–12.5	15–17

All other metals - see our website at [www.S-5.com](http://www.S-5.com).

When relying upon published load values, setscrew tension should be verified periodically throughout the installation process to ensure you are consistently achieving the proper torque.

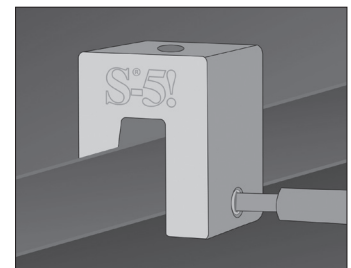
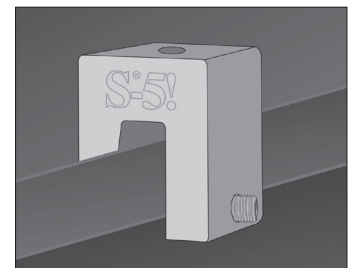
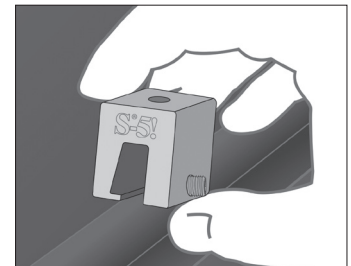

Above illustrations show S-5-N Mini clamp.

 **SKY PRODUCTS**  
2 CHISHOLM COURT • AJAX • ONTARIO • L1S 4N8 • 647 932 5605  
[WWW.SKYPRODUCTS.CA](http://WWW.SKYPRODUCTS.CA)

#### S-5!® Warning! Please use this product responsibly!

Products are protected by multiple U.S. and foreign patents. Visit the website at [www.S-5.com](http://www.S-5.com) for complete information on patents and trademarks. For maximum holding strength, setscrews should be tensioned and re-tensioned as the seam material compresses, i.e. tighten the first setscrew, then the second; then repeat until each setscrew achieves the recommended torque. Clamp setscrew tension should be verified using a calibrated torque wrench between 160 and 180 inch pounds when used on 22ga steel, and between 130 and 150 inch pounds for all other metals and thinner gauges of steel. Consult the S-5! website at [www.S-5.com](http://www.S-5.com) for published data regarding holding strength.

Copyright 2014, Metal Roof Innovations, Ltd. S-5! products are patent protected.  
S-5! aggressively protects its patents, trademarks, and copyrights. Version 092414.