

ScopeValet™ Endoscopy Care Products

ScopeValet™ Colonoscopy & EGD Kit

Item No. 345SVR

All-in-one Kit to Maximize the Efficiency of Endoscope Reprocessing

The ScopeValet™ COLONOSCOPY & EGD KIT provides a safe and efficient way for you to prepare, begin and perform the reprocessing procedure following a basic colonoscopy or esophagogastroduodenoscopy. The ScopeValet™ COLONOSCOPY & EGD KIT provides you with all the necessary supplies you need for these Endoscopy cases in one convenient package. The COLONOSCOPY & EGD KIT is labeled and color-coded to easily identify its contents.



Each kit contains:

- ScopeValet™ ECO-Bedside Kit with Bio-Clean Technology
- Ruhof Transport Bag
- Emesis Basin
- Suction Tubing, 6ft.
- Lubricant Jelly, 2 oz
- 16 ply 4"x4" Gauze Pad (10)

Features

- All the necessary supplies you need in one convenient package
- Color-coded label is positioned at bottom of kit for easy identification when stacked with other kits
- Meets all reprocessing guidelines
- Reduces procedure set-up time and room turnover time
- Reduces ordering time, inventory management costs and packaging waste
- Disposable, one time use
- Provides a consistent quality of care through standardization in every case
- Clinical staff can focus on patient care versus assembling supplies

Also available:



Clean & Transport
Item No.
345EPOSV



Compliance
Kit
Item No.
345SVC



Custom
Kit
Item No.
345CK

Warnings & Precautions:

This standard pre-packed kit is for one time use only. Any institution, practitioner, or third party who reprocesses, refurbishes, remanufactures, resterilizes, and /or reuses the components of this kit must bear full responsibility for their safety and effectiveness.



IFU / DFU

See reverse side for
Instructions for Use.



393 Sagamore Avenue, Mineola, New York 11501
1-800-537-8463 • www.ruhof.com



ScopeValet™ Colonoscopy & EGD Kit Instructions for Use

ScopeValet™ ECO-Bedside Kit

1. Open sponge bag and pour contents (sponge and detergent) into the provided container. Container has two convenient fill lines one for 250ml and one for 500ml. Fill tray with water to desired level. Use enclosed lid to keep enzymatic solution from spilling.
2. Immediately after a procedure, wipe the insertion tube with the ECO-Bedside Kit Sponge soaked in prepared enzymatic solution. Be sure to squeeze the excess liquid from the sponge back into the container prior to wiping.
3. Place the distal end of the endoscope into the canister and suction the enzymatic solution through the biopsy/suction channel for 30 seconds or until no liquid remains.
4. Flush water and air into the air/water channel in accordance with the endoscope manufacturer's instructions.
5. The sponge should be discarded in the waste container. Empty containers should be discarded in a waste container as they are biodegradable. Do not use empty containers for other purposes.
6. The soiled scope should then be placed in a Ruhof ScopeValet™ Transport Bag and removed to the reprocessing area.

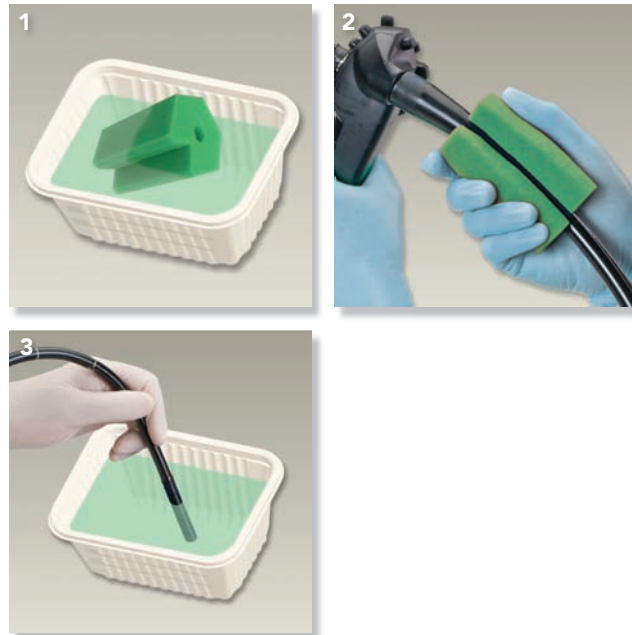

Ruhof Transport Bag

1. Remove packaging and spread the ScopeValet™ Transport Bag across the procedure cart surface, placing the soiled scope in the center of the pad.
2. Take hold of the drawstring closures at each end of the pad bringing them together into one hand over the center of the pad.
3. While lifting the scope and pad off of the cart surface pull up on the cords with one hand and down along the cords with the other hand to easily cinch the pad into a transport bag.
4. Simply release cinched cords and draw open the Transport Bag to remove used scope for reprocessing.

