

# ScopeValet™ Endoscopy Care Products

## ScopeValet™ Compliance Kit

Item No. 345SVC

The ScopeValet™ COMPLIANCE KIT is specially designed to standardize your infection control by providing premium infection control supplies all in one procedure pack. Components are specifically aligned to accreditation standards and society guidelines.. The ScopeValet™ COMPLIANCE KIT is labeled and color-coded to easily identify its contents.



Each kit contains:

### ScopeValet™ ECO-Bedside Kit with Bio-Clean Technology

- Contains Endozime® SLR enzymatic detergent with Bio-Clean technology and a contoured sponge that targets the polymeric layer that encases biofilm
- Begins cleaning on contact, preventing soil from drying on scope surfaces
- Removes gross contaminants, including synthetic lipids

### Ruhof Transport Bag

- Easy-to-use cinching cords converts pad into transport container
- Strong leak-proof liner and absorbent inner pad contains fluids and protects scope
- Features "Used Instrument" biohazard tag

### Lubricant Jelly, 2 oz.

### Gauze Pads

- Contains 10, 16 ply, 4" x 4"

### EndoBrush for 2mm-4mm

- Brush diameter is 5mm providing maximum channel surface contact; wand length is 230cm; catheter diameter is 1.8mm
- Premium catheter stiffness provides smooth scope passage
- Double-end provides pull through design while rounded brush tip prevents damage

### Additional features of the ScopeValet™ Compliance Kit:

- Reduces prep time, inventory management costs and packaging waste
- Full compliance with guidelines for endoscope reprocessing and transportation
- Disposable, one time use

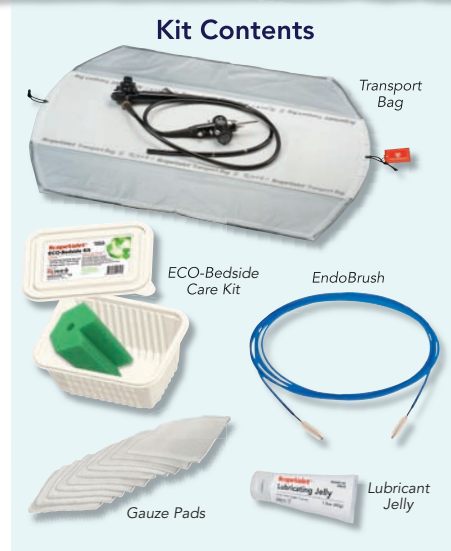

Also available:



Colonoscopy  
& EGD Kit  
Item No.  
345SVR



Clean &  
Transport Kit  
Item No.  
345EPOSV



Custom  
Kit  
Item No.  
345CK

### Warnings & Precautions:

This standard pre-packed kit is for one time use only. Any institution, practitioner, or third party who reprocesses, refurbishes, re-manufactures, reesterilizes, and /or reuses the components of this kit must bear full responsibility for their safety and effectiveness.

IFU / DFU

See reverse side for  
Instructions for Use.



393 Sagamore Avenue, Mineola, New York 11501  
1-800-537-8463 • www.ruhof.com



# ScopeValet™ Compliance Kit

## Instructions for Use

### ScopeValet™ ECO-Bedside Kit

1. Open sponge bag and pour contents (sponge and detergent) into the provided container. Container has two convenient fill lines one for 250ml and one for 500ml. Fill tray with water to desired level. Use enclosed lid to keep enzymatic solution from spilling.
2. Immediately after a procedure, wipe the insertion tube with the ECO-Bedside Kit Sponge soaked in prepared enzymatic solution. Be sure to squeeze the excess liquid from the sponge back into the container prior to wiping.
3. Place the distal end of the endoscope into the canister and suction the enzymatic solution through the biopsy/suction channel for 30 seconds or until no liquid remains.
4. Flush water and air into the air/water channel in accordance with the endoscope manufacturer's instructions.
5. The sponge should be discarded in the waste container. Empty containers should be discarded in a waste container as they are biodegradable. Do not use empty containers for other purposes.
6. The soiled scope should then be placed in a Ruhof ScopeValet™ Transport Bag and removed to the reprocessing area.

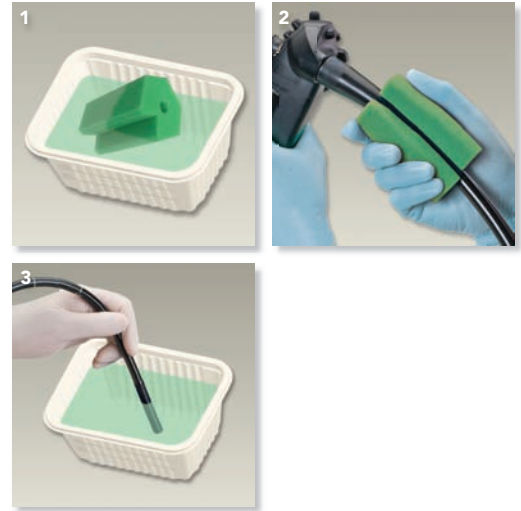

### Ruhof Transport Bag

1. Remove packaging and spread the ScopeValet™ Transport Bag across the procedure cart surface, placing the soiled scope in the center of the pad.
2. Take hold of the drawstring closures at each end of the pad bringing them together into one hand over the center of the pad.
3. While lifting the scope and pad off of the cart surface pull up on the cords with one hand and down along the cords with the other hand to easily cinch the pad into a transport bag.
4. Simply release cinched cords and draw open the Transport Bag to remove used scope for reprocessing.

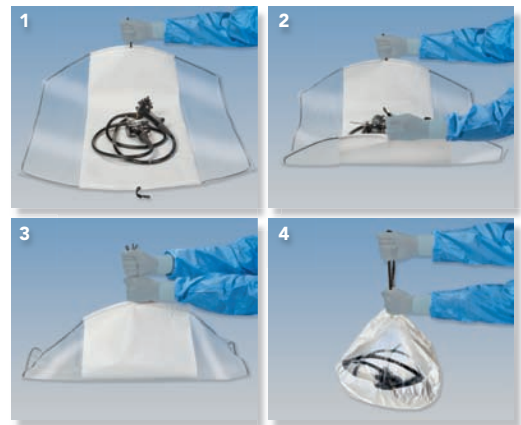

### ScopeValet™ Endo Brush

1. The channel cleaning brush is designed to provide mechanical scrubbing of channels 2mm-4mm to safely remove debris from flexible endoscopes.
2. Using the Ruhof enzymatic detergent of choice, advance the cleaning brush through the entire length of the endoscope channel pulling the remainder through at the distal end of the lumen.
3. Using the Ruhof enzymatic detergent of choice, pass the channel cleaning brush through the valve stem openings.

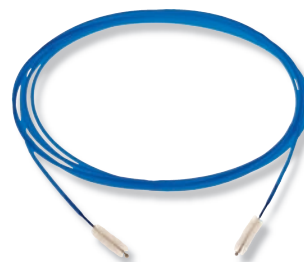

*Endo Brush's unique rounded tip helps prevent damage to inside channels of scopes.*

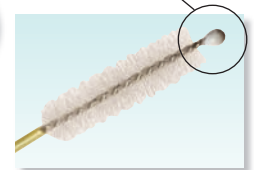

**Contraindications:** If resistance is met in attempting to pass the brush through the endoscope, do not force the cleaning brush through the endoscope, as this may result in damage to the channel. Do not use the cleaning brushes if the channel(s) are known to be occluded as this may result in damage to the channel.



393 Sagamore Avenue, Mineola, New York 11501  
1-800-537-8463 • www.ruhof.com

