

## Clean Check Complete® Manual

Item No. 345CCM - 2 bottles/kit; 50 strips/bottle

### Daily Monitor for MANUAL Enzymatic Cleaning Process

Clean Check Complete® Manual monitor for Manual Enzymatic Cleaning Process (MEC) determines the presence of active enzymes in manual bath solutions using enzymatic detergents.

Enzymatic detergents greatly enhance the cleaning of medical instruments however the optimal activity of enzymes is dependent on the *correct detergent concentration (dilution), bath temperature and exposure time.*<sup>1</sup> Clean Check Complete® Manual test strips are sensitive to all these parameters. Also, enzymes gradually degrade during use (soil components are substrates for the enzymes) thus the amount of soil on the device during the enzyme treatment will affect the efficacy of cleaning.

*"Disinfection and sterilization cannot be assured unless the cleaning process was effective; seek out whatever means are available and practical to verify the cleaning function. A quality system calls for monitoring and documenting both manual and automatic decontamination processing parameters."*<sup>2</sup>

Use the Clean Check Complete® Manual monitor wherever manual soaking or hand washing with enzymatic detergents is carried out such as in hospital CS/SPDs, medical or dental offices, decontamination areas, etc.

### Features

- Detects the presence of active enzymes in manual bath solutions which guards against using expired or inactive enzymatic detergents.
- Economically priced which supports frequent testing of manual bath solutions.
- Ready-to-use strips; no preparation of reagents or calibration of instruments required.
- Simple "Dip & Read" procedure with results in 90 seconds allowing for a quick check of enzyme activity prior to using manual bath solution.
- Easy to interpret color blocks.
- Each bottle clearly labeled with lot number and expiration date leaves no doubt as to the age or integrity of the product.

### Instructions for Use

Prior to use dilute the enzymatic detergent according to the manufacturer's instructions then test the bath solution with a Clean Check Complete® Manual test strip (*Do not use test strips in concentrated enzymatic detergent.*)

1. Fully immerse the indicator pad into the manual bath solution for **one (1) second**. Do not shake or blot the test strip.
2. Lay strip, pad side up, on a clean surface. Compare the color of the indicator pad to the color chart on the bottle label at **90 seconds**. Record results.

<sup>1</sup> AAMI TIR30:2011 Technical Information Report, A compendium of processes, materials, test methods, and acceptance criteria for cleaning reusable medical devices. Association for the Advancement of Medical Instrumentation, Arlington, VA.

<sup>2</sup> AAMI ST79:2010 Comprehensive Guide to steam sterilization and sterility assurance in health care facilities. Association for the Advancement of Medical Instrumentation, Arlington, VA.

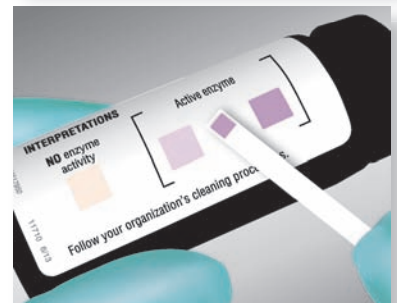

The color of the indicator pad will change in the presence of active enzymes in manual bath solution.