

Luvele

Luv life. Luv health.

LUVELE ULTIMATE MEAT GRINDER



Instruction
Booklet
LUMG700



Luvele.com.au

Safety

Please read all instructions before using the Luvele Meat Grinder. Keep these instructions for future reference.

- Remove all packaging before using your meat grinder for the first time.
- Do not place grinder near the edge of a bench or table during operation.
- Ensure the surface is level, free of liquids or other substances.
- Do not place your meat grinder on or near a hot stove or oven.
- Always use extreme care when handling the blade and cutting plates.
- Unplug from power outlet when not in use, before putting on or taking off attachments, and before cleaning.
- Only use the pusher that is supplied with this meat grinder.
- Do not put your fingers or any utensil into the head.
- Do not put hot meat into the meat grinder.
- All attachments should be removed with care before cleaning.
- Only use the accessories provided and recommended by Luvele.
- Do not overload the meat grinder.
- Do not place any parts of the grinder in a dishwasher or microwave oven.
- Do not immerse the body of the meat grinder in water or other liquids.
- Never operate damaged appliance (incl. mains cable).
- Operate appliance only through a professionally installed socket supplying the correct voltage and do not use extension cables.
- Never remove main cable with wet hands, or lay cable on hot surface, or let cable come into contact with oil.
- Unplug the appliance after each use, when the appliance is not in use and before changing accessories or cleaning appliance.
- Do not try and perform any maintenance, other than cleaning. For any maintenance issues please contact Luvele Australia/UK/EU.
- Do not operate outdoors.
- This appliance is not intended for use by young children or infirm persons without supervision.
- Use a fire blanket only to extinguish fires on appliance.
- The appliance is not designed for commercial or industrial use; it is for household use only.

Congratulations

on the purchase of your new Luvele Ultimate Meat Grinder

Safety

This appliance is intended to be used in household and similar applications such as:

- Staff kitchen areas in shops, offices and other working environments;
- Farm houses;
- By clients in hotels, motels and other residential type environments;
- Bed and breakfast type environments

This appliance is not intended for use by persons (including children) with reduced physical, sensory or mental capabilities, or lack of experience and knowledge, unless they have been given supervision or instruction concerning use of the appliance by a person responsible for their safety.

Children 8 years and above can use this appliance, however, they should be supervised to ensure that they do not play with the appliance. Children should not play with the appliance.

Cleaning and user maintenance shall not be made by children unless they are older than 8 years old and supervised.

Keep the appliance and its cord out of reach of children less than 8 years.

Check the power supply cord for damage from time to time. If the power supply cord is damaged, it must be replaced by the manufacturer or its service agent or a similarly qualified person in order to avoid a hazard.

Use only designated accessories enclosed. This appliance is not intended to be operated by means of external timer or separated remote-control system.

Basic Features

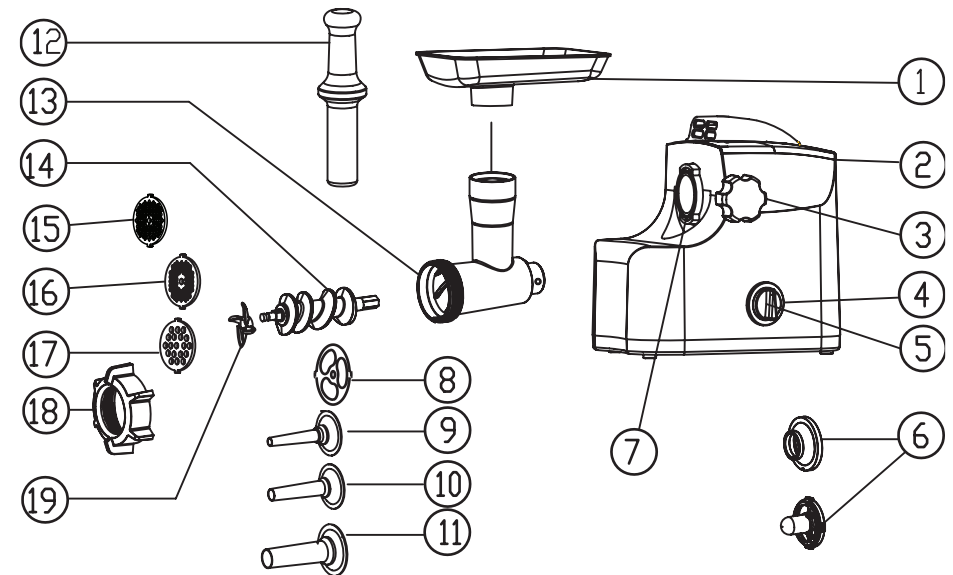

1. Hopper Plate
2. Body
3. Fasten Button
4. Control Dial
5. Reverse Option
6. Kibbe Attachment
7. Head Inlet
8. Sausage Cutting Plate
9. Sausage Nozzle (16mm)
10. Sausage Nozzle (22mm)
11. Sausage Nozzle (32mm)
12. Food Pusher
13. Head

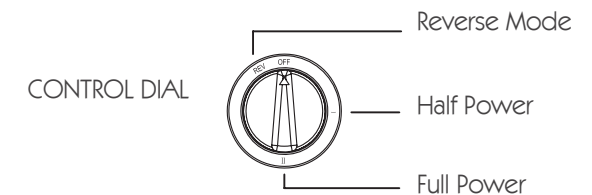

14. Grinding Screw
15. Cutting Plate (Fine 3mm)
16. Cutting Plate (Fine 5mm)
17. Cutting Plate (Medium 8mm)
18. Fixing Ring
19. Cutting Blade

Basic Features

Before using your Luvele Meat Grinder

Wash all attachments in warm soapy water using a mild detergent. Dry each part thoroughly before use. Before you assemble the meat grinder ensure that the power cord is unplugged.

NOTE: All attachments must be firmly in place before using the appliance.

IMPORTANT: Do not place any parts of the grinder in a dishwasher or microwave oven

Reverse Mode

Use the reverse mode if there is a blockage. If the meat grinder is in operation then turn control dial to the stop position, wait for 30 seconds, then turn the control dial to 'Reverse' setting to clear blocked food.

IMPORTANT: Do not select the reverse button while the meat grinder is in operation. The motor must have completely stopped. Once the blockage has been cleared unplug the appliance and clean out remaining food from the head of the meat grinder

Half Mode

Half mode is used when a slower grinding speed is required. Recommended for sausage and kibbe making.

IMPORTANT: Do not operate meat grinder for more than 10 minutes at a time. Allow motor to cool for 10 minutes, after 10 minutes of operation.

The appliance is not designed for commercial or industrial use; it is for household use only.

Basic Features

BASIC ASSEMBLY STEPS

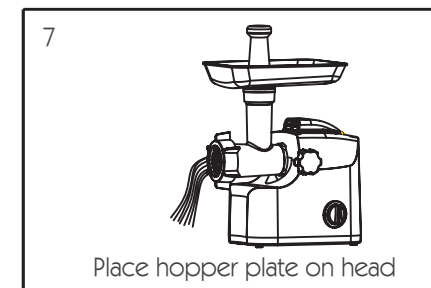
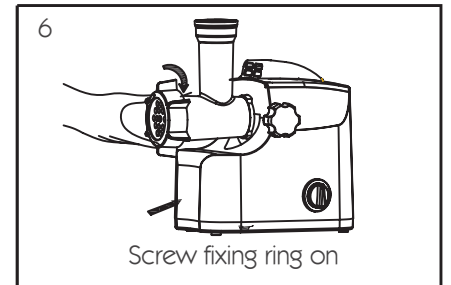
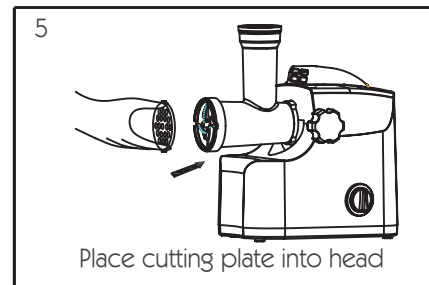
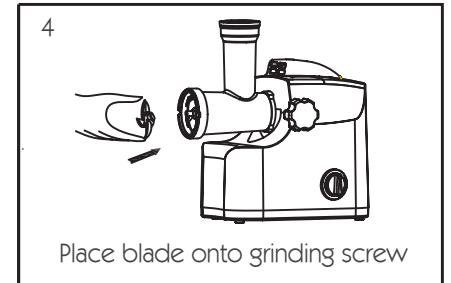
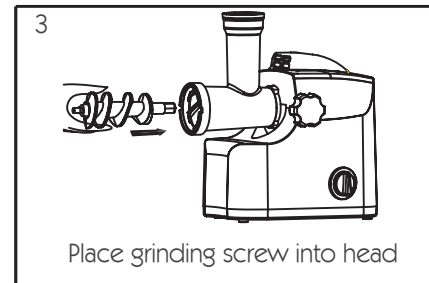
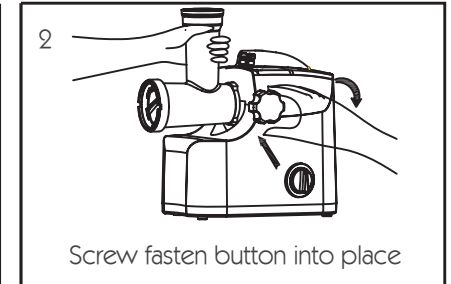
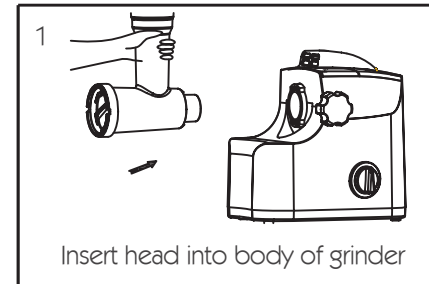

Operating

FITTING AND USING THE CUTTING BLADES

- STEP 1** Place the meat grinder body, facing you on a level, dry surface.
- STEP 2** Fit the grinding screw inside the head.
- STEP 3** Fit the blade over the grinding screw ensuring that the flat side of the blade faces the cutting plate, away from the grinding screw.
- STEP 4** Fit the cutting plate (depending on the type of mince you require).
- STEP 5** The fixing ring then fits over the cutting plate and screws into place.
- STEP 6** Align the head into the grinder body. Screw the fasten button into place.
- STEP 7** Before use, ensure all elements are securely in place.
- STEP 8** Place a bowl underneath the fixing ring for mince collection and the hopper plate on top of the head.
- STEP 9** Place prepared meat into the hopper plate. Plug the power cord into a 230-240V AC power outlet and turn control dial to the ON position.
- STEP 10** Using the food pusher, gently push meat through the head.
- STEP 11** When grinding is complete, turn the dial to the off position to stop grinder.

NOTE:
The head can be fixed into the grinder body prior to the accessories being attached if desired and as shown on page 7.

Operating



PLEASE NOTE:
Do not use excessive force to push meat through the head as it could damage the appliance.

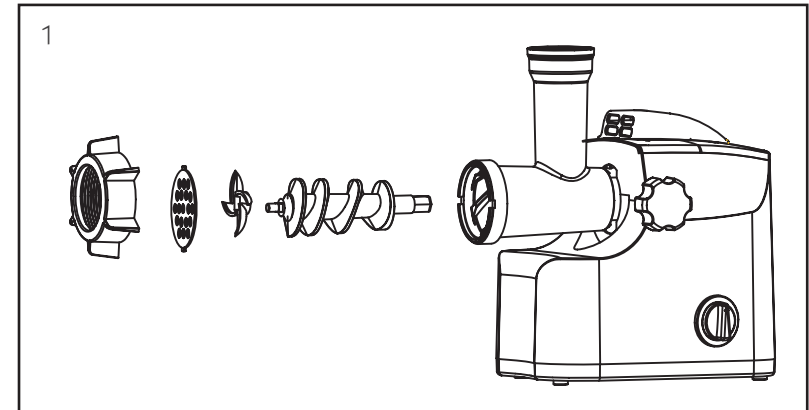

IMPORTANT:
The flat side of the cutting blade should be facing the cutting plate.

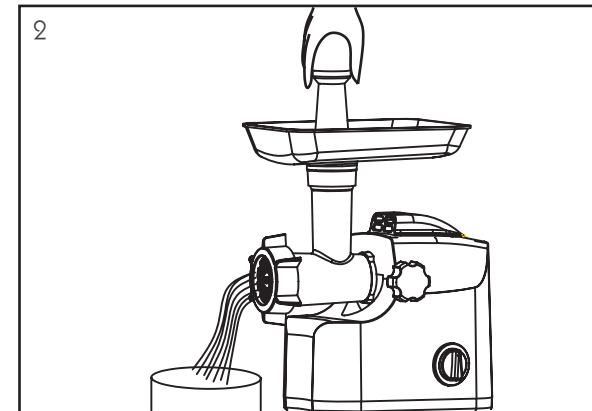

CAUTION:
Do not use anything else apart from the food pusher supplied with this meat grinder to push meat through the head. NEVER use your hands or fingers to push meat through the head. (Fig.2)

Operating

MAKING SAUSAGES

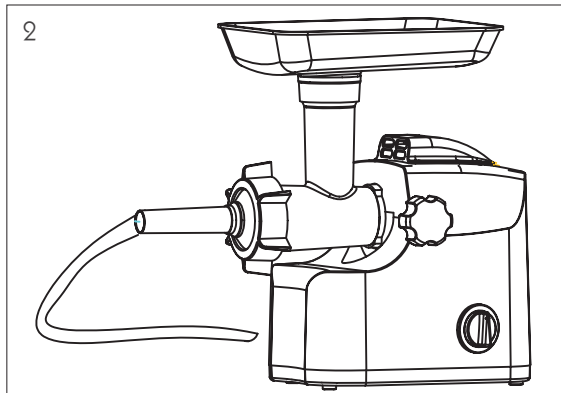
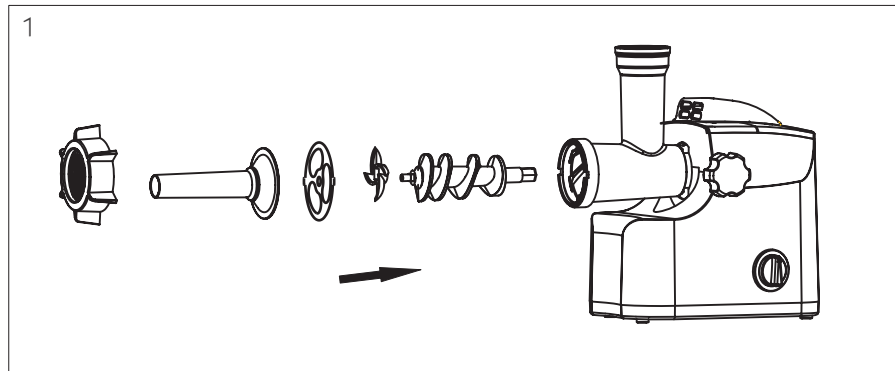

FITTING & USING THE SAUSAGE ATTACHMENTS

- 1 Place the meat grinder body, facing you on a level, dry surface.
- 2 Fit the grinding screw inside the head.
- 3 Fit the blade over the grinding screw ensuring that the flat side of the blade faces the cutting plate, away from the grinding screw.

Operating

- 4 Fit the Sausage cutting plate, followed by the small, medium or large stainless steel sausage nozzle. (Fig.1)
- 5 The fixing ring then fits over the sausage nozzle and screws into place. Do not tighten the fixing ring yet as it will be harder to lock into the grinder body.
- 6 Align the head into the grinder body. Screw the fasten button into place.
- 7 Once the grinder body is in place, tighten the fixing ring and ensure all elements are securely in place.
- 8 Place the hopper plate on top of the head.
- 9 Place prepared sausage mix or processed meat on to the hopper plate. Plug the power cord into a 230-240V AC power outlet and press the 'ON' button



PLEASE NOTE:

Do not use excessive force to push meat through the head as it could damage the appliance.

10

Using the food pusher, gently push sausage mix or meat through the head.

11

As the mixture comes through the nozzle, ease the skin off as it fills. Twist the skin at the desired length to form individual sausages once all of the casings are filled.



CAUTION:

Do not use anything else apart from the food pusher supplied with this meat grinder to push meat through the head. NEVER use your hands or fingers to push meat through the head.

Operating

MAKING KIBBE

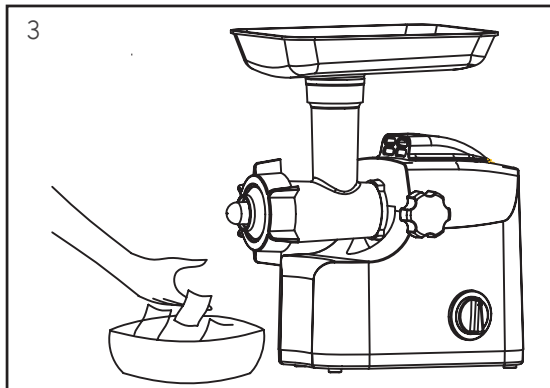
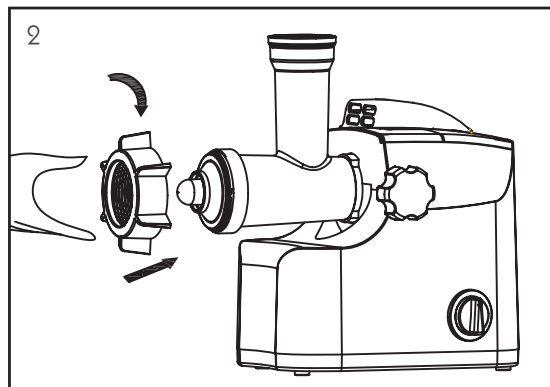
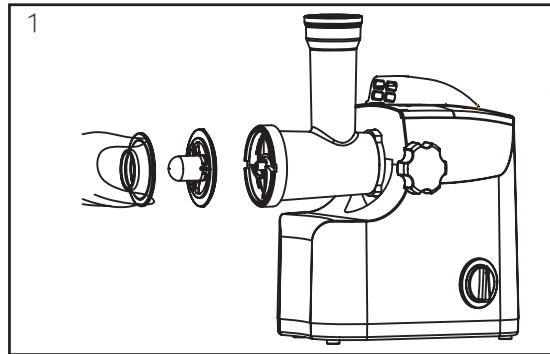

Operating

FITTING AND USING THE KIBBE ATTACHMENTS

- STEP 1** Place the meat grinder body, facing you on a level, dry surface.
- STEP 2** Fit the grinding screw inside the head.
- STEP 3** Fit the kibbe attachment. (Fig.2)
- STEP 4** Secure the kibbe attachments with the fixing ring. Loosely secure with fixing ring.
- STEP 5** Align head into the grinder body. Screw and tighten the fastening button, ensuring all elements are securely in place. (Fig.2)
- STEP 6** Place the hopper plate on top of the head.
- STEP 7** Plug the power cord into a 230-240V AC power outlet and press the 'ON' button.
- STEP 8** Using the food pusher, push the kibbe mixture into the head. (Fig.3)
- STEP 9** Cut kibbe into desired lengths.

Hints & Tips

HINTS FOR GRINDING MEAT

- Remove all large pieces of fat from meat before grinding.
- For fatty cuts of meat we recommend that you cut meat into 5cm cubes. We also recommend using the 8mm or 12mm cutting plates for fatty cuts of meat. If the 4mm cutting plate is used and there is excess fat in the meat it can cause the fat to block the grinder head. This should be avoided. For lean cuts of meat; cut into strips approximately 15cm long and 5cm thick or into cubes.
- Remove any bones from meat as this may damage the grinder.
- If changing cutting plates or changing to another attachment, always ensure that any meat that is around the fixing ring or blade is removed. This will ensure that all parts will reassemble and operate correctly.
- Minced meat should be used within 1-2 days. Freeze uncooked mince that will not be used within this time frame.
- Mince can be frozen for 2-3 months.
- Thaw mince in refrigerator overnight, DO NOT refreeze uncooked meat.
- When cooking mince it needs to be cooked thoroughly. Mince that has been used for hamburgers or meat patties should be cooked until well done.

RECIPES

For recipe inspiration please visit our recipe blog at www.luvele.com.au

ACCESSORIES

3mm, 5mm, 8mm, & 12mm cutting plates are available for separate purchase at www.luvele.com.au

Replacement cutting blades can also be purchased.

Hints & Tips

HINTS FOR SAUSAGE MAKING

- Salt is an important component of sausage making. It is responsible for the control of growth of micro-organisms. It also aids in dissolving the myosin (protein) out of the muscle fibres which then acts as a glue to bind the meat.
- Freshly made sausages are better when allowed to sit in the refrigerator for a minimum of 12 hours and for up to 24 hours.
- Fresh sausages are highly perishable products as they do not contain the preservatives that are present in most store-bought sausages. They should be cooked within 2-3 days of being made or frozen.
- Ideally, sausages should contain up to 30% fat content to provide a tender and moist product.
- Sausages should be thoroughly cooked to kill all microbes. Internal temperatures must reach 70-75°C.
- Intentional piercing of sausage skin releases much needed moisture but prevents the sausage from possibly splitting and being disfigured.

THINGS TO LOOK FOR WHEN MAKING SAUSAGES:

- Choose good quality ingredients - fat to meat ratio (30:70) - Spices and seasoning should be combined in amounts that compliment the meat type.
- Casings (skin) can be purchased from butchers that supply your fresh meat. If preserved in salt, it should be soaked in lukewarm water for up to 30 minutes before use. Flush skins with cold water to expel excess salt.
- Unused fresh casings must be drained, covered with salt and frozen.
- Sausages should be stored in an airtight container or sealed with cling film in the refrigerator.
- A good way to make sure that all the sausage mince has come through the mincer is to break up 1-2 slices of bread and push through mincer, this will force any remaining mixture into the casing.
- Gentle cooking over medium heat prevents interior from boiling which in turn bursts the skin, leaking out moisture and flavour. This then produces a hard textured product.

Cleaning

When you have completed grinding, unplug the meat grinder from the power outlet.

Ensure that all accessories and attachments are washed thoroughly with hot, soapy water.

IMPORTANT: Do not place any parts of the grinder in a dishwasher.

To remove meat that is stuck in the fine and medium cutting plates, use hot, soapy water and a scrubbing brush, clean thoroughly.

Ensure that all attachments are thoroughly cleaned and free of meat to prevent contamination. Then dry thoroughly before storing.

Warning: Take care in washing all attachment components to ensure that there are no food particles left in/around the cutting plates, sausage/kebbe making attachments, blade and grinding screw. Do not wash any of the mincing attachments in the dishwasher

Always unplug the grinder to clean. Do not wash/immerse the grinder body in water, clean this part only by wiping using a damp cloth.

Warranty

The complete Luvele range of products is backed by our 1 Year Total Cover Warranty. Our warranty will covers any manufacturing fault with the product and will also cover damage caused during transit. Your warranty starts from the purchase date of your Luvele product.

Please visit www.luvele.com.au/warranty to register your warranty. If your product was ordered through a seperate retailer then please keep store invoice for warranty claims.

Warranty Process

We want to make any warranty claim as simple as possible for you. All you need to do is contact us at support@luvele.com.au and provide us information about the problem you are having with your item. Firstly, we will suggest some troubleshooting ideas to establish whether or not the issue can be fixed without a return. Photos of the fault may be requested if and where appropriate, and if it will ensure a faster resolution.

Generally, if you have an issue with your item within 30 days of receiving it, we will email you a prepaid return label that can be printed out and used to send the item back with. We will then generally send you a brand new item. The new item will be shipped within 48 hours of receiving the faulty item back. A confirmation email will be send when your faulty item is received back.

If you have an issue after the 30 day period we will consider repairing your item if suitable. If it cannot be repaired it will be replaced with a brand new item. Refunds will only be offered within the 30 day money back guarantee, if you choose this option over a new replacement. Outside of this 30 day period, your item will be repaired or replaced.

Pease email us and the best solution to meet your needs will be offered.

Notes

