

# Which process is best for me?

Clear Dipping Glazes save time when glazing a high volume of projects and makes glazing large pieces fast and easy.  
Clear Brush-On Glazes offer a hands-on personal approach to glazing and excellent control of application.

## dipping glaze – step-by-step



### 1. Mix in Pail

Mix with electric mixer for no more than two minutes until you see a vortex.  
Avoid touching edges of pail with the mixing blade.  
Use a stainless steel wire whisk to stir glaze after initial mixing.

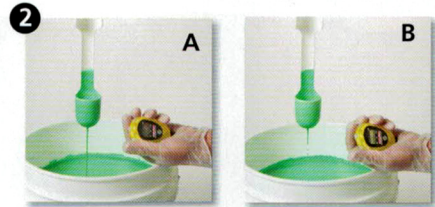

### 2. Check Viscosity

a. Submerge a TL 497 Viscosity Cup into tank and fill with glaze.  
As you lift cup from glaze, begin timing.  
b. Stop timing when the steady stream of glaze begins to break.  
A range of 19-24 seconds is normal. Add small amounts of water as needed to thin.

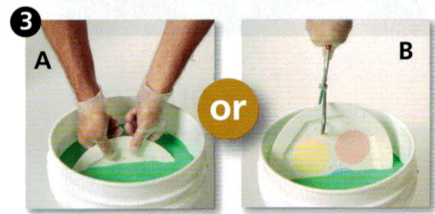

### 3A. Dipping with Hands

a. Wearing protective gloves, use a smooth casual motion to submerge cone 04 bisque in glaze, covering approximately 90% of piece. Quickly lift ware out of glaze.  
Shake off ware to remove excess glaze and achieve uniform application. Let dry.  
b. Using same motion, dip unglazed portion, slightly overlapping glazed area for full coverage. Let dry.

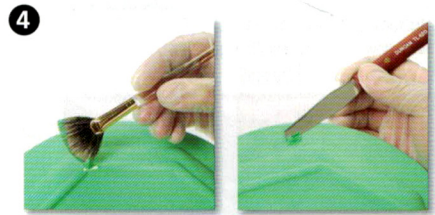

### 4. Touch Up

After ware is dry, use an SB 807 Fan Glaze brush to touch up tong marks or any missed areas with glaze. Use a TL 420 Palette Knife to shave off drips or runs to prevent airborne dust.

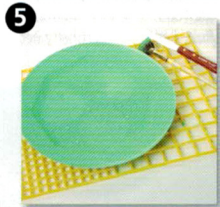

### 5. Fire Glazed Bisque

Let ware dry thoroughly. Set ware securely on clean, sharp stilts in kiln.  
Fire to shelf cone 06.

## brush on – step-by-step

for use on underglaze before firing or on previously fired underglaze



### 1. Mix

Mix Clear Glaze with TL 420 Palette Knife.

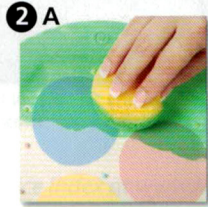

### 2A. Sponge Application

Dab a clean sponge into glaze and dab one coat over colors on surface of bisque to cover. After the sponged coat has dried thoroughly, dip Glaze brush in glaze and brush on two coats.  
Allow to dry between coats.

or

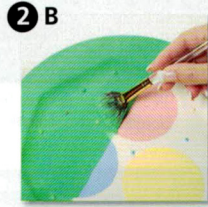

### 2B. Brush Application

Dip a Glaze brush in glaze and apply two flowing coats.  
Let dry between coats.



### 3. Fire Glazed Bisque

Let ware dry thoroughly.  
Set ware securely on clean, sharp stilts in kiln.  
Fire to shelf cone 06.