

SCYTHE MOWER MANUAL

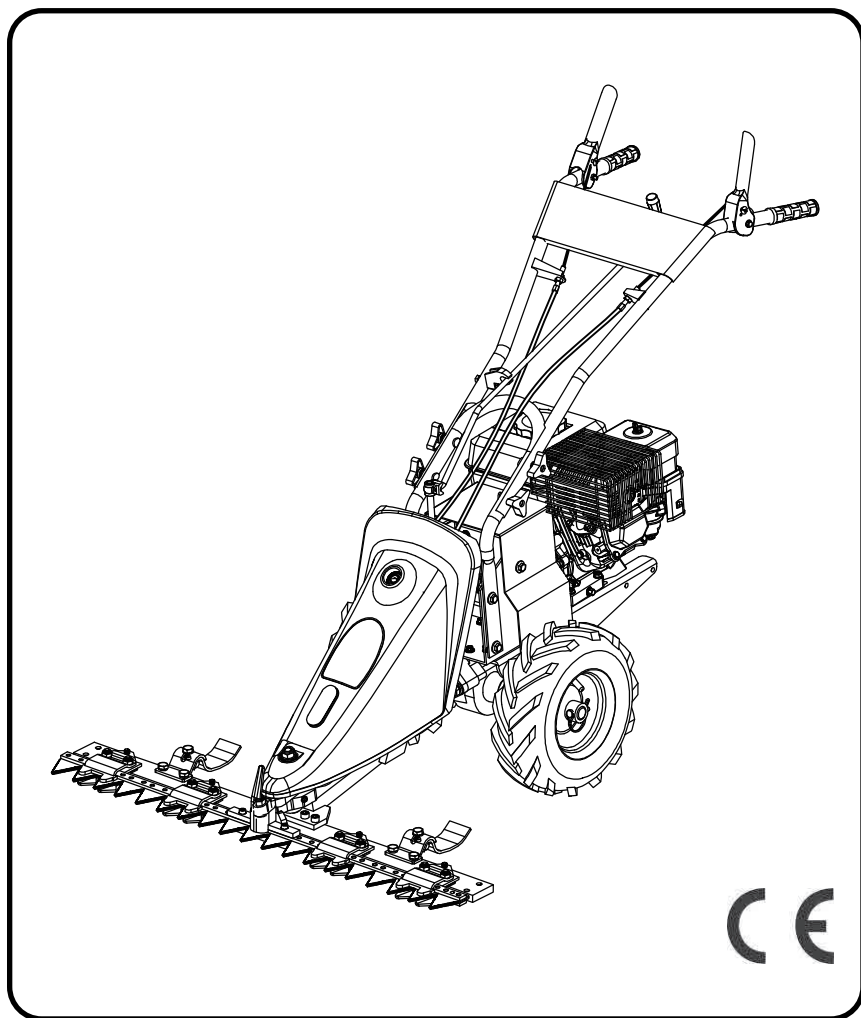

Please read the manual before use this machine!

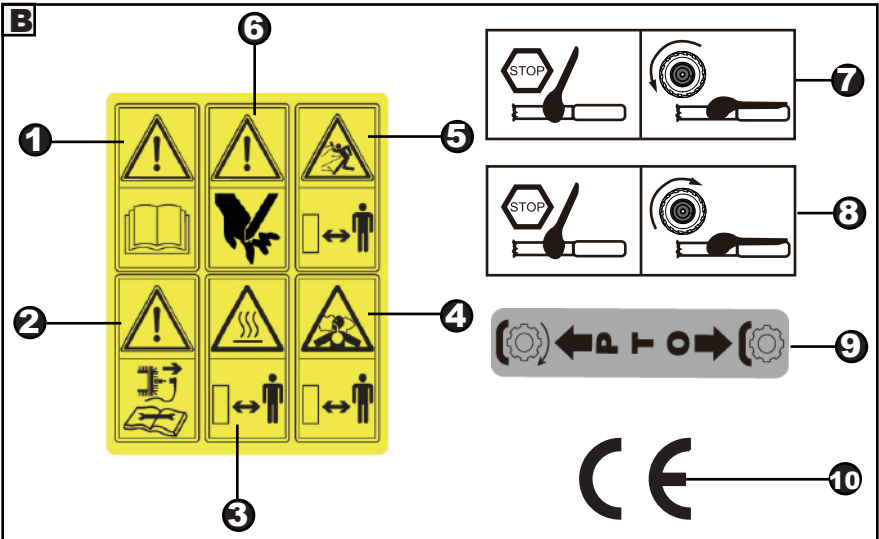

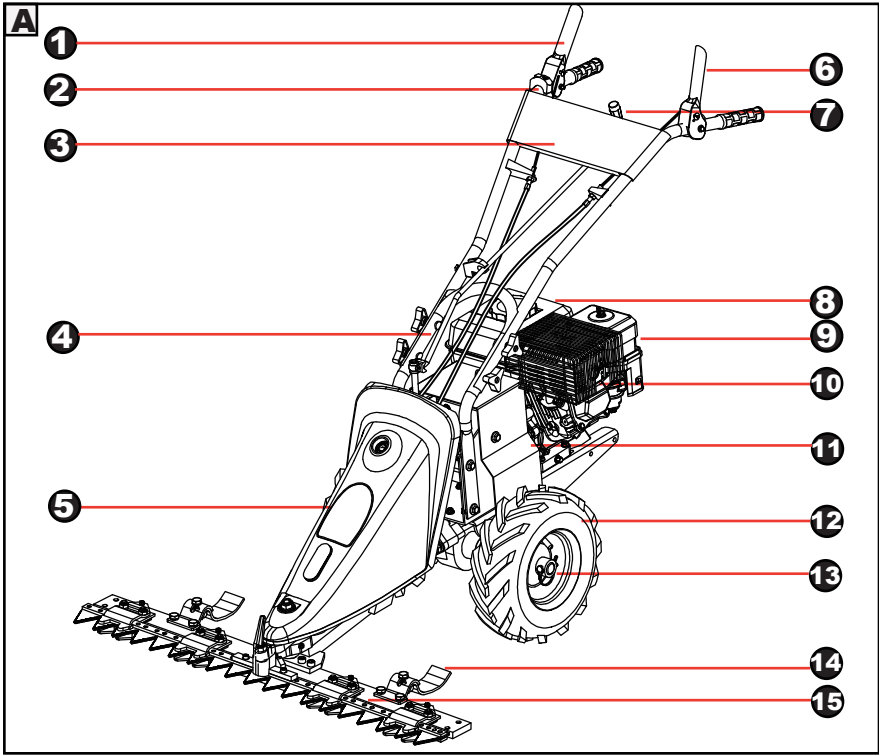
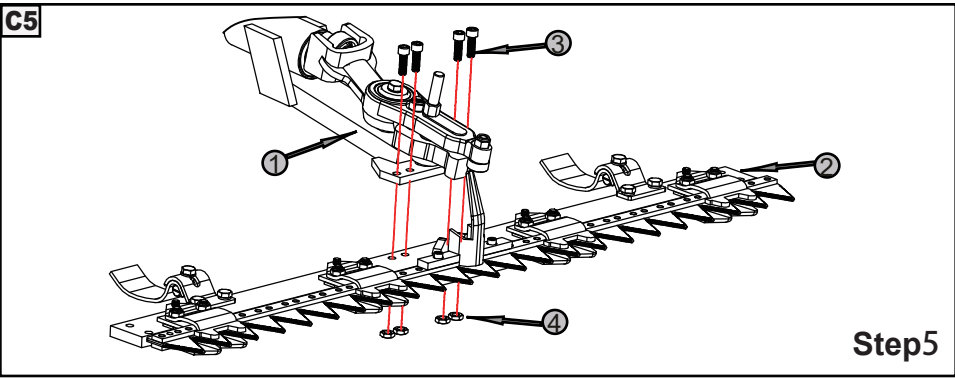
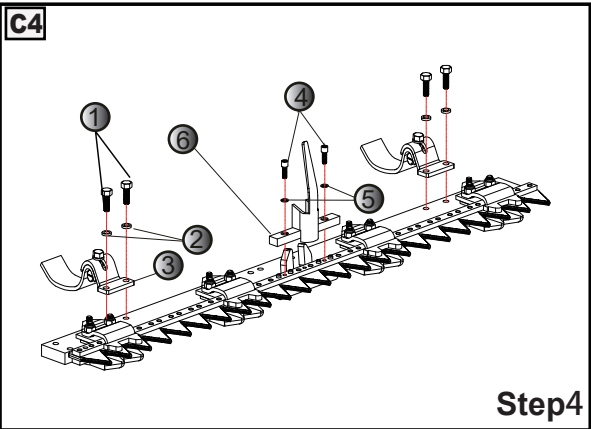
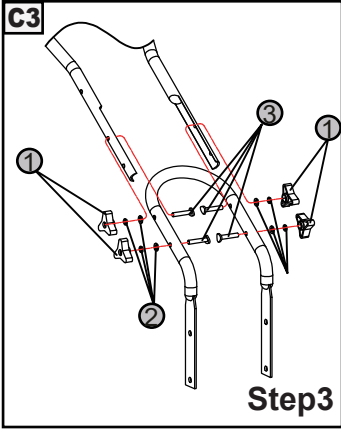
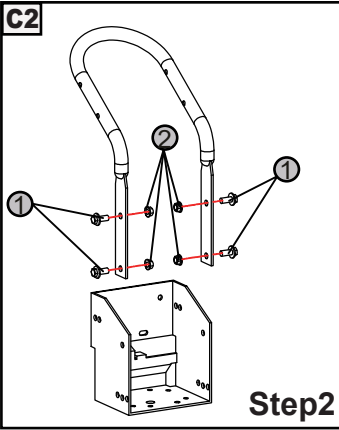
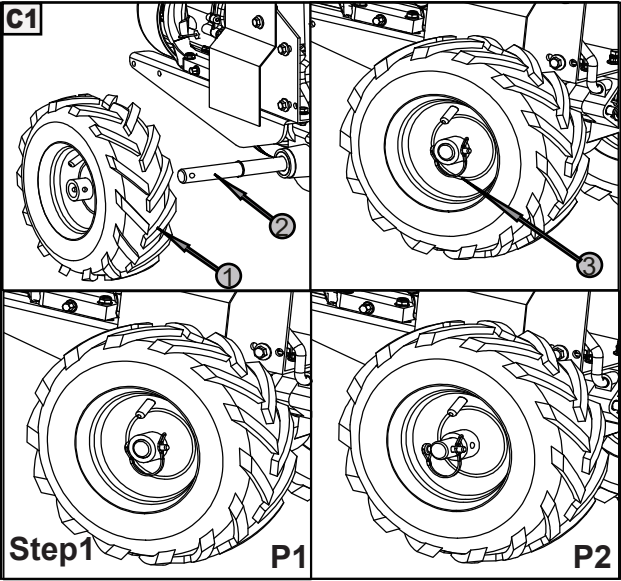

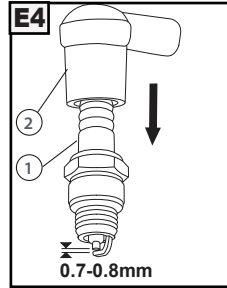
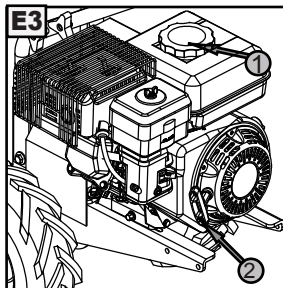
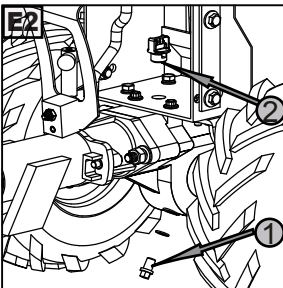
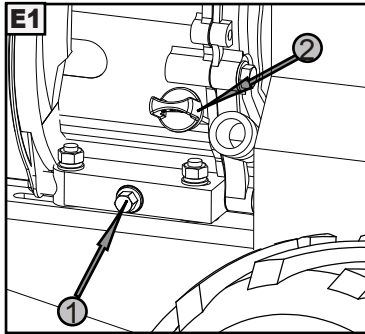
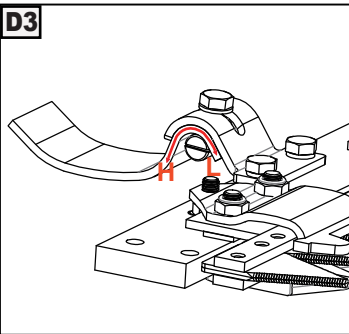
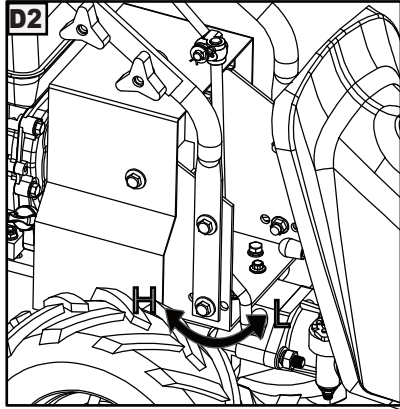
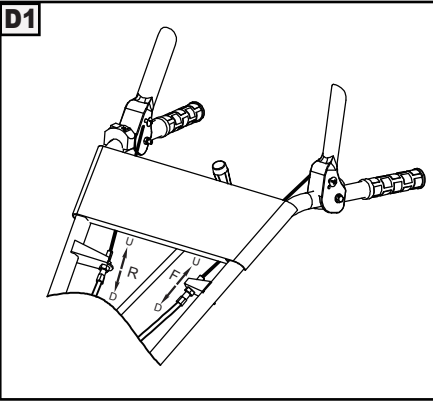
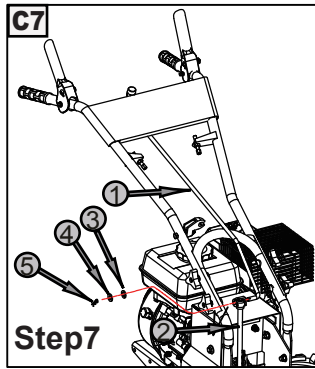
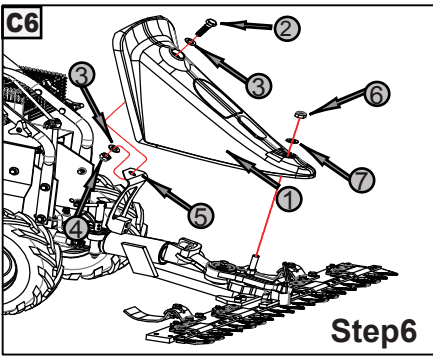

Safety instructions

General comments

Read the operating instructions carefully. Familiarise yourself with the correct operation of the mower.

Keep the operating instructions for later use and for subsequent owners.

Follow the safety instructions and warnings on the mower.

Users

Children and juveniles under the age of 16 as well as anyone who has not read the operating instructions must not operate the mower. Local regulations may specify the minimum age.

Wear long, close-fitting trousers and sturdy, non-slip footwear.

Working area

Carefully check the whole area to be mown. Remove all foreign objects, such as stones, sticks, wires, bones, etc.

Do not use the mower if there are any persons (caution: children) or animals (including wildlife) in the working area.

Operating times

Comply with any national regulations regarding operating times for lawn mowers (noise prevention).

See the operating manual for operating times.

Use the mower only in daylight or if the working area is well illuminated.

Operation

Always make a visual inspection of the mower before using it. The mower must be in a safe operating condition.

Damaged or worn parts must be replaced immediately.

Use the mower only if it is in the technical condition stipulated by the manufacturer.

The person using the mower is responsible for any accidents involving other persons or their property.

Do not disable the safety or protective devices on the mower.

Do not start the engine if anyone is standing in front of the cutter bar – the cutter and wheel drives must not be engaged.

Use the mower on grassy areas only.

The cutter drive must be disengaged when the mower is not on a mowable surface.

The blade guard must be mounted on the cutter bar if the mower is transported or lifted.

Keep hands and feet away from rotating parts.

Never lift or carry the mower if the engine is running. Wait until the cutters have stopped moving, then pull off the spark plug connector.

The mower may only be used if the safety clearance determined by the handlebar is maintained.

Ensure that you have a secure footing.

Always mow across a slope.

Never mow up or down a slope or on slopes with an inclination greater than 10°.

Keep the exhaust and engine free of leaves, grass and spilt oil.

Do not leave the mower unsupervised – pull off the spark plug connector.



Warning!

Petrol is highly flammable!

Store petrol in designated containers only.

Refill with petrol outdoors only. Do not smoke while refilling!

Do not open the tank cap or refill with petrol while the engine is running or if the machine is hot.

Use a funnel or filling tube to refill petrol to prevent fuel being spilt onto the engine, the housing or on the ground.

If petrol has been spilt, do not start the engine. Clean the mower and do not restart the engine until the petrol vapours have dispersed.

For reasons of safety, replace a damaged petrol tank and/or tank cap.

 **Risk of burns!**

The exhaust as well as the areas around the exhaust may be very hot.

Replace damaged mufflers.

Do not change the governor settings of the engine.

Never leave a combustion engine running in an enclosed space – **toxic hazard!**

Safety instructions for the cutter bar

Some of the blades on the cutter bar are bare. These can lead to serious injuries if they are not handled with care.

Always mount the blade guard on the cutter bar for the following:

- mounting the cutter bar onto the mower
- cleaning the mower
- during transport and storage of the mower
- during work on the cutter bar

Replace damaged blade guards.

Maintenance and storage

Before performing any work on the mower: switch off the engine, wait until the cutters have stopped moving and then pull off the spark plug connector.

Always wear safety gloves during work on the cutters.

If there is petrol in the tank, never store the mower in buildings where petrol vapours can come into contact with naked flames or sparks – **Risk of explosion!**

The petrol tank must be emptied outdoors only.

Allow the engine to cool before storing the mower in an enclosed space.

Do not spray the mower with water.

The mower must be repaired by an authorised specialist company only.

Spare parts and accessories

Use genuine spare parts and accessories only.

We reserve the right to make changes to the design and construction without prior notice.

Non-permitted users:

Persons who are not familiar with the operating manual, as well as children, adolescents under the age of 16 and persons under the influence of alcohol, drugs or medication must operate the mower.

MACHINE DESCRIPTION(FIG.A)

- 1.Reverse clutch lever
- 2.Flameout switch
- 3.Handlebar
- 4.Ex-arm-fixer
- 5.Protecting cover
- 6.Forward clutch lever
- 7.PTO clutch lever
- 8.Fuel tank
- 9.Air filter
- 10.Muffler
- 11.Belt cover
- 12.Tyre wheel
- 13.Lock pin
- 14.Height adjustive block
- 15.Blade assembly

DESCRIPTION SYMBOLS (FIG.B)

- 1.Before using the mower for the first time, read the operating manual!
- 2.Before working on the mower pull off the spark plug connector!
- 3.Danger of hot surfaces. Some of the outer surfaces on the machine can reach high temperatures. Some surfaces can remain hot after the motor is turned off. Keep a safe distance.
- 4.The engine gives off a poisonous, odourless and colourless gas: inhalation may cause nausea, fainting and death. Keep a safe distance.
- 5.Keep other people out of the danger area!
- 6.Keep hands and feet away from the blades!
- 7.Forward clutch
- 8.Reverse clutch
- 9.PTO clutch
- 10.Ce mark.

Assembly

Step1. Install the tyre(Fig.C1)

- Mount the tyre1 to the shaft2
- Use the lockpin to connect the holes of tyre and shaft,lock it.

Tyre have two conditions:

- P1:Tyre is locked,it is self-propelled
- P2:Tyre is not locked,it is free.

Step2. Mount Ex-arm-fixer(Fig.C2)

- Put the ex-arm-fixer on the side of conneting frame.
- Insert the bolt1,connect the connecting frame and ex-arm-fixer,use locknut2 to fix them.

Step3. Install the handlebar(Fig.C3)

- Place the handlebar on the ex-arm-fixer.
- Insert the bolt3,use the washer2 and star-nut to fix them

Step4.Assembly the height adjust block and Swing Block Assembly(Fig.C4)

- Place the height adjust block3 on the blade,place the waher2 and insert the nut1,fix them.
- Place the swing block assembly6 on the blade,place the washer5 and insert the nut4,fix them.

Step5.Mount the blade assembly

(Fig.C5)

- Place the arm-rocker1 on the blade assembly2.
- Insert the bolt3,use the nut4 to fix them.

Step6.Mount the protecting cover.(Fig.C6)

- Place the protecting cover1 on the arm-rocker assembly.
- Place the wahser3,Insert the bolt2,use the nut4 to fix them
- Place the washer7,use the nut6 to fix it.

Step7.Install the PTO lever(Fig.C7)

- Insert the upper PTO lever1 into the down PTO lever2
- place two washers3,4.Use the uncork5 to fix it.

Note:The shake of this machine is very big on its work,so every bolt or nut must be tighten specially.

Adjustment

Note:All the adjustments are started after trun off the engine.

- a).Adjusting the forward and reverse clutch line to adjust the belt tension or loosen.
(Fig.D1)
 - If forward belt is not proper,please adjust the "F" line,toward "U" will loosen the belt,"D" will tension the belt.
 - If reverse belt is not proper,please adjust the "R" line,toward "U" will loosen the belt,"D"will tension the belt.
- b).Adjust the handlebar height(Fig.D2)
There are three holes for adjusting the handlebar height,toward to "H" will be higher,toward to "L" will be lower.
- c).Adjust the cutting height(Fig.D3).
Cutting height adjustive block can control the cutting height,if toward "H" ,the cutting height will be highter,if "L",will be lower.

 Both skids must be set to the same height !

Operation

1.Pre-operation check

a)Engine oil(Fig E1)

CAUTION:Running the engine the low level cause serious engine damage.

- Remove the oil filter cap2 and wipe the dipstick clean;
 - insert the kipstick into the oil filler neck, but dot not screw it in;
 - if the level is low,fill to the top of the oil filler neck with the recommended oil.
- Use high-detergent,permium quality 4-stroke engine oil
- if you want to drain out all the oil,loosen the oil nut1.

Temperature for use	Degree of oil viscosity
From -10° C to 0° C	SAE 10W or 10W-30,10W-40
From -0° C to 25° C	SAE 20W or 10W-30,10W-40
From -25° C to 35° C	SAE 30W or 10W-30,10W-40
From -35° C to 45° C	SAE 40W

b). Gear box oil (Fig. E2).

- Gear oil has been filled at the works.
- if you want to drain out all the oil, screw out the nut 1, the oil will drain out automatically.
- Screw out the oil cap 2, if the level is low, fill to the top of the oil filler neck with the recommended oil.

c). Fuel (Fig. E3)

- Use automotive gasoline (unleaded or lowleaded is preferred to minimize combustion chamber deposits).
Never use an oil/gasoline mixture or dirty gasoline.
Avoid getting dirt, dust or water in the fuel tank.
- Open the tank cap 1
 - turning it in an anti-clockwise direction
 - Fill the tank up to a maximum of 3cm beneath the cap.
 - close the tank cap by turning it in a clockwise direction.

Adjustment

Before start the engine, please do the adjustment, which is introduced in upper content.

Start the engine

CAUTION: be sure that the clutch is disengaged and the shift lever is in the neutral position to prevent sudden uncontrolled movement when the engine starts. The clutch is engaged by pulling in the clutch lever and disengaged by releasing the clutch lever.

- Turn the fuel valve to ON. Check up the tightness of drain knob
 - Close the choke lever .
- NOTE: Do not use the choke if the engine is warm or the air temperature is high.
- Turn the engine on/off switch to ON in the handbar.
 - Move the throttle lever slightly to the MAX.
 - Pull the starter grip (2) lightly until resistance is felt, then pull briskly.
 - As the engine warms up, gradually open the choke.

Effective the wheel drive

Make sure the lock pin in P1 piston, so that the machine will be in self-propelled.

Make the cutting bar working

- engage the forward clutch lever
- pull the PTO lever, the machine will work.

Backward the machine

- pull back the PTO lever.
- engage the reverse clutch lever, the machine will be backward and the cutting bar is not working

Switching off the engine

- make sure the PTO lever is not in working condition.
- switch off the engine.

Maintenance and servicing

 **Before carrying out any maintenance or cleaning work, pull off the spark plug connector!**

Do not spray the mower with water. Water that enters the ignition system or the carburettor may lead to malfunctions. Clean the mower with a cloth, hand brush, etc.

Replacing the engine oil

Check the oil level on a daily basis and top up if necessary. Replace the oil after the first month or after the first 20 hours of use. Then replace it every 6 months or after every 80 hours of use.

Spark plug

Check it every 3 months or after every 50 hours of use, and replace it if necessary.

See the specification in reference to the spark plug type.

1. Remove the cap 2 (Fig. E4) and unscrew the spark plug 1 with the relative spanner.
2. Examine the spark plug and remove any carbon residue with a metal brush. Replace the spark plug if the electrodes are excessively worn or the insulation is damaged.
3. Measure the distance between the electrodes: it should be between 0.7 and 0.8 mm (Fig. E4).
4. Screw the spark plug back in by hand.
5. Secure a used spark plug with around VA turn of the spanner, and a new one with around V2 turn of the spanner.

Air filter

Clean it every 3 months or after every 50 hours of use, and replace it if necessary.

1. Unscrew the filter box knobs
2. Remove the cover.
3. Remove the filter.
4. Knock it gently on a flat surface.
5. Replace the filter in its housing.
6. Replace the box cover and screw on the knobs.

Fuel tubes

Make sure that there are no cracks in the fuel pipe and that the joints are solid on a daily basis. Check that there are no fuel leaks. Replace where necessary.

Cutter bar

Clean the cutter bar after every use, particularly the guidance and sliding surfaces. This means dismantling the cutter. Afterwards, oil all moving parts.

Use only biodegradable lubricants!

Expert inspection is required for the following:

- if the mower strikes an object
- if the engine stops suddenly
- if the cutter bar is bent
- if the gears are damaged
- if the V belt is defective

Drive gears

Check the oil level in the gearbox regularly

- Make sure the mower is horizontal.
- Unscrew the oil plug.
- Oil level: up to lower edge of filling opening
Top up with gear oil, if necessary.
- Oil grade: gear oil SAE 75
- Oil capacity for mowers with: approx. 0.45 l

Troubleshooting



Before carrying out any maintenance or cleaning work, pull off the spark plug connector!

Fault	Remedial action
--------------	------------------------

Engine does not start

If the engine is cold: press the primer
Full up with petrol
Move the throttle lever to the start position
Push the spark plug connector onto the spark plug
Check the spark plug. Replace, if necessary
Clean the air filter

Engine power reduced

Resharpener / replace the blades → customer service centre
Clean the air filter

Inexact cut

Resharpener / replace the blades → customer service centre
Readjust the cutting play

Cutter drive / wheel drive
not functioning

Readjust Bowden cable
V - belt defect → customer service centre

Faults that cannot be rectified with the aid of this table must be eliminated by an authorised workshop only (customer service centre).



Specification

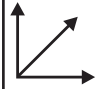

ca.146cm x 97cm x 113cm



ca. 85kg



97cm



6.5HP 3600⁻¹



5.00 - 6



ca. 2.1km/h



L_{WA} 104 dB(A)



a_{vhw} 5.5m/s²



F7TC,F7RTC