

PROJECT : \_\_\_\_\_  
SALE : \_\_\_\_\_

# Lampitude

## Product

## Dimension

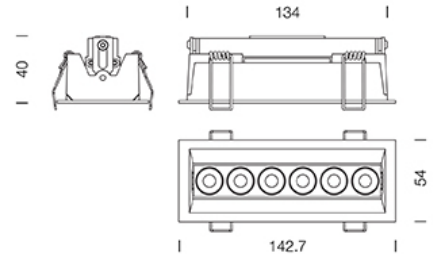

## Specification

|               |   |
|---------------|---|
| SERIES        | : ST-JGSQ                                   |
| ITEM CODE     | : ST-JGSQ602-9W-60D-3000K-WH+BK             |
| DESCRIPTION   | : ADJUSTABLE ANGLE RECESSED MICRO DOWNLIGHT |
| SIZE          | : W54 X L142.7 X H40 (MM)                   |
| INSTALLATION  | : RECESSED DOWNLIGHT                        |
| DRILL SIZE    | : L135 X H45 (MM)                           |
| WEIGHT        | : 0.4 KG                                    |
| MATERIAL      | : POWDER COATED ALUMINUM                    |
| COLOR         | : WHITE                                     |
| REFLECTOR     | : BLACK ALUMINUM                            |
| DIFFUSER      | : N/A                                       |
| IP RATING     | : 20  |
| LIGHT SOURCES | : POWER LED 6PCS                            |
| SOCKET        | : -   |
| WATTS         | : 9W  |
| VOLT          | : 220~240V AC 50/60Hz                       |
| CCT           | : 3000K                                     |
| CRI           | : RA≥90                                     |
| BEAM ANGLE    | : 60D                                       |
| LUMEN POWER   | : -   |
| LIFETIME      | : 50,000 Hrs                                |
| CONTROL GEAR  | : LED CONSTANT CURRENT DRIVER               |
| ACCESSORIES   | : -   |
| REMARKS       | : -   |

Head office 299/1 (Ekamai) Klongton-Nua, Wattana, Bangkok Thailand 10110

Tel (02) 392 6371-5 FAX (02) 392 1839 Email [info@lampitude.net](mailto:info@lampitude.net) [www.lampitude.net](http://www.lampitude.net)