

PROJECT : \_\_\_\_\_  
SALE : \_\_\_\_\_

## Product

## Dimension

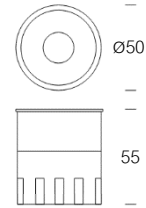

## Specification

SERIES	: CGBU-LUC15W-LED-CN50
ITEM CODE	: CGBU-LUC15W-LED-CN50-2.7K-6.0K-10D-TW
DESCRIPTION	: LED MODULE
SIZE	: Ø50 X H55 (MM)
WEIGHT	: 0.11 KG
INSTALLATION	: -
DRILL SIZE	: -
MATERIAL	: ALUMINIUM
COLOR	: DARK GREY
REFLECTOR	: -
DIFFUSER	: -
IP RATING	: 20
LIGHT SOURCES	: LED COB
INPUT CURRENT	: 0.35 A (DC 9-42 V)
POWER (WATTS)	: MAX 15 W
LUMENS	: 990-1100 lm
BEAM ANGLE	: 10°
CCT	: 2700K-6000K
CRI	: 90
AMBIENT TEMP.	: -25°C to +40°C
LIFETIME	: 35,000 Hrs
CONTROL GEAR	: LED DRIVER NOT INCLUDED (typ. with CGCT-AU-A1SBLCX15-CCF+LT)
ACCESSORIES	: -
REMARKS	: OPTIONAL DRIVER BY REQUEST

PROJECT : \_\_\_\_\_  
 SALE : \_\_\_\_\_

Product	Dimension
---------	-----------

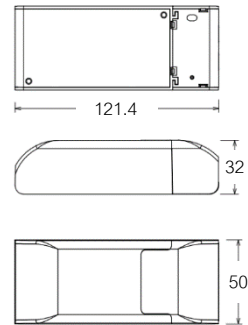

Specification	
---------------	--

SERIES	:	CGCT-AU-A1SBLCX15-CCF+LT
ITEM CODE	:	CGCT-AU-A1SBLCX15-CCF+LT
DESCRIPTION	:	CONSTANT CURRENT TW DRIVER
SIZE	:	W50 X L121.4 X H32 (MM)
WEIGHT	:	0.11 KG
INSTALLATION	:	SURFACE MOUNTED
DRILL SIZE	:	-
MATERIAL	:	PC
COLOR	:	WHITE/BLUE
REFLECTOR	:	-
DIFFUSER	:	-
IP RATING	:	20
DIMMABLE	:	LI SMART
INPUT VOLTAGE	:	AC 220-240 V, 50/60 Hz
OUTPUT VOLTAGE	:	DC 30-40 V
POWER RANGE	:	7.2-15 W
POWER FACTOR	:	≥0.9, @FULL LOAD, 230Vac
CCT	:	-
CRI	:	-
AMBIENT TEMP.	:	-20°C to +45°C
LIFETIME	:	35,000 Hrs
CONTROL GEAR	:	-
ACCESSORIES	:	-
REMARKS	:	DIP SWITCH 180/200/250/350mA

