



Join the Movement

Stay clear on the latest and greatest by visiting our website at [ClearlyFiltered.com](https://clearlyfiltered.com) and connect with us on social media to tap into our Clearly Filtered® family:



PRODUCT INSTALLATION GUIDE
VIDEO TUTORIAL

Quick Tips:

Your filter is built for cold tap water only. Do not attempt to filter hot water.

Superior filtration takes time. A full reservoir of water can take up to 35 minutes to filter. This means your filter is doing its job to make every drop as clean as possible.

Never wash your filter with soap, however your pitcher body can be hand washed with soap and water regularly.

Replace your filter every 100 gallons filtered. For most customers, this is every 3-4 months. See the 'When to replace your filter' section of this guide for more details.

Go to [ClearlyFiltered.com/PitcherFilters](https://clearlyfiltered.com/PitcherFilters) to get replacement filters and learn more about our free filter subscription service.

Always store the priming bag and any unused filters in a cool, dry location.



Troubleshooting:

Pressure is key to force water through the filter during step 2 of setup; 'Prime Filter'. That's why we recommend squeezing the bag forcefully with two hands.

If your filter is leaking, remove then reattach it to the base of the reservoir to ensure the gasket is securely in place.

If you find filtration is taking more than 35 minutes, "soak" your filter by leaving it submerged upright in tap water in a large bowl, container or glass overnight. The following day, reprime your filter before retesting it.

Excessive sediment can slow down your filter. If filtration is taking abnormally long, check your sediment levels.

HELP & RESOURCES:

We have a friendly support team and a library of online resources dedicated to you. Here's how to get help:

- Visit our Help & FAQs page at help.clearlyfiltered.com.
- Email our support team at info@clearlyfiltered.com.
- **Live chat** with a team member at clearlyfiltered.com.
- Call our support team at **+1 (877) 876-2740**

**Business Hours: M - F 9am-4pm PST; excluding holidays*

Subscribe & Save:

Never run out of clean water with replacement filters delivered straight to your door and 10% off every filter when you sign up for our free filter subscription service.

SUBSCRIPTION BENEFITS:

- **Save 10%** on every filter.
- Get **free shipping** in the USA.
- Pick your **preferred shipping frequency**.
- **Pause, skip, and adjust shipping frequency, or cancel at any time.***
- **No long-term contract required.**

**Go to [ClearlyFiltered.com/Subscription](https://clearlyfiltered.com/Subscription) for more information.*

Contact our support team at (877) 876-2740 or info@clearlyfiltered.com to get enrolled today.

When to replace your filter:

To maintain peak performance, a filter change is recommended at **every 100 gallons filtered.*** Your pitcher's top reservoir holds 1/2 gallon of water. That means if you fill the top reservoir twice a day, your filter should be changed every 100 days (or roughly every 3 months).

If you are not tracking gallons or referring to the Filter Change Tracker included with your pitcher, follow the guidelines below for replacing your filter:

- 4+ People: Replace filter every 2-3 months.**
- 2-3 People: Replace filter every 3-4 months.**
- 1 Person: Replace filter every 4-6 months.**

**Filter life can be impacted by water quality.*

IMPORTANCE OF REPLACING YOUR FILTER:

After 100 gallons filtered, your filter's effectiveness drops. As overuse continues, dangerous chemicals, metals, and toxins can pass through your filter and into your water.



WATER PITCHER FILTER Installation Guide

Like you, we have high standards for our water. That's why your filter contains our renowned Affinity® Filtration Technology; the most powerful filtration technology on the market. Your filter must be primed before first use to deliver superior results. Then it must be replaced regularly to maintain performance.

IMPORTANCE OF PRIMING YOUR FILTER:

Every filter **MUST** be primed before first use to perform properly. Priming is the process of preparing the filter by forcing running water through it. This simple step pushes air out of the filter, loosens up the filtration media, and ensures it's ready for water to flow through so contaminants are captured and eliminated.

ClearlyFiltered®

Components

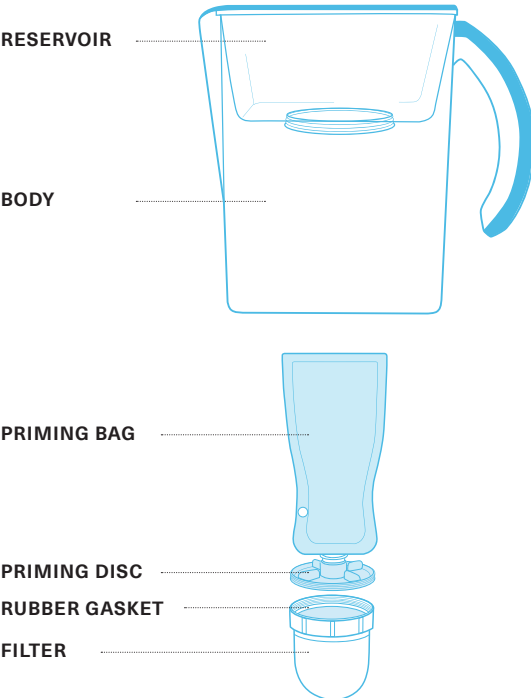

STEP 1

REMOVE STICKER

- 1 Hand twist the disc to disconnect the priming bag from the filter.
Please note: The priming disc and priming bag should always remain connected to one another throughout the priming process.

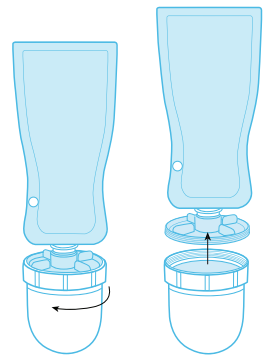

- 2 Remove the blue protective sticker covering the filter's intake holes.

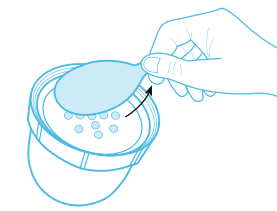

STEP 2

PRIME FILTER (DO NOT SKIP)

To ensure your filter works efficiently and effectively, you must prime it prior to first use.

- 1 Flip the included priming bag upside down so the priming disc is facing the faucet. Hold the disc below the faucet, then turn the cold water on gradually until a steady stream of cool water flows through the disc's hole into the bag.



- 2 Run water until the bag is full.



- 3 Once the bag is full, twist the threaded base of the filter (flat side) onto the disc until snug to create a seal between the two.
Ensure the rubber gasket stays in place on the filter when twisting the filter onto the disc.

- 4 Flip the bag right side up so the filter is oriented beneath the bag.

- 5 Hold the bag over the sink, then forcefully squeeze it with both hands to force the water inside down through the filter. Squeeze hard enough to see water dripping out of the bottom of the filter. We recommend using the same amount of pressure as you would to force the last few drops of toothpaste out of a tube. Continue to squeeze the bag until empty.

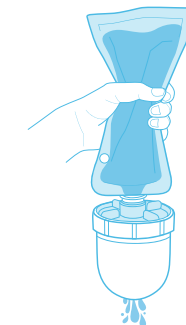

Please note: It is normal for water to escape from the edges of the priming disc and spill over the edges of the filter where the two components connect.

- 6 We recommend repeating this process two or three times. Once again refill the bag, then squeeze the water in the bag through the filter. Water should drip through the filter indicating that the filter is primed and activated.

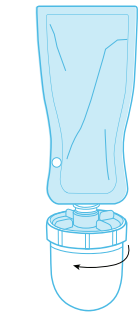

- 7 Once the bag is empty, hand twist the filter to disconnect it from the disc and bag. Pour out any remaining water left.
Please note: Save the priming bag in a cool, dry location for future use.

STEP 3

CONNECT FILTER TO RESERVOIR

- 1 Remove the back lid from the reservoir, then pull out the reservoir.

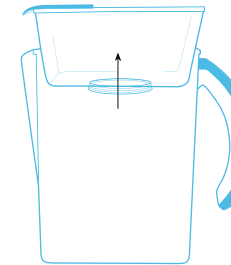

- 2 Twist the filter onto the threaded base of the reservoir.

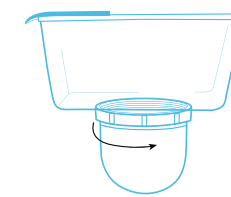

STEP 4

INSTALL & ENJOY

- 1 Place the filter and reservoir into the pitcher body.

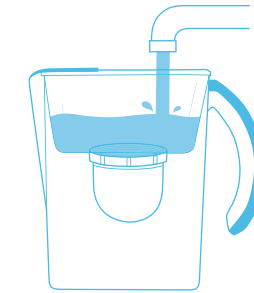

- 2 Fill the reservoir with cold or room temperature tap water.

- 3 Slide the back lid on top of the reservoir until it clicks into place.



- 4 Enjoy your clean and safe water.