

Assemble Front Axle, Wheels, and Spacers. Use a Spacer on the outside of each Wheel as a Hub Cap. Assemble Doors with Hinge Pins.
Place Seat Supports in slots in FloorPan. Apply glue to edges of Seat Supports and press Seat Back and Seat Bottom into place. Allow to dry. Glue Center Console in place. Congratulations! You're ready to roll!

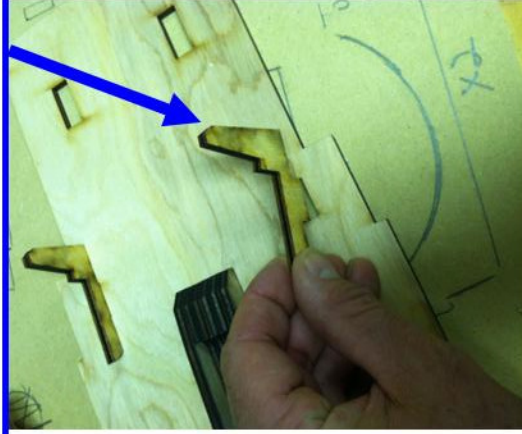

Construct A Truck USA

Dearborn, Michigan

U.S. Ranger Command Vehicle Kit Assembly Instructions



VIN: _____

Builder: _____

Build Date: _____

Register your VIN after vehicle is completed.

Email info from Title and Registration card to: VIN@constructatruckusa.com

*All designs, documents and processes © 2014
SHELFactory LLC and Construct A Truck USA*

TruckMaker's Pledge

*I pledge allegiance to my
Manufacturing talents,*

And to the

Construct A Truck USA company

That stands for the inherent

Satisfaction and benefit

Of making something

With my own hands.

To honor the skills,

Talents, and abilities

Of all engineers,

Who invent, design, or

Manufacture

So many valuable, necessary or

Desirable products that help

Make our economy strong

And our Nation great.



Things you will need to build this kit:

1. Wood glue
2. Rubber bands to hold parts together
3. Masking tape to hold parts together
4. Pliers to hold the threaded axle rod
5. Wrench (7/16" or adjustable) to tighten axle nuts
6. Brush-on or spray paint
7. Phillips head screwdriver
8. Slotted screwdriver

Construct A Truck USA

Dearborn, Michigan

www.constructatruckusa.com

Questions? Comments? Email us: kits@constructatruckusa.com



Assemble the frame rails and cross-members, and glue to the floor pan. Let glue dry for at least ten minutes.

Slide on Inner and Outer Windshield panels, as shown.

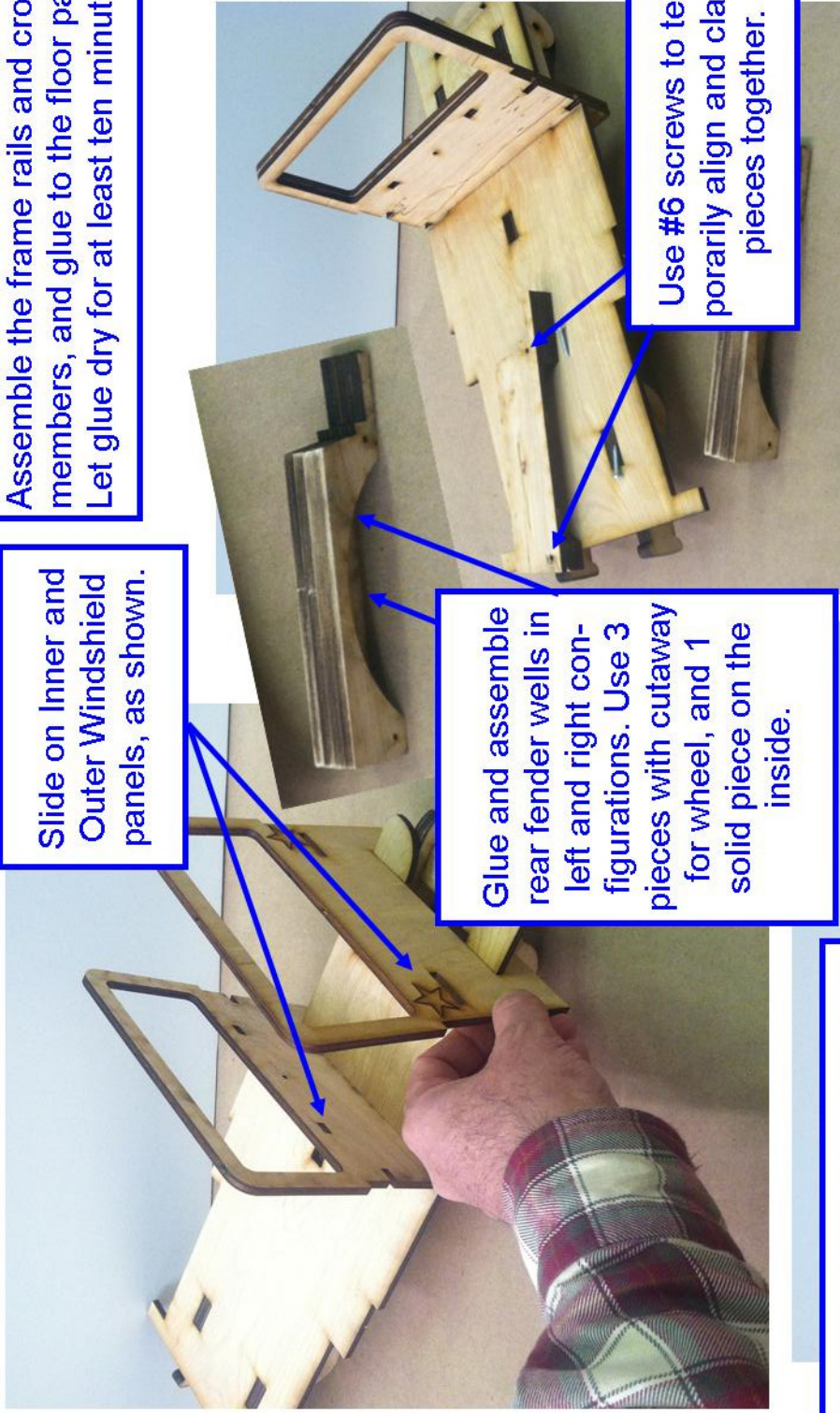

Glue and assemble rear fender wells in left and right configurations. Use 3 pieces with cutaway for wheel, and 1 solid piece on the inside.

Use #6 screws to temporarily align and clamp pieces together.

When dry, remove screws. Apply glue to fender well and re-use #6 screws to align and clamp Inner Side Body Panel to the fender well.

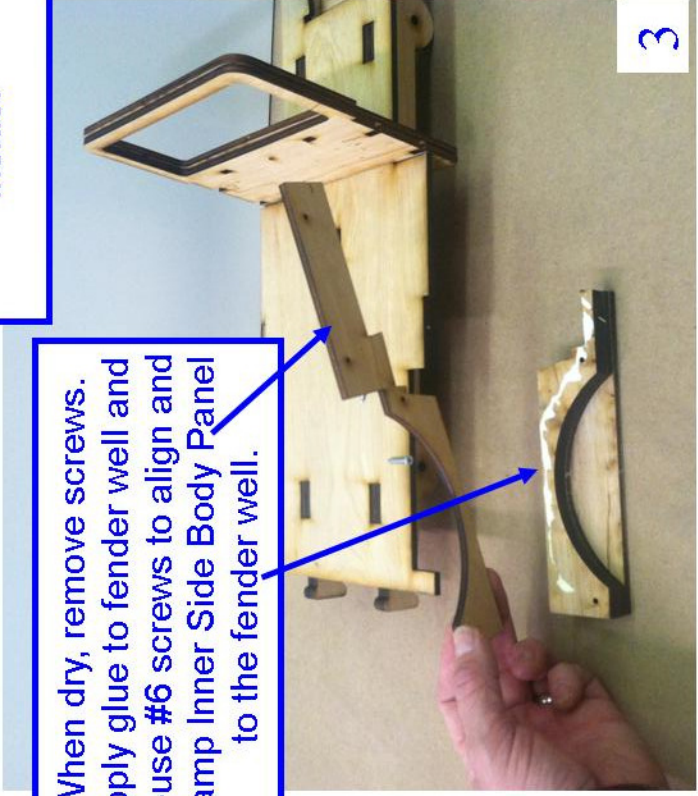
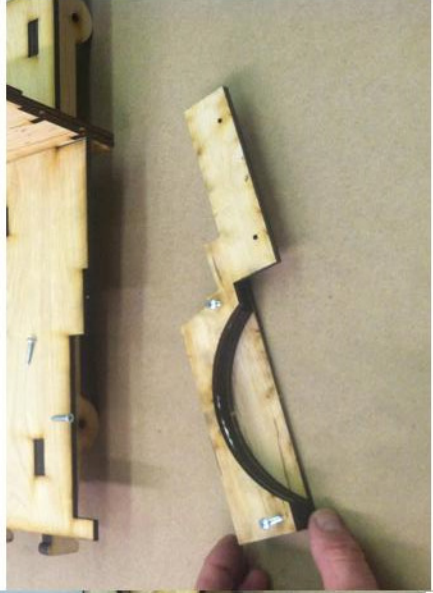

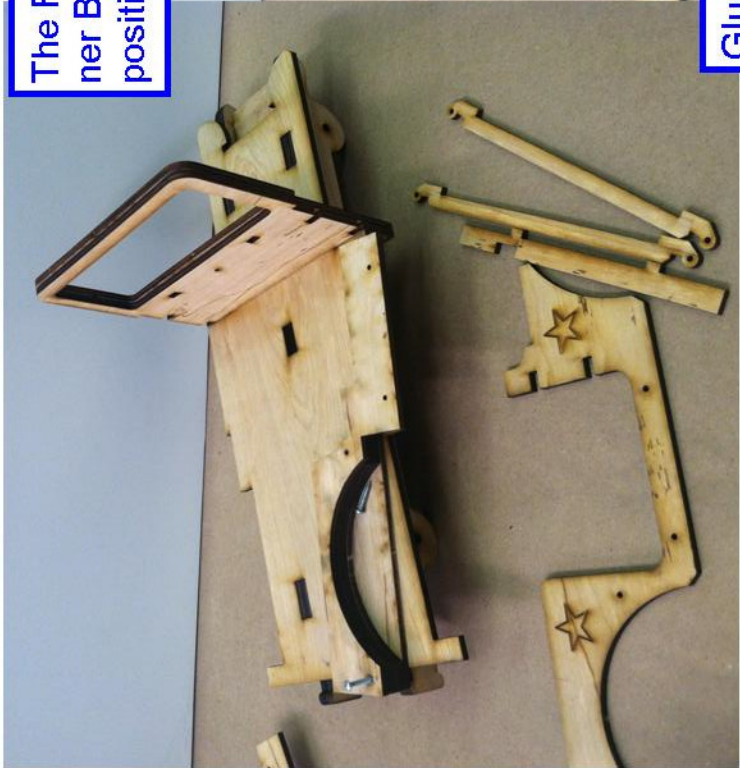

The Fender Wells with Inner Body Side Panels set in position, but not glued yet.

The next several pictures with a **BOLD** border must be completely glued and then assembled before the glue dries. The **BOLD**-border photos show the assembly and installation of all the body panels, which get glued to the floorpan and the front dash panel.

Glue front dash panels together and slide back in position. Glue Right Body Panel to edge of Front Dash Panel

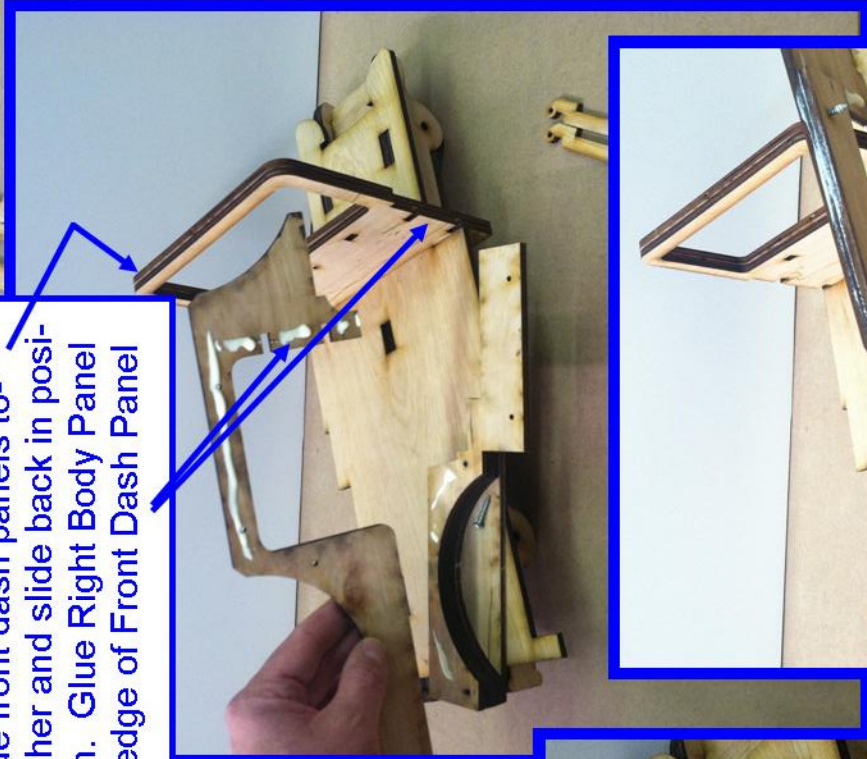

Use #6 machine screws to align and clamp Right and Left Body Side Panels (*not the #6 sheet metal screw shown*)

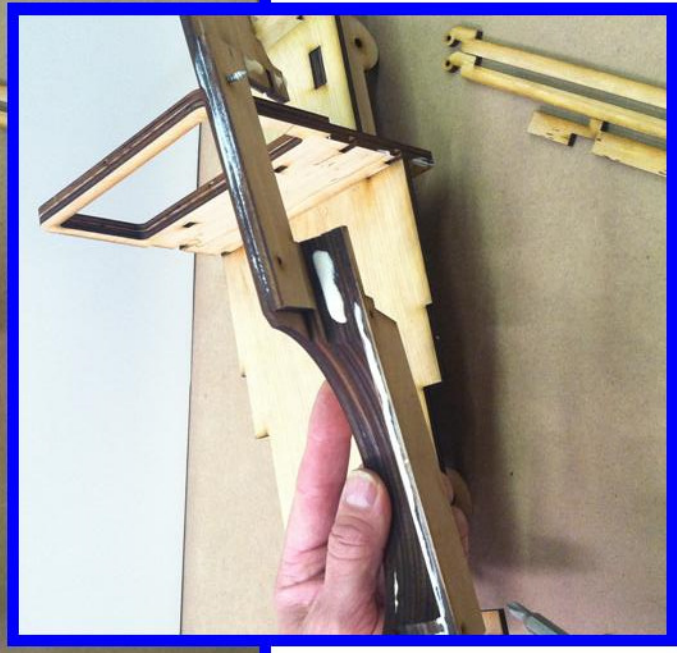

Glue right and left Body Side Panel Assemblies onto Floor-pan and Front Dash Panel. Assemble Rear Tailgate by gluing all mating edges and surfaces and then hooking piece in place.

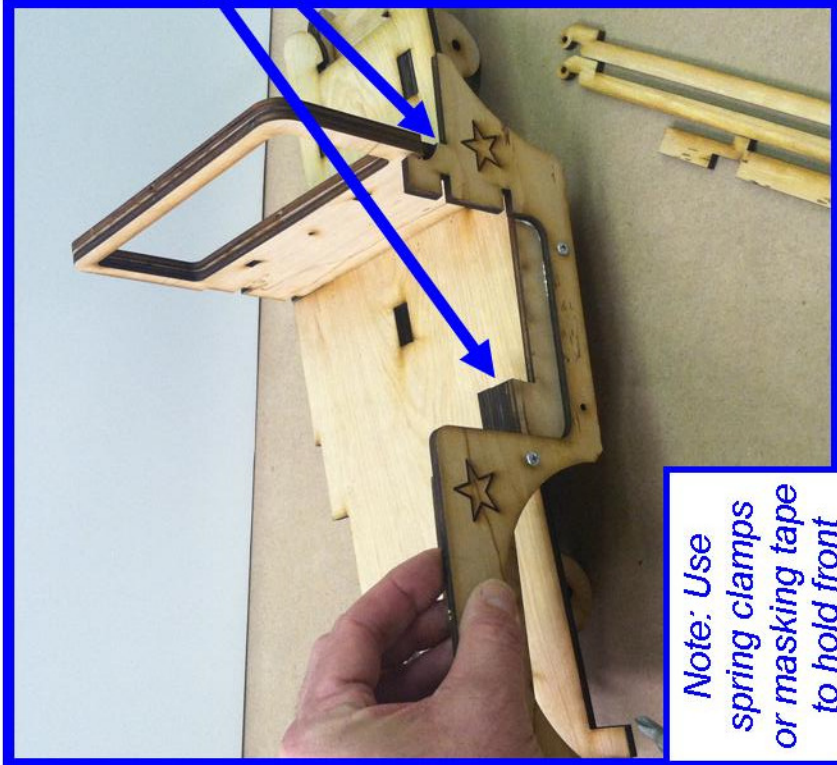

Note: Use spring clamps or masking tape to hold front dash panels together while glue is drying.

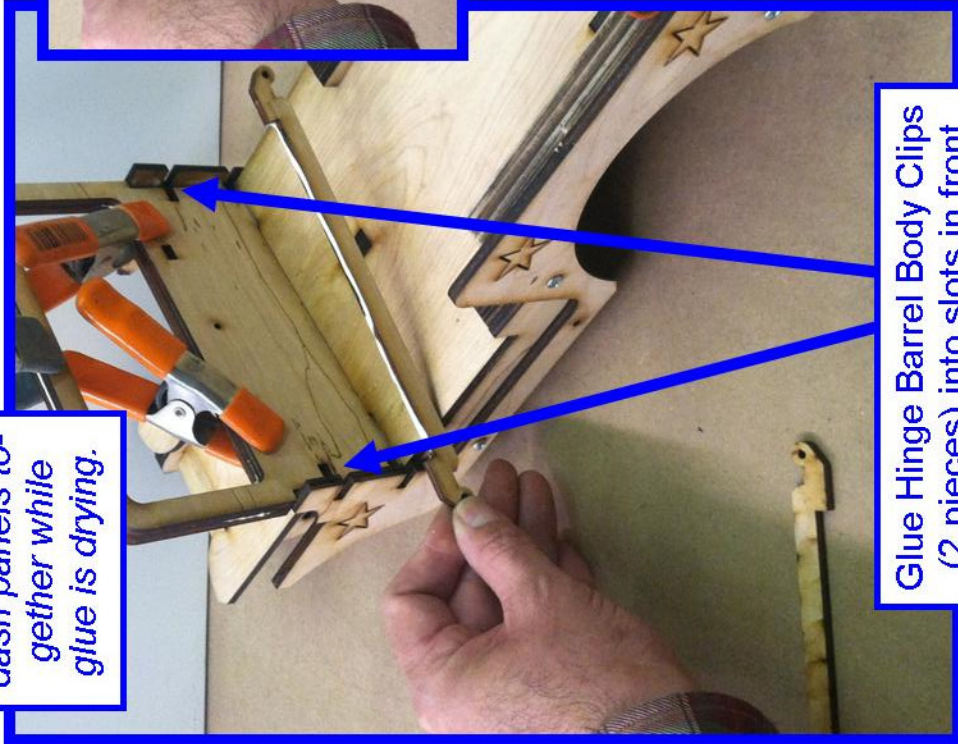

Glue Hinge Barrel Body Clips (2 pieces) into slots in front corners. Glue and assemble Upper Dash Board

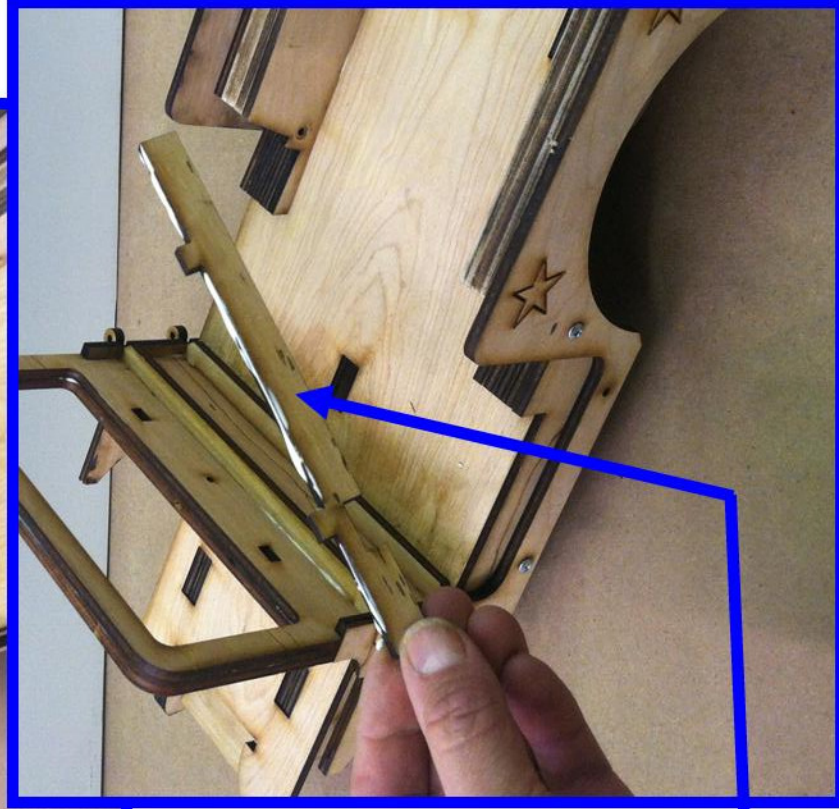
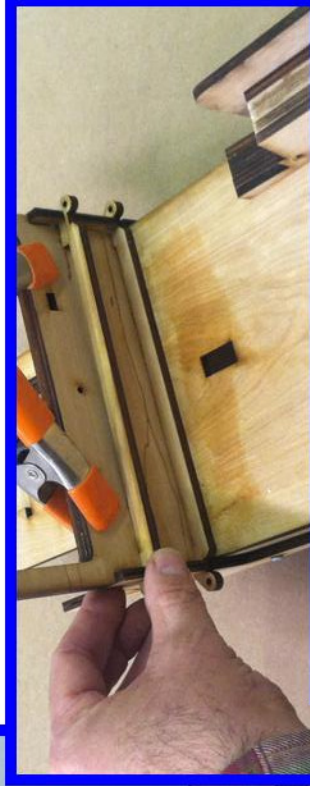

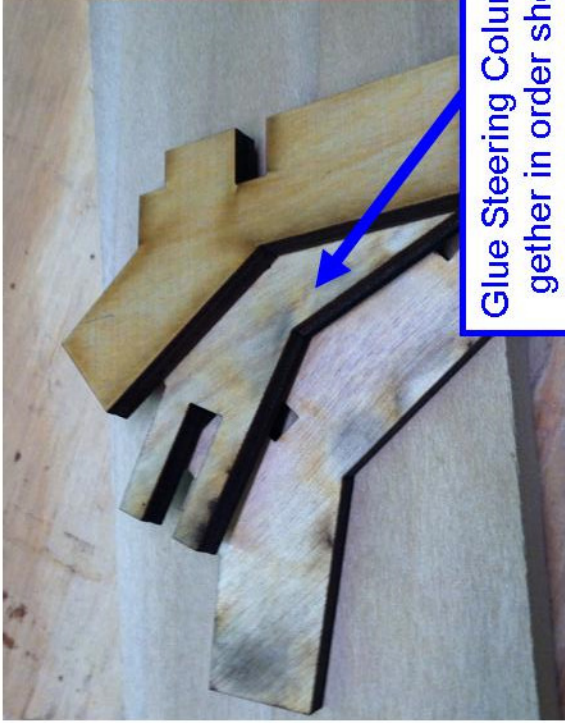

Glue Steering Column pieces together in order shown. When dry, apply glue and assemble into Upper Dash Board

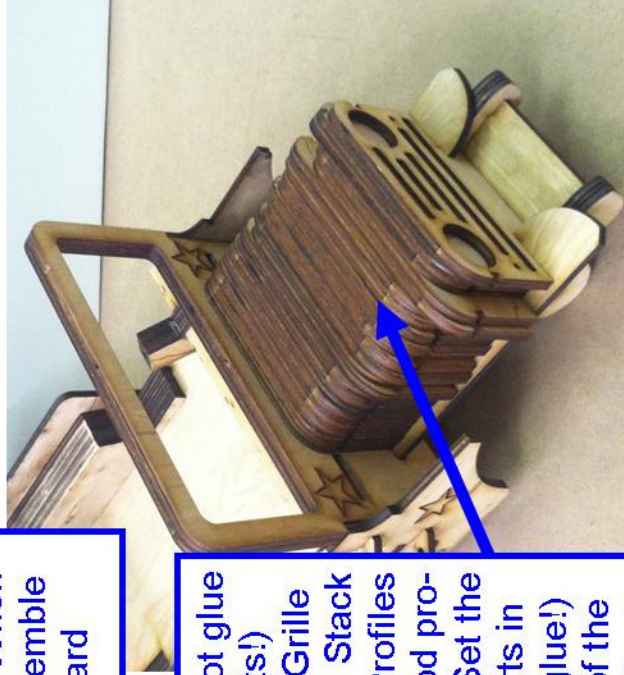
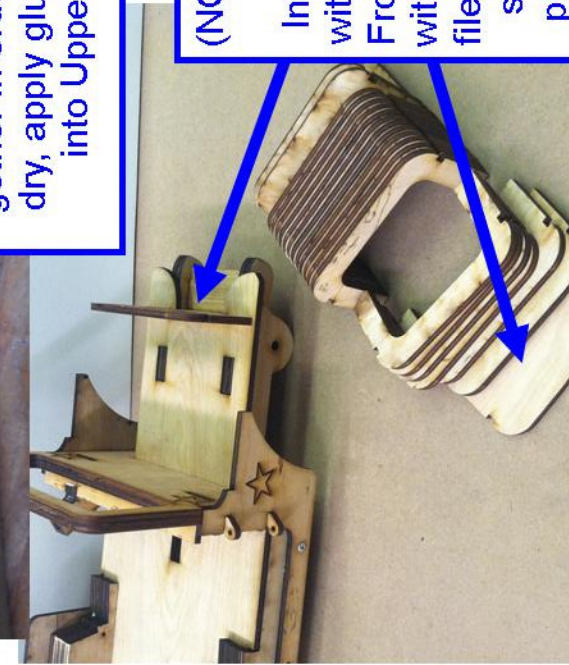
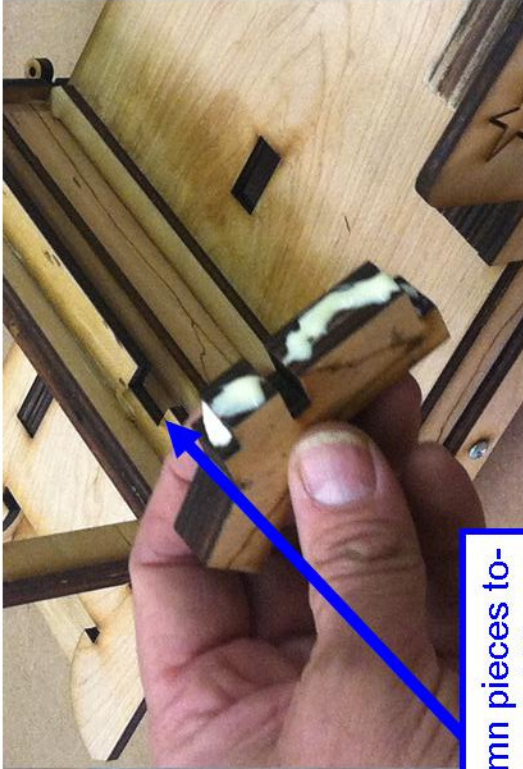

(NOTE: Do not glue these parts!)
Insert Front Grille without glue. Stack Front Hood Profiles with solid hood profile at front. Set the stack of parts in place. (No glue!)
Insert one of the Fenders without glue in order to align all the Front Hood Profiles

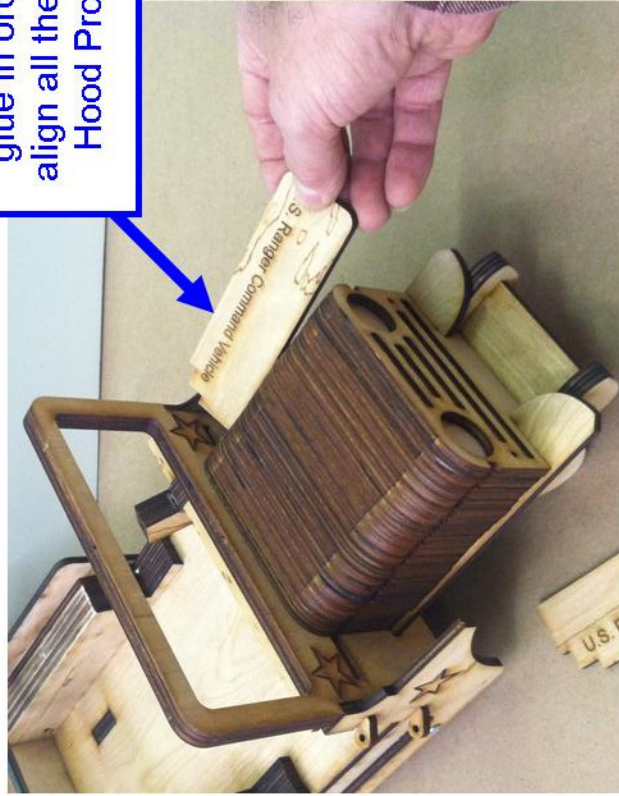

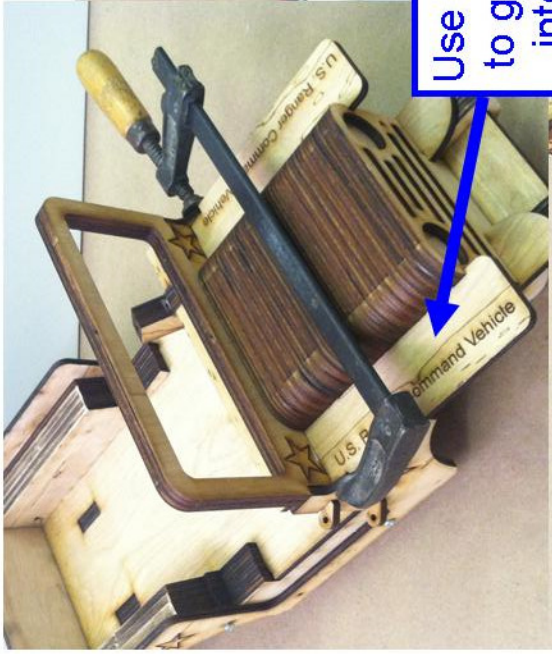

Use a clamp if necessary to gently press Fenders into Front Hood slots. Then, carefully remove one Fender, apply glue, and re-insert. Check alignment of all mating parts. Allow to dry. When dry, remove other Fender. Apply glue to edges and re-insert.

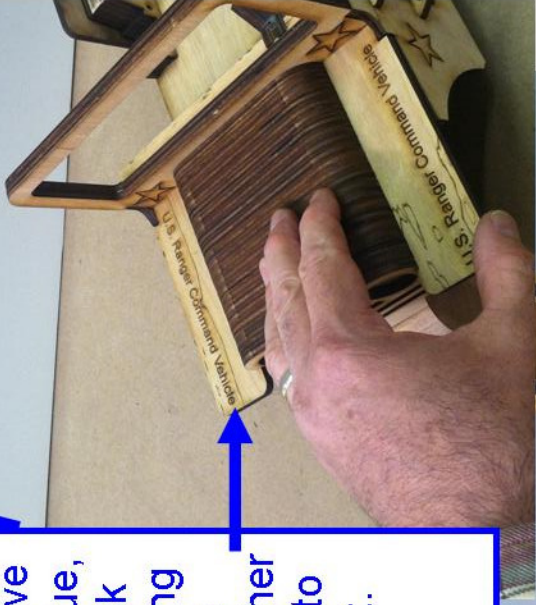

Assemble Steering Wheel. Place vehicle upside down on table. Insert Rear Axle. Assemble 6 Spacers and Wheel on each side. (Assemble 4 Wheel Pieces with #6 sheet metal screws..)

