

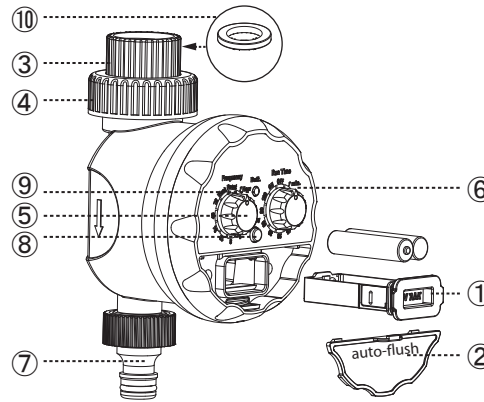

DS-AF15 AutoFlush Installation and Operation Guide

Designed for Installation With
All Desert Spring Rotary Disc
Humidifier Models

TIMER FEATURES



① Battery compartment & ② Battery compartment cover

Slide out the battery compartment ①, and insert 2x (LR03/AAA) 1.5V alkaline batteries.

⚠ WARNING

- Use only fresh alkaline batteries at the beginning of the season. DO NOT use rechargeable batteries.
- Test the unit by turning the Run Time knob to ON position. You should hear the sound of the motor within 10 seconds. If you do not hear the sound, check if the batteries are installed correctly.
- Turn Run Time to OFF position before connecting to the drain of the humidifier.

③ 3/4" Drain adaptor & ④ Collar ring

Turn loose the collar ring ④ until the drain adaptor ③ is unlocked, screw the drain adaptor ③ on to the drain tight and then lock them tight with the collar ring ④.

⚠ WARNING

DO NOT use spanners or pliers to avoid damage to the timer.

⑤ Frequency knob

Determine flush interval, ranging from once per hour to once per week.

⑥ Run Time knob

Choose how long to flush the humidifier, ranging from one minute to 120 minutes.

⑦ Male snap-on connector

Connect hose attachment to the male snap-on connector ⑦ at the bottom of the timer.

⑧ Delay button

To delay the start watering time, press Delay button for more than 3 secs until led is constantly ON, then each press of delay button means 1 hour delay of the next start watering time. (EXAMPLE 3)

⑨ Led indicator

Led indicator flashes once every 4 seconds.

⚠ WARNING

Replace with new batteries if led indicator flashes quickly or on steady.

⑩ Washer

Ensure washer is in place for proper seal.

PROGRAM TIMER

- Set Frequency: determine how often you will flush the humidifier from once per hour to once per week.
- Set Run Time: determine how long to flush the humidifier, ranging from one minute to 120 minutes.

NOTE: The first cycle will start X hours later, X is the set Frequency hours.

⚠ WARNING

Frequency should always be longer than Run Time. (Example: Frequency=1H, Run Time=90 minutes, is NOT a valid setting.)

EXAMPLE 1 : To flush 2 times a day for 3 minutes, set Frequency to 12 and Run Time to 3. First flush will start 12 hours after the knobs are set.

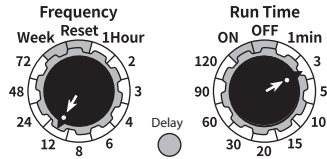

EXAMPLE 2 : To flush once a day for 3 minutes, set Frequency to 24 and Run Time to 3. First flush will start 24 hours after the knobs are set.

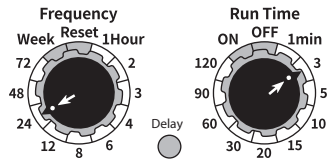

⚠ WHEN MAKING CHANGES AFTER INITIAL SETTINGS:

- Wait for min 3 seconds for timer to validate new settings after each change, which is indicated by quick flashing of the led indicator
- Every change of Frequency will recalculate the next start of the watering time. But the change of the Run Time dial will not change the next start watering time.

EXAMPLE 3 : How to use Delay button

Now is 8:00 am, your setting is Frequency=24 and Run Time=15, which means to flush for 15 minutes every 24 hours, so timer will start flushing at 8:00 am everyday.

If you want the timer to flush at 10:00 am everyday, which means 2 hours delay of current clock time 8:00 am, just press Delay button for 3 seconds until led is constantly ON, then press again twice the Delay button, timer will then start flushing at 10:00 am every 24 hours.

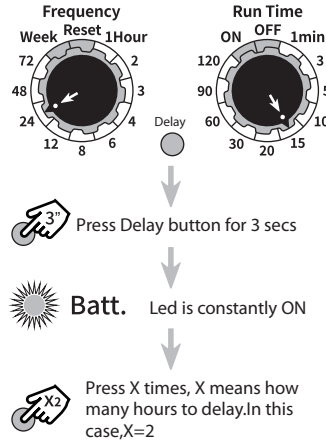

MANUAL FLUSHING

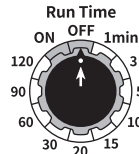

1. To start manual flushing, set Run Time to ON
2. To stop manual flushing, set Run Time to OFF
3. When done, set Run Time to other desired setting

PROTECT TIMER FROM DAMAGE

1. This timer is cannot be used for industrial purposes nor can it be in contact with food, chemicals or pesticides.
2. Timer is water resistant, NOT waterproof. DO NOT submerge the timer in water.
3. Operating water pressure is from 0 bar to 8 bars (0 psi to 116 psi).
4. DO NOT pull the hose while attached to the timer, to avoid damage to timer.
5. If timer does not work, please read through instruction to double check or contact below.



WARNINGS

- In case of long absence, change the battery before leaving.

AVERTISSEMENTS:

- En cas d'absence prolongée, veuillez changer la pile.

HEAD OFFICE:
Desert Spring Eco-Products Ltd
Mississauga, ON L5T 2C8
CANADA

Tel: (888) 486-4324
(905) 629-2010
Fax: (905) 795-1377

Website: <http://desertspringproducts.com>
Email: info@desertspringproducts.com

DISCLAIMER:

Except as expressly stated in this manual, Desert Spring Eco-Products Limited makes no representation or warranty with respect to the AutoFlush unit and disclaims all implied warranties including any warranty of merchantability or fitness for a particular purpose. In no event will Desert Spring Eco-Products Limited be liable to any customer or user of the humidifier for any indirect, incidental, or consequential damages or loss of revenues or profits, whether the same are foreseeable or not, occasioned by any cause whatsoever including, but not limited to, the installation or operation of this AutoFlush unit. © 2019