

# Connection types

other connection types on request

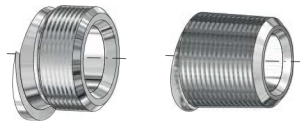

Connection according to	Thread connection	
<i>to</i>	DIN ISO 228	ASME B 1.20.1
<i>pipe standard</i>	G	NPT

Flanges		
DIN 2526 DIN EN 1092-1	DIN 11864 T2 Type A and B	APV Varivent, etc.
DIN 2448 DIN 2458 DIN EN 10220	DIN 11850 DIN EN ISO 1127 ISO 2037 BS 4825-1	-

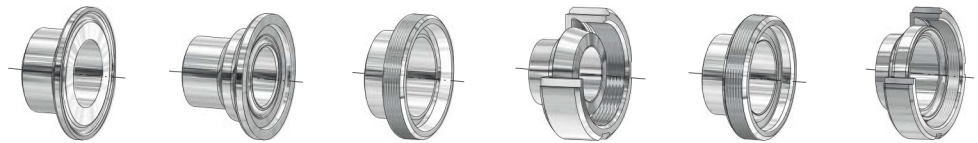

Connection according to	Clamp	Threaded / Conical connecting piece	Aspetik male / Female union
<i>to</i>	DIN, ISO, SMS	DIN 11864 T3 Type A and B	DIN 11851
<i>pipe standard</i>	DIN 11850 ISO 1127 ISO 2037	DIN 11866-A DIN 11866-B DIN 11866-C	DIN 11864 T1 Type A and B
		DIN 11850	DIN 11850 DIN EN ISO 1127 ISO 2037 BS 4825-1

## Options:

- GB: Medium-contacted surfaces with surface quality  $R_a = 1,6 \mu\text{m}$
- GC: Medium-contacted surfaces with surface quality  $R_a = 0,8 \mu\text{m}$
- GD: Medium-contacted surfaces with surface quality  $R_a = 0,5 \mu\text{m}$
- K0.5: Delta ferrite content = < 0.5% incl. weld seams
- SPA: Flushing connection G 1/4" in the spring bonnet
- VHP: Valve completely hand-polished on the outside