



EK-RS-01, 96-00 Civic
EG-RS-01, 94-01 Integra/92-95 Civic

Refer to endlink install instructions on how to install endlinks.

After bar assembly is completed install assembled hollow bar onto vehicle equipped with ASR Subframe Brace. Use the hardware provided with your subframe brace to mount.

1 Slide shaft collars onto bar with ASR logo facing inwards first.

2 Slide Delrin ball with pillow block onto bar after shaft collar.

7 Center hollow bar to vehicle.

8 Push shaft collar against delrin ball and tighten set screw to finalize assembly.

3 Install Swaybar arms onto bar at the same "clocked" position.

5 Tighten hex screw.

4 Be sure that both arms are in the same "clocked" position.

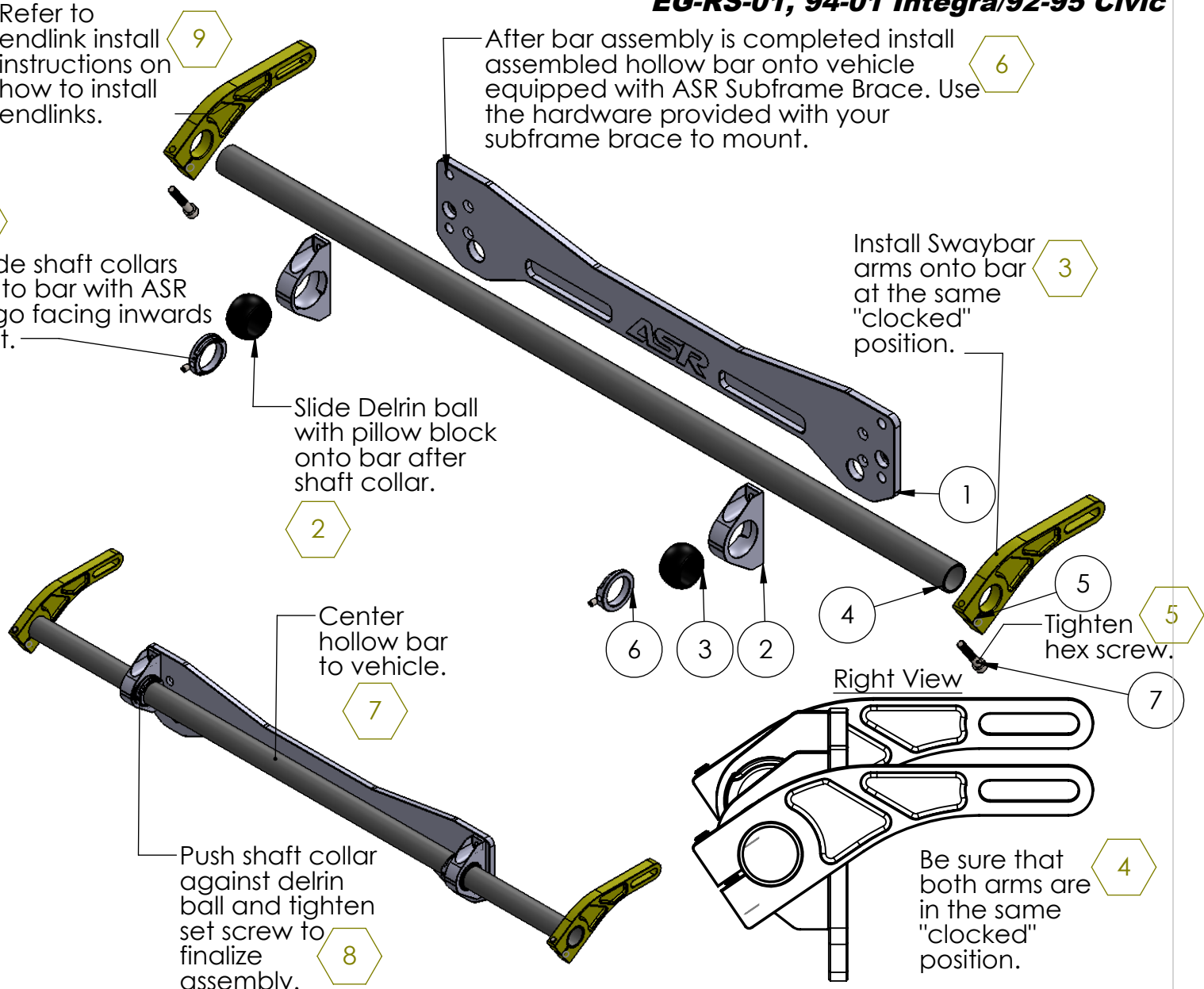

ITEM NO.	PART NUMBER	DESCRIPTION	QTY.
1	EK/EG-RB	ASR Subframe Brace	1
2	32M-PB-01	Pillow Block	2
3	32M-RPD-01	32mm Delrin Bushing	2
4	** -RS-0**	32mm Hollow Bar	1
5	EK/EG-HBA-01	Hollow Bar Arm	2
6	32M-SC-01	Shaft Collar	2
7	M8X45MM	Socket Head Hex Bolt	2
8	M8X9	Socket Set Screw	2

PROPRIETARY AND CONFIDENTIAL
 THE INFORMATION CONTAINED IN THIS DRAWING IS THE SOLE PROPERTY OF **A-Spec Racing**. ANY REPRODUCTION IN PART OR AS A WHOLE WITHOUT THE WRITTEN PERMISSION OF **A-Spec Racing** IS PROHIBITED.

For install video go to:
<https://www.youtube.com/watch?v=DbGtGhNBzPo>