

BATTERY INSTALLATION

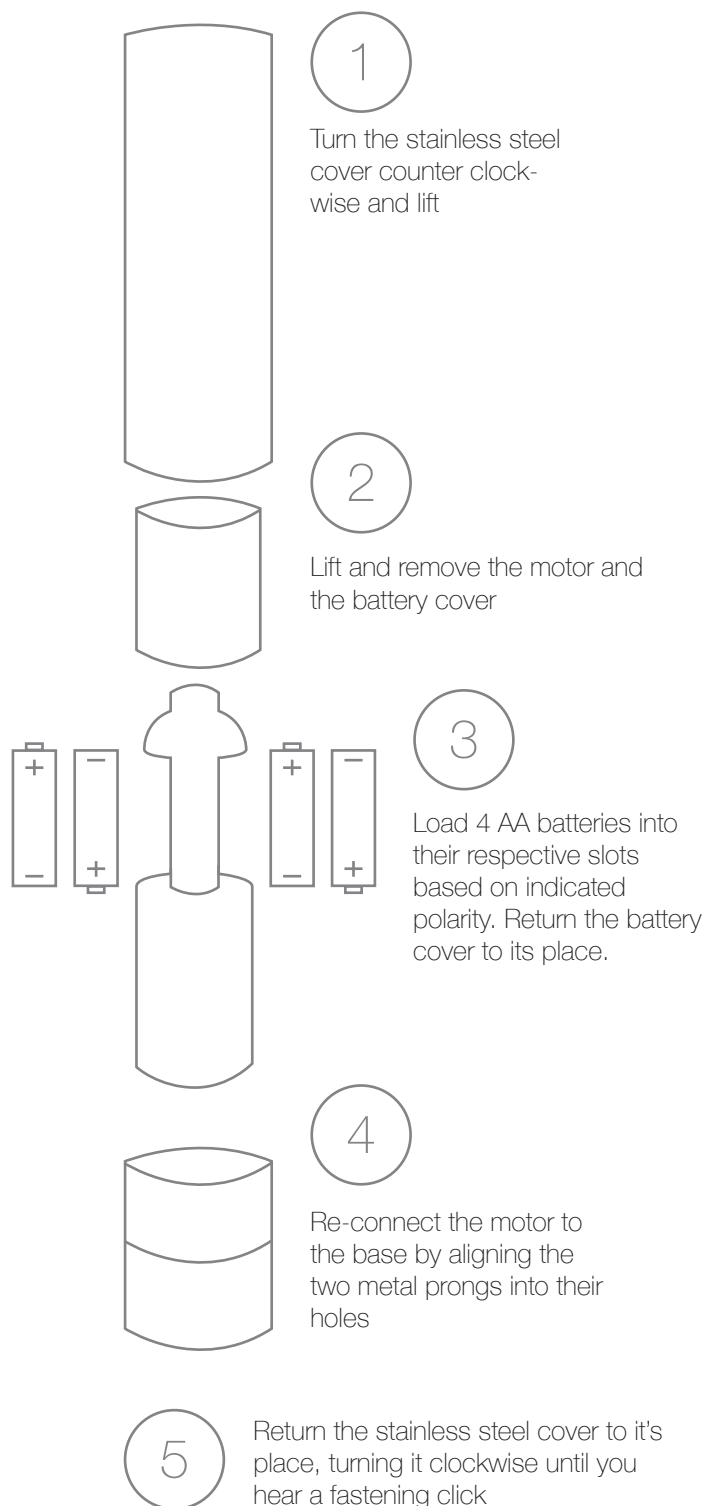

REFILLING SPICE

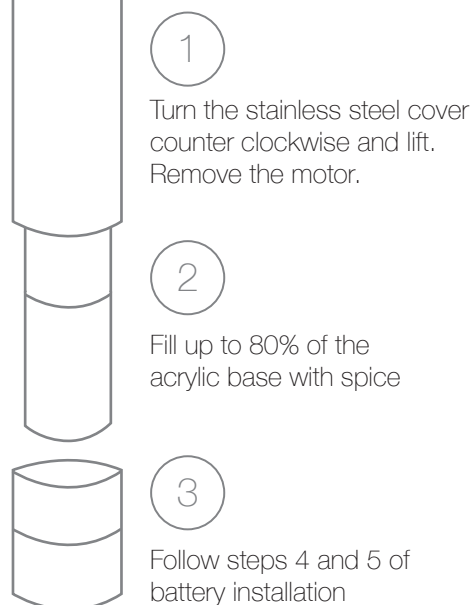

FINENESS ADJUSTMENT

Adjusting knob is located on the bottom of the base. Turn clockwise for a finer grind and counterclockwise for a coarser grind.

CLOGGING PREVENTION

In some rare instances, your grinder could get clogged with residue (peppercorn or sea salt) if this happens, flip your mill grinder side up and turn your adjustment knob counterclockwise until you feel a slight resistance (you cannot completely remove the adjustment knob), then push the residue downward using a pointed object to clean the grinder area. Once clean, turn the adjustment knob clockwise back to your desired grind level.

CLEANING AND CARE

Wipe the outside of the mill with a soft, damp cloth. Never immerse your mill in water. Store your mill in a dry place.

CAUTION

Do not use different types of batteries together. Do not mix old and new batteries. Always remove exhausted batteries and dispose of safely. Clean battery contacts and also those of the device prior to battery installation. Never fully tighten the knob below the base. Keep fingers clear when attaching cover.