

Warnings

C2 only: With ambient temperature +25°C the flashlight delivers light in Maximum mode for about 6-10 minutes and then the brightness decreases by 35%. After cooling-down (at sufficient voltage level) the brightness increases to the Maximum mode again. This stepping goes cyclically to maintain the user's safety and the flashlight's functionality. In conditions of good air-cooling the flashlight delivers light without stepping down even in Maximum mode. There are no preset timers for stepping, but real-time active temperature measurements.

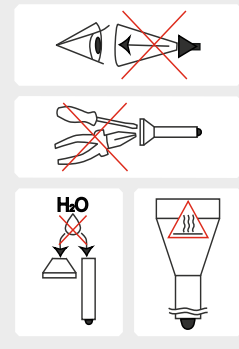

1. Always follow the instructions from this manual and recommendations on battery usage.
2. Apply only the recommended power sources.
3. Do not reverse battery polarity.
4. Do not use different power sources together, i.e. old ones with new ones, charged with discharged. Do not use different types of batteries combined as the element with less capacity can be damaged.
5. Do not modify or recast the flashlight and its components as it will deprive you of the warranty.
6. Do not allow water or any other liquid to leak into the flashlight.
7. Do not aim a turned-on flashlight at people's or animals' eyes – it can cause temporary blindness.
8. Do not allow children to use the flashlight without your assistance.

! Armytek Optoelectronics Inc. shall not be liable for any harm done to the user if it was caused by improper use of the product.

Care and Storage

It is recommended to clean the threads and O-rings off dirt and old grease. Remember that secure protection from water and dust cannot be provided by worn out sealing. And fouling as well as lack of lubricant cause fast wear-out of threads and sealing rings.

To clean the threads do the following:

1. Unscrew the tailcap and remove the sealing ring carefully with a toothpick (do not use sharp metal things as they can damage the ring).
2. Wipe the sealing ring thoroughly with a soft cloth (or tissue). Do not use solvents. If the sealing ring is worn out or damaged replace it by a new one.
3. Clean the metal threads with a brush using ethanol. Be careful not to allow applied liquid to get inside the flashlight or tailcap as it can cause fails in functionality of the flashlight.

After cleaning lubricate the thread and the sealing ring with polyalphaolefin-based silica grease, e.g. Nyogel 760G. The application of automotive and other improper grease can cause swelling and damage of the sealing rings.

In case of active operation and exploitation in dusty environments, it is recommended to perform cleaning and lubricating of the parts as often as required, even if it is more than twice a year.

Service and Warranty

Armytek provides free warranty repair for 10 years from the purchase.

Warranty doesn't cover damage caused by:

1. Improper usage.
2. Attempts to modify or repair the flashlight by nonqualified specialists.
3. Longtime application in chlorinated or polluted water, or other liquids (other than water).
4. High temperatures and chemicals' exposure (including the exposure of liquid from defected batteries).
5. Usage of low-quality batteries.

Armytek Optoelectronics Inc.

Web: www.armytek.com Email: service@armytek.com
Address: 67 Vandervoort Dr, Richmond Hill, Ontario, L4E 0C7, Canada

Specifications are subject to change without notice.

Prime

THE MOST TECHNICALLY ADVANCED
FLASHLIGHTS IN THE WORLD

— USER MANUAL —

Thank you for choosing the products of Armytek Optoelectronics Inc., Canada.
Please read this manual carefully before using the flashlight.

Specifications

Armytek Optoelectronics Inc. is a Canadian manufacturer that produces powerful and reliable flashlights designed especially for your needs applying in them components made in the USA and Japan. **10 years no-hassle warranty.**

- Superb light of amazing constant brightness due to powerful electronics and active temperature control without timers
- Efficient TIR-optics and no "tunnel vision" effect even after continuous use
- Warning Indication of low battery level and high temperature
- Side switch for comfortable one-hand operation and easy modes switching
- Ultra low current drain in OFF-state - more than 25 years
- Removable clip, comfortable holster and possibility of tail-stand for multipurpose use
- Compact and light-weight flashlight of guaranteed durability stands up harsh impacts and falling from 10 meters
- Total protection from water, dirt and dust penetration - flashlight continues to work even at the depth of 10 meters

Model	Prime A1	Prime A2	Prime C1	Prime C2
LED / Optics	Cree XP-L / TIR			
Brightness stabilization type	FULL stabilization (constant brightness)**			
Light output, LED / OTF lumens*	450 / 370	620 / 500	500 / 400	1200 / 1050
Peak beam intensity, candelas	3050	4250	3100	8800
Hotspot/spill	20°/80°			
Beam distance*	110 meters	130 meters	111 meters	188 meters
Hotspot diameter at 100 meters	35 meters			
Modes and runtimes (measured for Sanyo Eneloop AA 2000 mAh / Armytek CR123A 1500 mAh / Armytek 18650 Li-Ion 3100 mAh to the decrease to 10% of initial brightness)	Firefly1: 0.15 lm / 90d Firefly2: 1.7 lm / 200h Main1: 10 lm / 25h Main2: 70 lm / 3h Main3: 210 lm / 1.2h Max: 370 lm / 30min	Firefly1: 0.15 lm / 130d Firefly2: 1.7 lm / 300h Main1: 10 lm / 48h Main2: 70 lm / 9.5h Main3: 210 lm / 2.5h Max: 500 lm / 1h	Firefly1: 0.15 lm / 130d Firefly2: 1.7 lm / 300h Main1: 10 lm / 40h Main2: 70 lm / 5h Main3: 210 lm / 2h Max: 400 lm / 35min	Firefly1: 0.2 lm / 100d Firefly2: 2 lm / 18d Main1: 35 lm / 48h Main2: 200 lm / 9h Main3: 420 lm / 3.8h Max: 1050 lm / 1.5h
Power source	1xAA / 1x14500 Li-Ion	2xAA	1x18350 Li-Ion / 1xR123 Li-Ion/1xCR123A	1x18650 Li-Ion / 2xCR123A/2xR123 Li-Ion
Size	Length 103mm, body diameter 24.5mm	Length 149mm, body diameter 24.5mm	Length 87mm, body diameter 24.5mm	Length 118mm, body diameter 24.5mm
Weight (w/o batteries)	54g	58g	52g	56g

* Light outputs for flashlights with Warm light are about 7% less, beam distances are about 3% less.

** C2: in Max mode stabilization is DIGITAL, in all other modes - FULL.

! We recommend to use Sanyo Eneloop AA rechargeable batteries instead of ordinary AA batteries to obtain higher brightness and longer runtimes. We highly recommend NOT to use CR123A batteries as a power source for often and continuous flashlight's operation. Remember that old or low-quality disposal batteries can be damaged under heavy load and explode.

Set description

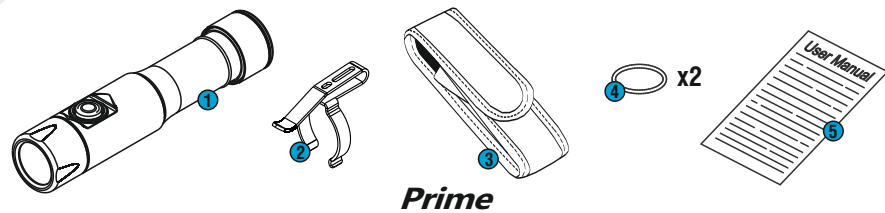

Prime

Items included in the package:

- 1 - Flashlight
- 2 - Clip
- 3 - Holster
- 4 - 2 spare O-rings
- 5 - User manual



- ✓ Depending on the model, your flashlight can considerably differ from the pictures in the manual.
- ✓ The producer reserves the right to change the package at his own discretion without modifying this manual.

Initial Service

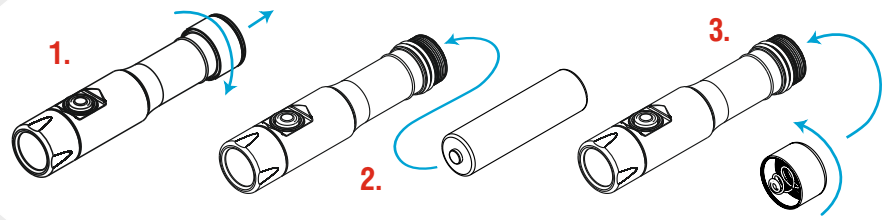

To set/replace batteries:

1. Unscrew the tailcap.
2. Place the batteries with the positive contact (+) facing the head of the flashlight.
3. Adjust the tailcap and tighten it as far as it can go.



We recommend NOT to leave power sources inside the flashlight for a long storage period, as batteries (especially, non-rechargeable) can leak for various reasons and damage the inner parts of the flashlight. If you want to keep your flashlight in a stand-by state with batteries in, use new and quality batteries, store the flashlight in acceptable for batteries operational temperature and revise the batteries' state at least once a month. If you have noticed any signs of batteries' defects, withdraw them from the flashlight and take out of operation. It is also recommended to replace discharged batteries with new ones before the storage as the chance of leakage is higher with discharged batteries.

Operation

In OFF state:

Click: To turn on the last used mode.

Press and hold: To go through 2 Firefly modes (release to select). Keeping button pressed will start cycling through the Main modes.

In ON state:

Click: To turn off the flashlight.

Press and hold: To start cycling through the Main modes.

Double click: To turn on the Maximum mode. Second double click brings back the last used mode.

For comfortable operation you have a convenient momentary access to all the following modes:

Click x1



OFF → Main (if last used)

Main

Main. Short click from the OFF-state activates the Main mode (if it was the last mode used previously).

Press & Hold

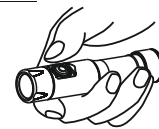

OFF → Firefly1 → Firefly2

Firefly

Firefly. Press and hold the button in OFF-state to turn on the desired Firefly mode and then release immediately. Keeping the button pressed will start cycling through the Main modes.

Click x2



Any mode → Max
Max → Last mode

Maximum

Maximum. The mode is activated by double click in any mode. To return to the last mode make double-click again.

Press & Hold

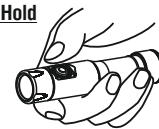

Main1 → Main2
↙ ↘
Main3

Cycling through Modes

Cycling through the Main modes. In ON-state press and hold the button (in any mode); the 3 Main modes will start switching cyclically. Release the button to select the desired mode. In Maximum mode it starts cycling through the Main modes.

Automemorizing. After switching off the last used Mode is memorized for quick 1-click access at next switching on.

Lock-out function. Unscrew the tailcap to 1/4 for the protection from accidental switching on.

Low Battery Indication

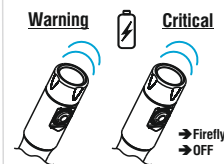

High Temperature Indication



Warning Indication. In ON-state shows the battery level and the temperature inside the flashlight.

Low battery level. When it is <25%, the **main LED** flashes 2 times once a minute. At **critical level** <5% light output decreases to Firefly1 and then switched off.

High temperature (C2 only). At **critical level** the **main LED** flashes 4 times once and the light output decreases by 35%. In case the temperature doesn't fall the light output decreases to Firefly2. At normal temperature the brightness increases to usual level.