

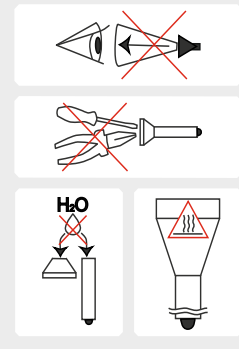

Warnings

C2 Pro only: With ambient temperature +25°C the flashlight delivers light in Maximum mode for about 6-10 minutes and then the brightness decreases by 35%. After cooling-down (at sufficient voltage level) the brightness increases to the Maximum mode again. This stepping goes cyclically to maintain the user's safety and the flashlight's functionality. In conditions of good air-cooling the flashlight delivers light without stepping down even in Maximum mode. There are no preset timers for stepping, but real-time active temperature measurements.



1. Always follow the instructions from this manual and recommendations on battery usage.
2. Apply only the recommended power sources.
3. Do not reverse battery polarity.
4. Do not use different power sources together, i.e. old ones with new ones, charged with discharged. Do not use different types of batteries combined as the element with less capacity can be damaged.
5. Do not modify or recast the flashlight and its components as it will deprive you of the warranty.
6. Do not allow water or any other liquid to leak into the flashlight.
7. Do not aim a turned-on flashlight at people's or animals' eyes – it can cause temporary blindness.
8. Do not allow children to use the flashlight without your assistance.

! Armytek Optoelectronics Inc. shall not be liable for any harm done to the user if it was caused by improper use of the product.

Care and Storage

It is recommended to clean the threads and O-rings off dirt and old grease. Remember that secure protection from water and dust cannot be provided by worn out sealing. And fouling as well as lack of lubricant cause fast wear-out of threads and sealing rings.

To clean the threads do the following:

1. Unscrew the tailcap and remove the sealing ring carefully with a toothpick (do not use sharp metal things as they can damage the ring).
2. Wipe the sealing ring thoroughly with a soft cloth (or tissue). Do not use solvents. If the sealing ring is worn out or damaged replace it by a new one.
3. Clean the metal threads with a brush using ethanol. Be careful not to allow applied liquid to get inside the flashlight or tailcap as it can cause fails in functionality of the flashlight.

After cleaning lubricate the thread and the sealing ring with polyalphaolefin-based silica grease, e.g. Nyogel 760G. The application of automotive and other improper grease can cause swelling and damage of the sealing rings.

In case of active operation and exploitation in dusty environments, it is recommended to perform cleaning and lubricating of the parts as often as required, even if it is more than twice a year.

Service and Warranty

Armytek provides free warranty repair for 10 years from the purchase.

Warranty doesn't cover damage caused by:

1. Improper usage.
2. Attempts to modify or repair the flashlight by nonqualified specialists.
3. Longtime application in chlorinated or polluted water, or other liquids (other than water).
4. High temperatures and chemicals' exposure (including the exposure of liquid from defected batteries).
5. Usage of low-quality batteries.

Armytek Optoelectronics Inc.

Web: www.armytek.com Email: service@armytek.com
Address: 67 Vandervoort Dr, Richmond Hill, Ontario, L4E 0C7, Canada

Specifications are subject to change without notice.



Prime PRO

THE MOST TECHNICALLY ADVANCED
FLASHLIGHTS IN THE WORLD

• USER MANUAL •

Thank you for choosing the products of Armytek Optoelectronics Inc., Canada.
Please read this manual carefully before using the flashlight.

Specifications

Armytek Optoelectronics Inc. is a Canadian manufacturer that produces powerful and reliable flashlights designed especially for your needs applying in them components made in the USA and Japan. **10 years no-hassle warranty.**

- Superb light of amazing constant brightness due to powerful electronics and active temperature control without timers
- Efficient TIR-optics and no "tunnel vision" effect even after continuous use
- Multicolor Warning Indication of low battery level and high temperature (C2)
- Side switch for comfortable one-hand operation and easy modes switching with advanced operation
- Multicolor State Indication and ultra low current drain in OFF-state - more than 25 years
- Removable magnet in the tailcap, firm holster, removable clip, strong lanyard and possibility of tail-stand for multipurpose use
- Compact and light-weight flashlight of guaranteed durability stands up harsh impacts and falling from 10 meters
- Total protection from water, dirt and dust penetration - flashlight continues to work even at the depth of 10 meters

Model	Prime A1 Pro	Prime A2 Pro	Prime C1 Pro	Prime C2 Pro
LED / Optics	Cree XP-L / TIR			
Brightness stabilization type	FULL stabilization (constant brightness)**			
Light output, LED / OTF lumens*	450 / 370	620 / 500	500 / 400	1200 / 1050
Peak beam intensity, candelas	3050	4250	3100	8800
Hotspot/spill	20°/80°			
Beam distance*	110 meters	130 meters	111 meters	188 meters
Hotspot diameter at 100 meters	35 meters			
Modes and runtimes (measured for Sanyo Eneloop AA 2000 mAh / Armytek CR123A 1500 mAh / Armytek 18650 Li-Ion 3100 mAh to the decrease to 10% of initial brightness)	Firefly1: 0.15lm / 90d Firefly2: 1.7lm / 200h Main1: 10 lm / 25h Main2: 70 lm / 3h Main3: 210 lm / 1.2h Max: 370 lm / 30min Strobe: 10Hz Beacon: 0.6Hz	Firefly1: 0.15lm/130d Firefly2: 1.7lm / 300h Main1: 10 lm / 48h Main2: 70 lm / 9.5h Main3: 210 lm / 2.5h Max: 500 lm / 1h Strobe: 10Hz Beacon: 0.6Hz	Firefly1: 0.15lm/130d Firefly2: 1.7lm / 300h Main1: 10 lm / 40h Main2: 70 lm / 5h Main3: 210 lm / 2h Max: 400 lm / 35min Strobe: 10Hz Beacon: 0.6Hz	Firefly1: 0.2lm / 100d Firefly2: 2lm / 18d Firefly3: 15lm / 72h Main1: 70lm / 18h Main2: 200lm / 9h Main3: 420lm / 3.8h Max: 1050lm / 1.5h Strobe: 10Hz Beacon: 0.6Hz
Power source	1xAA / 1x14500 Li-Ion	2xAA	1x18350 Li-Ion / 1xR123 Li-Ion/1xCR123A	1x18650 Li-Ion / 2xCR123A/2xR123 Li-Ion
Size	Length 108mm, body diameter 24.5mm	Length 155mm, body diameter 24.5mm	Length 93mm, body diameter 24.5mm	Length 124mm, body diameter 24.5mm
Weight (w/o batteries)	66g	70g	64g	68g

* Light outputs for flashlights with Warm light are about 7% less, beam distances are about 3% less.

** C2 Pro: in Max mode stabilization is DIGITAL, in all other modes - FULL.

! We recommend to use Sanyo Eneloop AA rechargeable batteries instead of ordinary AA batteries to obtain higher brightness and longer runtimes. We highly recommend NOT to use CR123A batteries as a power source for often and continuous flashlight's operation. Remember that old or low-quality disposal batteries can be damaged under heavy load and explode.

Set description

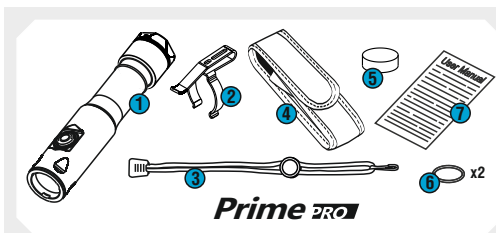

Items included in the package:

- 1 - Flashlight
- 2 - Clip
- 3 - Lanyard
- 4 - Holster
- 5 - Magnet
- 6 - 2 spare O-rings
- 7 - User manual



- ✓ Depending on the model, your flashlight can inconsiderably differ from the pictures in the manual.
- ✓ The producer reserves the right to change the package at his own discretion without modifying this manual.

Initial Service

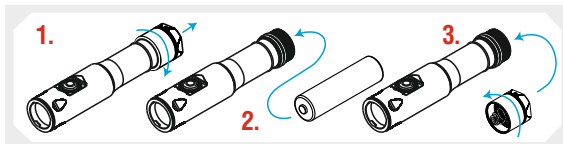

To set/replace batteries:

1. Unscrew the tailcap.
2. Place the batteries with the positive contact (+) facing the head of the flashlight.
3. Adjust the tailcap and tighten it as far as it can go.

The flashlight is ready for operation.

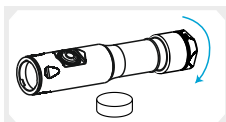

The removable magnet in the tailcap.

With its help you can easily attach the flashlight to an electric service panel, a bike handlebar, above a car wheel, etc.

The magnet can be taken out of the tailcap. To do this unscrew the small cover at the end of the tailcap and put the magnet out.

Specifying the battery type for correct voltage indication.

Do not specify the type of power source manually unless you use **unprotected Li-Ion batteries** different from those that are stated by default: 1xAA (for A1 Pro) / 2xAA (for A2 Pro) / 1xCR123A (for C1 Pro) / 1x18650 Li-Ion (for C2 Pro).

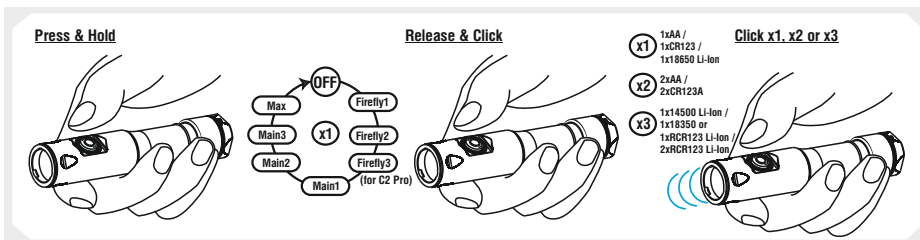

To access the Menu press and hold the switch button (when the flashlight is switched off). It will switch on, go through the all available modes and then switch off again. After switching off, release the button quickly and click it rapidly again. The flashlight will enter the Menu and the LED will flash about 3 times a second.

Now you can specify the battery type:

- 1 click for 1xAA (A1 Pro) / 1xCR123A (C1 Pro) / 1x18650 Li-Ion.
- 2 clicks for 2xAA (A2 Pro) / 2xCR123A (C2 Pro).
- 3 clicks for 1x14500 Li-Ion (A1 Pro) / 1x18350 or RCR123 Li-Ion (C1 Pro) / 2xRCR123 Li-Ion (C2 Pro).

After the choice is made the light will flash 1, 2 or 3 times to show the battery type chosen.



We recommend **NOT** to leave power sources inside the flashlight for a long storage period, as batteries (especially, non-rechargeable) can leak for various reasons and damage the inner parts of the flashlight. If you want to keep your flashlight in a stand-by state with batteries in, use new and quality batteries, store the flashlight in acceptable for batteries operational temperature and revise the batteries' state at least once a month. If you have noticed any signs of batteries' defects, withdraw them from the flashlight and take out of operation. It is also recommended to replace discharged batteries with new ones before the storage as the chance of leakage is higher with discharged batteries.

Operation

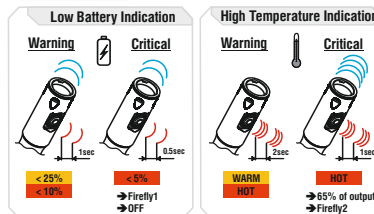
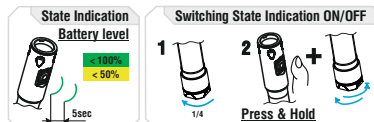
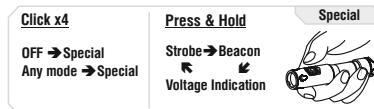
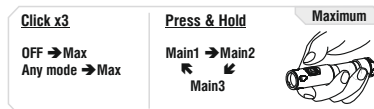
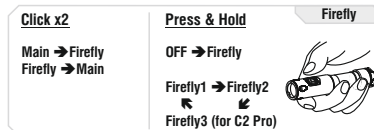

The flashlight has 4 Sections of modes:

[Section1] – Firefly modes [Section2] – Main modes
[Section3] – Maximum [Section4] – Special modes

In OFF state:

Click: To turn on the last used mode (Firefly, Main or Maximum). If the flashlight was turned on in one of the Special modes it will turn on in the last used Main mode.

Press and hold: To turn on Firefly1 mode in [Section 1].

In ON state:

Click: To turn off the flashlight.

Press and hold: To start cycling through the modes of the current Section. In Maximum mode it starts cycling through the Main modes in [Section 2].

The same in OFF & ON states:

2 clicks: To turn on the last used Main mode [Section 2]. Further double clicks will switch modes between the last used modes in [Section 1] and [Section 2].

3 clicks: To turn on the Maximum mode [Section 3].

4 clicks: To turn on the last used Special mode [Section 4].

Only C2 Pro has 2 types of operation:

1. **General.** The flashlight is switched on/off permanently.
2. **Tactical.** The light turns on for the time the button is being pressed. It will switch on in the last memorized mode (except for the Special modes). This type of operation is useful for short-time lighting and setting signals.

To access the Tactical operation type, unscrew the tailcap to 1/4, press the button and tighten the tailcap again keeping the button pressed. To return to the General type, unscrew the tailcap to 1/4 and tighten it again.

You have a convenient momentary access to all Modes:

Main. Double click from OFF or ON state turns on the last used Main Mode.

Firefly. Press and hold the button in OFF-state to turn on the Firefly1. Press and hold after Firefly activation to start cycling through the Firefly modes: release the button to select one. Firefly modes can be also accessed from the Main mode by a double click.

Maximum. 3 clicks from OFF or ON state turn on the Maximum mode.

Special modes (Strobe / Beacon / Voltage Indication). 4 clicks from OFF or ON state turn on the last used Special mode.

Cycling through modes. In ON-state press and hold the button in any mode: the modes of the current Section will start switching cyclically. Release the button to select the desired mode. In Maximum mode it starts cycling through the Main modes.

Automemorizing. After switching off the last used Mode is memorized for quick 1-click access at next switching on. If the flashlight was turned on in one of the Special modes it will turn on in the last used Main mode.

Lock-out function. Unscrew the tailcap to 1/4 for the protection from accidental switching on. State indication will be turned off.

Voltage Indication. Shows the battery voltage in percents. The percentage is indicated by flashes: <100% - 4 flashes
<50% - 3 flashes
<25% - 2 flashes
<10 - 1 flash

Multicolor State Indication. Shows the battery level by short flashes every 5 seconds. C2 Pro has State Indication in OFF state and Firefly modes, which can be helpful to find the flashlight in the dark. Other models don't have it.

Switching Multicolor State Indication ON/OFF (C2 Pro only). It is switched off by default in OFF-state and Firefly modes. To turn on and off: unscrew the tailcap to 1/4, press the button and holding the button pressed - tighten the tailcap and then unscrew it again. The settings will be memorized even when battery is changed.

Warning Indication. In ON-state shows the battery level and the temperature inside the flashlight.

Low battery level. When it is <25%, the **color LED** shows the **warning level** once a second and the **main LED** flashes 2 times once a minute. **Critical level** <5% is color indicated twice a second and light output decreases to Firefly1 and then switched off.

High temperature (C2 Pro only). When it increases to the **warning level**, the **color LED** flashes 3 times once in 2 seconds. At **critical level** the **color LED** flashes 3 times once a second, the **main LED** flashes 4 times once and the light output decreases by 35%. In case the temperature doesn't fall the light output decreases to Firefly2. At normal temperature the brightness increases to usual level.