

89-01

Service Instructions**Book 4**

95-06

GS Motor

0

B

1

Dismantling the motor

1. Turn the 2 blue screws of the handle 90°, lift up the handle.
2. Lift of the grill and the air filter.
3. Remove the screws from the 2 locking devices and the 2 screws in the socket.
4. Lift of the motor top.
5. Detach the fan-gasket and the 3 supports with rubber springs and the nylon tube.

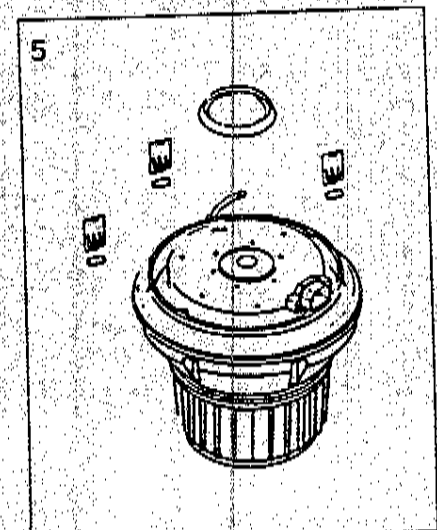
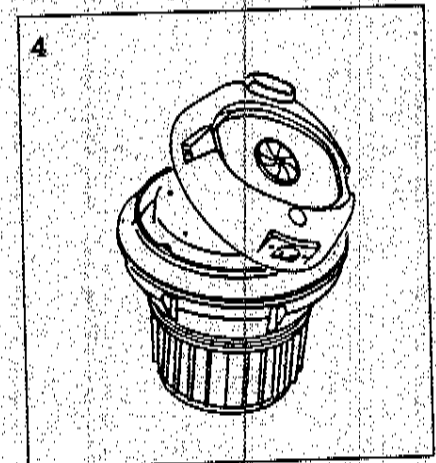
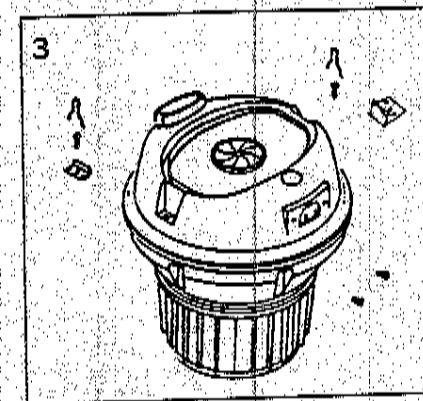
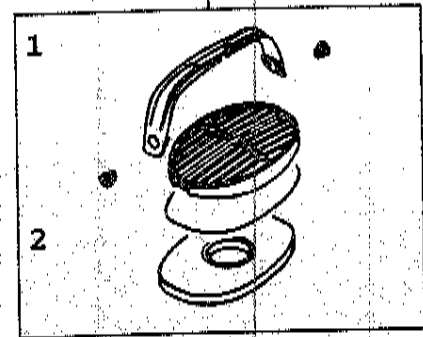

Book 4

Service Instructions

0 B 2

GS Motor

6. Place support stand V-32692 on fan top.
Turn the unit 180°.

Release the lock in motor casing.

Turn casing counter clockwise and
lift the motor casing.

V-32692

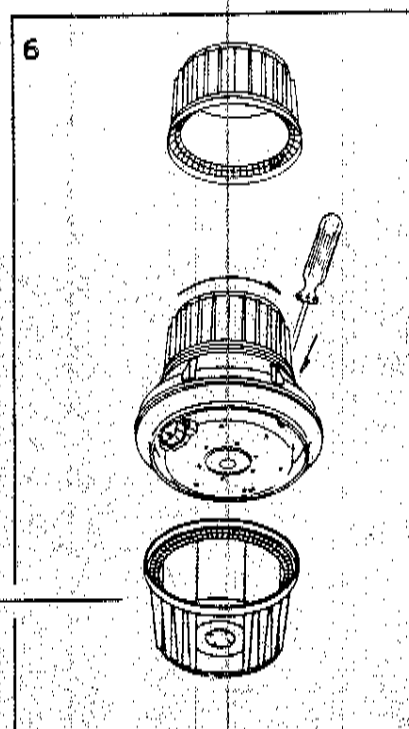

7. Detach 2 leads from capacitor.
Lift fan casing up.

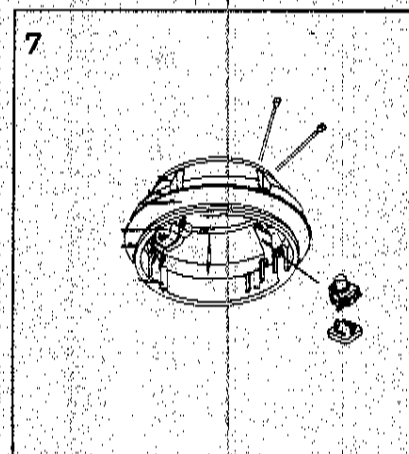

8. Detach nylon tube and all leads from:
Brush holder, capacitor, and remove
components.

Pneumatic switch not to be used.

Remove 2 screws, bearing plate
and cross washer.

IMPORTANT: When assembling motor.
Grinding carbon brushes:
Seat new brushes with commutator-
stone S.15,1 ahead of each brush-
holder for 1 minute.

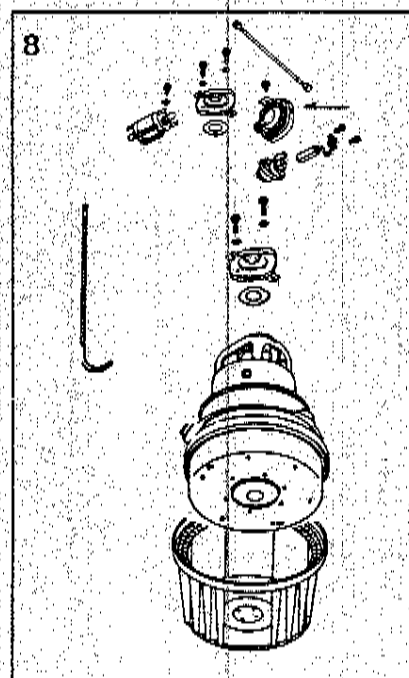

89-01

Service Instruktionen

Book 4

GS Motor

0

B

3

Dismantling motor

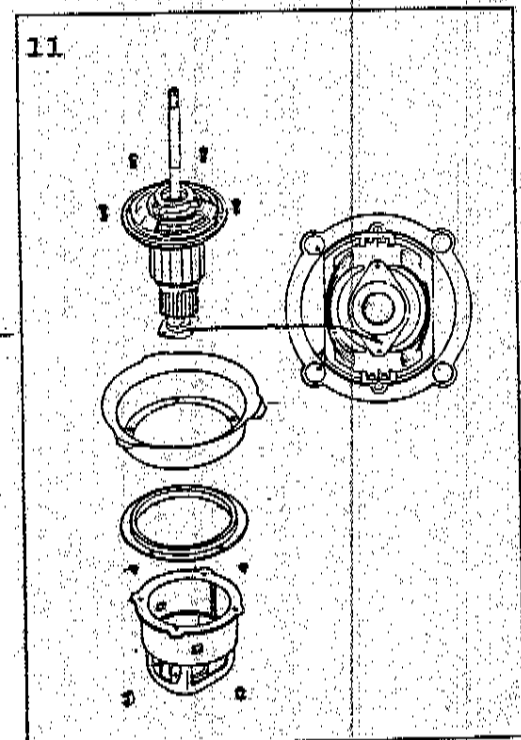
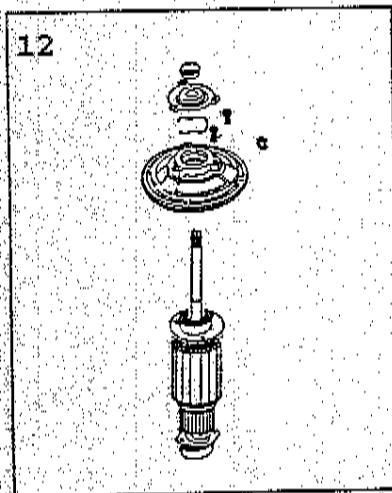
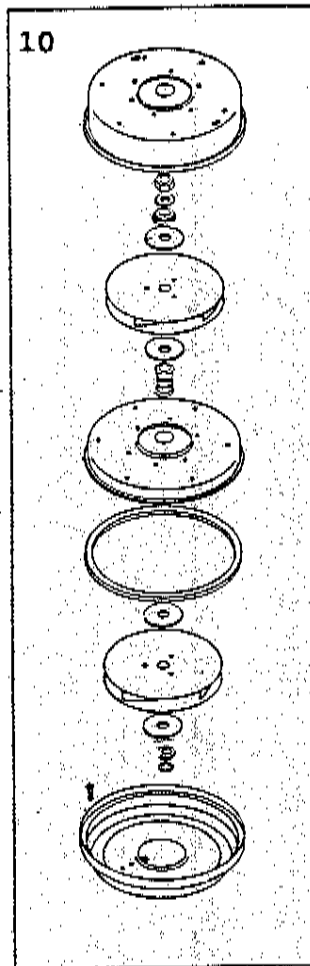
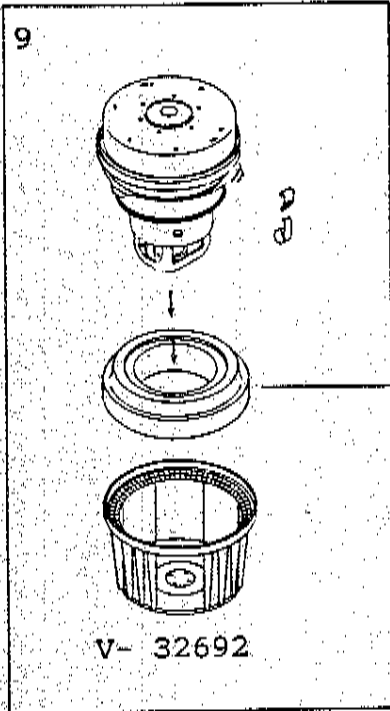

Assembling motor

Armature/bearings: see 0 A 3

Book 4

Service Instructions

0 B 4

GS Motor

Position of motor parts

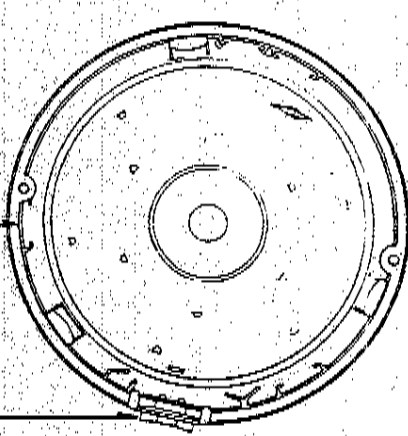
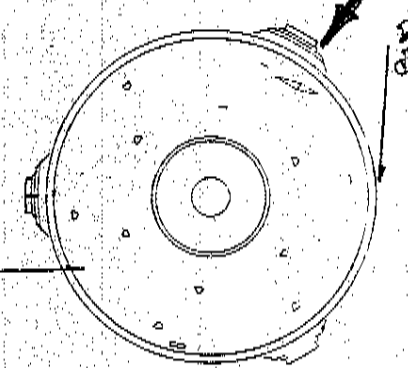
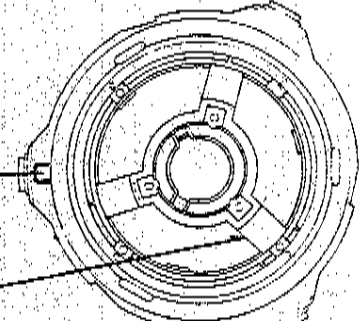
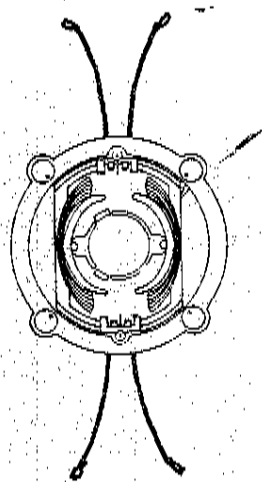

Wiring instructions

GSD

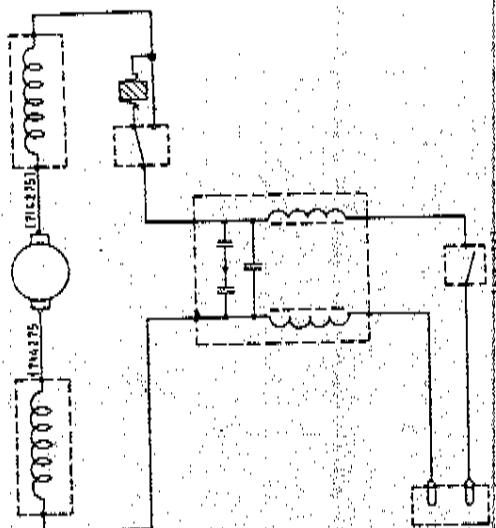

GST-GSF

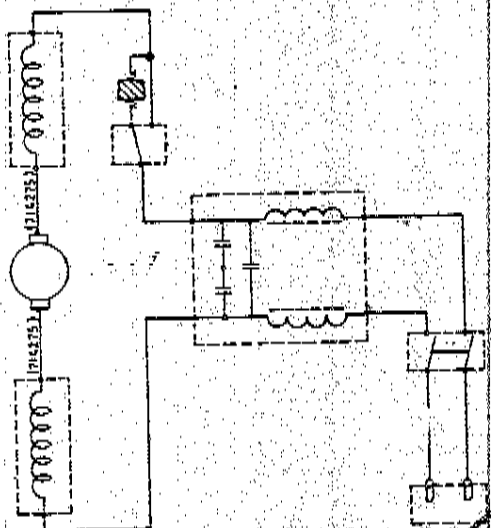

GSJ-GSJF

