

G70 - G71		Voltage	110	120-130	140-150	200-220	230	230-240	250
Armature	Number of turns		11	13	15	22	22	24	24
	Ref. no. 211650		07	09	10	13	13	14	14
Field coils	Number of turns		100	120	135	200	215	225	250
			50+75	60+90	65+100	100+150	105+160	115+170	130+190
	Ref. no. 311512		03	05	06	09	10	11	13

GI		Voltage	110	120-130	200-220	230	230-240	250
Armature	Number of turns		11	13	22	22	24	24
	Ref. no. 211650		07	09	13	13	14	14
Field coils	Number of turns		75	90	150	160	170	190
	Ref. no. 310742		07	09	13	14	16	18

GAD motor No. 101 - 288200, GAE motor No. 101 - 98100

A

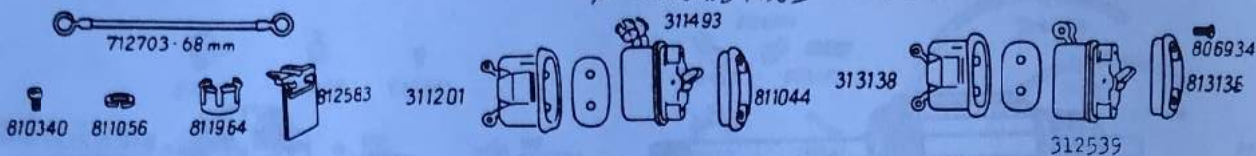

B

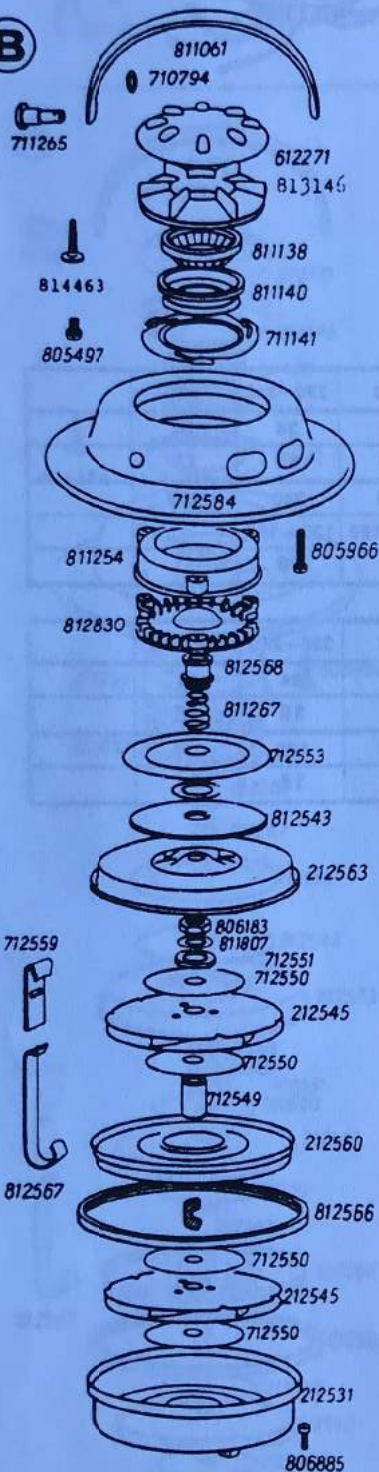

C

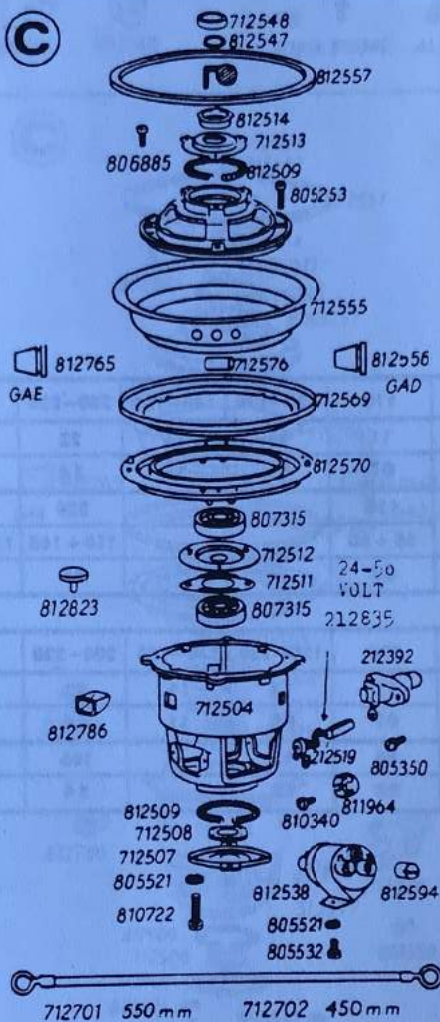

D



H

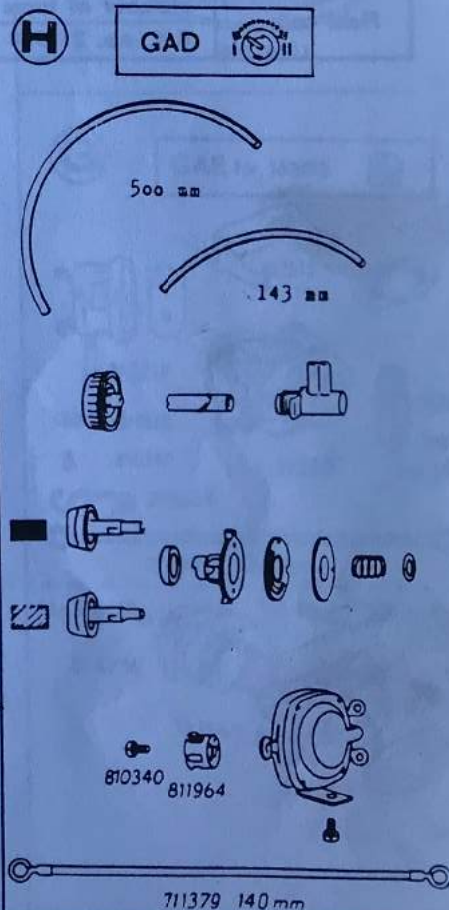

E

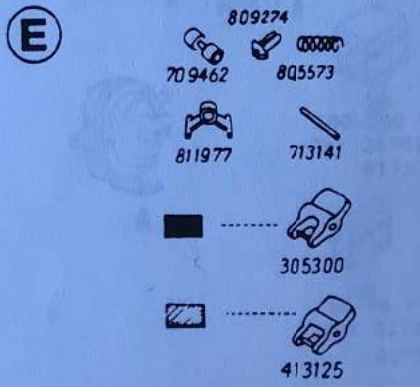

F

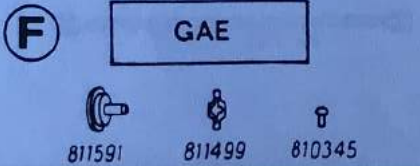

GAD, GAE motors

GAD motor No. 101 - 288200, GAE motor No. 101 - 98100



212501

GAD 212599
GAE 212598

GAD	Voltage	110	120-130	140-150	200-220	230	230-240	250
Armature	Number of turns	11	13	15	22	22	24	24
	Ref. no. 212501	07	09	11	14	14	15	15
Field coils	Number of turns	110			220	240	240	260
	Ref. no. 212599	55+80			110+165	120+180	120+180	
		03			09	10	10	

GAE - GAES	Voltage	110	120-130	140-150	200-220	230	230-240	250
Armature	Number of turns	11	13	15	22	22	24	24
	Ref. no. 212501	07	09	11	14	14	15	15
Field coils	Number of turns	80	95		165	180	180	195
	Ref. no. 212598	08	10		14	15	15	16

GAD motor No. 288201 - 1115011, GAE motor No. 98101 - 370732

A



B

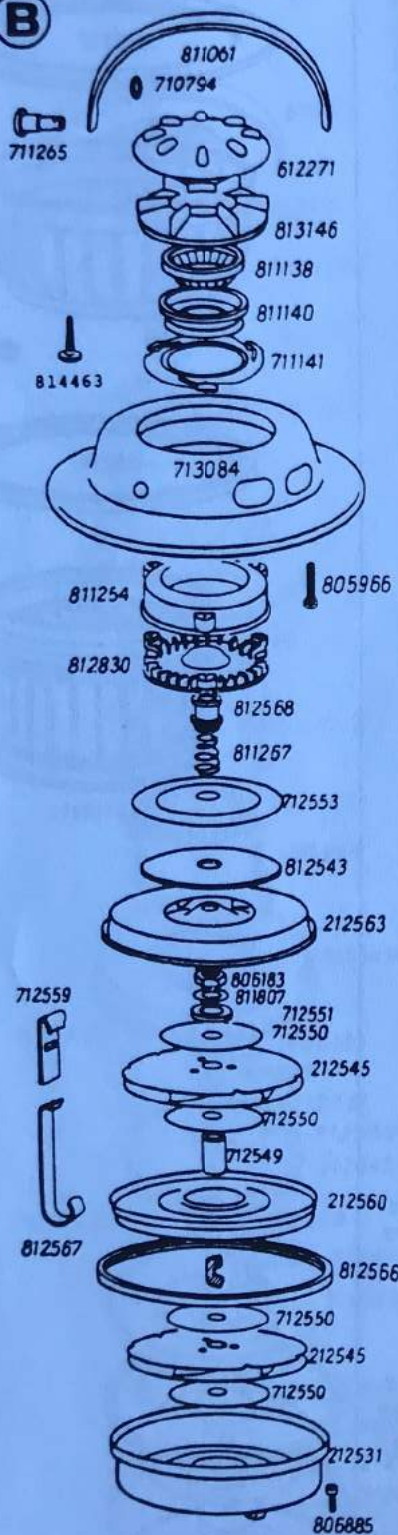

C

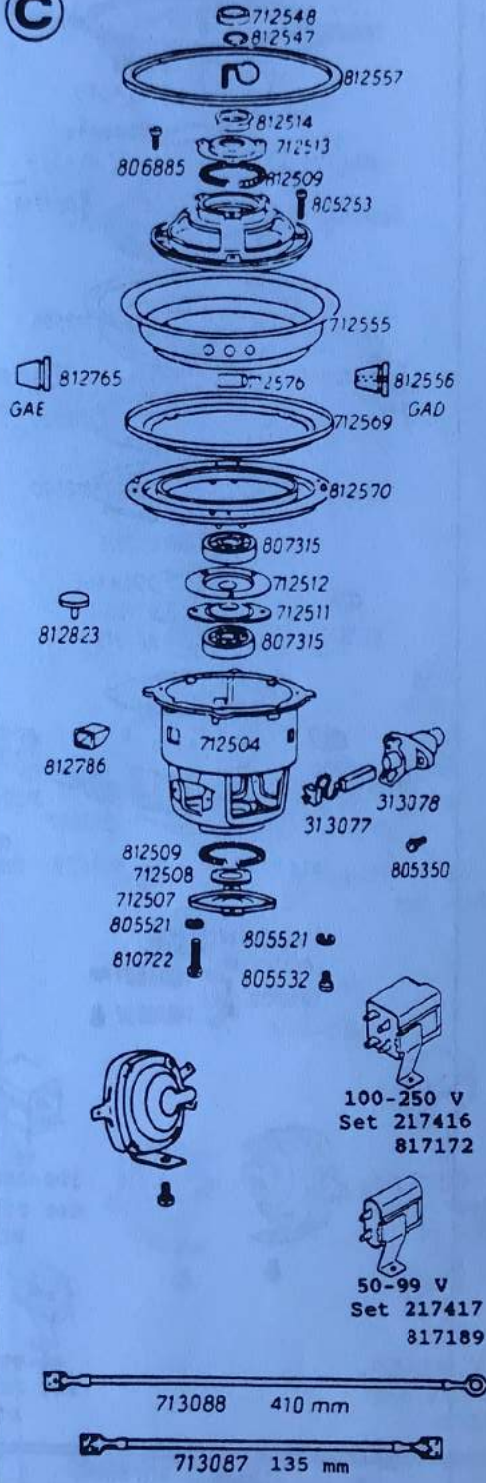

D

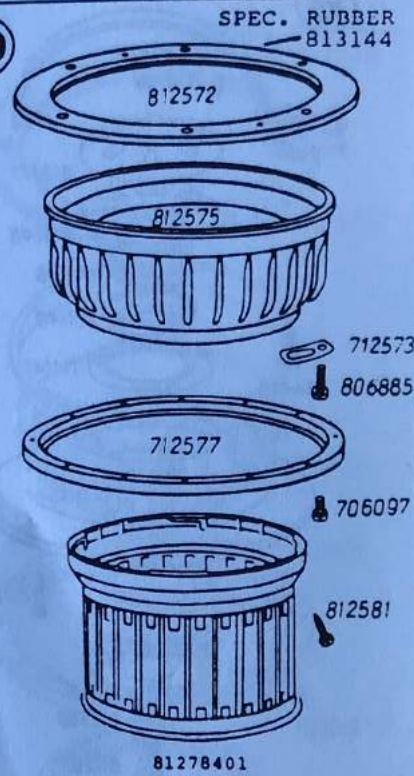

G

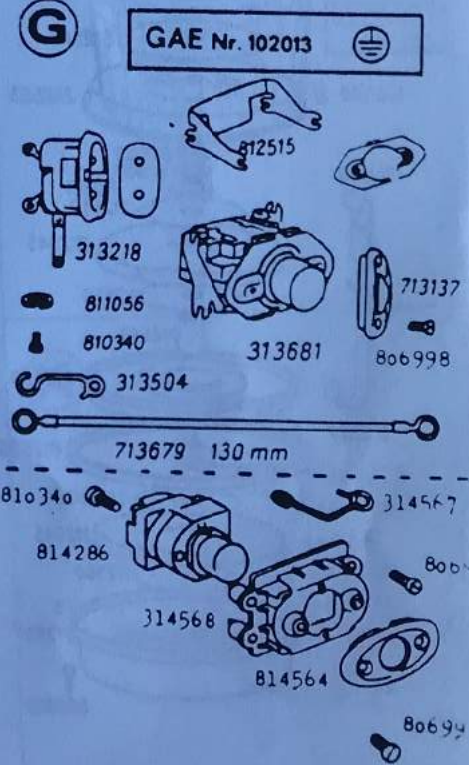

GAD motor No. 1115012 - 1538679, GAE motor No. 370733 - 603037

A

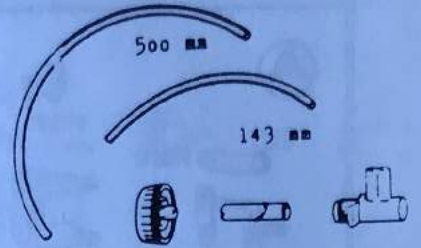

B

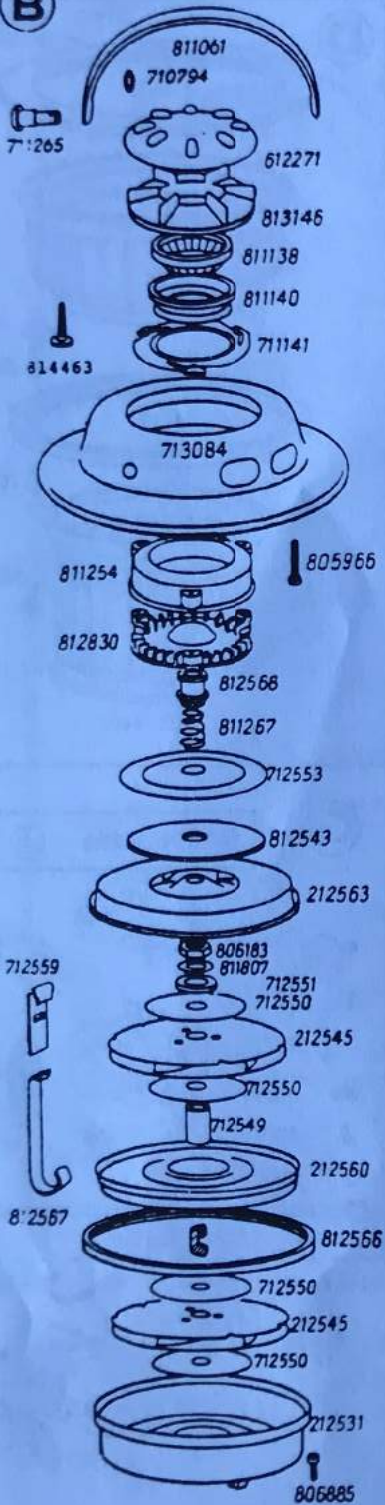

C

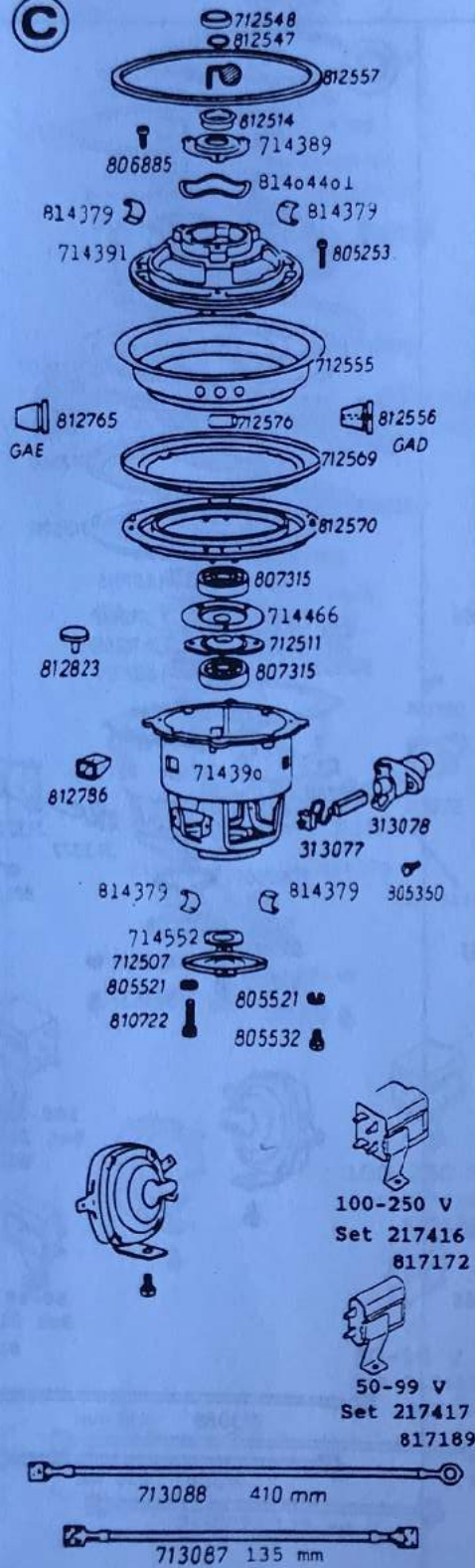

D

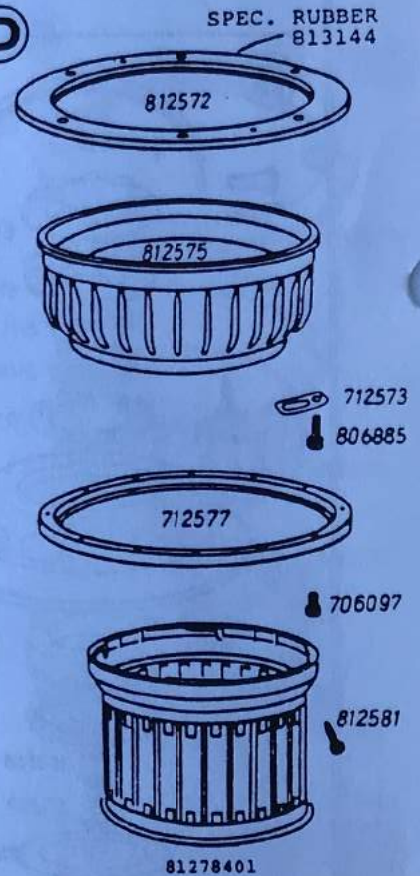

GAD motor No. 1741148 - 2270480, GAE motor No. 603038 -

A

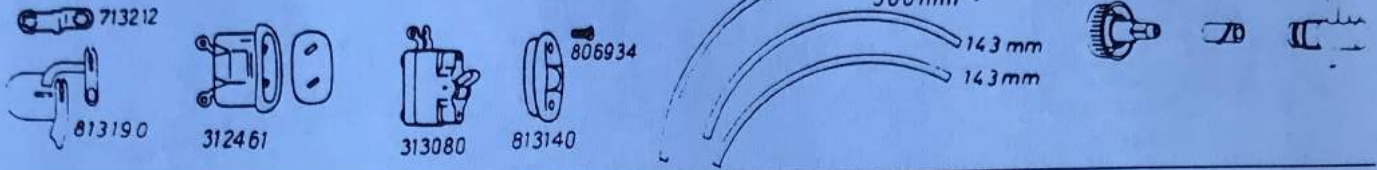

B

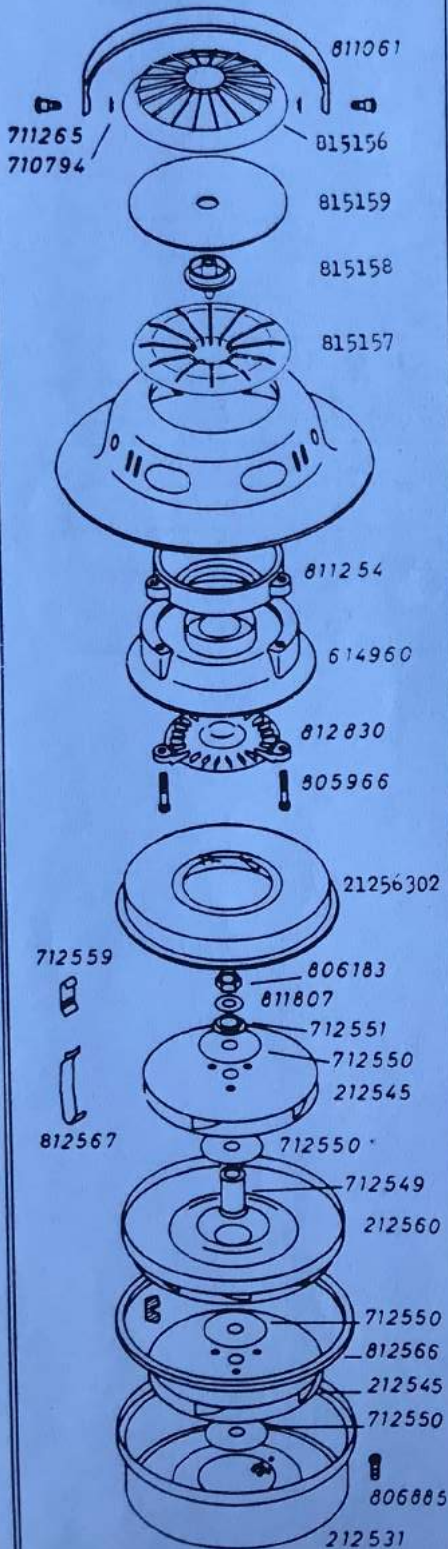

C

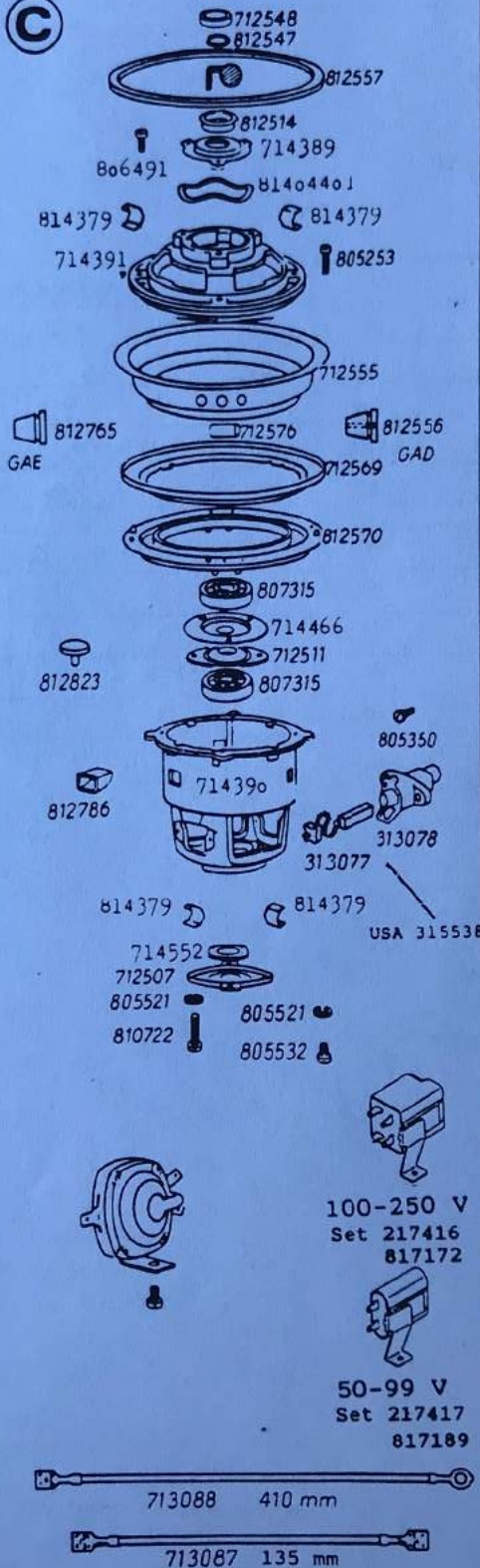

D

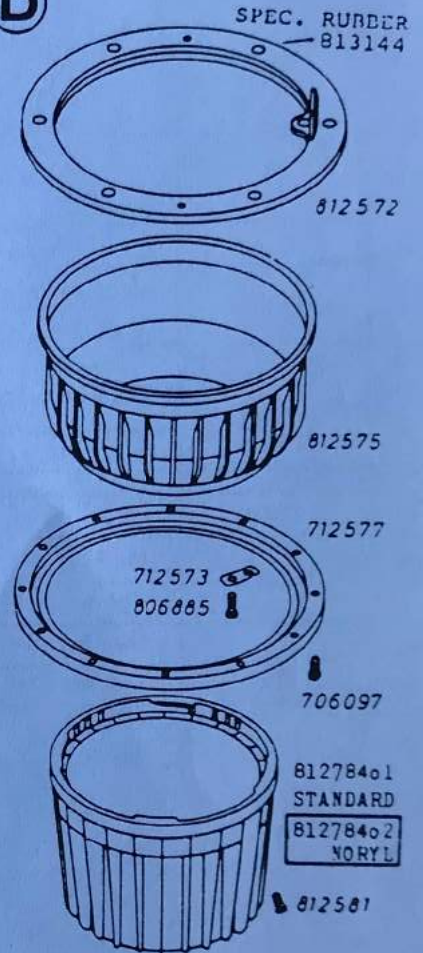

K



GAD, GAE motors

GAD motor No. 288201 - 2270480, GAE motor No. 98101 -



2125o1

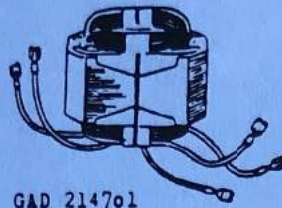

GAD 2147o1



GAE 2147o2



714275 115mm



714275 115mm 714268 180mm

GAD	Voltage	110	120-130	140-150	200-220	230	230-240	250
Armature	Number of turns	11	13	15	22	22	24	24
	Ref. no. 2125o1	07	09	11	14	14	15	15
Field coils	Number of turns	110	130	150	220	240	240	260
		55+80	65+95	75+110	110+165	120+180	120+180	130+195
	Ref. no. 2147o1	03	05	06	09	10	10	11

GAE	Voltage	110	120-130	140-150	200-220	230	230-240	250
Armature	Number of turns	11	13	15	22	22	24	24
	Ref. no. 2125o1	07	09	11	14	14	15	15
Field coils	Number of turns	80	95	110	165	180	180	195
	Ref. no. 2147o2	08	10	11	14	15	15	16