

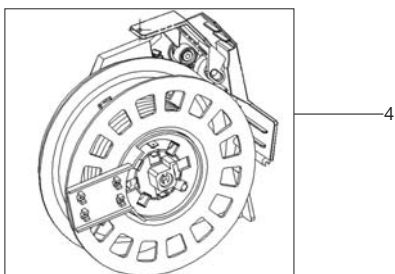

<u>DESCRIPTION</u>	<u>PLAN</u>
Motor and cord reel	A - 11.3.1 - 2
Filters, dust container	A - 11.3.1 - 4
Sales box	A - 11.3.1 - 6
Upper parts	A - 11.3.1 - 8
Lower parts	A - 11.3.1 - 12
Tubes, and hoses	A - 11.3.1 - 14
Nozzles	A - 11.3.1 - 16

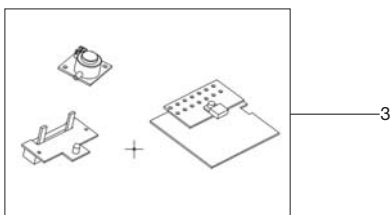
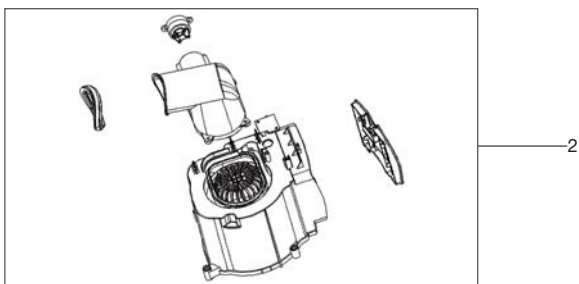
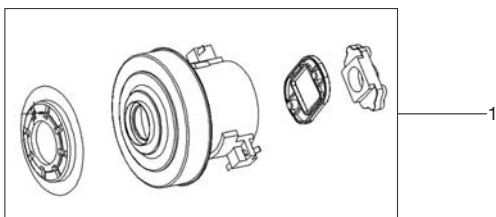

**Cable reel,**

Voltage Plug type			
Index 200, AUS/NZ	250		

	<b>MOTOR SERVICE KIT</b>	<b>BOOK A</b>		
<b>06-08</b>	<b>MOTOR AND CORD REEL</b>	<b>A</b>	<b>11.3.1</b>	<b>3</b>

Item	Part.No.	Qty	Desc. 1	Desc. 2	EAN CODE No.
					<b>5715492 +</b>
1+2	80066000	1	MOTOR INCL FIXATION AND HOUSING AUS 220-240V		+036042
3	80066300	1	PCB COMBAT		+036073
4	80066100	1	CABLE REEL AUS/NZ	L:6M	+036059

**Note**

>> means: New or changed ref. no.

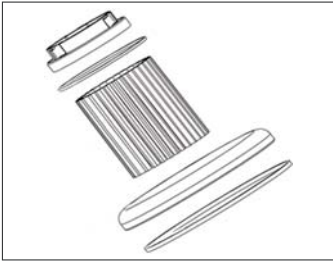

1

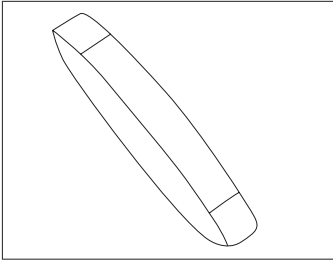

3

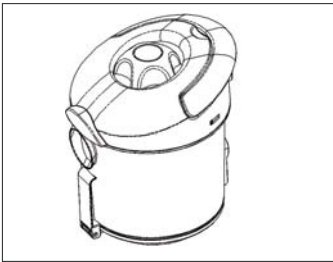

4

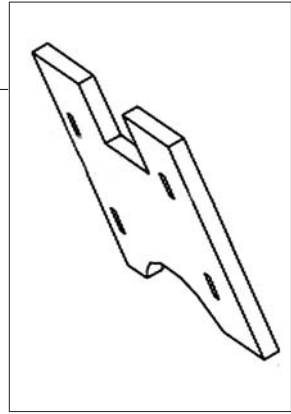

2

	<b>FILTER SERVICE KIT</b>	<b>BOOK A</b>		
<b>06-08</b>	<b>FILTER, DUST CONTAINER</b>	<b>A</b>	<b>11.3.1</b>	<b>5</b>

<b>Item</b>	<b>Part.No.</b>	<b>Qty</b>	<b>Desc. 1</b>	<b>Desc. 2</b>	<b>EAN CODE No.</b>
					<b>5715492+</b>
1	80066500	1	HEPA H10 FILTER KIT-COMBAT		+036097
2	80066600	1	EXHAUST FILTER MICRO-COMBAT		+036103
3	80066700	1	PRE-FILTER-COMBAT		+036127
4	80066800	1	DUST CONTAINER COMPL TRANSTARENT-COMBAT		+036134

**Note**

>> means: New or changed ref. no.

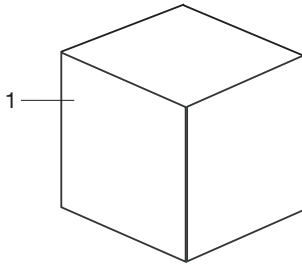

	<b>SERVICE KIT</b>	<b>BOOK A</b>		
<b>06-08</b>	<b>SALES BOX</b>	<b>A</b>	<b>11.3.1</b>	<b>7</b>

Item	Part.No.	Qty	Desc. 1	Desc. 2	EAN CODE No.
					<b>5715492 +</b>
1	80067200	1	SALES CARDBOARD BOX - COMBAT		+036172

**Note**

>> means: New or changed ref. no.

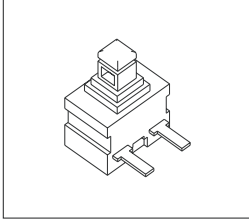

— 1

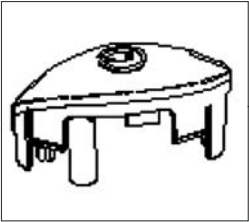

— 2



	<b>CONTAINER SERVICE KIT AND SPARE PARTS</b>		<b>BOOK A</b>		
<b>06-08</b>	<b>UPPER PARTS</b>		<b>A</b>	<b>11.3.1</b>	<b>9</b>

Item	Part.No.	Qty	Desc. 1	Desc. 2	EAN CODE No.
					<b>5715492 +</b>
1	80066400	1	ON/OFF SWITCH KIT COMBAT		+036080
2	80068200	1	CORD REEL BUTTON-COMBAT		+036271

**Note**

>> means: New or changed ref. no.

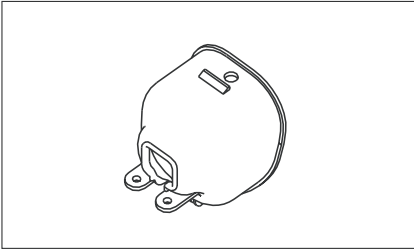

1

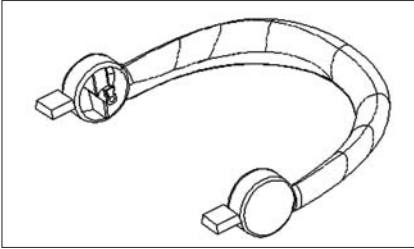

2

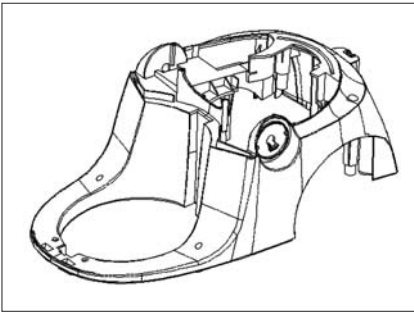

3

	<b>CONTAINER SPARE PARTS</b>	<b>BOOK A</b>		
<b>06-08</b>	<b>UPPER PARTS</b>	<b>A</b>	<b>11.3.1</b>	<b>11</b>

<b>Item</b>	<b>Part.No.</b>	<b>Qty</b>	<b>Desc. 1</b>	<b>Desc. 2</b>	<b>EAN CODE No.</b>
					<b>5715492 +</b>
1	80066200	1	CABLE OUTLET		+035066
2	80066900	1	HANDLE COMPLETE RED METALLIC COMBAT		+036141
3	80067000	1	UPPER COVER RED METALLIC-COMBAT		+036158

**Note**

>> means: New or changed ref. no.

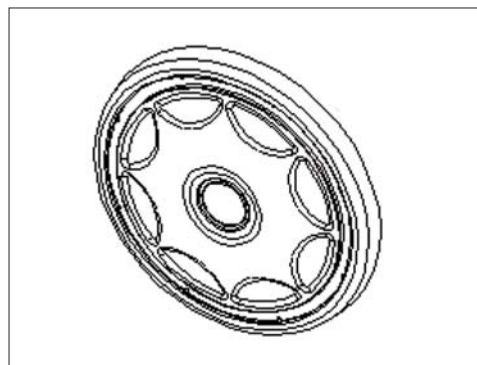
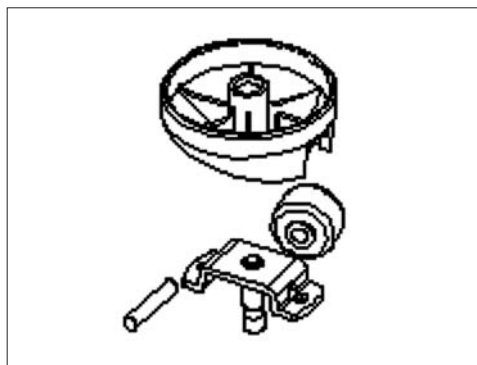
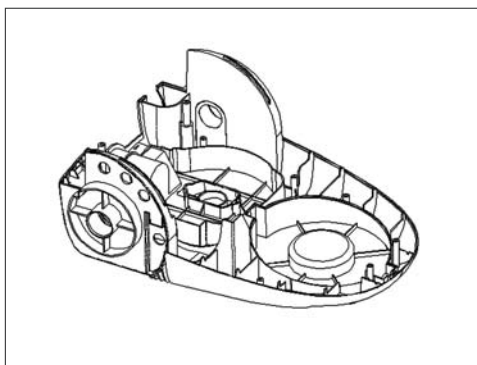

	<b>CONTAINER SPARE PARTS</b>	<b>BOOK A</b>		
<b>06-08</b>	<b>LOWER PARTS</b>	<b>A</b>	<b>11.3.1</b>	<b>15</b>

Item	Part.No.	Qty	Desc. 1	Desc. 2	EAN CODE No.
					<b>5715492 +</b>
1	80067100	1	BODY BASE COMPLETE COMBAT		+036165
2	80068000	1	FRONT WHEEL SMALL		+036257
3	80068100	2	REAR WHEEL		+036264

**Note**

>> means: New or changed ref. no.

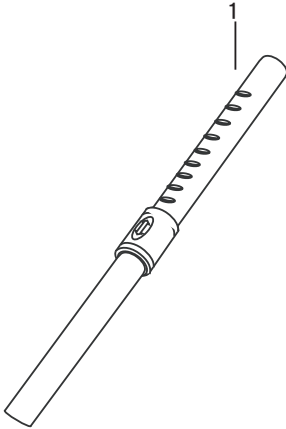

2

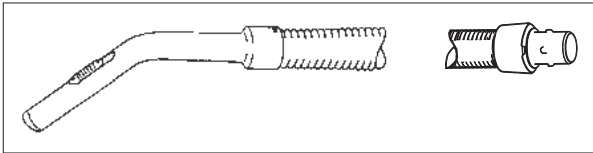

	<b>ACCESSORIES ø35 MM</b>		<b>BOOK A</b>		
<b>06-08</b>	<b>HOSES AND TUBES</b>		<b>A</b>	<b>11.3.1</b>	<b>17</b>

Item	Part.No.	Qty	Desc. 1	Desc. 2	EAN CODE No.
					<b>5715492 +</b>
1	80067800	1	TELESCP. TUBE	D:35MM	+036233
2	80067900	1	HOSE COMPL WITH BEND TUBE	D:35MM	+036240

**Note**

>> means: New or changed ref. no.

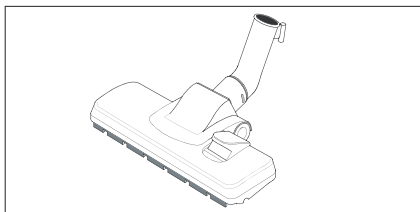

1

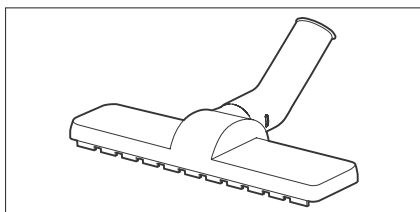

2



3

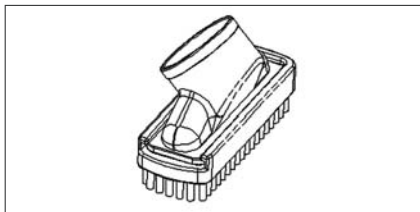

4

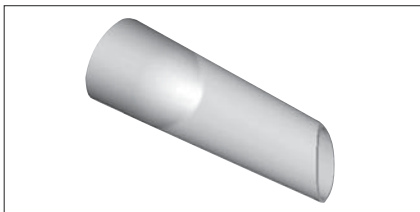

5



	<b>ACCESSORIES ø35 MM</b>	<b>BOOK A</b>		
<b>06-08</b>	<b>NOZZLES</b>	<b>A</b>	<b>11.3.1</b>	<b>19</b>

<b>Item</b>	<b>Part.No.</b>	<b>Qty</b>	<b>Desc. 1</b>	<b>Desc. 2</b>	<b>EAN CODE No.</b>
					<b>5715492 +</b>
1	80067300	1	COMBI NOZZLE D:35MM W:275MM, W/PARKING		+036189
2	80067400	1	HARD FLOOR NOZZLE D:35MM W:300MM, W/PARKING		+036196
3	80067500	1	TURBO NOZZLE D:35MM W:275MM, W/PARKING		+036202
4	80067600	1	ROUND BRUSH D:35MM		+036219
5	80067700	1	CREVICE NOZZLE D:35MM		+036226

**Note**

>> means: New or changed ref. no.