

SUPPLEMENT

INFO DM,

Marking of carbon brushes

Motor type	Voltage	Watt	Standard carbon	Special carbon*	Mark **	Size mm
GAE-GAD	65-250	500	313077	315538	EG 224	6 x 10 x 32
GAE-GTECH	24-50	500	212835		F 3	6 x 10 x 25
GAH 200-800 Hz	115	500		314217	DH	6 x 10 x 32
GTE-GTES GTESCH-GVE	50-250	500	313077	315538	EG 224	6 x 10 x 32
GSD-GST-GSF	70-85/130-250	700	315432		EG 236	6 x 10 x 32
GSD-GST GSJ-GSJF-GSF	90-130	700		317110	9243	6 x 10 x 32
GSD-GSJ-GSJF	70-85/130-250	700		315254	EG 236	6 x 10 x 32
GSE-GSEJ	115	500		315538	EG 224	6 x 10 x 32
GSH 200-800 Hz	115	500		314217	DH	6 x 10 x 32
GMD-GMI-GVX GMF-GM 200	200-250	1000	316422		9243 F 10	6 x 12 x 52
GMJ	200-250	1000		#317456	9243 F 10	6 x 12 x 52
GVX	90-130	700		#317456	9243 F 10	6 x 12 x 52

\* Special carbon:  
Carbon brush with steatite ring

\*\* Mark in carbon brush

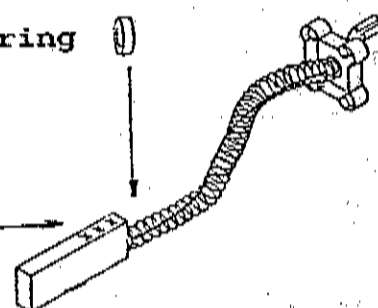

Important

It is very important to use the correct carbon brushes in the motors, in order to obtain maximum lifetime for the brushes.

NILFISK

Classification

Motor type	Standard	Unit	GSD	GSD	GST	GSJ	GSJF	GSF
Voltage	IEC 335	V	70-250	70-250	70-250	70-250	70-250	70-250
Frequency	-	Hz	50-60	50-60	50-60	50-60	50-60	50-60
Rated power	IEC 335	W	700	700	700	700	700	700
Max. power	IEC 335	W	850	850	850	850	850	850
Motor revolutions	-	rpm	16800	16800	16800	16800	16800	16800
Protec. grade (mec.moist.dust)	IEC 529	-	IP 40	IP 40	IP 40	IP 40	IP 40	IP 40
Protec. class (electrical)	IEC 335	-	II ☐	II ☐	II ☐	I	I	II ☐
Motor cooling	-	-	direct	direct	direct	direct	direct	direct
Switch type	-	-	1 pole	1 pole	2 poles	2 poles	2 poles	2 poles
Cable connection	IEC 320	-	plug	plug	plug	plug	fixed	fixed

Filter systems

	GSD	GSD	GST	GSJ	GSJF	GSF
Diffuser filter	x	-	x	x	x	x
Micro-static filter	-	x	-	-	-	-
Optionals						
Motor protection filter	x	x	x	x	x	x
Exhaust filter	x	x	x	x	x	x
Sound suppressor	x	x	x	x	x	x
Blowing attachment	x	x	x	x	x	x

Dimensions

	cm	GSD	GSD	GST	GSJ	GSJF	GSF
Height	27.7	27.7	27.7	27.7	27.7	27.7	27.7
Diameter	22.9	22.9	22.9	22.9	22.9	22.9	22.9
Weight	3.7	3.7	3.7	3.7	3.7	3.7	3.7

References

Ref.No. *	12210xxx	122105xx	12240xxx	12230xxx	12300xxx	122901xx
Spare parts, plan	0 B 1 - 0 B 5					
Standard cables*, plan	0 T 1					

Voltage/index

Voltage	70	75	85
xx-index	23	24	26

Voltage	100	110	115	120	125	130	140	150	160	175	190
xx-index	27	28	30	32	33	34	38	40	42	44	46

Voltage	200	208	230	240	250
xx-index	48	49	52	54	56

REMARK

\* See Order Specification for your country, plan 19 A 3 - 19 A 5

NILFISK

WHEN  
DEPLETED  
NO LONGER  
ON STOCK

**NILFISK**

97-11 MOTOR TOP AS PER MAY 1997 0 B 1

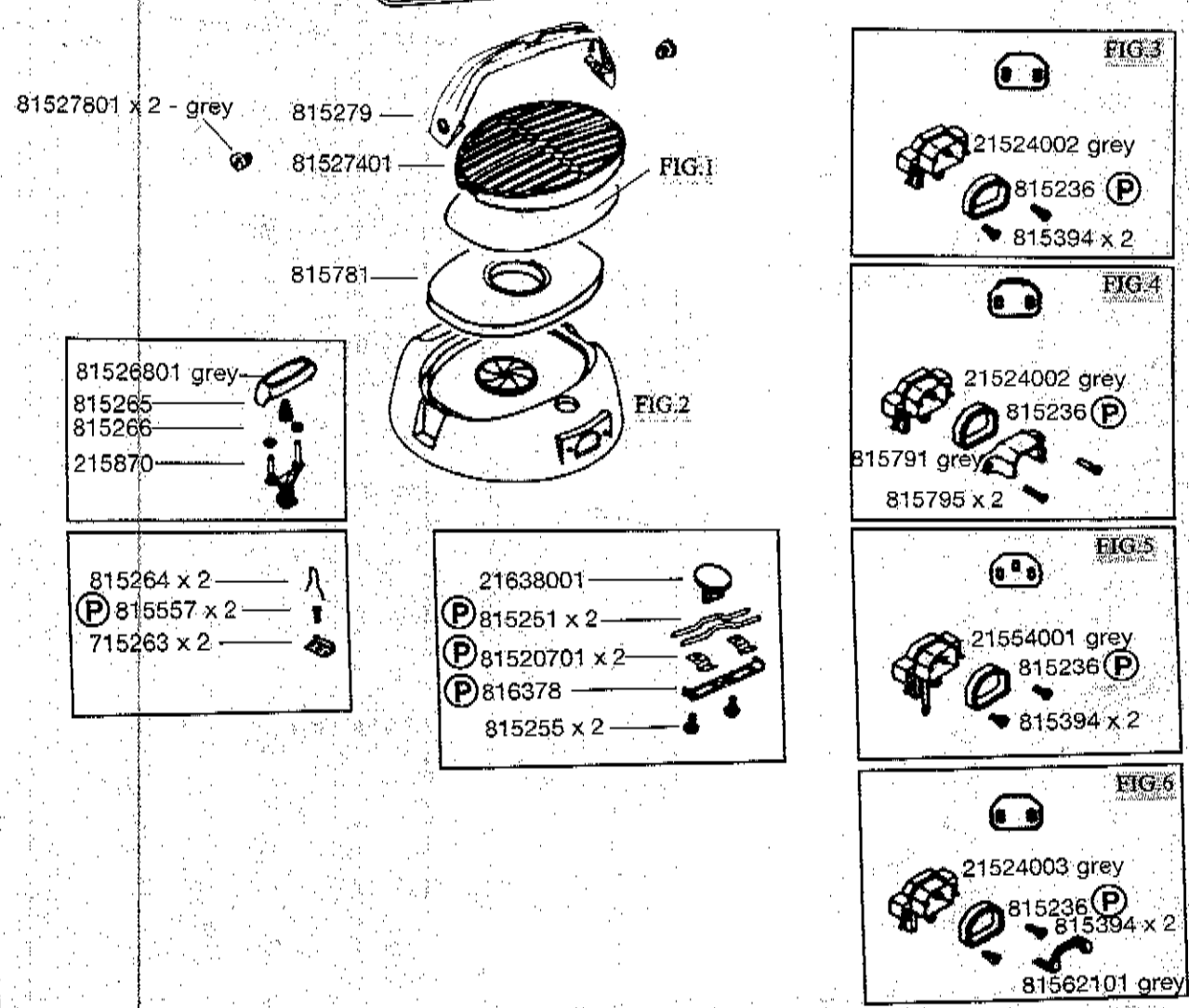

Filters			
Ref.No.	Description	For motor types	Fig.
21593001	Diffuser dark blue	All GS motors	1
11641000	Micro-static	GSD	1

Top casing			
Ref.No.	Description	For motor types	Fig.
(P) 81526900	Standard plastic	GSD, GST, GSF	2
(P) 81526901	UL-plastic	GSD, GSJ, GSJF, GSE, GSEJ, GSH	2

Sockets			
Ref.No.	Description	For motor types	Fig.
21524002	Standard	GSD, GST, GSE	3
21524002+815791	Standard and fixed cable	GSF	4
21554001	Earthed	GSJ, GSJF, GSEJ	5
21524003+81562101	Fixed cable	GSH	6

WHEN  
DEPLETED  
NO LONGER  
ON STOCK

**NILFISK**

Classification					
Motor type	Standard	Unit	GSE	GSEJ	GSH
Voltage	IEC 335	V	115	115	115
Frequency	-	Hz	50-60	50-60	200-800
Rated power	IEC 335	W	500	500	500
Max. power	IEC 335	W	650	650	650
Motor revolutions	-	rpm	15100	15000	15100
Protec. grade (mec.moist.dust)	IEC 529	-	IP 40	IP 40	IP 40
Protec. class (electrical)	IEC 335	-	II □	I □	II □
Motor cooling	-	-	direct	direct	direct
Switch type	-	-	1 pole	2 poles	1 pole
Cable connection	IEC 320	-	plug	plug	plug
Remark	-	-	-	-	high frequency

Filter systems				
Diffuser filter		x	x	x
Micro-static filter		-	-	-
<b>Optionals</b>				
Motor protection filter		x	x	x
Exhaust filter		x	x	x
Sound suppressor		x	x	x
Blowing attachment		x	x	x

Dimensions				
Height	cm	27.7	27.7	27.7
Diameter	cm	22.9	22.9	22.9
Weight	kg	3.7	3.7	3.8

References			
Ref.No. *	12220x30	12310130	12250130
Spare parts. plan	0 B 1 - 0 B 6		
Standard cables*. plan	0 T 1		

REMARK  
\* See Order Specification for your country. plan 19 A 3 - 19 A 5

Ref.No.	Description	For motor types	Fig.
(P) 32105100	Standard 700 W, 70-250 V	GSD, GST, GSF	1
(P) 32105200	With steatite ring 500/700 W, 90-220 V	GSD, GST, GSJ, GSJF, GSF, GSE, GSEJ	1

**Condenser**

Ref.No.	Description	For motor types	Fig.
81717200	Standard 100-250 V	All GS motors	2
81718900	Standard 70-99 V	All GS motors	3

MOTORS			GS MOTORS
0	B	2	CASINGS

**PRUNED MODELS  
AS PER MAY 1997**

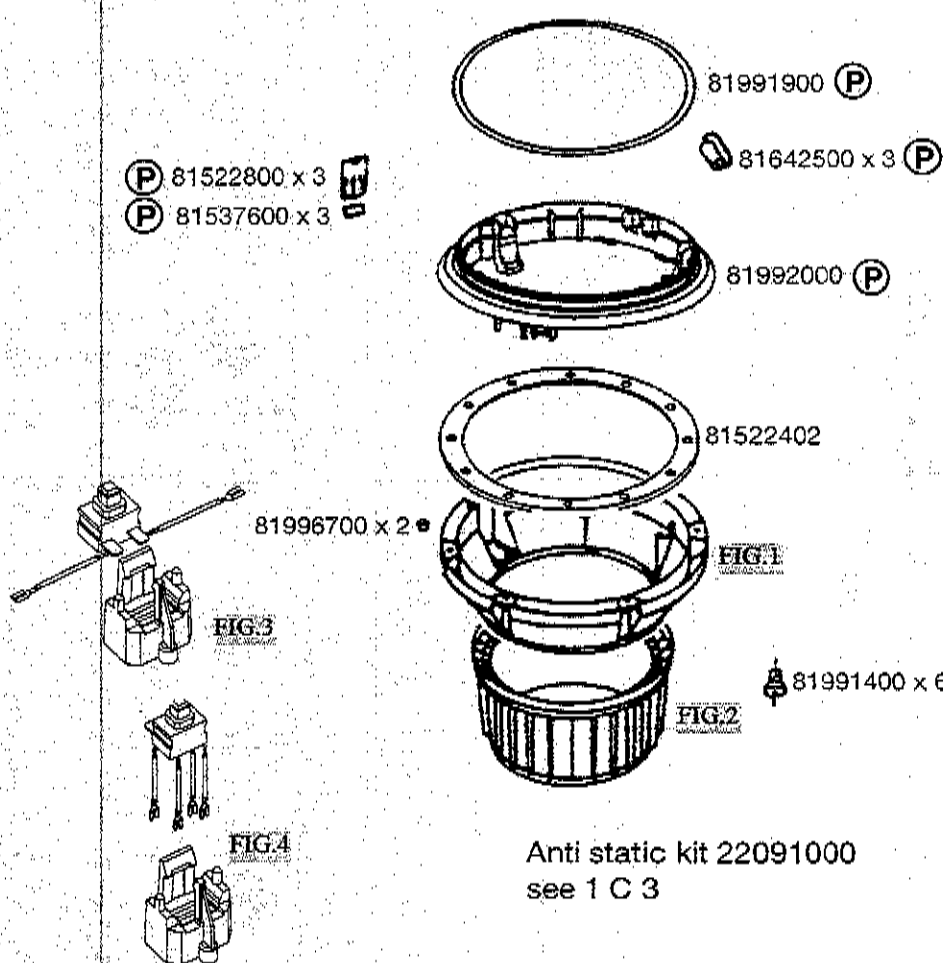

**Fan casing**

Ref.No.	Description	For motor types	Fig.
(P) 81584404	Standard plastic	GSD, GST, GSF	1
(P) 81584405	UL-plastic	GSD, GSJ, GSJF, GSE, GSEJ, GSH	1

**Motor casing**

Ref.No.	Description	For motor types	Fig.
(P) 81523102	Standard plastic	GSD, GST, GSF	2
(P) 81523103	UL-plastic	GSD, GSJ, GSJF, GSE, GSEJ, GSH	2

**Switch kit**

Ref.No.	Description	For motor types	Fig.
32103900	Kit with 1-pole switch and plate	GSD, GSE, GSH	3
32104000	Kit with 2-pole switch and plate	GST, GSF, GSJ, GSJF, GSEJ	4

**WHEN  
DEPLETED  
NO LONGER  
ON STOCK**

**97-06 FAN PARTS**

0	B	3
---	---	---

**PRUNED MODELS  
AS PER MAY 1997**

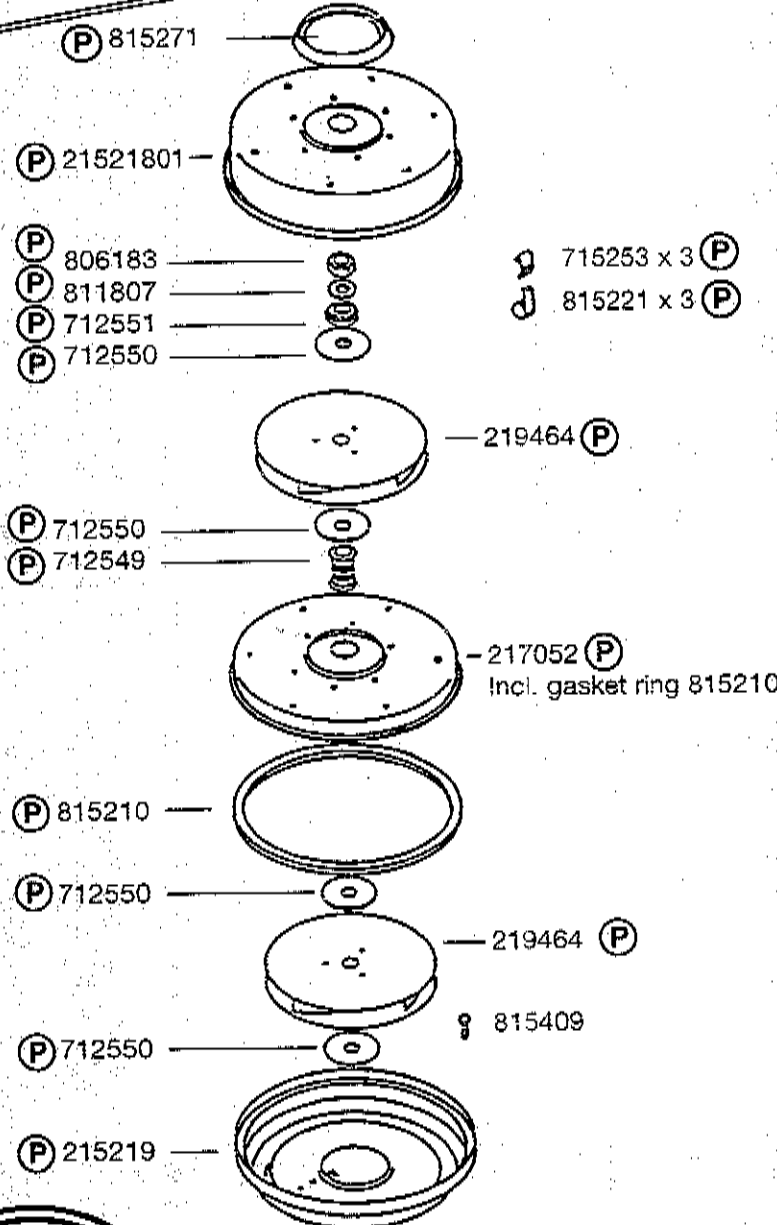

**WHEN  
DEPLETED  
NO LONGER  
ON STOCK**

**MOTORS**

**GS MOTORS**

0

B

4

**MOTOR PARTS**

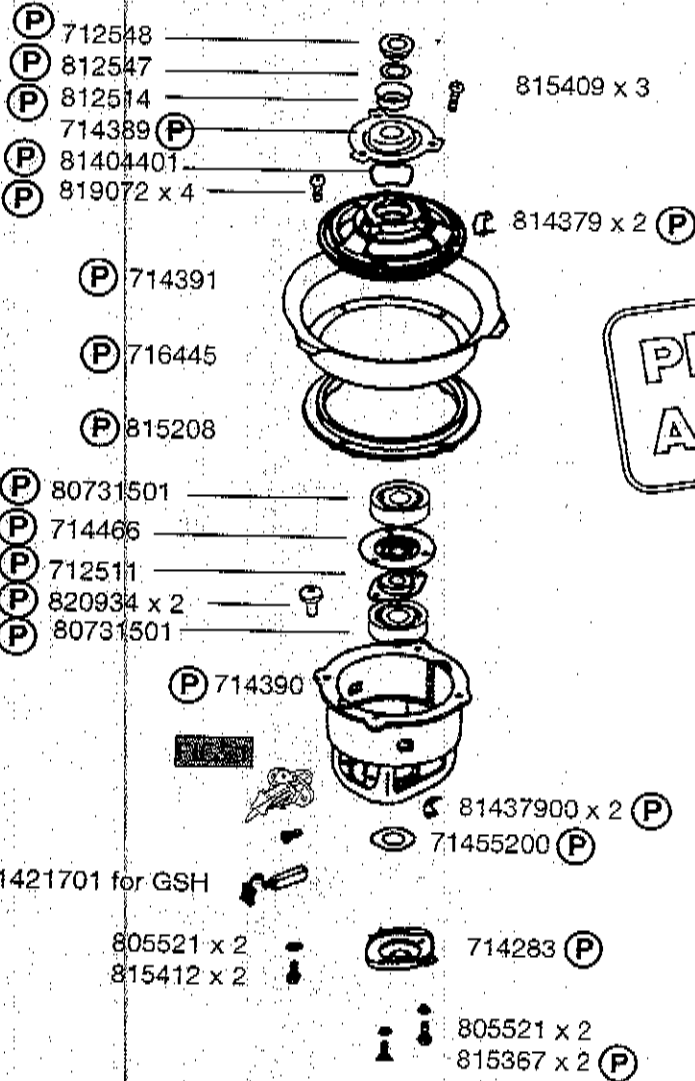

**PRUNED MODELS  
AS PER MAY 1997**

**WHEN  
DEPLETED  
NO LONGER  
ON STOCK**

**Carbon brush kit, 2 carbon brushes with holder and 4 screws**

Ref.No.	Description	For motor types	Fig.
(P) 32105100	Standard 700 W, 70-250 V	GSD, GST, GSF	1
(P) 32105200	With steatite ring 500/700 W, 90-220 V	GSD, GST, GSJ, GSJF, GSF, GSE, GSEJ	1

**Condenser**

Ref.No.	Description	For motor types	Fig.
81717200	Standard 100-250 V	All GS motors	2
81718900	Standard 70-99 V	All GS motors	3

97-06

## ARMATURE, FIELD COIL

0

B

5

For 700 watt, motor types: GSD, GST, GSJ, GSC and GSJF  
 For 500 watt, motor types: GSE and GSEJ

Armature  
 Ref.No. 219995xx (P)

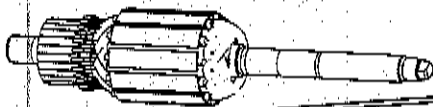

Field coil  
 Ref.No. 220930xx (P)

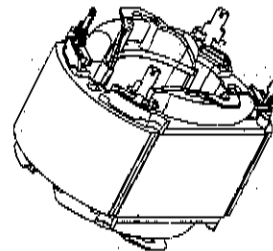

Internal wiring

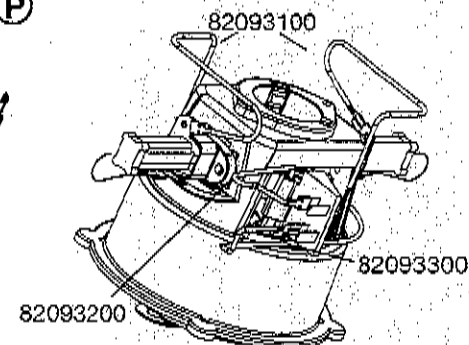

**PRUNED MODELS  
 AS PER MAY 1997**

**Armature: 219995xx for 700 W (P)**

Voltage	100	110	115	120
xx=index	06	18	07	07
Voltage	200	220	230	240
xx=index	12	20	20	14

**Armature: 219995xx (P)  
 for 700 W for GSC only**

Voltage	220-240
xx=index	20

**Armature: 219995xx for 500 W (P)**

Voltage	115
xx=index	07

**Field coil: 220930xx (P)  
 for 700 W for GSC only**

Voltage	220-240
xx=index	30

**Field coil: 220930xx (P)  
 for 500 W**

Voltage	115
xx=index	08

For wiring instructions,  
 see Book 4, Plan 0 B 5  
**NOTE:** Internal wires  
 interchanged compared  
 to old coil.

**TEST:** Clockwise  
 rotation of armature  
 seen from commutator  
 (test can be performed  
 at 30V).

**Field coil: 220930xx for 700 W (P)**

Voltage	100	110	115	120
xx=index	07	20	20	21
Voltage	200	220	230	240
xx=index	44	30	30	31

**WHEN  
 DEPLETED  
 NO LONGER  
 ON STOCK**

**Motor wires to condenser**

Ref.No.	Description	Pcs	Length
82093100 (P)	Field to brush	2	130 mm
82093200 (P)	Field to condenser	1	95 mm
82093300 (P)	Field to condenser for 70-250V	1	180 mm

**Internal wires from  
 condenser 100-250 V**

Ref.No.	Length
71526100 (P)	295 mm
71529100 (P)	370 mm
71719400 (P)	260 mm

**For GSC only, fixed cable length**

xx=Index	Ref. no. 819927xx		Ref. no. 820448xx	Plug type
	7 meter	10 meter		
Index 01, Standard	x	x		
Index 02, Italy	x			
Index 03, British Std.	x			
Index 06, AUS		x		
Index 07, CH	x			

**NILFISK**

<b>MOTORS</b>			<b>GS MOTORS</b>
<b>0</b>	<b>B</b>	<b>6</b>	<b>ARMETURE, FIELD COIL</b>

For 500 watt, motor type: GSH 115 volt and 200-800 Hz only

Armature



(P) 21250109

Fields coil



(P) 21428051

Internal wire

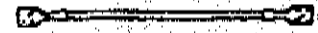

**PRUNED MODELS  
AS PER MAY 1997**

Condensers

Rectifier

(P) 317064

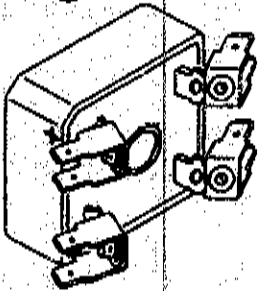

815412  
805521

214795 (P)

(P) 814904

814211 (P)

815412 805521

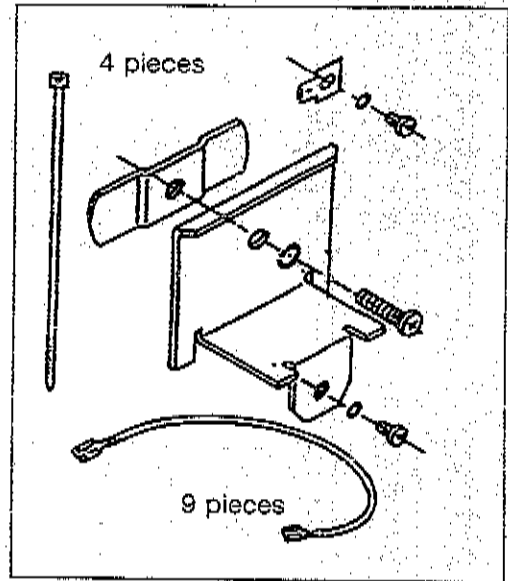
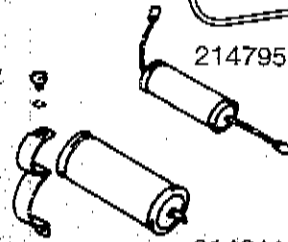

Radio noise filter

(P) 31706

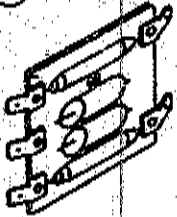

**WHEN  
DEPLETED  
NO LONGER  
ON STOCK**

**Internal wires for 115 volt**

Ref.No.	Length
(P) 11392100	180 mm
(P) 11389100	115 mm
(P) 61054100	75 mm
(P) 61382900	200 mm
(P) 61616500	245 mm
(P) 61616500	295 mm
(P) 61616500	150 mm

For wiring instructions see Book No. 4 plan 0B7.