

97-06

GM MOTORS

97-11

MOTOR TOP

**PRUNED MODELS  
AS PER MAY 1997**

MOTORS		
0	C	1

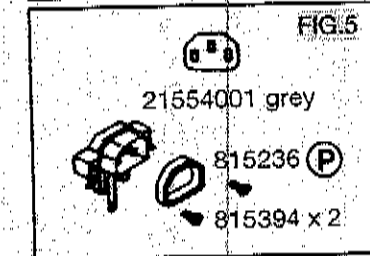
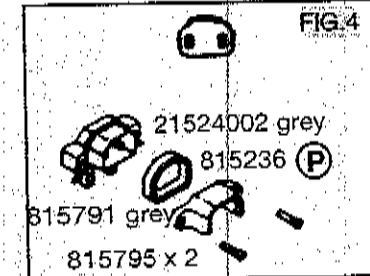
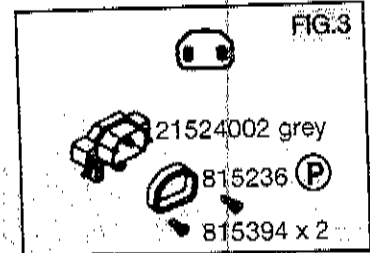
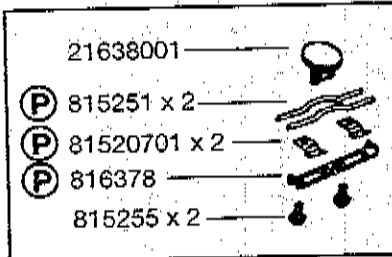
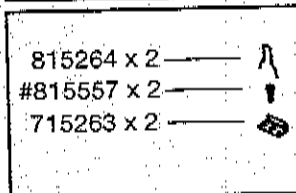
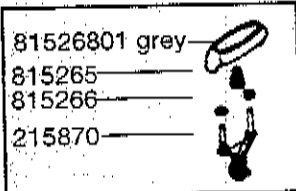
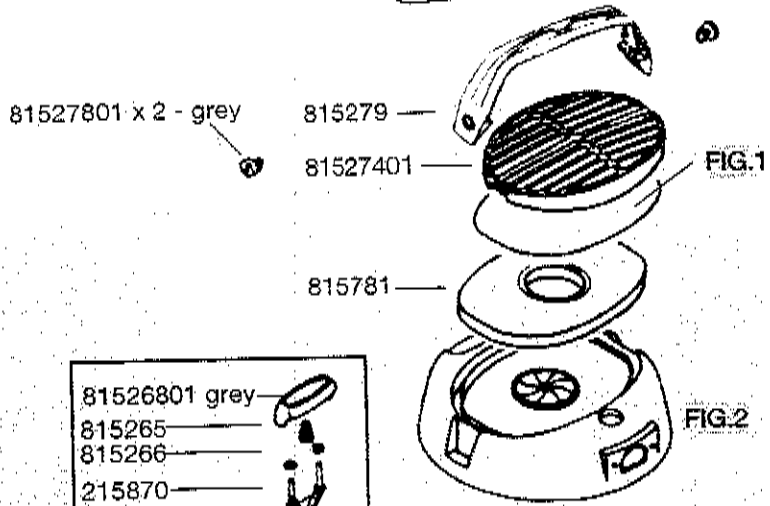

Filters			
Ref.No.	Description	For motor types	Fig.
21593001	Diffuser dark blue	GMI, GMF, GMJ	1
11641000	Micro-static	GMD	1

Top casing			
Ref.No.	Description	For motor types	Fig.
(P) 81526900	Standard plastic	GMD, GMI, GMF	2
(P) 81526901	UL-plastic	GMD, GMI, GMJ	2

Sockets			
Ref.No.	Description	For motor types	Fig.
21524002	Standard	GMD, GMI	3
21524002+815791	Standard and fixed cable	GMF	4
(P) 21554001	Earthed, grey	GMJ	5

**WHEN  
DEPLETED  
NO LONGER  
ON STOCK**

96-11 GM MOTORS

97-06 FAN PARTS

MOTORS

0

C

3

PRUNED MODELS  
AS PER MAY 1997

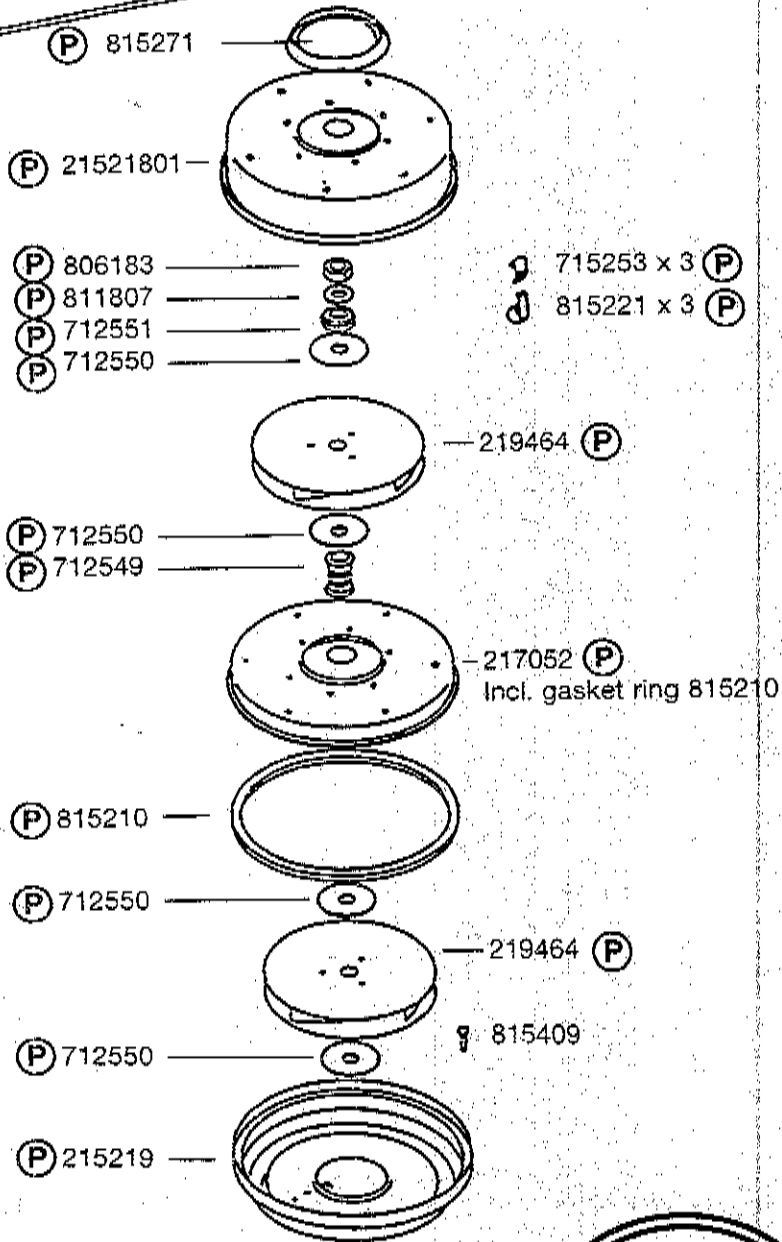

WHEN  
DEPLETED  
NO LONGER  
ON STOCK

MOTORS		
0	C	2

**GM MOTORS**  
**CASINGS**

**PRUNED MODELS**  
**AS PER MAY 1997**

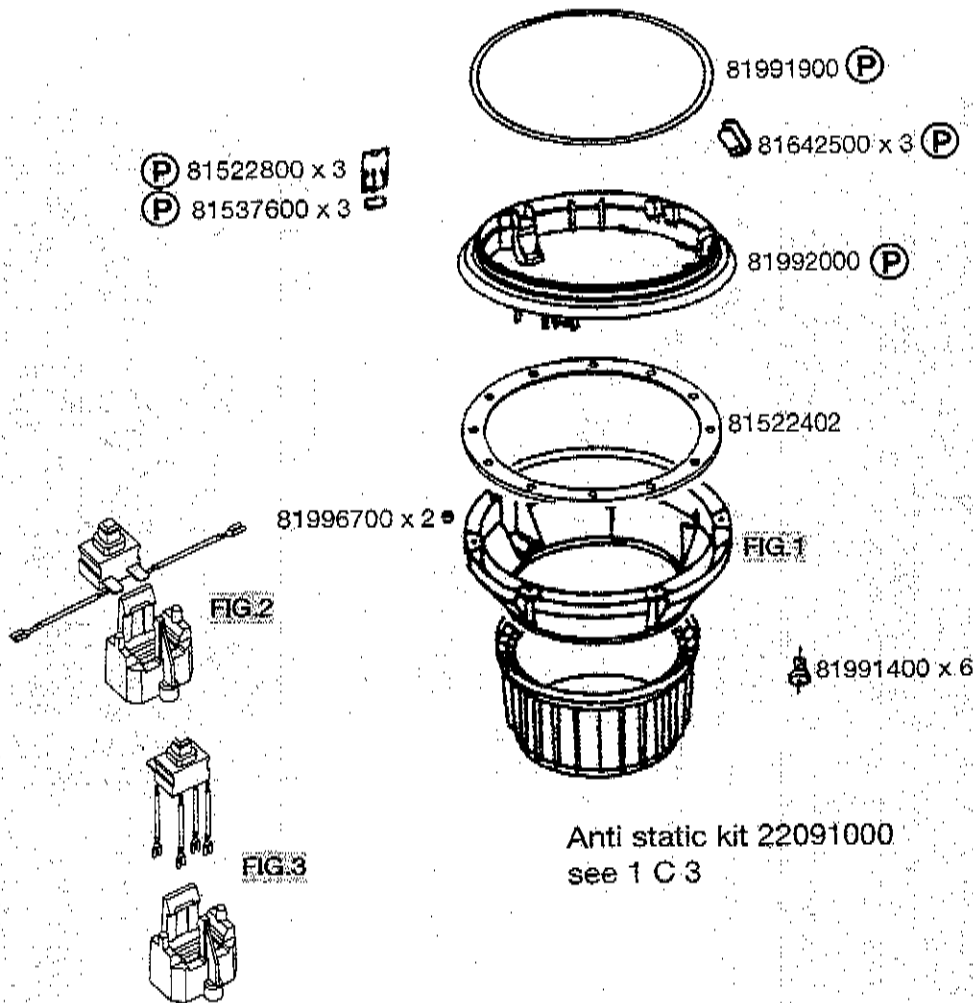

**WHEN DEPLETED**  
**NO LONGER ON STOCK**

Motor casing			
Ref.No.	Description	For motor types	Fig.
(P) 81641900	Standard plastic	GMD, GMI, GMF	1
(P) 81641901	UL-plastic	GMD, GMI, GMJ	1

Switch kit			
Ref.No.	Description	For motor types	Fig.
32103900	Kit with 1-pole switch and plate	GMD	2
32104000	Kit with 2-pole switch and plate	GMI, GMF, GMJ	3

MOTORS		
0	C	4

**GM MOTORS**  
**MOTOR PARTS**

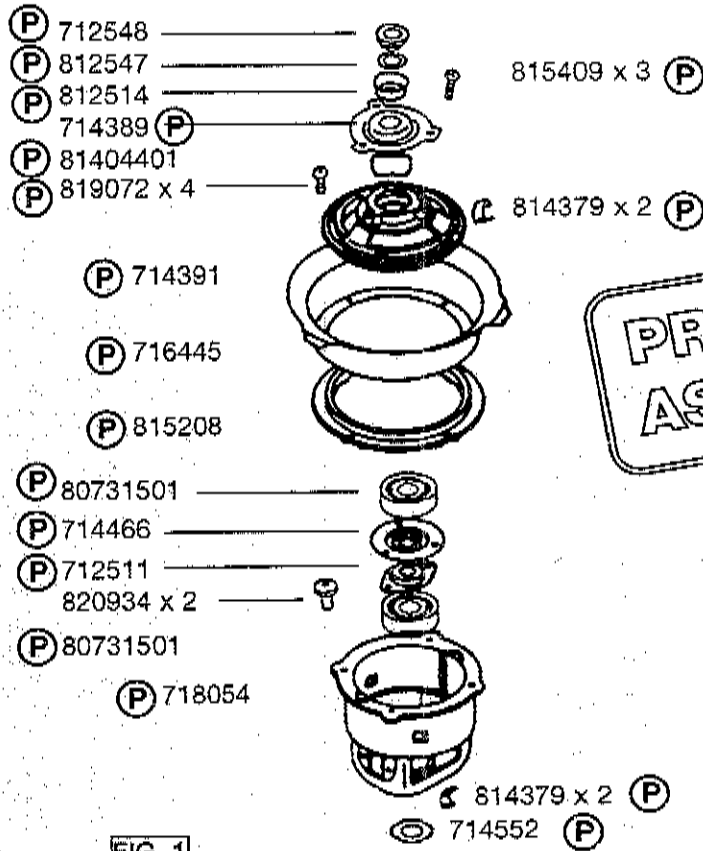

**PRUNED MODELS  
AS PER MAY 1997**



FIG. 2

805521  
815412

FIG. 1

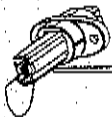

714283 (P)

805521 x 2  
815367 x 2

**WHEN  
DEPLETED  
NO LONGER  
ON STOCK**

Carbon brush kit, 2 carbon brushes with holder and 4 screws			
Ref.No.	Description	For motor type	Fig.
(P)32000000	Carbon brush kit	GM	1.

Condenser			
Ref.No.	Description	For motor types	Fig.
81717200	Standard 200-250 V	All GM motors	2