

4" LED Slim Panel Light



Project	
Type	
Quantity	
Notes	

Certifications



Line-up

Model No.	Power [W]	Light Colour [K]	Light Output [lm]	Efficacy [lm/W]	Input Voltage [V]	Beam Angle	CRI	PF
CCR-PR023R8-9W-3	9	3000	800	89	120	120°	>80	>0.9
CCR-PR023R8-9W-4	9	4000	850	94				
CCR-PR03R8-9W-5	9	5000	900	100				

Technical Drawings

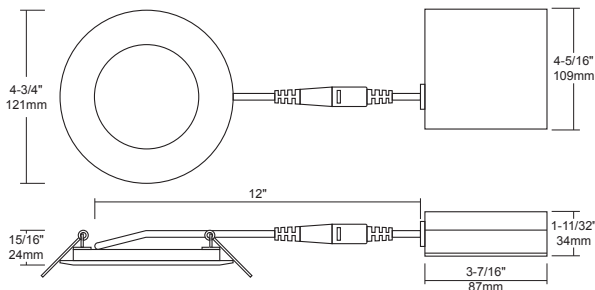

Features

Housing Material	Airtight Aluminum body with white polycarbonate diffuser lens
Dimming	10%-100% dimming capability, compatible with standard dimmers.
Mounting	Two spring loaded chips, suitable for recessed ceiling mount.
LED Driver	Hardwire box with 300mA dimmable class II electronic LED driver with 100-135VAC input, includes a 12" cable from driver to fixture.
Operating Temperature	-20°C to 40°C
Application	Mainly indoor, suitable for damp locations.
Warrenty	3-year warrenty



www.ccrled.com
 cledlighting@gmail.com
 ccrincled@gmail.com

2-91 Esna Park Dr., Markham, L3R 2S2
 [T] 1.905.698.0359
 13-170 Esna Park Dr., Markham, L3R 1E3
 [T] 1.905.604.0143

1-155 Wings Rd., Woodbridge, L4L 6C7
 [T] 1.905.856.0903
 64-7250 Keele St., Vaughan, L4K 1Z8
 [T] 1.647.887.7403