



AREAS OF APPLICATION

- General illumination
- Suitable for Outdoor applications

PRODUCT HIGHLIGHTS

- Easy installation
 - Using high-brightness LED chip, energy saving and environmental protection, stable lighting, long service life
 - Optical grade lampshade, good light, anti-aging, not easy to damage
 - High thermal conductivity aluminum alloy shell, good heat dissipation, vacuum dust-free spraying, anti-corrosion, no peeling
 - Strict waterproof treatment technology, in line with international waterproof and dustproof standards
 - Radiation protection design, will not affect the lighting effect due to weather
 - Charming appearance and fashionable
- Product Features**
- LED classic induction lighting function
 - Color temperature: (3000K-5000K)+RGB
 - Life time: more than 30000h
 - Contains no mercury
 - Working environment: Dry Location, Damp Location, wet location



FA8UD 15W
FA8UD0 30W
FA8UD1 50W
FA8UD3 100W



Electrical data

Power supply	RGB Dimming power supply + Bluetooth power supply
Working frequency	50/60HZ
Rated wattage	15W/30W/50W/100W
Power factor	>0.9
Rated voltage	100-347V
Equiv. Power of CLF	80W/180W/300W/600W

Beam angle

Chip Brand and model	2835
Quantity of lamp beads	124 (3030)12 (5050)/64*2/64 (3030)32 (5050)/200
Directional color	White light + Warm light + RGB
Color temperature deviation	-
Color temperature	(3000K-5000K)+RGB
Lumen	7200-8000 lm/9000-10000 lm
Light efficiency	90-100 lm/W
CRI	>80
Beam angle	90X120

Lighting technical parameters

Start Time	< 1 s
Light control	APP+Power switch control

lifetime

Number of switching cycles	10000
Rated lifetime	30000 h

Other product data

Shell	High thermal conductivity aluminum alloy
Cover	Clear lens
Without Mercury	Yes
Product Notes	-
Lamp holder	-

Functions

Dimmable	Yes
Compatible with smart home technology	Yes

Certificates and standards

Certification	ETL
---------------	-----

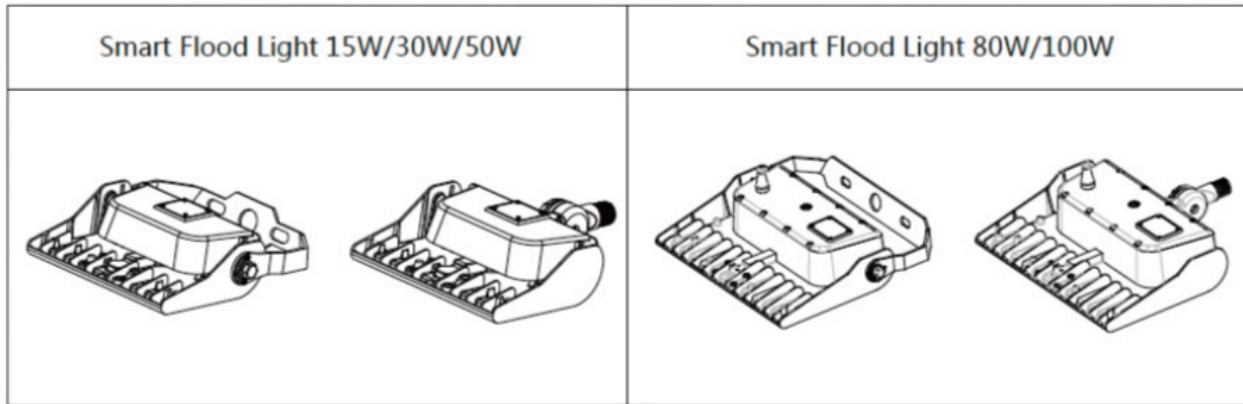

1. Take out the light from package, adjust the bracket and make the wire go through the hole on the bracket.



2. Disconnect the power supply, drill two holes in the wall and screws into the wall. After the power cord penetrates into the wall, the bracket is aligned with the hole of the wall and then locked into the screw to fix it on the wall. Connect the black line, white line, yellow rolling green line with L N G line corresponding.

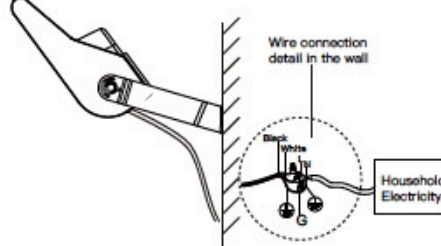

Logistics data

Packing category	Packaging unit (Pieces/Unit)	Dimensions (mm)	Gross weight (g)	Volume
Neutral box	1/1	340 mm x 113mm x 225mm	- g	8.64dm ³
Master carton	1/4	475 mm x 355 mm x 248 mm	- g	41.82 dm ³

Disclaimer

This product data sheet provides periodic information, and the content can be updated at any time according to the actual situation of the product without notice. If caused by improper use of this product data sheet The company does not assume any responsibility for direct or indirect losses



Accessories name	Specification Description	Quantity
American screw terminal	PG \ Pressure resistance 300V \ Temperature resistance 105 °C \ Fire rating UL94V-2 \ φ12.5*22mm\ RCHS	3PCS
Tighten the screws	Screw \PM4*8mm\ Cross head machine tooth \ flat end \304 stainless steel 2	2PCS

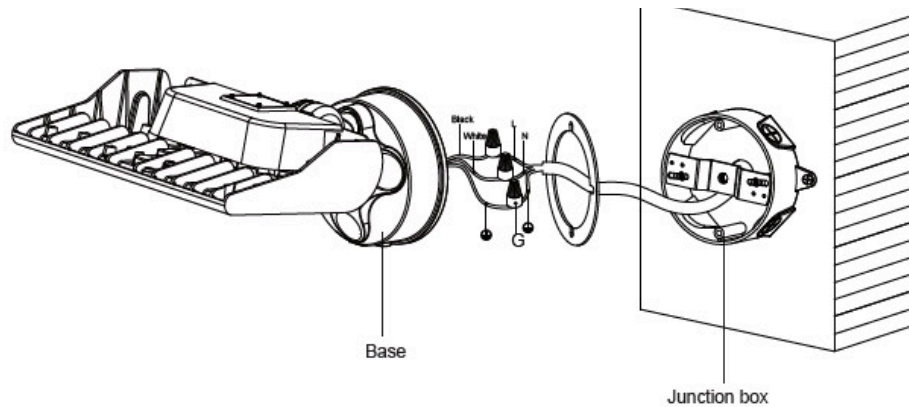

1. Take out the lamp, disconnect the power supply, pass the power cord through the junction box and fix the junction box on the wall. Fix the lamp power cord through the base and fix it with a nut. Put the black wire, white wire and yellow rolling green wire passing the gasket respectively and

Download app

This product can be intelligently controlled via the Home Linking APP, scanning QR codes or downloading mobile clients in the app store.



Google Play



APP Store

Add device

1. Open the app, log in or register for an account to enter the home page;
2. Click [+] in the upper right corner and select [Add] to enter the adding process.
3. If adding failed, please reset the device and add again. Power on and off 5 times continuously. Reset will be successful when downlight flashing.

Device Parameters

Product Name: Smart Flood Light
 Model: FU8AD2(for device adding of APP)
 Power: 15W/30W/50W/80W/100W
 CCT: 3000K-5000K
 Brightness Range: 1%—100%
 Voltage: 100-277V 50/60Hz
 CRI: >80
 Bean Angle: 90X120°
 Color: Brown
 Communication Method: Bluetooth mesh

Product Name: Smart Flood Light(CCT+RGB)
 Model: FU8AD3(for device adding of APP)
 Power: 15W/30W/50W/80W/100W
 CCT: (3000K-5000K)+RGB
 Brightness Range: 1%—100%
 Voltage: 100-277V 50/60Hz
 CRI: >80
 Bean Angle: 90X120°
 Color: Brown
 Communication Method: Bluetooth mesh