

Product Feature



- Easy to install and use
- High Brightness Led chip, energy-saving and environmental protection, stable lighting, long lifespan
- Optical lamp cover, good Light, anti-aging and not easy to damage
- High thermal conductivity aluminum aluminum shell, good heat dissipation, vacuum dust-free spraying, anti-corrosion and no stripping
- Strict waterproof treatment technology, in line with international standards for water and dust resistance.
- Charming appearance and fashionable.

Control App: Home Linking



find at:



- Classic LED induction lighting function
- Color temperature: (2700K-5000K)+RGB
- Lifetime: up to 30,000 h
- Hg-free
- Working environment: Dry Location, Damp Location

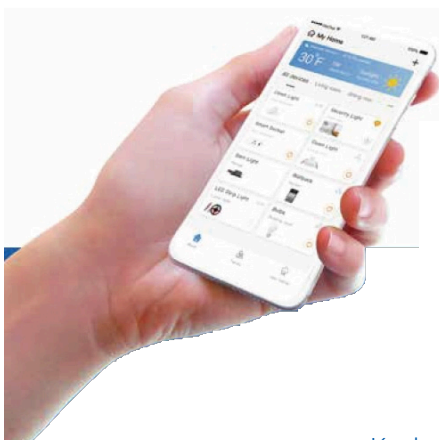
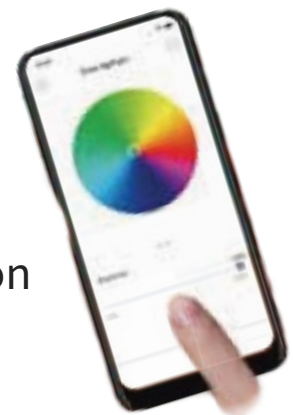

Electrical data

| | |
|---------------------|---|
| Power supply | Dimming+RGB power supply Bluetooth module |
| Working frequency | 50/60HZ |
| Rated wattage | 9W |
| Power factor | >0.7 |
| Rated voltage | 100-277V |
| Equiv. Power of CLF | 60W |

Beam angle

| | |
|-----------------------------|--------------------------------|
| Chip Brand and model | 2835+3838 |
| Quantity of lamp beads | 48+24 |
| Directional color | White light + Warm light + RGB |
| Color temperature deviation | - |
| Color temperature | (2700K-5000K)+RGB |
| Lumen | 600 lm |
| Light efficiency | 60-70 lm/W |
| CRI | >90 |
| Beam angle | 100° |

Lighting technical parameters

| | |
|---------------|----------------------------|
| Start Time | < 1 s |
| Light control | APP Control+Switch control |

lifetime

| | |
|----------------------------|---------|
| Number of switching cycles | 10000 |
| Rated lifetime | 30000 h |

Other product data

| | |
|-----------------|-------------|
| Shell | Aluminum+PC |
| Cover | Milky PC |
| Without Mercury | Yes |
| Product Notes | - |
| Lamp holder | - |

Functions

| | |
|---------------------------------------|-----|
| Dimmable | Yes |
| Compatible with smart home technology | Yes |

Certificates and standards

| | |
|---------------|---------|
| Certification | ETL FCC |
|---------------|---------|

Product installation

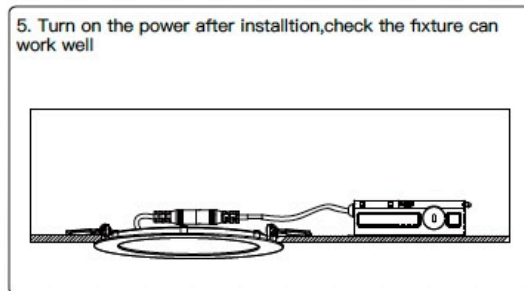
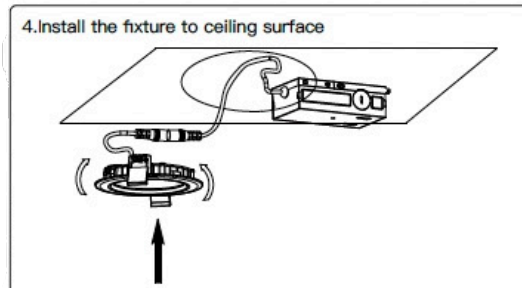
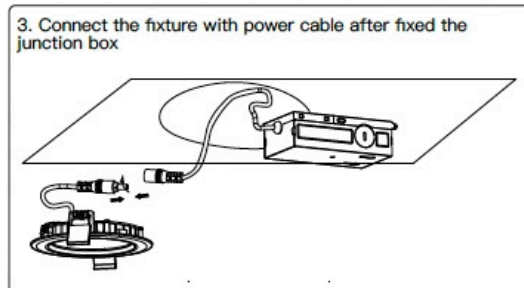
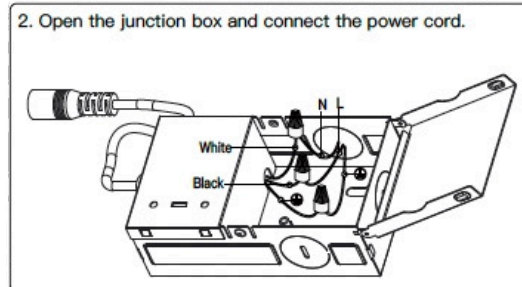
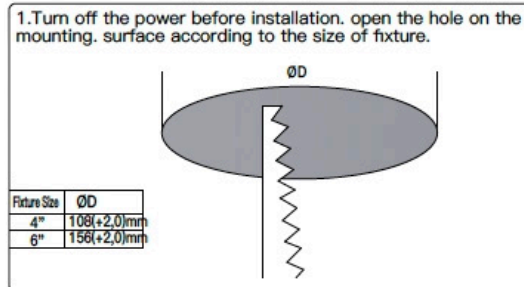

Product line drawing

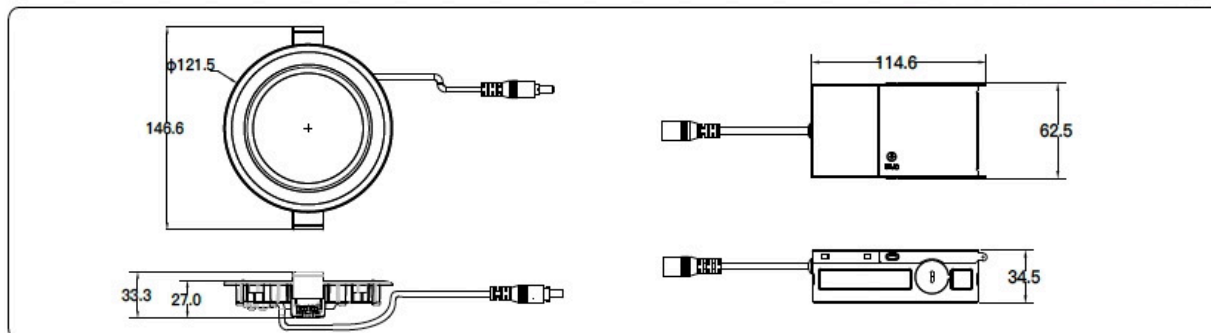

Logistics data

| Packing category | Packaging unit (Pieces/Unit) | Dimensions (mm) | Gross weight (g) | Volume |
|------------------|------------------------------|--------------------------|------------------|-----------------------|
| White box | 1/1 | 145 mm x 145mm x 90mm | 418 g | 1.89dm ³ |
| Outer box | 1/30 | 455 mm x 305 mm x 480 mm | 13296 g | 66.61 dm ³ |

Disclaimer

This product data sheet provides periodic information, and the content can be updated at any time according to the actual situation of the product without notice. If caused by improper use of this product data sheet The company does not assume any responsibility for direct or indirect losses