

# BUMPER LIGHT COVER

Accessory

PART #101445

## Kit Components:

Item #	Qty.	Description
1	2	Bumper Light Cover
2	1	Hardware Kit (HK-345)
2.1	5	5/16"-18 X 1.00 Carriage Bolt Back
2.2	5	5/16"-18 Hex Flange Nylock Nut

**Note:** Make sure all hardware needed to complete this mount is in the package. Thoroughly read through and understand the instructions before installing.

1. Set the bumper light cover (1) over the accessory light cut out in the bumper and secure using bolts (2.1) and nuts (2.2) as shown in **Figure 1**. **NOTE:** Picture in Figure 1 is showing the driver side of the bumper. Repeat step 1 for passenger side.
2. Tighten all hardware evenly.

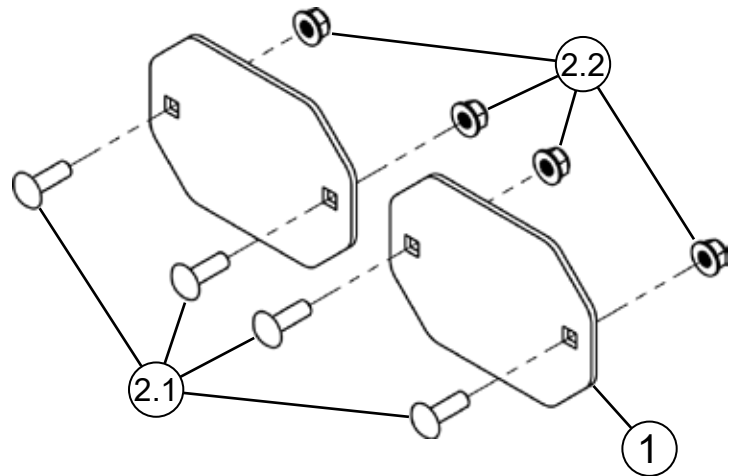

Figure 1

