

HOW TO ASSEMBLE AND ADJUST THE LENGTH OF YOUR DAT STRAP WITH THE FEED-THROUGH ADJUSTMENT SYSTEM

Every Dat Strap leather guitar strap is designed using a feed-through adjustment system so that its length can be adjusted exactly to your liking. It's made up of two parts: The main strap, and the narrower adjustment strap. There are nine holes on the main strap and one hole on the adjustment strap. Here is a simple guide to help you make the adjustment according to your preferred length.

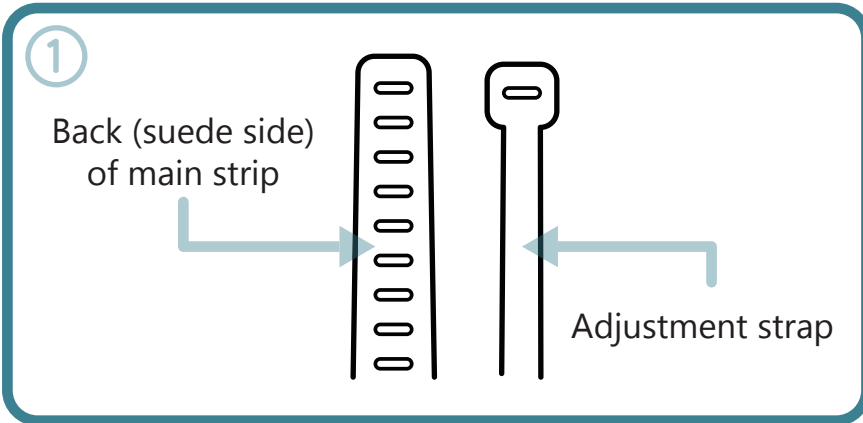

Dat Strap®

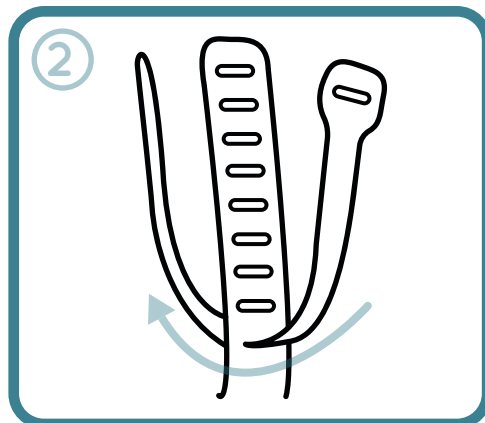

Thread the adjustment strap into the desired hole on the main strap. The further away from the end of the main strap, the shorter the strap will be. So before moving to step 3, ensure you have chosen your desired length. The hole on the adjustment strap should always be on the back (suede side) of the main strap.

Thread the end of the adjustment strap back through the next hole down on the top side of the main strap, and pass it through the hole on the adjustment strap.

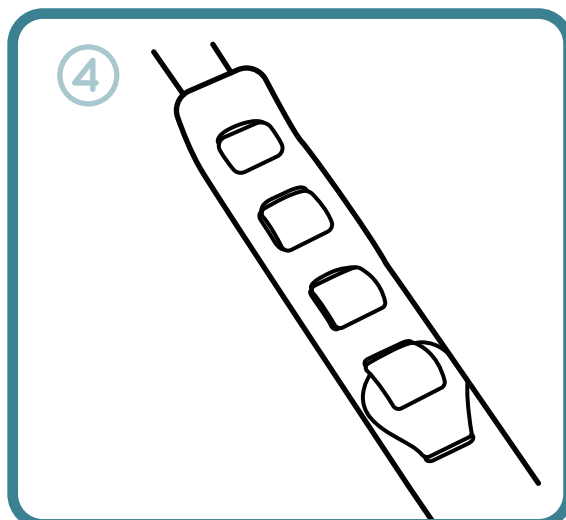
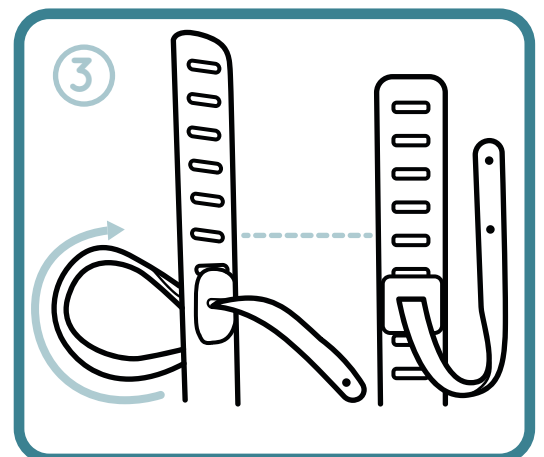

Finally, weave the adjustment strap through the remaining holes on the main strap and gently pull it snug. Done

HOW TO FASTEN YOUR DAT STRAP TO AN ACOUSTIC GUITAR WITH ONLY ONE STRAP PIN

For acoustic guitars with a single strap-pin, Dat Strap recommends using a simple shoe-lace (not supplied) to tie behind the strings on the guitar headstock. Simply take one end of your shoe-string and pass it under the strings just behind the top nut (the wood or plastic piece at the far end of the fretboard that keeps the strings separated). Bring the end of the string under and around the headstock. The string should ideally rest just behind the nut. Next, tie the ends of your string together. If your string is exceptionally long, you may want to "double it up" to reduce the distance between the strap and the headstock. Use a strong knot (or knots) - you don't want this string to come untied while you're playing!

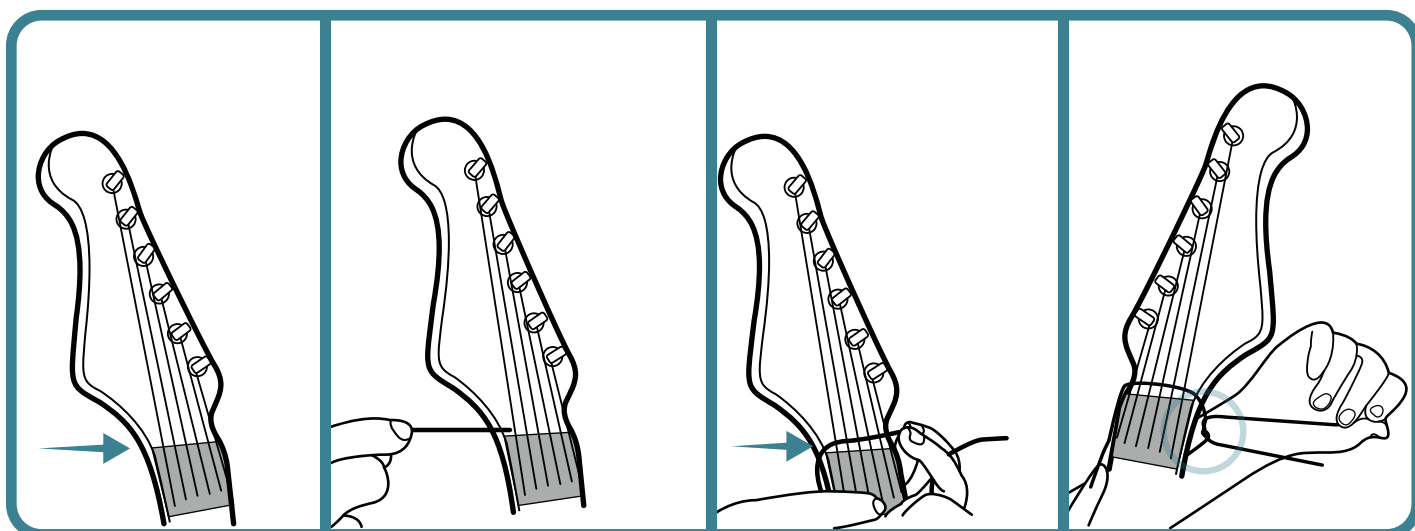
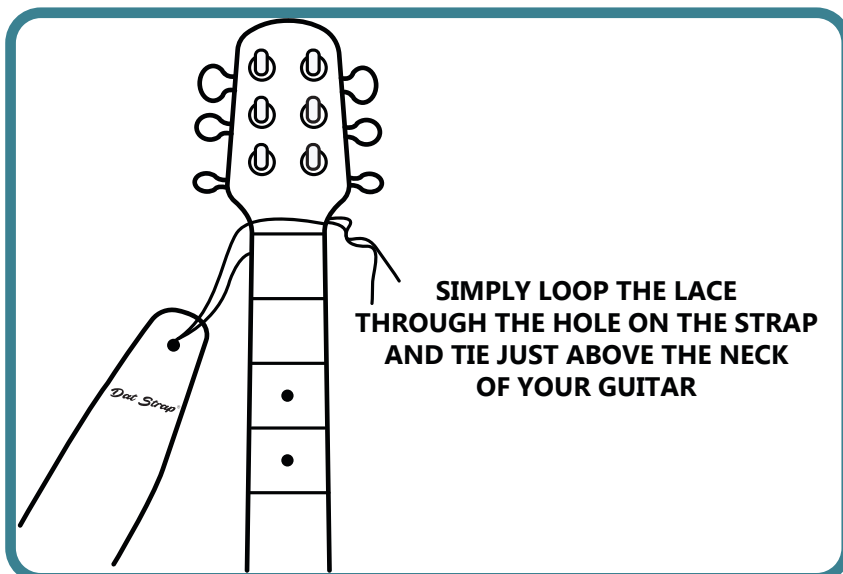

HOW TO FASTEN YOUR DAT STRAP LEATHER GUITAR STRAP TO THE GUITAR STRAP PINS

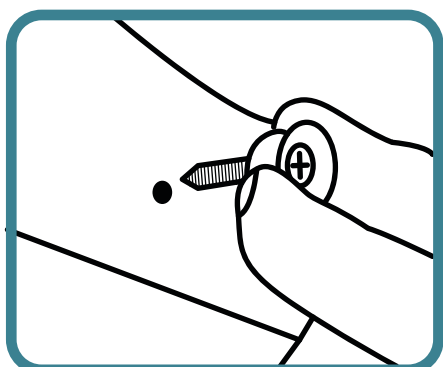

A common problem with leather guitar straps is the strap holes become larger over time as the leather wears in. This often leads to the strap simply coming off the guitar – not a desired effect! Dat Strap leather guitar straps have been designed to mitigate this problem by reducing the size of the strap pin holes. However, it may mean that your strap right out of the box, especially the smaller adjustments strap, is slightly difficult to attach on its first few uses. In this case, work the leather a little bit to stretch it slightly.

We recommend simply unscrewing your strap pin (as in the image) and attaching the strap directly to the strap pin at the

smaller end, and then screw it back on the guitar.

WHAT IS THE BEST AND SAFEST SOLUTION TO ATTACH MY DAT STRAP LEATHER GUITAR STRAP TO MY GUITAR?

We highly recommend the purchase of quick-release strap locks, which can be permanently attached to the strap, and then quickly released from the guitar as and when required.

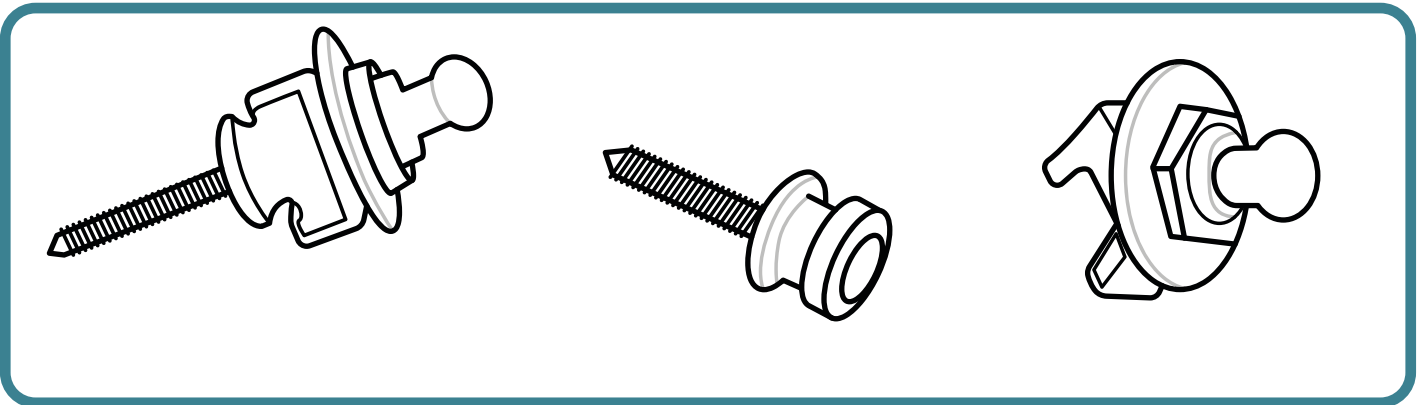

DOES THE LEATHER NEED TO BE TREATED?

A protective layer and seal has been applied during production ensuring your strap is protected from spills and scratches. It shouldn't need any special treatment, as long as it's not exposed to continuous heat. Though any neutral colour leather treatment can be used and will keep it fresh looking, though we wouldn't recommend using anything on the softer suede side.

Another tip for leather guitar straps is that whilst all Dat Strap leather guitar straps have been sealed, during the early days of usage, it's not recommended that you wear a white shirt on your gig, as some of the dye may rub off onto your nice white shirt. If this does happen, it's not the end of the world as most good quality stain removers will do exactly that - remove the stains!