

Trin 1.

Klik på linket: <http://dpcs.daedong.co.kr?ID=EUROPE>

Trin 2.

Klik på "search"

This screenshot shows two search filter sections. The left section, titled "Model Name", contains three dropdown menus: "Product" (set to "-ALL-"), "Model", and "Group". A black arrow points to the "Search" button in this section, which is circled in black. The right section, titled "Search Part", contains two input fields: "Part" and "Description", each followed by an orange "Search" button. Below this is a "Serial No Search" section with a "Serial No" input field and an orange "Search" button.

Trin 3.

Vælg UTV under Product - tryk derefter på søgeknappen.

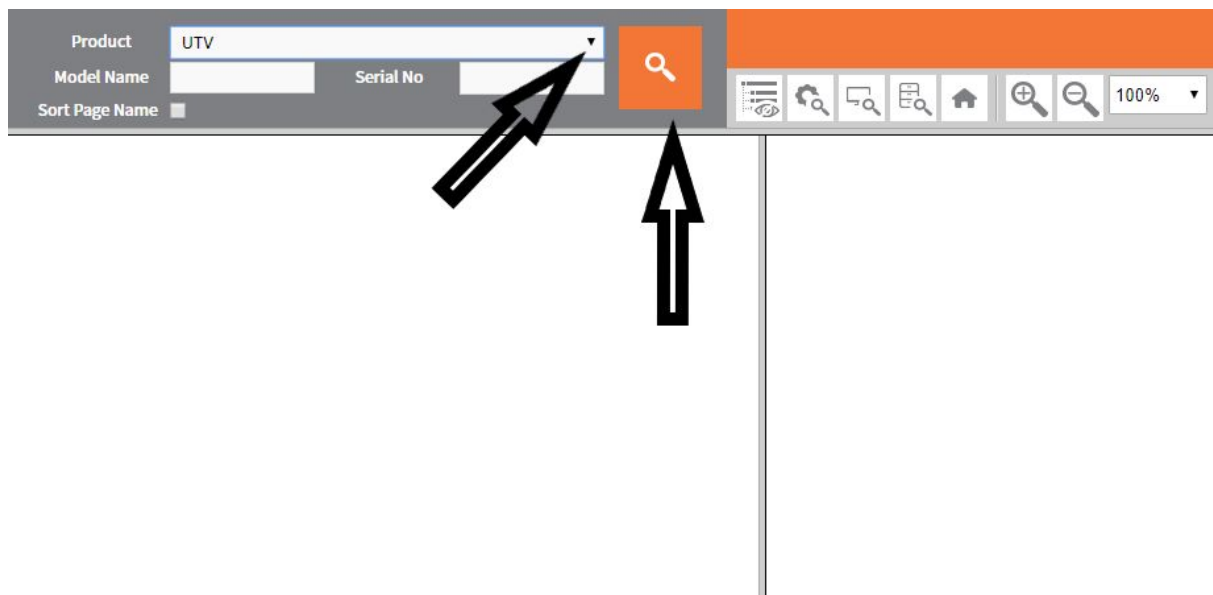

Trin 4.  
Vælg din model

Product: UTV

Model Name:

Serial No:

Sort Page Name:

- K9
  - K92400-EU
  - K92440-EU
- MEC
  - MEC2200SA
  - MEC2200SA-EU
  - MEC2200SHA-AU
  - MEC2200SHW(PZ06-00001~)
  - MEC2200SHW-AU
  - MEC2200ST-EU
  - MEC2200SW(JZ01-00001~NZ01-00106)
  - MEC2200SW-EU
  - MEC2210SA-EN
  - MEC2210SA-EU
  - MEC2210ST-EN
  - MEC2210ST-EU
  - MEC2210SW-EN
  - MEC2210SW-EU

Trin 5.  
Vælg en hovedgruppe og derefter en undergruppe - kopiere PART NUMBER og sende til [salg@roedkilde.com](mailto:salg@roedkilde.com) og vi vender tilbage med en pris.

Product: UTV

Model Name:

Serial No:

Sort Page Name:

UTV / K9 / K92400-EU / ENGINE / CYLINDER BLOCK GROUP / 3C100LWJ-E010

100% Hide Part List ?

- K9
  - K92400-EU
    - ENGINE
      - CYLINDER BLOCK GROUP
      - OIL PAN GROUP
      - CYLINDER HEAD COVER GROUP
      - GEAR CASE GROUP
      - MAIN BEARING CASE GROUP
      - VALVE ROCKER ARM GROUP
      - CYLINDER HEAD COVER GROUP
      - CAMSHAFT GROUP
      - PISTON & CRANKSHAFT GROUP
      - NOZZLE HOLDER GROUP
      - FUEL CAMSHAFT GROUP
      - SPEED CONTROL LEVER GROUP
      - ENGINE STOP LEVER GROUP
      - GROUP GOVERNOR
      - WATER HOSE GROUP
      - DYNAMO GROUP
      - MANIFOLD GROUP
      - LABEL GROUP
    - FRONT AXLE
    - TRANSMISSION
    - CHASSIS
    - HYDRAULIC
    - ELECTRICAL
    - OPTION
  - K92440-EU
  - MEC
  - XS

Part Number	Description	Qty	Specs	Serial No
1-2	EC11-A0016A CYLINDER BLOCK ASSY v	1		
	06311-75015 PLUG	6	T1.6"18"18	
3	06311-75040 PLUG	2		
4	15321-9626-3 PLUG	12	T1.6"50"50	