

# KS SERIES CASTORS

MAX LOAD RATING  
**75KG**

## FEATURES

- » Stainless steel castor frames
- » 75Kg load per castor
- » Narrow double ball headrace
- » Fixed bolt hole castor available
- » Quality German manufacture by Blicke

## COMMON USES

- » Light furniture
- » Cabinets
- » Garment racks
- » Display units
- » Catering racks
- » Food preparation areas
- » Marine
- » Hospital

RIGID (BOLT HOLE)   SWIVEL (BOLT HOLE)   TOTAL LOCKING (BOLT HOLE)

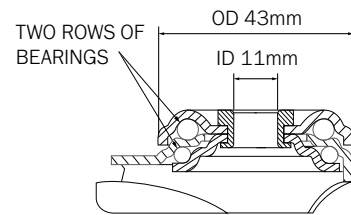

RIGID (PLATE)   SWIVEL (PLATE)   TOTAL LOCKING (PLATE)

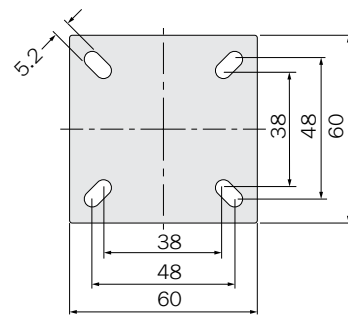

**NNP**

- » Solid virgin nylon 6 tread & centre
- » Plain bore & SS bushings



**TPB**

- » Thermoplastic elastomer tread
- » Polypropylene centre
- » Precision bearings
- » Sealed thread guard



WHEEL DIAMETER (mm)	MOUNTING TYPE	FRAME CODE	WHEEL ABR	MAX LOAD (KG)	WHEEL ABR	MAX LOAD (KG)	OVERALL HEIGHT (mm)	SWIVEL RADIUS (mm)
75		KSHR07525	-TPB(6)	75	-NNP(6)	75	98	-
75		KSH07525	-TPB(6)	75	-NNP(6)	75	98	67
75		KSHT07525	-TPB(6)	75	-NNP(6)	75	98	75
75		KSR07525	-TPB(6)	75	-NNP(6)	75	100	-
75		KSS07525	-TPB(6)	75	-NNP(6)	75	100	67
75		KSST07525	-TPB(6)	75	-NNP(6)	75	100	75

## WHEELS

WHEEL DIAMETER (mm)	TREAD WIDTH (mm)	WHEEL CODE	MAX LOAD (KG)	BORE DIAMETER (no spacer mm)	BORE DIAMETER (spacer mm)	HUB LENGTH (mm)	TREAD MATERIAL	CENTRE MATERIAL	BEARING TYPE	AXLE SPACER TYPE
75	25	TP07525SB(6)	75	6	-	31	THERMOPLASTIC ELASTOMER	POLYPROPYLENE	STAINLESS PRECISION BEARINGS	-
75	25	NN07525P(6)	75	8	6	29.5	NYLON	NYLON	PLAIN BORE	SS SPACER