

K Series 50–100 kg



Features

- Thermoplastic elastomer (TPE), grey rubber, hard nylon or polyurethane (PU) wheels
- Swivel, fixed plate and bolt hole zinc plated Core Coat™ forks with or without total brake
- Available with Chicago screw axles and alternate colourways
- Excellent corrosion resistance at three times the Australian Standard
- Made in Australia

Wheels



- | | | | |
|---|--|---|--|
| KJQ*
TPE, precision bearing, thread guard | KSA
Grey rubber, plain bearing, optional thread guard ¹ | KNN
Hard nylon, plain bearing | KUQ*
PU, precision bearing, optional thread guard ¹ |
|---|--|---|--|

Wheel	Max load (kg)	Diameter x tread (mm)	Hub x bore (mm)
KJQ65G	50	65 x 23	30 x 8
KJQ75G	50	75 x 23	30 x 8
KJQ100G	50	100 x 23	30 x 8
KSA65	50	65 x 23	30 x 12
KSA75	50	75 x 23	30 x 12
KSA100	50	100 x 23	30 x 12
KNN65	50	65 x 23	30 x 8
KNN75	65	75 x 23	30 x 8
KNN100	70	100 x 23	30 x 8
KUQ75	100	75 x 23	30 x 8
KUQ100	100	100 x 23	30 x 8

* Wheels also available with plain bearings—KJA, KUA.
 Note that plain bearing bore is 12 mm.
¹ For optional thread guards, add **G** at the end of wheel code.

Forks



- | | | | | |
|---------------------------------|---|--------------------------------------|--------------------------------|--|
| KZP
Plate with swivel | KZPTB
Plate with swivel and total brake | KZF
Fixed plate, no swivel | KZH
Bolt hole swivel | KZHTB
Bolt hole swivel and total brake |
|---------------------------------|---|--------------------------------------|--------------------------------|--|

Fork	Wheel size (mm)	Mount height (mm)	Turning radius (mm)
KZP/KZH/KZF ²	65	96	63
	75	104	69
	100	131	82
KZPTB/KZHTB	65	96	89
	75	104	89
	100	131	89

Fork mounts

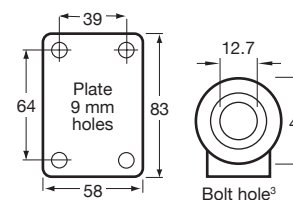

² KZF—fixed plate has no turning radius.
³ Bushes available to reduce bolt hole to 8 and 10 mm.
 Grip-neck pintles also available (see page 64).

Colourway and axle options

Colourways



Standard

Default castor colourway

Red

Add **R** to castor code

Example:
KJQ65G/KZPTBR

Grey

Add **G** to castor code

Example:
KJQ65G/KZPTBG

Chicago screw axle (optional)



To upgrade to a Chicago screw axle, add **C** to the end of castor code (after any colourway options)

Example:
KJQ65G/KZPTBRC

Order codes

Wheel	Fork	Castor	Wheel	Fork	Castor
KJQ65G	K65ZP	KJQ65G/KZP	KNN65	K65ZP	KNN65/KZP
	K65ZPTB	KJQ65G/KZPTB		K65ZPTB	KNN65/KZPTB
	K65ZF	KJQ65G/KZF		K65ZF	KNN65/KZF
	K65ZH	KJQ65G/KZH		K65ZH	KNN65/KZH
	K65ZHTB	KJQ65G/KZHTB		K65ZHTB	KNN65/KZHTB
KJQ75G	K75ZP	KJQ75G/KZP	KNN75	K75ZP	KNN75/KZP
	K75ZPTB	KJQ75G/KZPTB		K75ZPTB	KNN75/KZPTB
	K75ZF	KJQ75G/KZF		K75ZF	KNN75/KZF
	K75ZH	KJQ75G/KZH		K75ZH	KNN75/KZH
	K75ZHTB	KJQ75G/KZHTB		K75ZHTB	KNN75/KZHTB
KJQ100G	K100ZP	KJQ100G/KZP	KNN100	K100ZP	KNN100/KZP
	K100ZPTB	KJQ100G/KZPTB		K100ZPTB	KNN100/KZPTB
	K100ZF	KJQ100G/KZF		K100ZF	KNN100/KZF
	K100ZH	KJQ100G/KZH		K100ZH	KNN100/KZH
	K100ZHTB	KJQ100G/KZHTB		K100ZHTB	KNN100/KZHTB
KSA65	K65ZP	KSA65/KZP	KUQ75	K75ZP	KUQ75/KZP
	K65ZPTB	KSA65/KZPTB		K75ZPTB	KUQ75/KZPTB
	K65ZF	KSA65/KZF		K75ZF	KUQ75/KZF
	K65ZH	KSA65/KZH		K75ZH	KUQ75/KZH
	K65ZHTB	KSA65/KZHTB		K75ZHTB	KUQ75/KZHTB
KSA75	K75ZP	KSA75/KZP	KUQ100	K100ZP	KUQ100/KZP
	K75ZPTB	KSA75/KZPTB		K100ZPTB	KUQ100/KZPTB
	K75ZF	KSA75/KZF		K100ZF	KUQ100/KZF
	K75ZH	KSA75/KZH		K100ZH	KUQ100/KZH
	K75ZHTB	KSA75/KZHTB		K100ZHTB	KUQ100/KZHTB
KSA100	K100ZP	KSA100/KZP			
	K100ZPTB	KSA100/KZPTB			
	K100ZF	KSA100/KZF			
	K100ZH	KSA100/KZH			
	K100ZHTB	KSA100/KZHTB			