



Vertical Adapter Assembly Instructions

Step 1) Confirm that you have the six main parts; the front plate, the back plate, the two side plates, and the two sheet metal screws.

Step 2) Attach one of the side plates into the back plate by inserting the male button lock on the side plate into the female button lock on the back plate.

Step 3) Repeat Step 2 with the other side plate.

Step 4) Line up the front plate with the two connected side plates.

Step 5) Connect the front plate evenly on both sides and then drill the sheet metal screw through one side of the front plate into the corresponding side plate.

Step 6) Repeat Step 5 on the other side.

Step 7) You should now have a completed Vertical Adapter with all four pieces attached and two screws drilled in.

Complete all steps as instructed and illustrated. QuietCool is not liable for misassembled Vertical Adapters

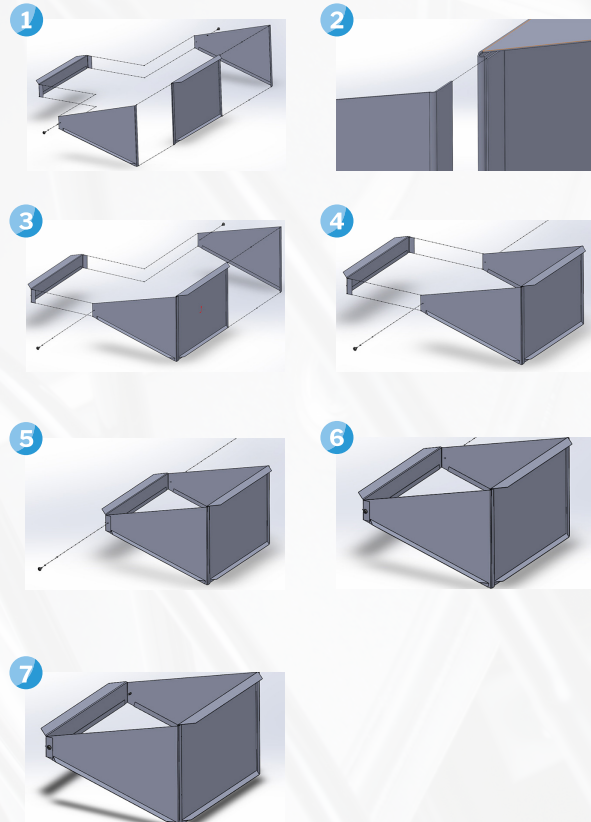

Vertical Adapter Installation Instructions

The vertical adapter is essentially an extension of the damper box included with your QuietCool whole house fan. Installation procedures for the vertical adapter deviate from the instructions of a whole house fan in two primary ways: attaching the vertical adapter to the damper box and attaching the ceiling grille to the vertical adapter.

- 1** Before starting installation, note that the vertical adapter has a top and a bottom, a wall facing side (four flanges), and a damper box facing side (two flanges).

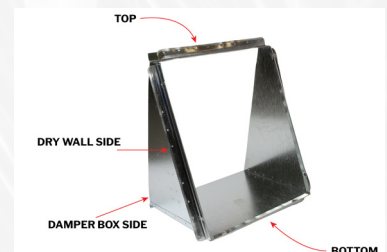

2 Preparation

If your studs are 16" on center, you will need to remove the side flanges on your vertical adapter and damper box prior to installation. This is accomplished by using a flat head screwdriver to gently pry the flanges off.

If your studs are 24" on center then remove one side of the flange on the vertical adapter. Then remove one flange on the same corresponding side of the damper box.



3 Attaching The Damper Box To The Vertical Adapter

1. To attach the damper box to the vertical adapter, ensure that the flanges on the damper box align with the flanges on the damper box side of the vertical adapter.

2. Using the included black sheet metal screws, attach the damper box to the vertical adapter by driving 2 screws through the flanges on both sides of the damper box/vertical adapter assembly.



4 Securing Vertical Adapter

1. Insert the Vertical adapter into the cutout in the drywall and secure in place. If your studs are 16" on center, you would have removed both flanges on the vertical adapter and damper box. From inside the vertical adapter, screw through the vertical adapter using the provided screws in the fan box. Be sure your screw alignment is such that when it penetrates the metal vertical adapter it then screws into the wood of the stud. Be sure to do this on both of the wood facing sides.

2. If your studs are 24" on center, you would have removed one flange from one side of the vertical adapter and damper box. The side with the removed flanges is now up against a wood stud. On this side secure the damper box by screwing through the metal of the vertical adapter into the wood of the stud. On the other side, of the vertical adapter that has the flanges still in place, screw through the drywall into the flange of the vertical adapter.



5 Attaching the Ceiling Grille to the Vertical Adapter

1. Remove the grate from the ceiling grille and insert the frame into the cut-out hole for the vertical adapter.

2. Using the included white screws, secure the ceiling grille frame by driving the screws through the four provided holes on the front of the ceiling grille frame.

WARNING Be careful not to overtighten these four screws as they can deform the frame, causing an improper fit for the grate.

3. Snap the grate back into the frame and make sure the grate is snapped in tight. If it is loose, you may have overtightened the screws into the frame.

