



Est. 1938

Direct Drive Centrifugal Roof/Wall Exhauster

Models PDURF and PDURG Restaurant Exhauster



Centrifugal Exhausters

Models PDURF and PDURG (restaurant exhauster) are direct drive upblast centrifugal exhausters. Capacities up to 5,317 CFM and up to 1 1/4 inch static pressure. The PDURF is a clean air ventilator designed for high velocity vertical discharge. Model PDURG is ideally suited for removal of grease laden exhaust found in restaurant and commercial kitchen applications. Other applications include a wide range of commercial, industrial, and institutional facilities such as schools, hospitals, prisons, and assembly areas.

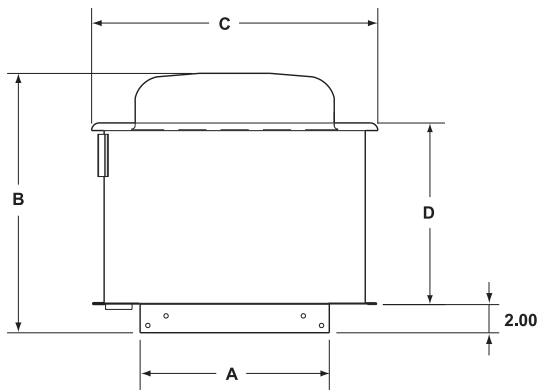

DIMENSIONS

Fan Model	A	B	C	D	Roof Opening * ‡	Est. Unit Wt.	Est. Ship Wt.	Damper Model	Roof Curb ‡	
									RF	RG
PDU080	13.50	13.06	20.63	12.84	9 x 9	23	36	AR8.75	C12	CR12
PDU100	13.50	16.10	20.63	12.84	9 x 9	30	43	AR8.75	C12	CR12
PDU110	13.50	16.41	20.63	12.84	9 x 9	30	43	AR8.75	C12	CR12
PDU120	19.00	19.48	26.41	16.59	14.5 x 14.5	50	72	AR14	C17.5	CR17.5
PDU135	19.00	20.87	26.41	16.59	14.5 x 14.5	50	72	AR14	C17.5	CR17.5
PDU150	24.00	23.89	30.16	21.92	19.5 x 19.5	76	102	AR18	C22.5	CR22.5
PDU165	24.00	23.89	30.16	21.92	19.5 x 19.5	76	102	AR18	C22.5	CR22.5
PDU185	28.00	25.75	34.65	21.99	23.5 x 23.5	94	179	AR22	C26.5	CR26.5
PDU200	28.00	25.75	34.65	21.99	23.5 x 23.5	94	179	AR22	C26.5	CR26.5

Dimensions are shown in inches.

Weights are shown in pounds.

*Recommended maximum.

‡ Please contact your local representative for correct rated sizing for hurricane construction

Construction Features

Housing

- Windband constructed of heavy gauge aluminum with rolled bead for strength
- Sealed windband perimeter to prevent leakage
- Quick release latches allow easy removal of motor compartment cover without special tools
- Heavy gauge galvanized wire birdscreen (PDURF only)
- Aluminum curb cap

Centrifugal Wheel

- Aluminum construction backward curved blade
- Non-overloading design for safe operation
- Wheel optimally matched with die-formed orifice
- Precision balanced for smooth vibration free operation



Motors

- Continuous duty motors with sealed ball bearings located outside the airstream
- Large breather tube directs outside air into the motor compartment resulting in maximum life
- Motor compartment cooled by fins located on top of impeller

Options/Accessories

- Roof Curbs
- Dampers
- Coatings
- Wall Bracket (PDU080-200)
- Birdscreen (PDURG)
- Grease Trough
- Curb Hinge



Acme Engineering & Manufacturing Corporation certifies that the models shown herein are licensed to bear the AMCA seal. The ratings shown are based on tests and procedures performed in accordance with AMCA Publication 211 and AMCA Publication 311 and comply with the requirements of the AMCA Certified Ratings Program.



Model PDURF is Listed for Electrical (UL/C-UL 705) File No. E39982.
Model PDURG is Listed for (UL 762) File No. MH11542.

Consult your Acme representative for availability.

PERFORMANCE DATA																							
Fan Model	Motor		CFM and Sones vs. Static Pressure																		Max. BHP		
	HP	RPM	.000"		.125"		.250"		.375"		.500"		.625"		.750"		1.000"		1.250"				
			CFM	Sone	CFM	Sone	CFM	Sone	CFM	Sone	CFM	Sone	CFM	Sone	CFM	Sone	CFM	Sone	CFM	Sone			
PDU080	1/10	1600	385	9.7	368	9.5	350	9.2	323	8.8	253	8.5									.040		
		1300	313	7.4	292	7.7	261	11.0														.020	
PDU100	1/10	1630	850	12.0	788	11.8	735	11.3	681	10.6	625	9.6	573	8.9							.085		
		1300	678	8.3	604	7.8	537	7.5	468	6.9												.042	
PDU110	1/10	1550	1017	10.1	951	10.2	885	10.6	816	9.6	731	9.5	617	9.5	506	9.5					.098		
		1300	853	8.1	774	8.3	693	7.6	588	7.5	454	7.5	270	7.5								.057	
		1050	689	6.0	591	6.2	468	5.5	292	5.5												.030	
		860	564	4.5	441	4.2	243	4.2															.016
PDU120E4	1/4	1680	1753	13.8	1689	13.7	1611	13.6	1522	13.6	1433	13.5	1295	13.2	1155	13.1					.250		
		1550	1617	13.5	1548	13.5	1457	13.1	1361	12.7	1233	12.4	1082	12.0								.200	
		1300	1356	10.8	1269	9.9	1154	9.5	1001	9.6												.110	
		1160	1210	9.0	1106	8.8	972	8.7	770	8.2													.080
		860	897	5.3	742	5.3																	.030
PDU135F6	1/3	1160	1840	11.9	1718	11.6	1597	11.1	1470	11.0	1311	10.6									.164		
		1050	1665	10.5	1531	10.0	1397	9.7	1242	9.4												.122	
		860	1364	8.5	1201	8.1	1020	7.6														.067	
PDU135G4	1/2	1725	2736	20	2654	19.2	2572	19.2	2491	19.0	2410	18.5	2328	18.4	2243	18.3	2052	18.1	1782	17.5	.540		
		1550	2458	17.6	2367	17.1	2276	16.9	2186	16.5	2095	16.2	2000	16.1	1897	16.0	1614	15.0				.392	
		1300	2062	14.0	1953	13.6	1845	13.1	1737	12.9	1619	12.7	1473	12.0								.231	
		1050	1665	10.5	1531	10.0	1397	9.7	1242	9.4												.122	
		860	1364	8.5	1201	8.1	1020	7.6															.067
PDU150F6	1/3	1160	2230	11.6	2073	10.9	1911	9.9	1748	10.0	1583	9.5	1353	8.9							.220		
		860	1652	8.0	1439	8.4	1218	8.5	909	7.9												.090	
PDU165G6	1/2	1160	3242	18.2	3087	18.5	2934	18.1	2781	17.0	2621	16.2	2439	16.1	2194	15.2	1692	15.9			.500		
		1050	2935	15.9	2764	16.3	2595	16.0	2421	14.9	2227	13.7	1962	13.4	1680	13.8						.373	
		860	2404	11.9	2196	12.4	1986	10.7	1725	10.6	1385	10.2										.205	
PDU185G6	1/2	1160	4340	15.0	4193	15.0	4047	14.5	3900	14.0	3751	13.3	3602	12.6	3426	12.7					.600		
PDU200J6	1	1160	5317	19.5	5155	18.2	4994	17.8	4830	17.8	4657	17.0	4483	17.0	4305	16.8	3898	16.1	3415	15.4	1.215		

Performance certified is for Installation Type A: Free Inlet, Free Outlet. Performance ratings do not include the effects of appurtenances (accessories). The sound ratings shown are loudness values in hemispherical sones at 1.5 m (5ft) in a hemispherical free field calculated per AMCA Standard 301. Values shown are for Installation Type A: Free Inlet hemispherical sone levels. The brake horsepower capability of an exhauster motor is dependent on the degree of cooling the motor receives from the air moving through the motor. The motor loading beyond the motor nameplate rating does not overheat the motor and is in accordance with the motor manufacturer's recommendations. It is therefore not detrimental to the motor and is economically desirable. Maximum RPM shown obtained with the standard one speed motor, for all other RPM's use solid state controller.

For more information on this product contact your sales support.

