

Blowers

MODEL NADB – CAST ALUMINUM VOLUME BLOWER – DIRECT DRIVE



APPLICATION

Designed for use in situations where low volumes of air flow are required at relatively low static pressures. Excellent for removal of welding smoke and fumes and for spot cooling of electronic equipment.

FEATURES AND BENEFITS

- Cast aluminum spark resistant housings.
- Forward curved squirrel cage type steel wheels provide efficient, quiet performance.
- Round outlets and inlets facilitate connection to standard pipe and duct diameters with slip fit connections or flange to flange.
- Only available in clockwise rotation with four discharge positions available.
- Standard construction meets AMCA Type C spark resistant requirements.
- Suitable for use in airstreams to a maximum of 150°F.

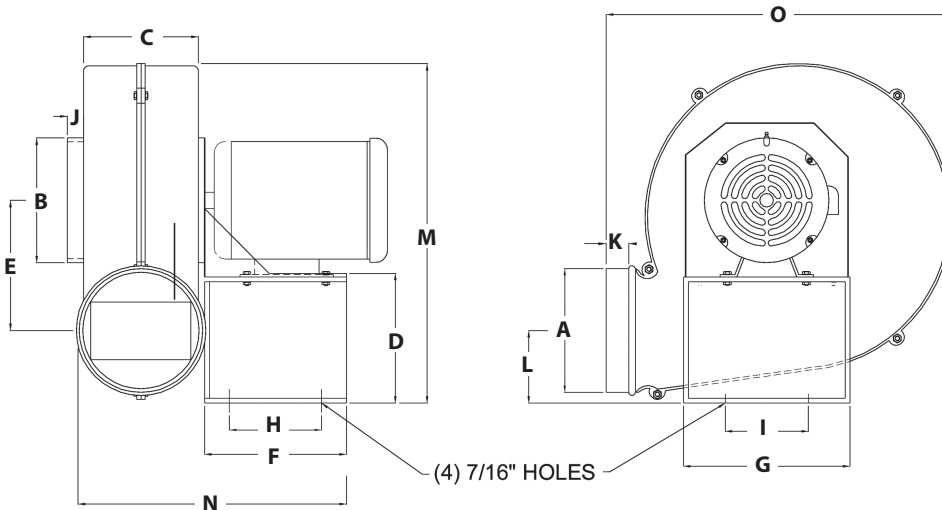

OPTIONAL ACCESSORIES

- Cast aluminum inlet or outlet flanges
- Slide gate dampers for inlet or outlet
- Motor weather cover for outdoor service
- Inlet filters
- Inlet and outlet guards

DIMENSIONS **subject to change without notice*

MODEL	A	B	C	D	E	F	G	H	I	J	K	L	M	N	O
NADB4	4"	4 7/8"	4"	5"	2 3/4"	7"	6 7/8"	4 5/16"	4 1/4"	15/16"	15/16"	5 3/4"	12 1/2"	13 1/8"	9 1/8"
NADB6	6"	5 7/8"	4 5/8"	5"	4 1/4"	7"	6 7/8"	4 5/16"	4 1/4"	1 1/16"	7/8"	4 1/4"	13 1/2"	14 1/4"	11 3/4"
NADB8	7 7/8"	7 13/16"	5 3/4"	7 15/16"	5 3/8"	8 1/2"	8 3/8"	6 1/2"	6 1/2"	1 1/8"	15/16"	5 5/8"	17 7/8"	16 5/8"	14"



MODEL NADB – CAST ALUMINUM VOLUME BLOWER – DIRECT DRIVE

PERFORMANCE DATA

MODEL	WHEEL DIA.	RPM	CAPACITY C.F.M.																			
			1/4" SP		1/2" SP		3/4" SP		1" SP		1-1/2" SP		2" SP		2-1/2" SP		3" SP		3-1/2" SP		4" SP	
			CFM & BHP	CFM & BHP	CFM & BHP	CFM & BHP	CFM & BHP	CFM & BHP	CFM & BHP	CFM & BHP	CFM & BHP	CFM & BHP	CFM & BHP	CFM & BHP	CFM & BHP	CFM & BHP	CFM & BHP	CFM & BHP	CFM & BHP	CFM & BHP	CFM & BHP	
NADB4	4-3/4"	1725	210 .035	135 .023	—	—	—	—	—	—	—	—	—	—	—	—	—	—	—	—	—	—
NHADB4	4-3/4"	3450	500 .38	470 .34	440 .32	420 .30	360 .26	260 .16	—	—	—	—	—	—	—	—	—	—	—	—	—	—
NLADB6	6-1/4"	1140	248 .06	96 .02	—	—	—	—	—	—	—	—	—	—	—	—	—	—	—	—	—	—
NADB6	6-1/4"	1725	440 .18	370 .14	300 .11	—	—	—	—	—	—	—	—	—	—	—	—	—	—	—	—	—
NHADB6	6-1/4"	3450	900 1.45	870 1.40	850 1.35	820 1.30	780 1.20	730 1.15	660 1.00	580 .90	470 .80	390 .70	—	—	—	—	—	—	—	—	—	—
NLADB8	8-1/2"	1140	860 .26	720 .18	600 .15	—	—	—	—	—	—	—	—	—	—	—	—	—	—	—	—	—
NADB8	8-1/2"	1725	1550 1.15	1500 1.05	1490 1.00	1400 .90	1200 .85	950 .70	—	—	—	—	—	—	—	—	—	—	—	—	—	—

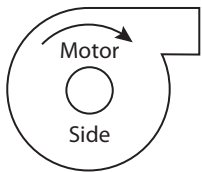

Clockwise Top
Horizontal
Discharge

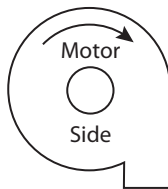

Clockwise
Down-Blast
Discharge

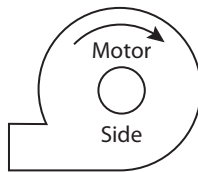

Clockwise Bottom
Horizontal
Discharge

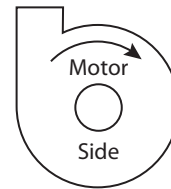

Clockwise
Up-Blast
Discharge

MODEL NUMBER SCHEMATIC

