

J&D Manufacturing

PORTABLE COOLING UNIT



WARRANTY

J&D Manufacturing warrants all products are free from defects in materials and workmanship under normal use for the period of one year from date of purchase. Our warranty does not cover normal or regular wear and tear. J&D Manufacturing can repair or replace at our option, any product or part of the product that is found to be defective. Our warranty applies to materials only, and does not include return freight, delivery, loss or damage to personal property, cost of removal or installation, any incidental or consequential damages or labor. This warranty does not apply to products which are misused, abused, altered, improperly installed or subject to negligence. All warranties must be approved through our warranty department. The original purchaser must present a copy of the invoice for the defective product. One year is our standard warranty unless specified on our literature or in the installation instructions or user manuals.

INSTALLATION

Please read over all setup, operating, storage, transporting, and maintenance instructions carefully before you begin. If you have any questions please call your local dealer, or contact J&D Manufacturing at 1-800-998-2398.

PARTS LEGEND

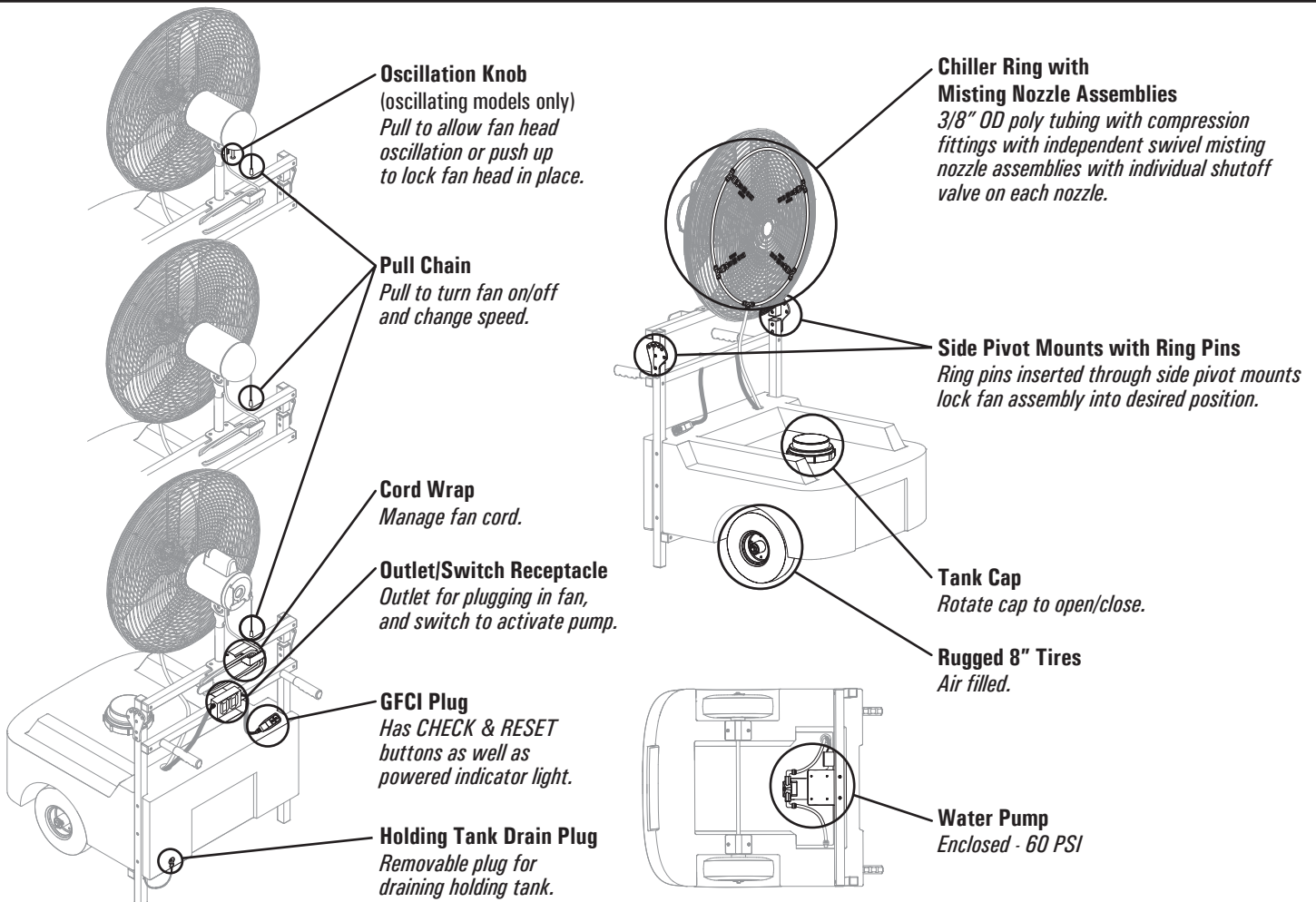

SETUP

Unpack unit from packing material.

While supporting fan and misting assembly remove ring pin from side pivot mount on each side of unit. Swing fan and misting assembly to the vertical position and reinsert the ring pin into the side pivot mount on each side to lock into place.

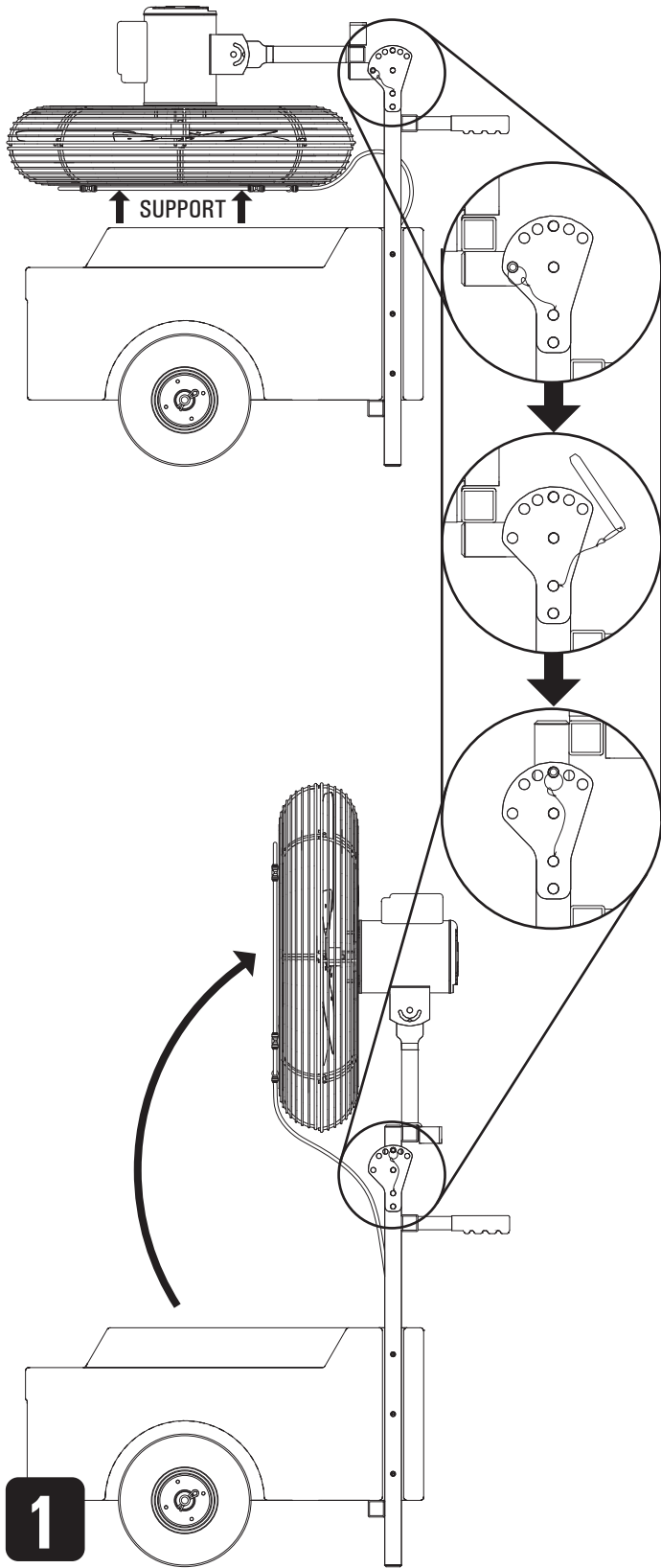

Reset all compression fittings that may have come loose during shipment by gripping the tubing and pushing it firmly into the fitting. It is recommended to hand check all of the tubing compression fittings by gripping tubing and push tube firmly into fitting.

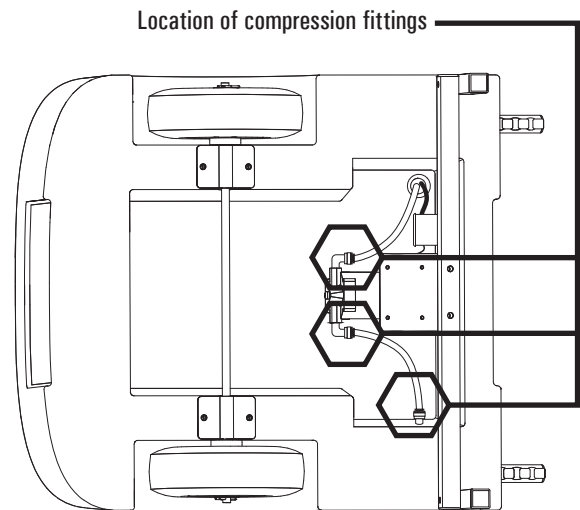
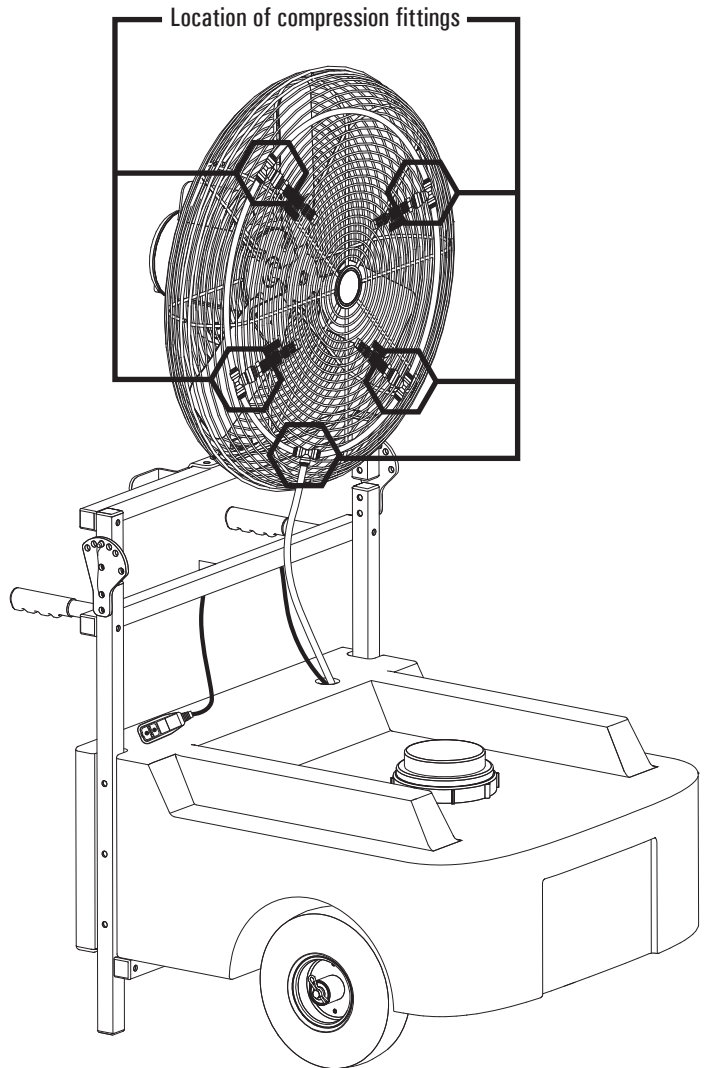

Flush holding tank to remove any debris that might have entered the holding tank.

Unscrew and remove tank cap. Remove holding tank drain plug by lifting lever on plug and pulling out.

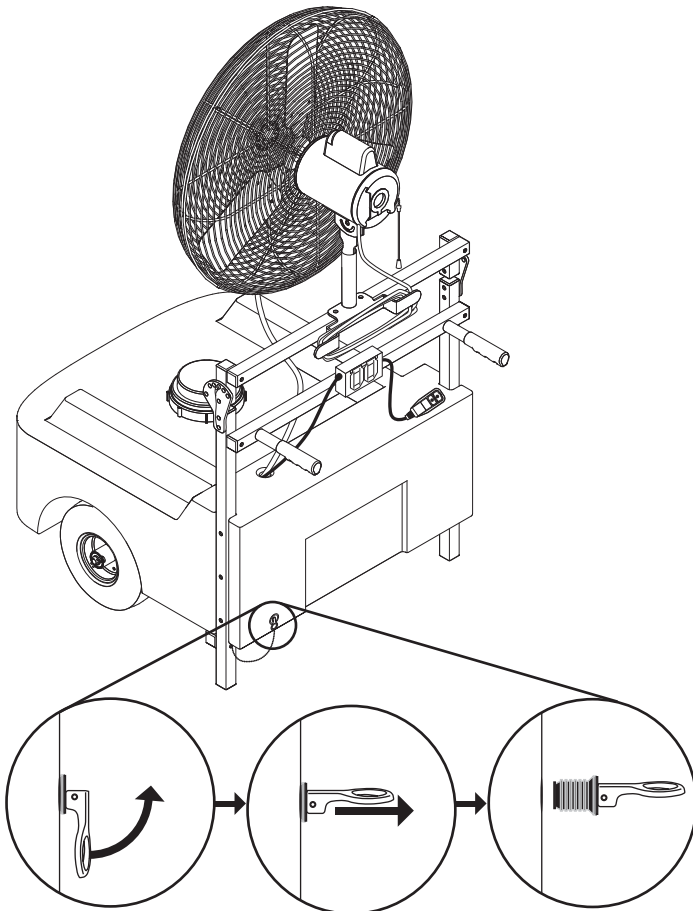
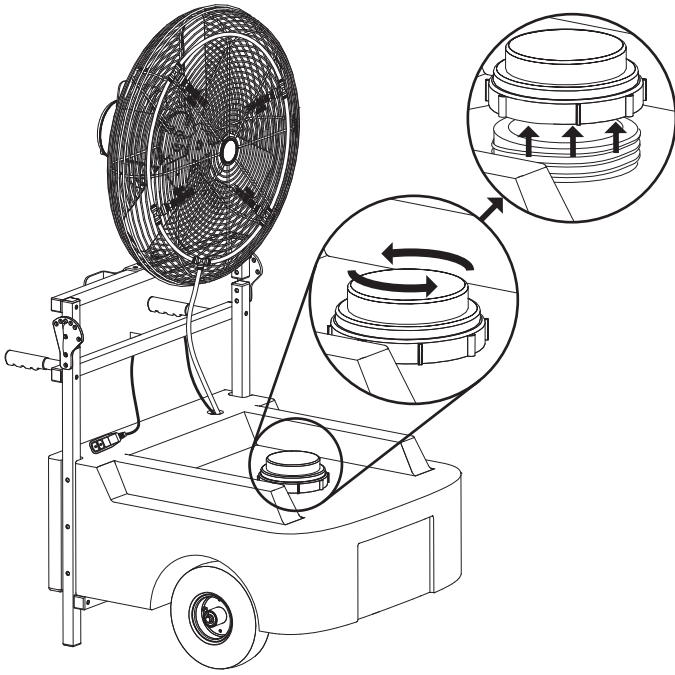

3

Note: Use only clean fresh water to rinse and fill tank.

Insert hose into tank opening and rotate water stream around entire interior of holding tank, letting the water flush debris out the drain hole. You may want to tilt unit towards drain hole to assist in flushing, and to prevent debris from settling on the bottom of the tank.

Visually check interior of tank for any remaining debris. Once tank is free from debris, reinsert drain plug and secure by flipping lever parallel with tank.

Begin filling tank. If water is leaking from the drain plug area, flip drain plug lever up (do not remove plug), and rotate drain plug lever clockwise 1/2 turn. Flip lever parallel with tank. Repeat as necessary until no water leaks from drain plug. Continue filling tank. Replace and hand tighten tank cap.

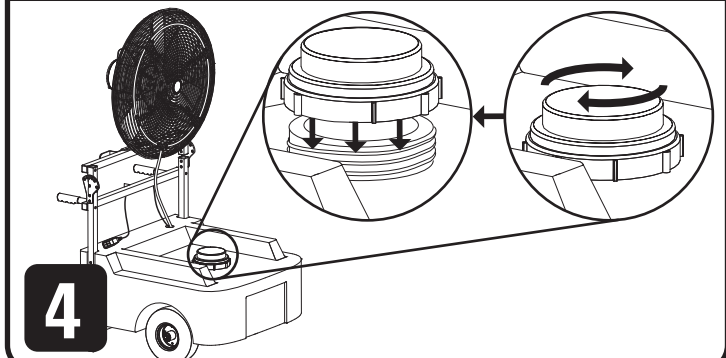
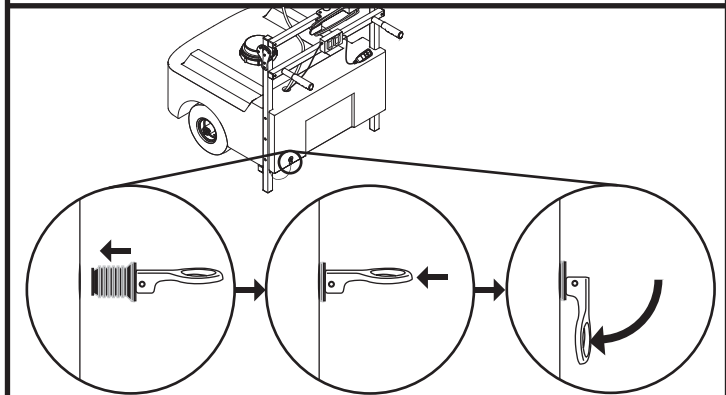
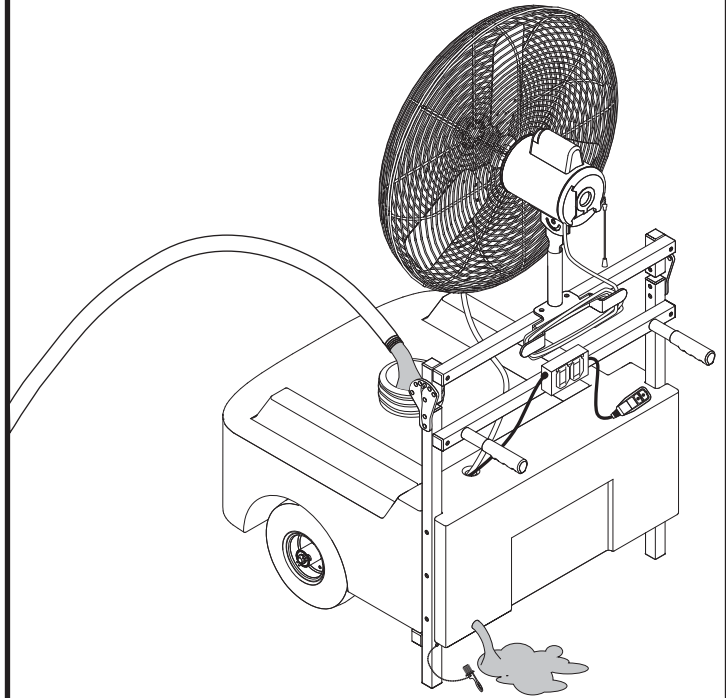

4

Swivel nozzle assemblies so they are at 90° to fan face. Open all nozzles as shown below.

NOTE: It is required that all nozzles be open prior to and during pump start-up to prevent an air lock. Further nozzle adjustment is permitted once unit is running.

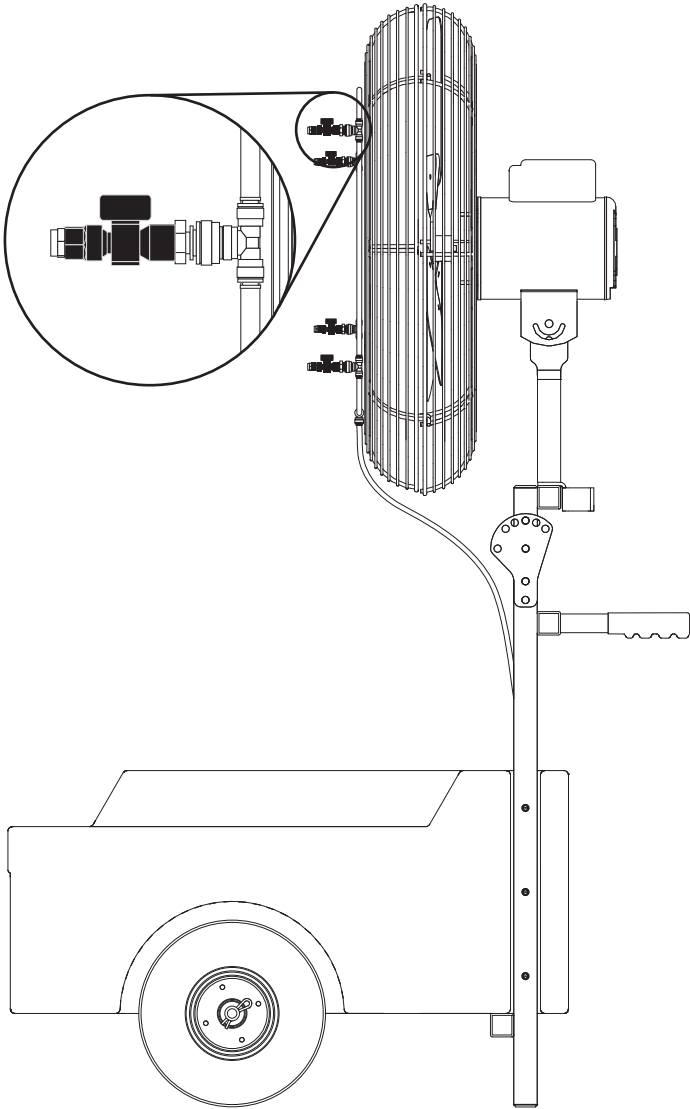

Plug fan into outlet of receptacle box as shown.

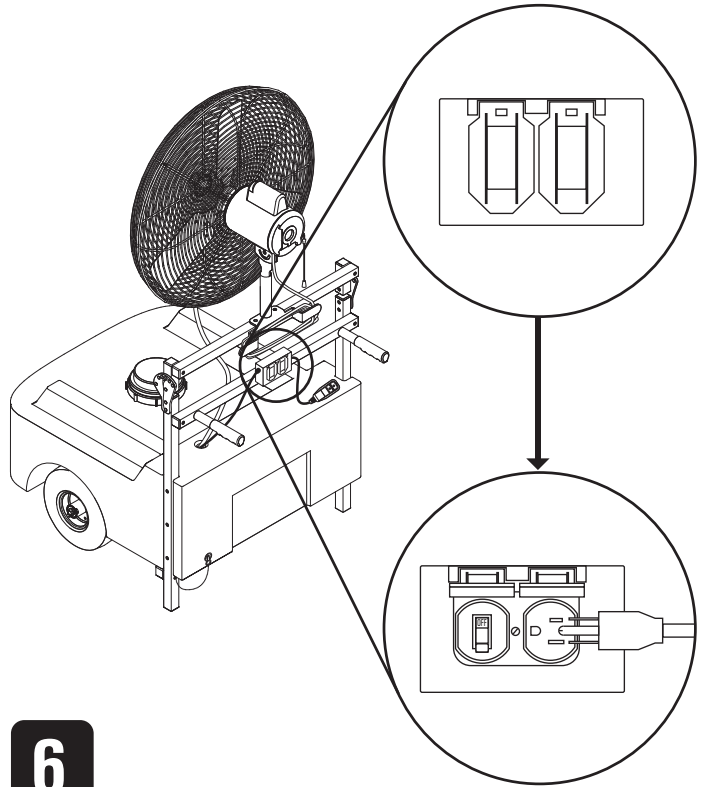

Plug GFCI plug into approved outlet.

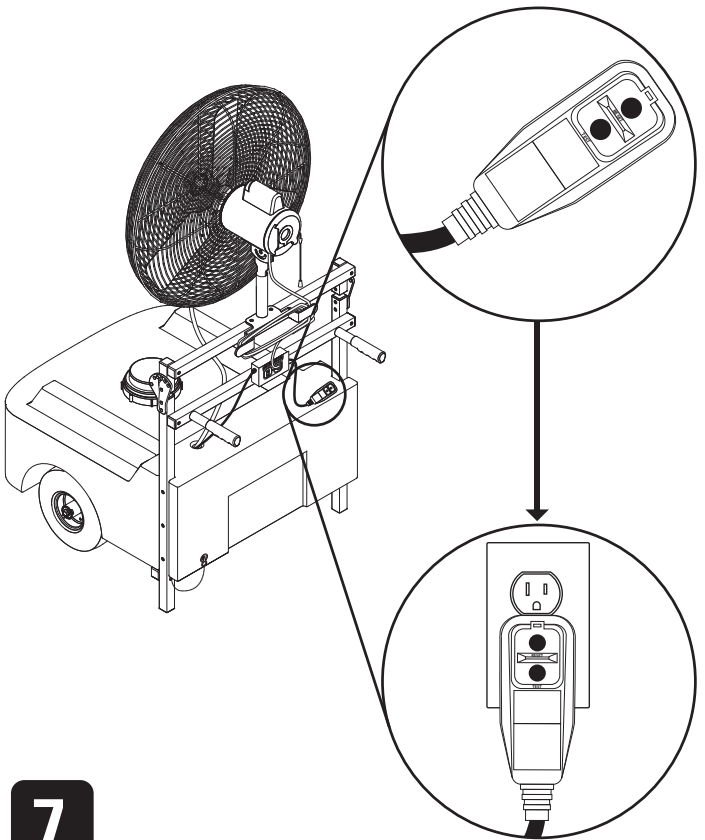

OPERATION



CAUTION



- Never run pump dry. Doing so will void the warranty.
- All nozzles must be in the open position before starting pump to prevent air lock.
- Any horizontal or vertical obstructions located too close to fan head and nozzles will quickly be covered with condensation, and may begin to drip.
This can cause a reduction in cooling efficiency, and may also create a safety hazard.

Pull fan chain to turn fan on to desired speed prior to turning on pump.

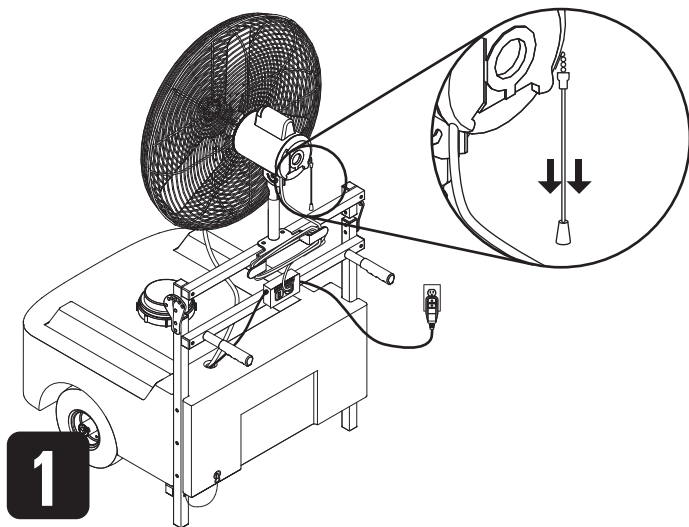

Turn on pump by flipping switch on receptacle.

It will take a minute or two for the self priming pump to fill and express all the air from the pump and the tubing.

NOTE: You will hear the pump pulsate occasionally to release pressure. This is normal.

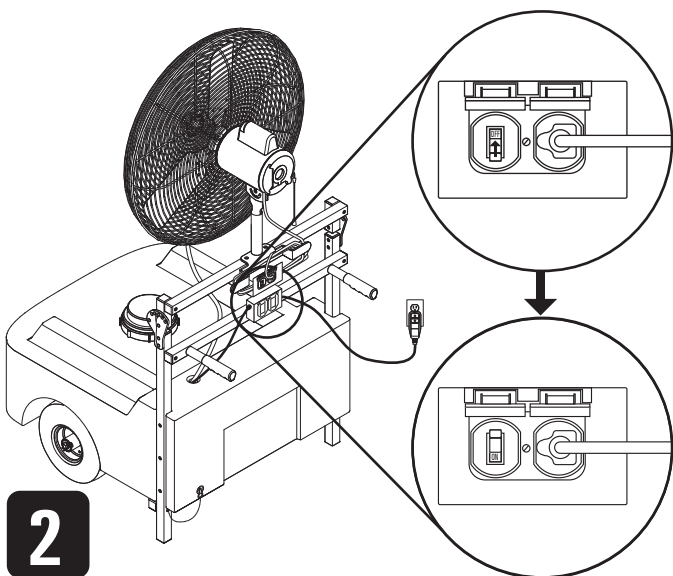

Adjust water spray and air flow for efficient and affective cooling.

Adjust the fan to your preferred air speed and angle. Fan head must be at an angle of 90° or greater. Do not angle downward.

With pump running, close all but one of the nozzles and start opening the remaining nozzles one at a time.

Observe. If droplets start collecting on the ground in front of the unit, reduce the number of open nozzles. Ideally you want all the water to evaporate before it gets a chance to dissipate out and collect on the ground. The amount of water that you can evaporate to cool the air is dependant on the temperature of the air and the humidity.

3

OPTIONAL: Oscillating models

Oscillation feature on applicable models is engaged by pulling down on oscillation knob, or disengaged by pushing knob up to lock fan head into place.

Oscillation feature should only be used when fan is in the 90° vertical position. Using the oscillation feature in a tilted position may cause the fan to bump and skip which can eventually lead to failure.

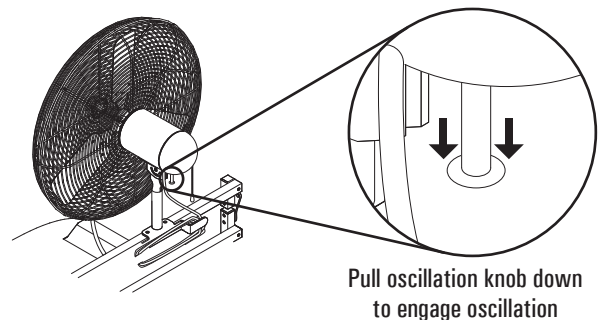

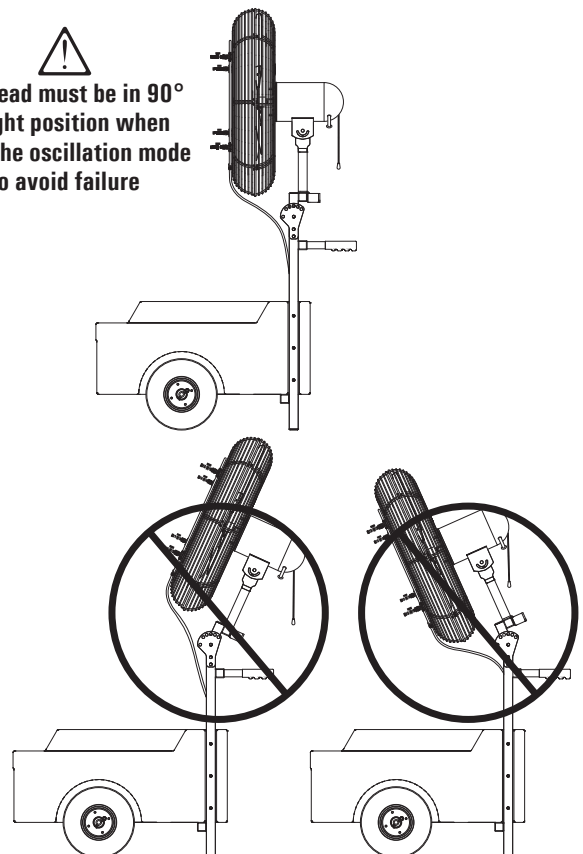

Fan head must be in 90° upright position when using the oscillation mode to avoid failure

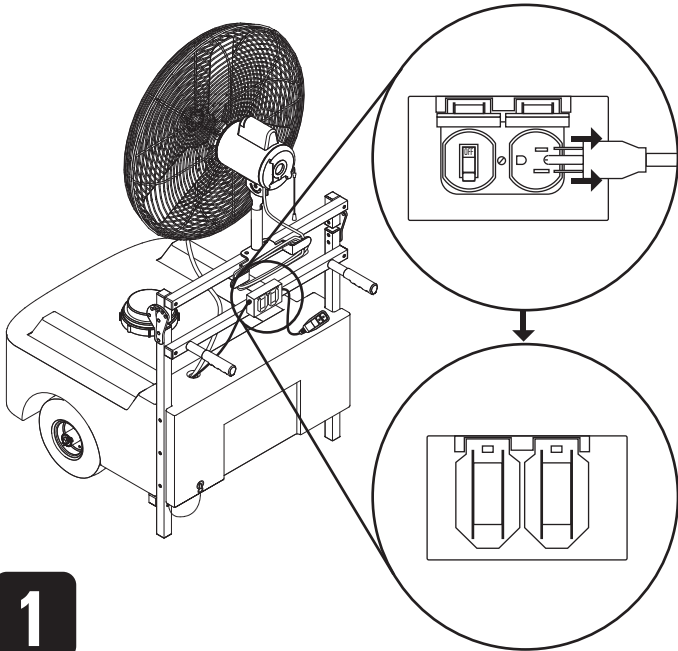

STORAGE & TRANSPORTATION

Unplug fan from outlet of receptacle box as shown.



1

Swivel nozzle assemblies so they lay flat against fan face.

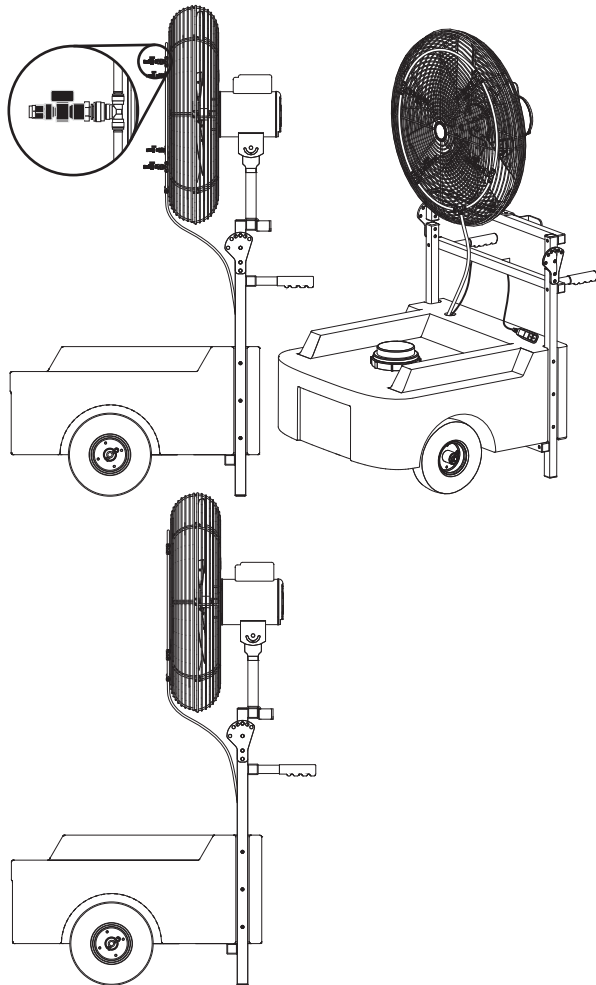

2

While supporting fan and misting assembly remove ring pin from side pivot mount on each side of unit. Swing fan and misting assembly to the horizontal position and reinsert the ring pin into the side pivot mount on each side to lock into place.

Do not allow fan head to bang or rest against tank.

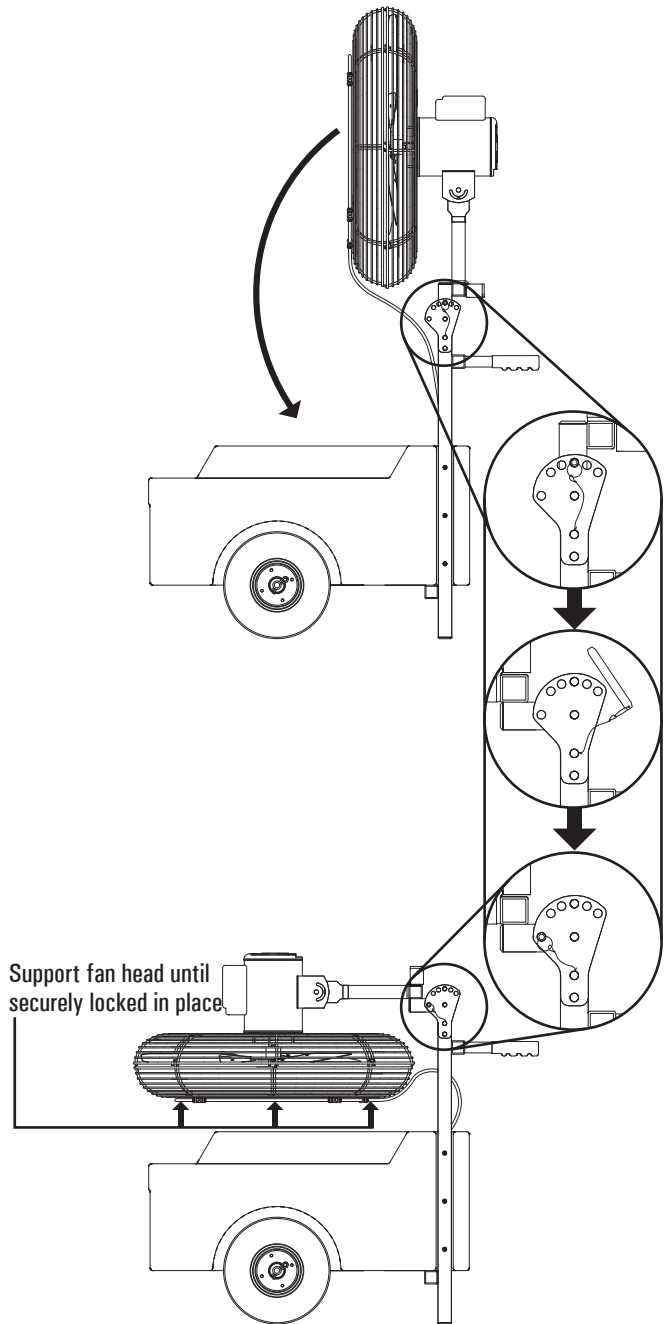

3

TROUBLE SHOOTING

Water leaking around fittings.

Shipping/transporting can cause compression fittings to loosen. Unplug unit from electrical source. Grip tubing and push tube firmly into fittings. Refer to SETUP Step 2 for location of compression fittings.

Water leaking from tank around drain plug.

Drain plug is adjustable. Unplug unit from electrical source. Flip drain plug lever up (do not remove plug), and rotate drain plug lever clockwise 1/2 turn. Flip lever parallel with tank. Repeat as necessary until no water leaks.

No spray coming out of nozzles.

Check to see if holding tank is out of water. If empty, **TURN PUMP OFF IMMEDIATELY!** Running pump without water will ruin pump motor.

Check that nozzles are in the open position. Refer to SETUP Step 5.

Unit was started without nozzles open, creating an air lock. Release air lock by temporarily detaching one end of the top tubing from the fittings. Push down compression fitting collar and pull out tube end as shown below. Using container to catch water, turn pump on until water streams out of disconnected tubing. Shut off pump. Reconnect tubing. Check that all water nozzles are open, and restart pump. Nozzles should now spray.

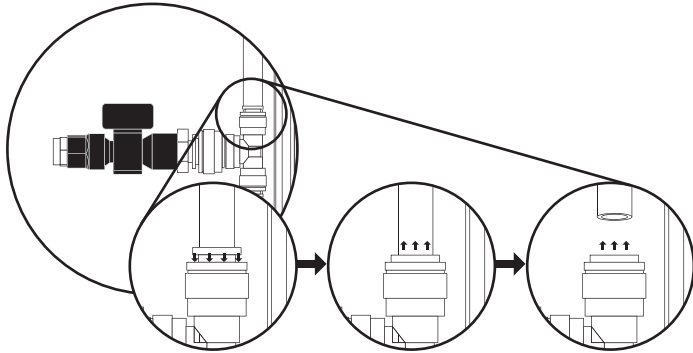

Nozzles may be plugged with mineral deposits or other debris. Remove nozzles using 1/2" & 9/16" wrenches. Observe back side of nozzle for debris accumulation on screen mesh surface. Carefully wipe or brush off mesh. If contamination does not easily wipe off the screen mesh, soak nozzle in cleaner for removing hard water deposits (example CLR). Make sure to follow all safety and warnings on label of product. Rinse thoroughly with clean water. If nozzle and screen cannot be effectively cleaned, replace with a new 0.5 GPH nozzle, J&D part # SS418W.

Replacing the SS418W 0.5 GPH nozzle.

Apply 2-3 wraps of Teflon tape clockwise around nozzle threads, making sure that edge of tape does not hang over nozzle opening which would impede the water flow.

Screw nozzle into assembly using a 1/2" & 9/16" wrench to snug nozzle to assembly. Do not over tighten.

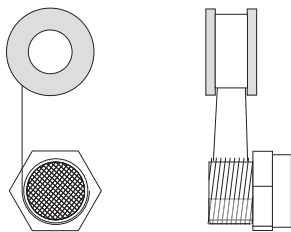

Pump making pulsing noise.

You will hear the pump pulsate occasionally to release pressure. This is normal.

When oscillation option is engaged on applicable models, rotation is jerky, gets stuck in one position, or does not travel at full range.

Inspect oscillation knob to make sure it is fully engaged in the oscillation mode by pulling knob down.

Fan head must be in 90° upright position as shown in OPERATIONS Step 4. Unit must be on relatively flat surface.

Check to make sure that electrical cord and water tubing for fan has enough slack to allow for movement of fan head.

FREEZE WARNING

Any damage caused by allowing unit to freeze is not covered by warranty, regardless of precautions taken.

The following recommendations are only to be consulted when no other storage options remain and are strictly at your own risk.





Winterizing:

- 1.) Remove drain plug. Drain all free standing water and replace plug.
- 2.) Mix one gallon of RV antifreeze to one gallon of water and pour into tank. Do NOT use automotive grade antifreeze.
- 3.) Run pump for ten minutes to purge pump and nozzles with the RV antifreeze mix. All internal pump and nozzle parts must be free of water.
Water expands when frozen and will cause damage to the pump parts and nozzles.
- 4.) The unit is now considered winterized.

De-winterizing:

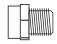
- 1.) Remove drain plug. Drain antifreeze mix into container to properly dispose. Replace plug.
- 2.) Fill unit with fresh water.
- 3.) Run pump for ten minutes to purge pump and nozzles of the RV antifreeze mix.
- 4.) Unit is now ready to use.

NOZZLE REPLACEMENT PARTS

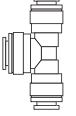
 Mist Nozzle 0.5 GPH	 Socket FTG, 1/4" x 1/8" FNPT	 Female Valve FTG, 1/4" NPT	 Stem Adapter FTG, 3/8" x 1/4"	 Union Tee FTG, 3/8"
--	--	---	--	--

J&D
Manufacturing

Visit our website at www.jdmfg.com